

ROUTE 162 (OCEAN AVENUE) ROUTE 162 (JONES HILL ROAD)

BASELINE CURVE DATA

CURVE NO. 1
 R=280
 T=34.74
 L=69.12
 DELTA 14°-06'-39.5" LEFT
 PC STA. 40-88.46
 S34°-25'-36.5" W
 PISTA. 50-72.76
 S34°-19'-57.2" W
 PT STA. 41-54.59

CURVE NO. 2
 R=2000
 T=18.59
 L=35.17
 DELTA 0°-57'-01.0" RIGHT
 PC STA. 42-44.06
 S34°-18'-57.2" W
 PISTA. 42-60.84
 N38°-15'-58.2" W
 PT STA. 42-77.25

CURVE NO. 3
 R=20000
 T=18.46
 L=32.93
 DELTA 0°-09'-39.6" LEFT
 PC STA. 43-51.15
 S33°-13'-58.2" W
 PISTA. 43-67.59
 S33°-08'-18.6" W
 PT STA. 43-84.05

BASELINE CURVE DATA

CURVE NO. 1
 R=300
 T=62.34
 L=122.95
 DELTA 23°-28'-41.8" LEFT
 PC STA. 30-10.42
 N7°-39'-30.5" W
 PISTA. 30-72.76
 N37°-09'-12.0" W
 PRC. 31-33.35

CURVE NO. 2
 R=850
 T=17.35
 L=34.89
 DELTA 7°-20'-17.9" RIGHT
 PC STA. 31-33.35
 N37°-09'-12.0" W
 PISTA. 31-50.69
 N68°-17'-34" W
 PRC. 31-58.04

ROUNDABOUT BASELINE CURVE DATA

CURVE NO. 1
 R=37.5
 L=233.62
 DELTA 180°-00'-00" RIGHT
 CC COORD. N 146904.059
 E 534937.102
 STARTING STA. 10-00 N 146904.059
 E 534937.102
 ENDING STA. 12-35.62 N 146904.059
 E 534937.102

S.R. 705 (OCEAN AVENUE) BASELINE CURVE DATA

CURVE NO. 1
 R=250
 T=21.85
 L=43.59
 DELTA 5°-59'-5.8" LEFT
 PC STA. 20-51.05
 S78°-51'-52.4" E
 PISTA. 20-82.89
 S68°-57'-05.1" E
 PRC STA. 20-74.61

CURVE NO. 2
 R=500
 T=45.08
 L=89.92
 DELTA 10°-46'-44.5" RIGHT
 PC STA. 20-74.61
 S88°-51'-08.1" E
 PISTA. 21-18.99
 S78°-57'-53.7" E
 PRC STA. 21-64.55

CURVE NO. 3
 R=700
 T=44.37
 L=88.51
 DELTA 7°-14'-42" RIGHT
 PC STA. 21-64.55
 S78°-57'-53.7" E
 PISTA. 22-08.95
 S77°-16'-11.7" E
 PRC STA. 22-53.05

CURVE NO. 4
 R=500
 T=34.5
 L=68.74
 DELTA 19°-08'-25.8" LEFT
 PC STA. 22-53.05
 S77°-16'-11.7" E
 PISTA. 23-37.20
 N69°-57'-24.6" E
 PRC STA. 24-18.78

CURVE NO. 5
 R=700
 T=74.76
 L=142.95
 DELTA 12°-11'-29" RIGHT
 PC STA. 24-18.78
 N69°-57'-24.6" E
 S78°-15'-6.4" E
 PT STA. 25-66.75

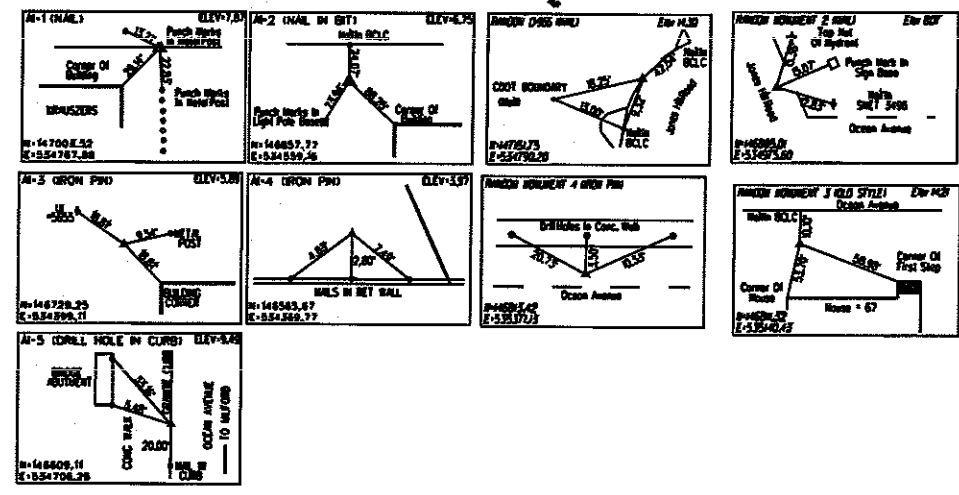
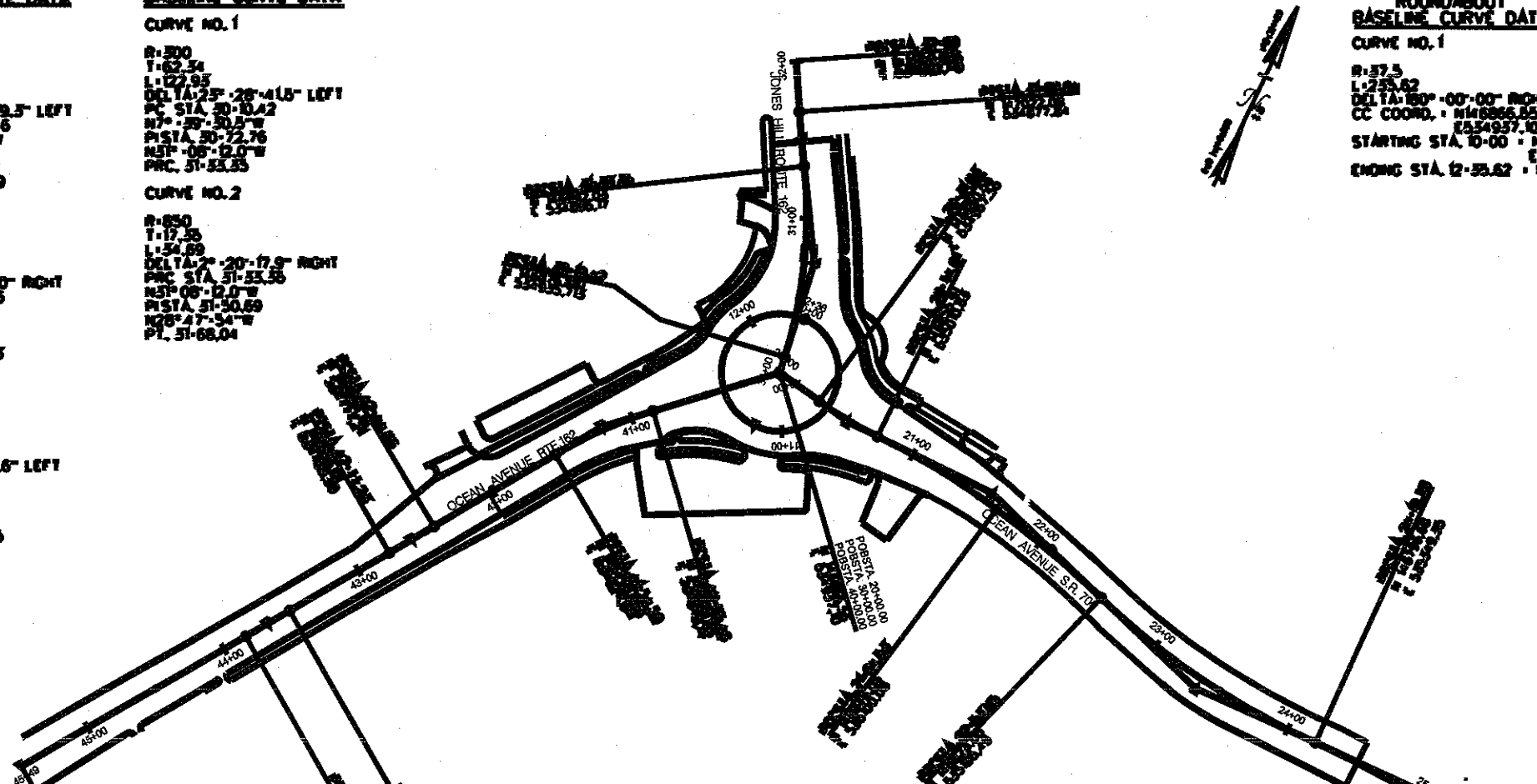

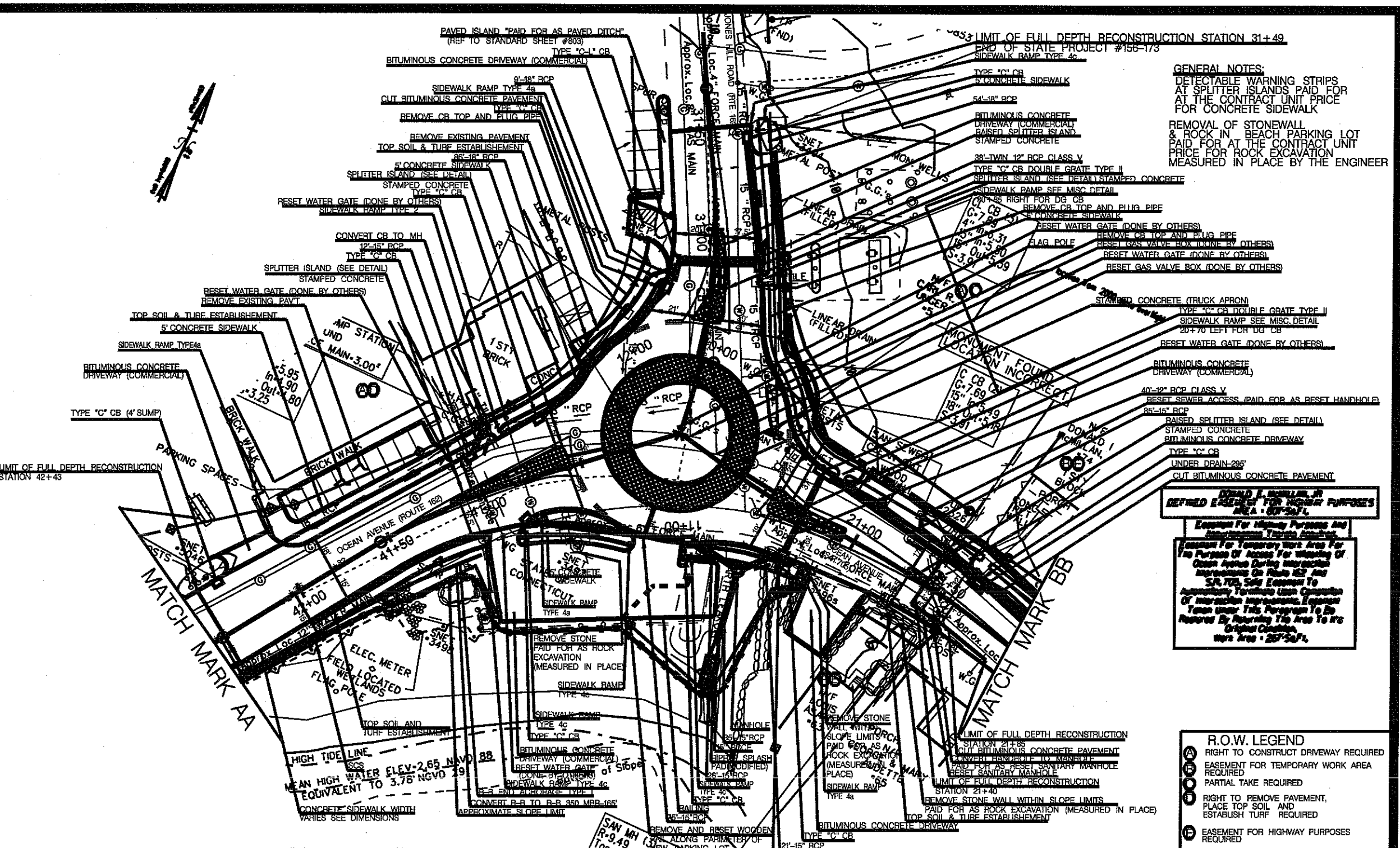

GENERAL NOTES:
 DETECTABLE WARNING STRIPS AT SPLITTER ISLANDS PAID FOR AT THE CONTRACT UNIT PRICE FOR CONCRETE SIDEWALK
 REMOVAL OF STONEMALL & ROCK IN BEACH PARKING LOT PAID FOR AT THE CONTRACT UNIT PRICE FOR ROCK EXCAVATION MEASURED IN PLACE BY THE ENGINEER

DEFINED EASEMENT FOR HIGHWAY PURPOSES AREA - 60'x51'

Exception For Temporary Work Area For The Purpose Of Access For Relocation Of Ocean Avenue During Intersection Improvements On Route 162 And S.R. 705, Sole Easement To Accompany Temporary Lane Construction Of Intersection Improvements, Easement Term Under This Paragraph To Be Restored By Restoring The Area To It's Original Condition, Work Area - 267'x51'

R.O.W. LEGEND

| | |
|-----|--|
| (A) | RIGHT TO CONSTRUCT DRIVEWAY REQUIRED |
| (B) | EASEMENT FOR TEMPORARY WORK AREA REQUIRED |
| (C) | PARTIAL TAKE REQUIRED |
| (D) | RIGHT TO REMOVE PAVEMENT, PLACE TOP SOIL AND ESTABLISH TURF REQUIRED |
| (E) | EASEMENT FOR HIGHWAY PURPOSES REQUIRED |

| REV. | DATE | DESCRIPTION | BY | CHKD. |
|------|------|-------------|----|-------|
| | | | | |
| | | | | |



DESIGNED BY: GS
 CHECKED BY: GS
 DRAWN BY: SB

STATE OF CONNECTICUT
 DEPARTMENT OF TRANSPORTATION

OFFICE OF ENGINEERING

PROJECT TITLE:
**INTERSECTION IMPROVEMENT
 ROUTE 162 & S.R. 705**

WEST HAVEN
 PLAN SHEET
 156-173
 PLAN-01
 24

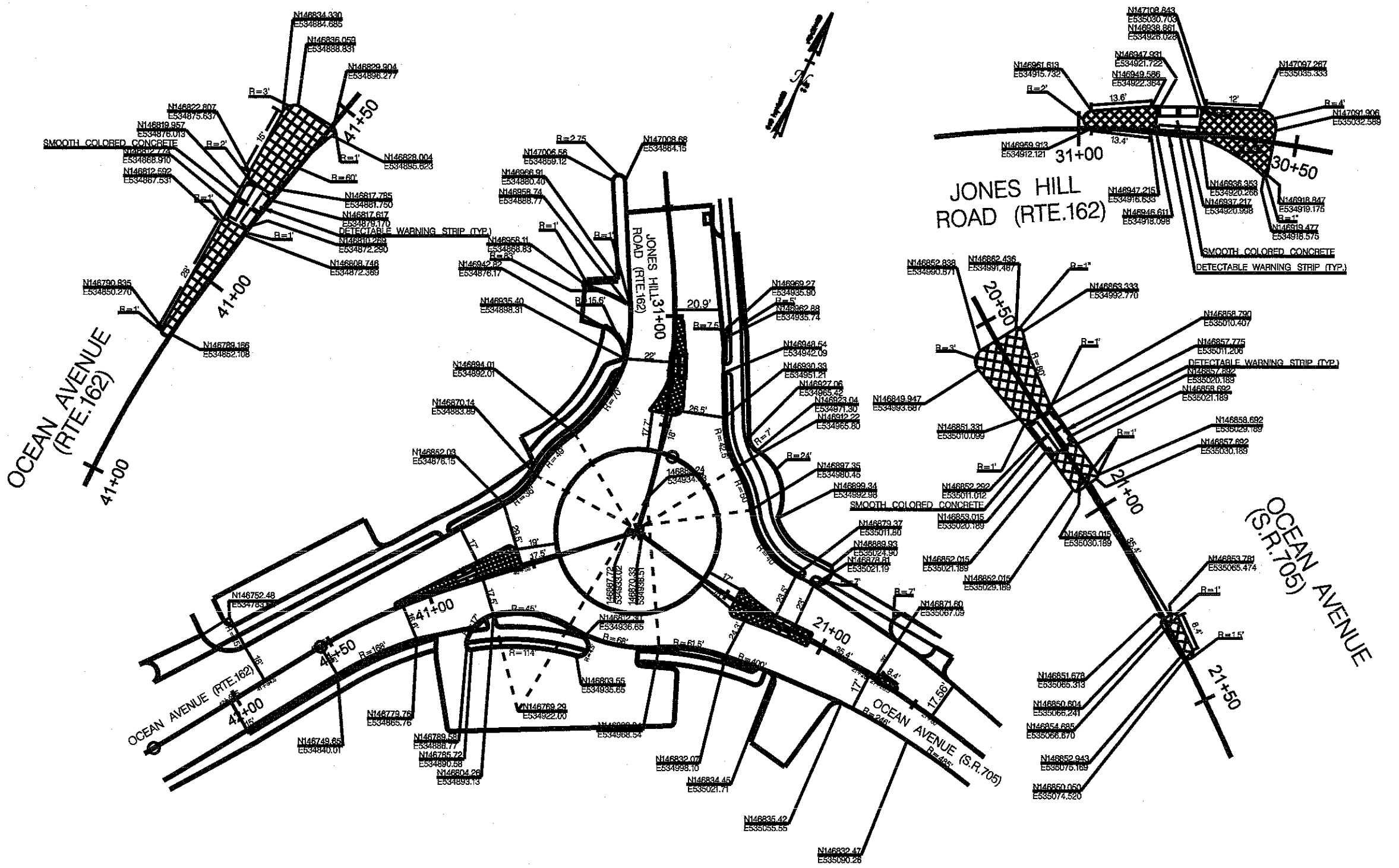

| REV. | DATE | DESCRIPTION | SHEET NO. |
|------|------|-------------|-----------|
| | | | |
| | | | |
| | | | |



| | |
|----|--|
| GS | |
| GS | |
| SB | |

STATE OF CONNECTICUT
 DEPARTMENT OF TRANSPORTATION

OFFICE OF ENGINEERING

PROJECT TITLE: INTERSECTION IMPROVEMENT ROUTE 162 & S.R.705
 DRAWING TITLE: WEST HAVEN
 SHEET: RADIUS LAYOUT SHEET

| | |
|--|--|
| | |
| | |
| | |

| | | |
|--|--|--|
| | | |
| | | |
| | | |