

CONNECTICUT
GEODETIC SURVEY
CALIBRATION BASE LINE

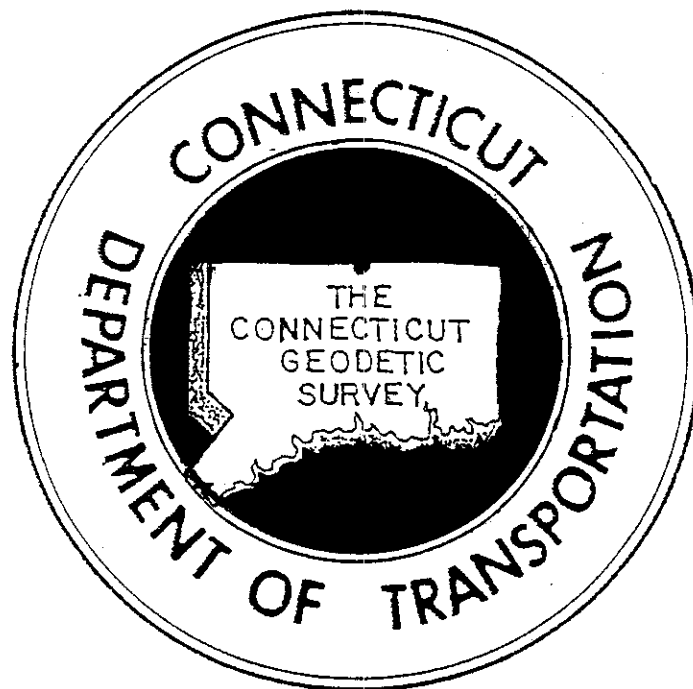

CITY OF NEW HAVEN

PUBLISHED BY
CONNECTICUT DEPARTMENT OF TRANSPORTATION

CENTRAL SURVEYS

1979 — 1990

ANGULAR BASELINE

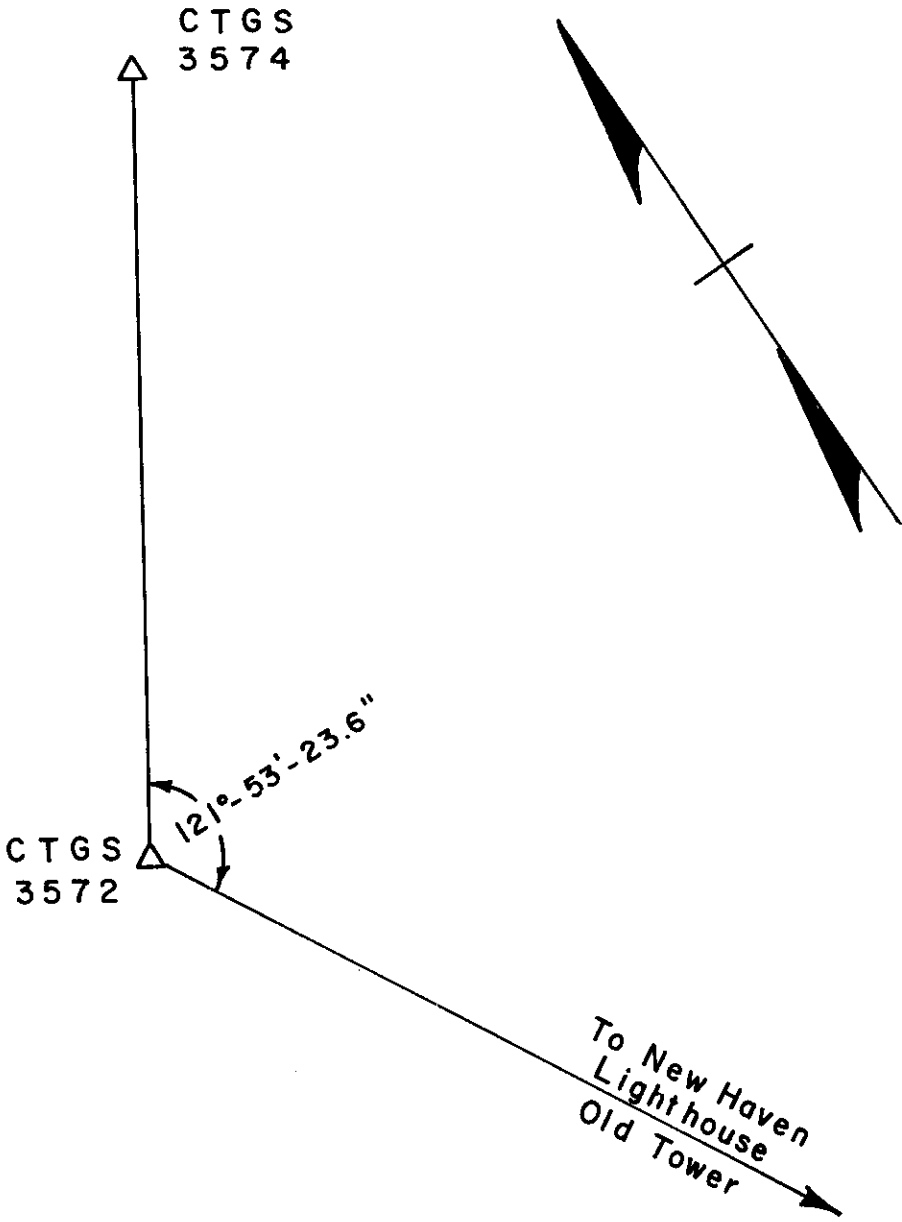

CONNECTICUT GEODETIC SURVEY

TOWN New Haven COUNTY New Haven STATION 3572
 DATE SET April 1975 QUADRANGLE 410723 New Haven ORDER OF ACCURACY
 DATE DESCRIBED November 1978 USGS MAP New Haven Horizontal
 COMPUTATION VOLUME _____ BOOKS 257 R.O.W. MAP 92-04 Sheet: 2

NATIONAL GEODETIC SURVEY — CALIBRATION BASE LINE DATA

FROM STATION	ELEVATION FEET	TO STATION	ELEVATION FEET	HORIZONTAL DISTANCE Feet	HORIZONTAL DISTANCE Meters	SLOPE DISTANCE Feet	SLOPE DISTANCE Meters	STANDARD ERROR FEET
CGS 3572	15.6	CGS 3573	9.3	492.143	150.0056	492.183	150.0178	0.0007
CGS 3572	15.6	CGS 3574	10.2	2,624.649	799.9947	2,624.655	799.9963	0.0013
CGS 3572	15.6	CGS 3584	9.6	5,003.739	1,525.1427	5,003.743	1,525.1438	0.0020
CGS 3573	9.3	CGS 3574	10.2	2,132.505	649.9889	2,132.506	649.9890	0.0010
CGS 3573	9.3	CGS 3584	9.6	4,511.595	1,375.1369	4,511.595	1,375.1369	0.0016
CGS 3574	10.2	CGS 3584	9.6	2,379.089	725.1479	2,379.090	725.1480	0.0013

ELEVATION		OBJECT	DISTANCE FEET	DIRECTION	PLANE AZIMUTH
Mean Sea Level Datum	Comments				
Feet		C.G.S. 3574 RM 1 RM 2 RM 3	63.34 21.87 33.40	00 00 00 34 16 49 99 34 08 192 30 28	
Meters					
Date					
Feet		RM 1 to RM 2 RM 2 TO RM 3	58.1 40.8		
Meters					
Date					

P - Indicates preliminary values (SEE OTHER SIDE)

TOWN New Haven

STATION

3572

DESCRIPTION: The Station Mark is a Connecticut Geodetic Survey brass disk, stamped 3572, set in the top of a cast in place concrete monument that is 5 feet long and about 1.2 inches square. The top of the monument is flush with the surface of the ground. Subsurface mark is a Connecticut Geodetic Survey brass disk, stamped 3572, set in an irregular mass of concrete that is about 5 feet below the surface of the ground.

To reach the station in New Haven from the intersection of I-91 & I-95, go southwesterly on I-95 for 0.36 mile to Exit 46 (Sargent Drive). Proceed along Exit 46 for 0.17 mile to Sargent Drive and continue southwesterly on Sargent Drive for 0.48 mile to Long Wharf Drive on the left, southeast. Turn left and proceed southeasterly on Long Wharf Drive for 0.10 mile to a dirt drive, just past the bridge under I-95. Turn right and proceed southwesterly for 0.08 mile to the station in the gravel parking lot.

The station is 448 feet southwest of the centerline of Long Wharf Drive 167 feet east of the centerline of I-95, and 47 feet west of a 3 foot bank.

RM 1: Northeast of Station: A drill hole in a CGS brass disk, stamped REFERENCE NO. 1, set in a reinforced concrete post the top set 1 inch below the surface of the ground. It is 190 feet east of the centerline of I-95 (northbound) 388 ft. southwest of the centerline of Long Wharf Drive, and 16 feet west of a 3 foot bank.

RM 2: East of Station: A drill hole in a CGS brass disk, stamped REFERENCE NO. 2, set in the top of a reinforced concrete post, the top set 1 inch below the surface of the ground. It is 448 feet southwest of the centerline of Long Wharf Drive, 190 feet east of the centerline of I-95 (northbound), and 25 feet west of a 3 foot bank.

RM 3: Southwest of Station: A drill hole in a hex head brass bolt set in a ¼ in. hole in a 2 ft. by 1 ft. boulder that is flush with the surface of the ground. It is 485 feet southwest of the centerline of Long Wharf Drive, 168 feet east of the centerline of I-95 (northbound), and 47 feet west of a 3 foot bank.

NOTES: All baseline measurements are not corrected for sea level or scale factors.

METRIC CONVERSION CONSTANTS
1 Meter= 3.2808333333 Feet
1 Foot= 0.3048006096 Meter

RECOVERY NOTES

Date	Organization	Condition
10/02/90	CTGS	Good

SKETCH:

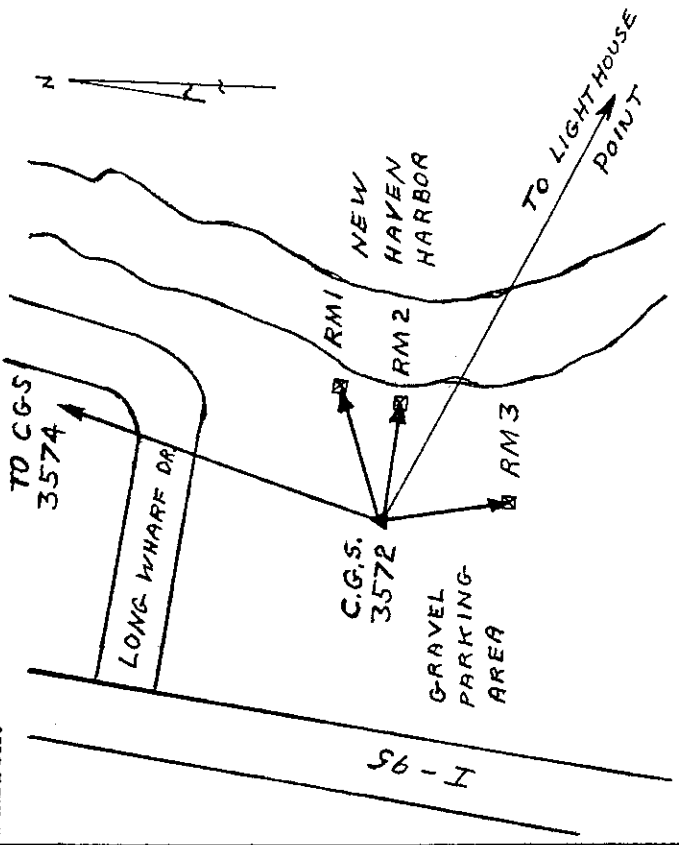

CONNECTICUT GEODETIC SURVEY

3573

TOWN New Haven COUNTY New Haven STATION 3573
 DATE SET April 1975 QUADRANGLE 410723 New Haven ORDER OF ACCURACY
 DATE DESCRIBED October 1990 USGS MAP New Haven Horizontal
 COMPUTATION VOLUME BOOKS 257 & F-1 Vertical
 R.O.W. MAP 92-04, Sheet 2

NATIONAL GEODETIC SURVEY — CALIBRATION BASE LINE DATA

FROM STATION	ELEVATION FEET	TO STATION	ELEVATION FEET	HORIZONTAL DISTANCE Feet	HORIZONTAL DISTANCE Meters	SLOPE DISTANCE Feet	SLOPE DISTANCE Meters	STANDARD ERROR FEET
CGS 3572	15.6	CGS 3573	9.3	492.143	150.0056	492.183	150.0178	0.0007
CGS 3572	15.6	CGS 3574	10.2	2624.649	799.9947	2624.655	799.9963	0.0013
CGS 3572	15.6	CGS 3584	9.6	5003.739	1525.1427	5003.743	1525.1438	0.0020
CGS 3573	9.3	CGS 3574	10.2	2132.505	649.9889	2132.506	649.9890	0.0010
CGS 3573	9.3	CGS 3584	9.6	4511.595	1375.1369	4511.595	1375.1369	0.0016
CGS 3574	10.2	CGS 3584	9.6	2379.089	725.1479	2379.090	725.1480	0.0013

ELEVATION		OBJECT	DISTANCE FEET	DIRECTION	PLANE AZIMUTH
Mean Sea Level Datum	Comments				
Feet		CGS 3574		00 00 00	
Meters		RM 3	81.53	256 09 21	
Date		RM 1	63.90	315 55 55	
Feet		RM 2	20.66	332 37 46	
Meters					
Date					
Feet					
Meters					
Date					

(SEE OTHER SIDE)

P - Indicates preliminary values

DESCRIPTION: The Station Mark is a standard CTGS brass disk, stamped 3573, set into the top of a cast in place concrete monument which is 5.0 ft. long and 10 in. in diameter and recessed 2 in. below the ground.

To reach the station from the intersection of Interstate Route 91 and Interstate Route 95 proceed southwest on I-95 for 0.36 mi. to Exit 46 (Sargent Drive). Proceed along the exit for 0.17 mi. to Sargent Drive and continue westerly on Sargent Drive for 0.48 mi. to Long Wharf Drive. Turn left onto Long Wharf Drive and proceed northwest for 0.03 mi. to the station on the left (north).

The station is located 77.2 ft. northeast of N.H. Light Std. #60, 89.3 ft. southwest of N.H. Light Std #61, 63.9 ft. south of an 8 in. oak tree, 26 ft. northwest of the centerline of Long Wharf Drive and 5.4 ft. northwest of a concrete curb.

RM 1: Northwest of Station: A drill hole in a CTGS brass disk, stamped REFERENCE NO. 1, set into the top of a reinforced concrete post which is recessed 1 in. below the ground. It is located 125.6 ft. north of N.H. Light Std. #60, 107.5 ft. southwest of N.H. Light Std. #61, 75 ft. northwest of the centerline of Long Wharf Drive, 11.1 ft. southeast of a 14 in. oak tree and 14.7 ft. southwest of an 8 in. oak tree.

RM 2: North of Station: A drill hole with flick marks on the east side of a City of New Haven manhole rim. It is located 94.3 ft. northeast of a N. H. Light Std. #60, 84.5 ft. southwest of N.H. Light Std. #60, 84.5 ft. southwest of N.H. Light Std. #61, 43.3 ft. south of a 10 in. oak tree and 38 ft. northwest of the centerline of Long Wharf Drive.

RM 3: West of Station: A drill hole in a hex head brass bolt in a ¼ in. hole in a chiseled square in the southerly corner of the northeast wingwall of the bridge carrying I-95. It is located 85.5 ft. northwest of N.H. Light Std. #60 and 28 ft. northeast of the centerline of Long Wharf Drive.

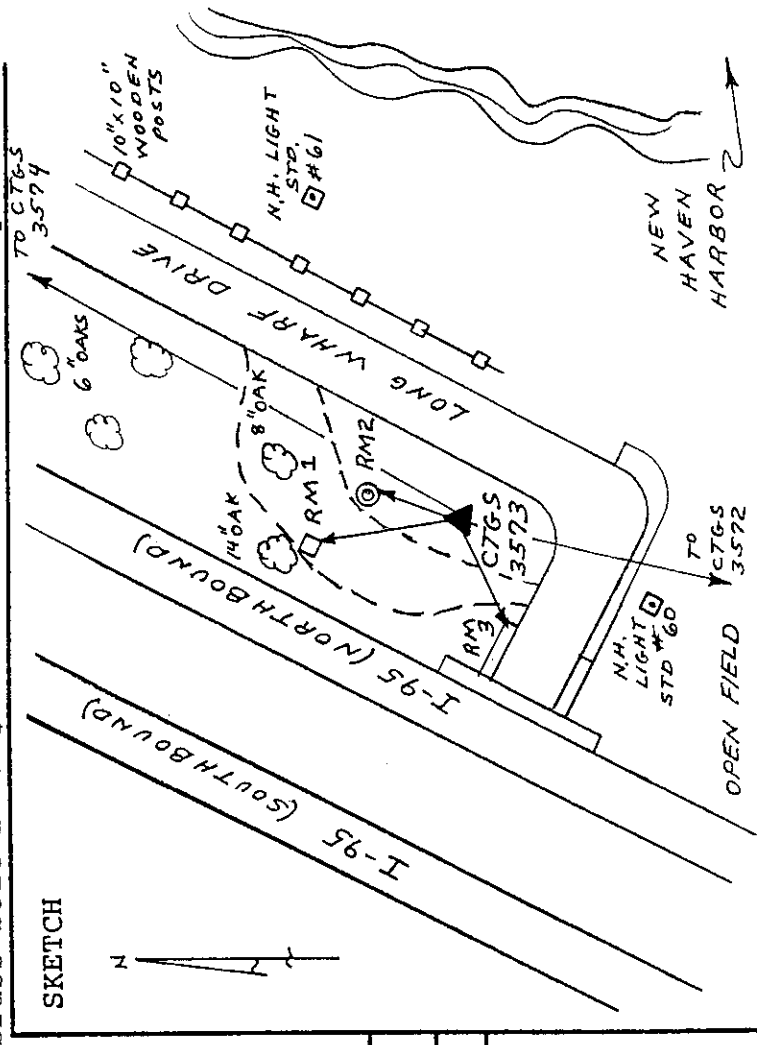

NOTES: All baseline measurements are not corrected for sea level or scale factors.	RECOVERY NOTES		
	Date	Organization	Condition
	10/1/90	CTGS	Good

METRIC CONVERSION CONSTANTS
 1 Meter = 3.280833333 Feet
 1 Foot = 0.3048006096 Meter

CONNECTICUT GEODETIC SURVEY

TOWN New Haven COUNTY New Haven STATION 3574
 DATE SET April 1975 QUADRANGLE 410723 New Haven ORDER OF ACCURACY
 DATE DESCRIBED November 1978 USGS MAP New Haven Horizontal
 COMPUTATION VOLUME BOOKS 257 R.O.W. MAP 92-04 Sheet 3

NATIONAL GEODETIC SURVEY — CALIBRATION BASE LINE DATA

FROM STATION	ELEVATION FEET	TO STATION	ELEVATION FEET	HORIZONTAL DISTANCE Feet	HORIZONTAL DISTANCE Meters		SLOPE DISTANCE		STANDARD ERROR FEET
					Feet	Meters	Feet	Meters	
CGS 3572	15.6	CGS 3573	9.3	492.143	150.0056	492.183	150.0178	0.0007	
CGS 3572	15.6	CGS 3574	10.2	2624.649	799.9947	2624.655	799.9963	0.0013	
CGS 3572	15.6	CGS 3584	9.6	5003.739	1525.1427	5003.743	1525.1438	0.0020	
CGS 3573	9.3	CGS 3574	10.2	2132.505	649.9889	2132.506	649.9890	0.0010	
CGS 3573	9.3	CGS 3584	9.6	4511.595	1375.1369	4511.595	1375.1369	0.0016	
CGS 3574	10.2	CGS 3584	9.6	2379.089	725.1479	2379.090	725.1480	0.0013	

ELEVATION		OBJECT	DISTANCE FEET	DIRECTION	PLANE AZIMUTH
Mean Sea Level Datum	Comments				
Feet		C.G.S. 3573 RM 3 RM 1 RM 2	47.79 94.27 57.82	00 00 00 39 57 22 152 28 35 270 18 34	
Meters					
Date					
Feet					
Meters		(SEE OTHER SIDE)			
Date		P Indicates preliminary values			

TOWN New Haven

STATION 3574

DESCRIPTION: The Station Mark is a Connecticut Geodetic Survey brass disk, stamped 3574, set in the top of a cast in place concrete monument that is 5 feet long and 12 inches square. The top of the monument is set flush with the surface of the ground. The subsurface mark is a Connecticut Geodetic Survey brass disk, stamped 3574, set in an irregular mass of concrete that is about 5 feet below the surface of the ground.

To reach the station in New Haven from the intersection of I-91 & I-95, go westerly on I-95 for 0.36 mi. to Exit 46 (Sargent Drive). Proceed along Exit 46 for 0.17 mile to Sargent Drive and continue southwesterly on Sargent Drive for 0.48 mile to Long Wharf Drive on the left, southeast. Turn left and proceed northeasterly on Long Wharf Drive for 0.50 mile to the station on the left, (north).

The station is 440 feet southwest of the access ramp to I-95, 125.1 feet south of an 8 inch oak tree, and 30 feet northwest of the centerline of Long Wharf Drive.

RM 1: North of Station: A drill hole in a hex head brass bolt, set in a 1/4 inch drill hole in a chiseled triangle in the center of the east side of the concrete lip of a catch basin. It is 74.5 feet northwest of the centerline of Long Wharf Drive, 73.5 feet southeast of the bituminous curb on the east side of I-95 (northbound), and 31.4 feet south of a 8 inch oak tree.

RM 2: Southeast of Station: A drill hole in a hex head brass bolt, set in a 1/4 inch drill hole in a chiseled triangle in the granite curb on the south side of Long Wharf Drive. It is 89 feet northeast of a bituminous drive to a rest area 27 feet southeast of the centerline of Long Wharf Drive, and 26.0 feet northwest of a 4 inch maple tree.

RM 3: West of Station: A drill hole in a Connecticut Geodetic Survey brass disk, stamped REFERENCE NO. 3, set in the top of a reinforced concrete post. The top set 4 in. below the surface of the ground. It is 121.4 feet southwest of the centerline of a drop inletcatch basin, 61 feet northwest of the centerline of Long Wharf Drive, and 50.2 feet north-east of a 15 inch willow tree.

NOTES: All baseline measurements are not corrected for sea level or scale factors.

METRIC CONVERSION CONSTANTS
1 Meter= 3.2808333333 Feet
1 Foot= 0.3048006096 Meter

Monument is now located in a partially paved pull-off area -
10/90 CTGS

SKETCH:

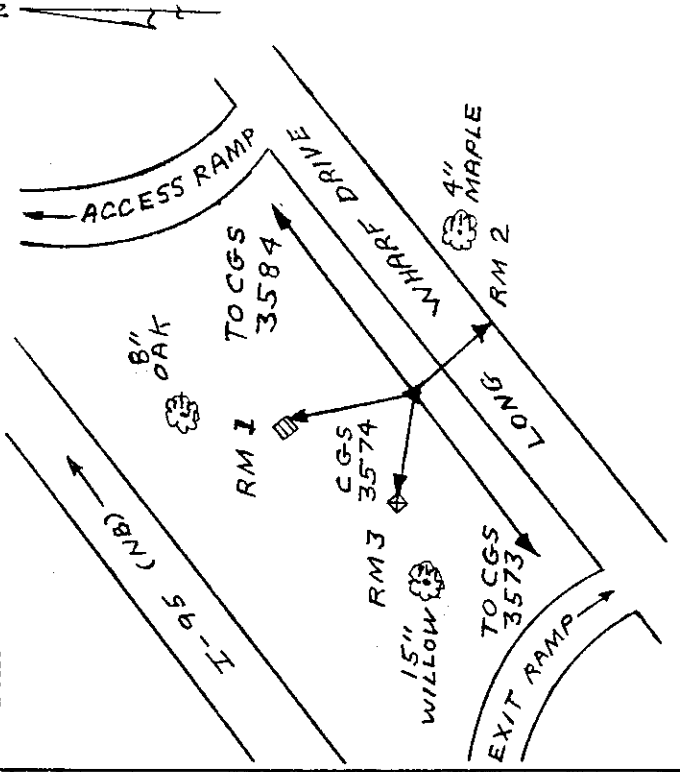

RECOVERY NOTES		
Date	Organization	Condition
10/02/90	CTGS	Good

CONNECTICUT GEODETIC SURVEY

TOWN New Haven COUNTY New Haven STATION 3584
 DATE SET April 1975 QUADRANGLE 410723 New Haven ORDER OF ACCURACY
 DATE DESCRIBED November 1978 USGS MAP New Haven Horizontal
 COMPUTATION VOLUME BOOKS 257 R.O.W. MAP 92-04 Sheet: 4

NATIONAL GEODETIC SURVEY — CALIBRATION BASE LINE DATA

FROM STATION	ELEVATION FEET	TO STATION	ELEVATION FEET	HORIZONTAL DISTANCE Meters	SLOPE DISTANCE Meters	STANDARD ERROR FEET
CGS 3572	15.6	CGS 3573	9.3	150.0056	150.0178	0.0007
CGS 3572	15.6	CGS 3574	10.2	799.9947	799.9963	0.0013
CGS 3572	15.6	CGS 3584	9.6	1525.1427	1525.1438	0.0020
CGS 3573	9.3	CGS 3574	10.2	649.9889	649.9890	0.0010
CGS 3573	9.3	CGS 3584	9.6	1375.1369	1375.1369	0.0016
CGS 3574	10.2	CGS 3584	9.6	725.1479	725.1480	0.0013

ELEVATION		OBJECT	DISTANCE FEET	DIRECTION	PLANE AZIMUTH
Mean Sea Level Datum	Comments				
Feet		C.G.S. 3574 RM 2 RM 3 RM 1	34.92 14.29 32.93	00 00 00 30 11 48 75 22 57 202 45 50	
Meters					
Date					
Feet		RM 2 to RM 1 RM 3 to RM 2	43.3 26.9		
Meters					
Date					

P - Indicates preliminary values

(SEE OTHER SIDE)

TOWN New Haven

STATION 3584

DESCRIPTION: The Station Mark is a Connecticut Geodetic Survey brass disk, stamped 3584, set in the top of a cast in place concrete monument which is 5 feet long and 12 inches square. The top of the monument is flush with the surface of the concrete walk. The subsurface mark is a Connecticut Geodetic Survey brass disk, stamped 3584, set in an irregular mass of concrete that is about 5 feet below the surface of the ground.

To reach the station in New Haven from the intersection of I-91 & I-95, go southwesterly on I-95 for 0.36 mile to Exit 46 (Sargent Drive). Proceed along Exit 46 for 0.17 mile to Sargent Drive and continue southwesterly on Sargent Drive for 0.48 mile to Long Wharf Drive on the left, southeast. Turn left and proceed northeasterly on Long Wharf Drive for 0.85 mile to the station on the left, (west).

The station is 105.7 feet northeast of light pole 6, 33.2 feet south of light pole 5, 32.0 feet north of the centerline of a manhole, 28 feet northwest of the centerline of Long Wharf Drive, 21.0 feet south of the centerline of a gate for a bituminous drive, and 3.7 feet northwest of the face of the granite curb.

RM 1: Northeast of Station: A drill hole in a hex head brass bolt, set in a 1/4 inch drill hole, in the most southern corner of the concrete base for light pole 5. It is 26.7 feet northwest of the centerline of Long Wharf Drive, 19.8 feet northeast of the centerline of a gate for a bituminous drive, and 7.0 feet southwest of the centerline of a catch basin.

RM 2: Southwest of Station: A drill hole in a hex head brass bolt, set in a 1/4 inch drill hole on the most eastern corner of a 5 foot by 5 foot concrete base for a metal light box. It is 73.6 feet northeast of light pole 6, 13.1 feet northwest of the face of the granite curb, and 7.4 feet south of the northeast corner of a chain link fence.

RM 3: West of Station: A drill hole in a hex head brass bolt, set in a 1/4 inch drill hole, in the concrete base for the third iron fence post, south of the bituminous driveway. It is 43.2 feet southwest of light pole 5, 26.0 feet southwest of the centerline of a bituminous driveway, and 10.0 feet northwest of the face of the granite curbing.

NOTES: All baseline measurements are not corrected for sea level or scale factors.

METRIC CONVERSION CONSTANTS
1 Meter= 3.2808333333 Feet
1 Foot= 0.3048006096 Meter

RECOVERY NOTES

Date	Organization	Condition
10/01/90	CIIGS	Good

SKETCH:

