

		MOVEMENT DIAGRAM																																			
		PHASE 1				PHASE 2 PRE-EMPT. 1				PHASE 3				PHASE 4				PHASE 5				PHASE 6				PHASE 7				PHASE 8							
		FLASH	GRN	CL	CL	GRN	CL	CL	CL	GRN	CL	CL	CL	GRN	CL	CL	CL	GRN	CL	CL	CL	GRN	CL	CL	CL	GRN	CL	CL	CL	GRN	CL	CL	CL	GRN	CL	CL	CL
INTERVALLS	MIN GRN																																				
	WALK																																				
	PED CLR																																				
	VEH EXT																																				
	MAX 1																																				
	MAX 2																																				
	YELLOW																																				
	RED																																				
	ADD INIT																																				
	MAX INIT																																				
TBR																																					
TTR																																					
MIN GAP																																					
MODE																																					
INIT START																																					

TECHNICAL NOTES		OFFICE RECORD	
RECTANGULAR RAPID FLASHERS TO FLASH FOR XX SECONDS UPON ACTUATION. (XX-XX SECOND ADJUSTABLE.)		REV #	TIR # N/A SM # N/A SIGNAL REVISED:
XX SECOND TIMER SHOULD RESET UPON EACH ACTUATION.		INSTALLED RECTANGULAR RAPID FLASHING BEACON (RRFB) ASSEMBLY UNDER PERMIT OR IF APPLICABLE UNDER PROJECT NO. XXXX-XXXX.	
NOTE TO DESIGNER FOR TIMER CALCULATION:			
TYPICAL CALC = 7' + (27 FT / 3.5 FT/SEC) = 15'			
MIN VALUE = 29 FEET / 3.5 FT/SEC = 9'			
MAX VALUE = 7' + (27 FT / 3.0 FT/SEC) = 16'			

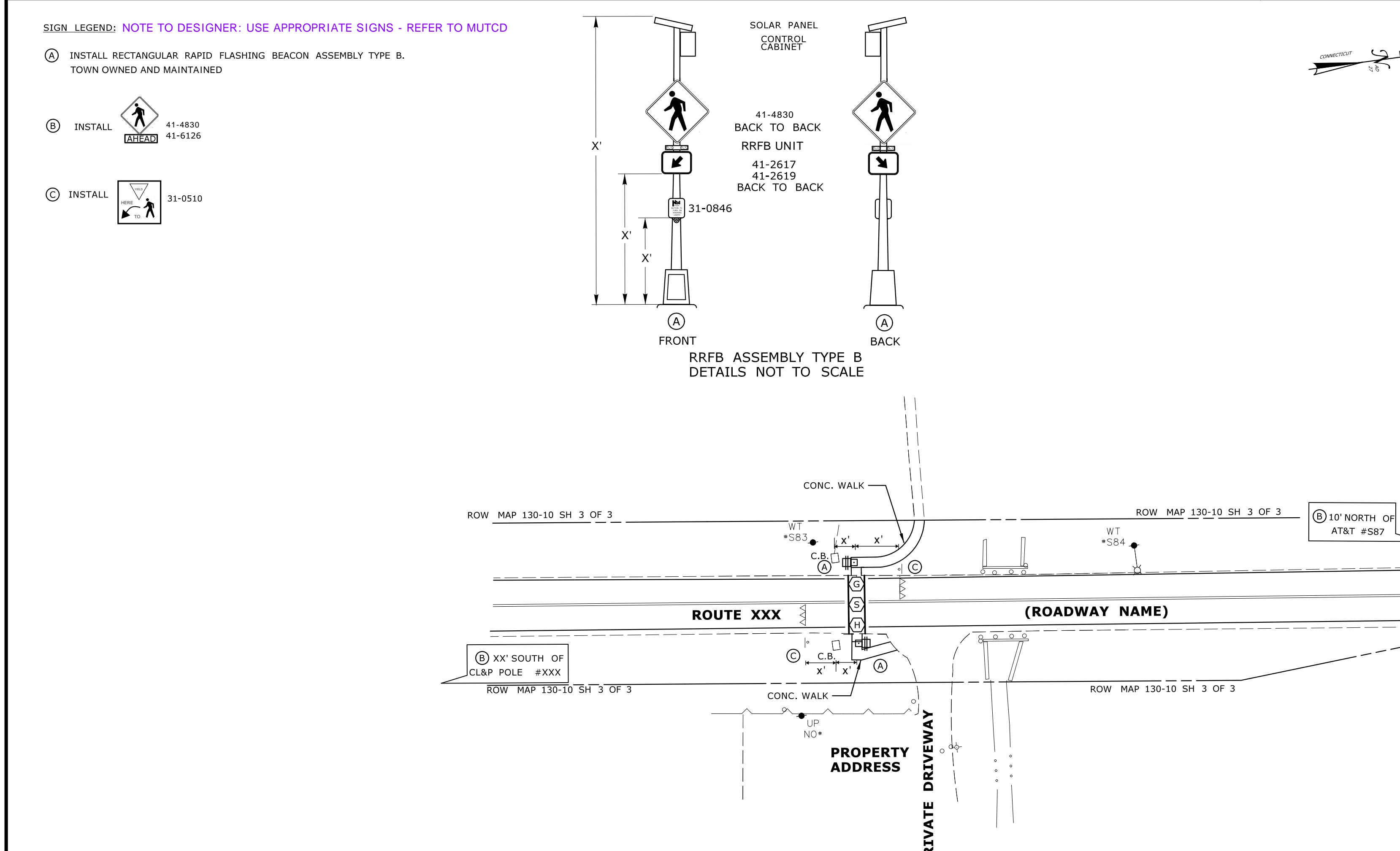

**CONSTRUCTION NOTES:**

ALL MATERIAL AND CONSTRUCTION METHODS SHALL CONFORM TO THE FOLLOWING CURRENT D.O.T. DOCUMENTS WHICH CAN BE ACCESSED ON THE CTDOT WEBSITE:

- STANDARD SPECIFICATIONS FOR ROADS, BRIDGES, AND INCIDENTAL CONSTRUCTION (FORM 817)
- SUPPLEMENTAL SPECIFICATIONS TO FORM 817
- STANDARD INSTALLATION AND GUIDE DETAIL SHEETS.

ALL TRAFFIC EQUIPMENT IS NEW.

STAKE ALL R.O.W. PRIOR TO EXCAVATION.

ANY PROPOSED REVISIONS TO THE LOCATION OF THE APPURTENANCES SHOWN ON THE PLAN MUST BE SUBMITTED FOR REVIEW AND APPROVAL BY THE CITY/TOWN PRIOR TO INSTALLATION

THE LOCATION OF TRAFFIC SIGNAL FOUNDATIONS WHEN IN OR ADJACENT TO SIDEWALKS SHALL BE VERIFIED PRIOR TO INSTALLATION TO PROVIDE A FREE PATH OF NOT LESS THAN 4 FEET. IF A MINIMUM 4 FOOT FREE PATH IS UNAVAILABLE NOTIFY THE ENGINEER AND CONTACT THE CITY/TOWN

SEE SPECIAL PROVISION ITEM #1117XXX-A - RECTANGULAR RAPID FLASHING BEACON- TYPE B.

RECTANGULAR RAPID FLASHING BEACON TO BE PEDESTRIAN ACTUATED, SOLAR POWERED AND WIRELESS ACTIVATED.

COORDINATE WITH UTILITY COMPANY REPRESENTATIVES LISTED IN THE SPECIAL PROVISION, 1.07 - LEGAL RELATIONS AND RESPONSIBILITIES.

REMOVE ALL ABANDONED TRAFFIC SIGNAL EQUIPMENT PER SPECIAL PROVISION.

(G) INSTALL TYPE XX SIDEWALK RAMP PER GUIDE SHEETS.

(H) INSTALL TYPE XX SIDEWALK RAMP PER GUIDE SHEETS.

INSTALL RRFB ASSEMBLIES ON X' PEDESTALS.

INSTALL PEDESTAL FOUNDATIONS ADJACENT TO THE LANDING AREAS

CONTRACTOR TO ERADICATE AND INSTALL ALL PAVEMENT MARKINGS AS INDICATED BELOW:

(ADD APPROPRIATE NOTES AS APPLICABLE)

## TOWN RRFB ASSEMBLY

ENGINEER	TRAFFIC DESIGN	ELECTRICAL DESIGN	REV #	INTERSECTION #XXX-XXX
DRAWN BY			RECTANGULAR RAPID FLASHING BEACON ASSEMBLY (RRFB)	
CHECKED BY			ENERGY BY: SOLAR ADDRESS # N/A	
SUBMITTED BY			MAINT LEVEL: N/A SERVICE POLE: SOLAR	
APPROVED BY			UNMETERED SERVICE	
APPROVED DATE				

ROUTE XXX (ROADWAY NAME) AT ROADWAY/DRIVEWAY NAME AND/OR STREET ADDRESS	TOWN:	PROJECT NO. XXXX-XXXX
	<b>INSERT TOWN NAME</b>	DRAWING NO.
<b>TRAFFIC CONTROL SIGNAL PLAN</b>		SHEET NO.

NOTES:  
(S) BAR TYPE CROSSWALK - STATE MAINTAINED

## SAMPLE PLAN - SOLAR RRFB FOR REFERENCE ONLY

NO.	DATE	REVISION DESCRIPTION

<b>LEGEND:</b> R RED Y YELLOW G GREEN ←R RED ARROW ←Y YELLOW ARROW ←G GREEN ARROW W/P WALK/ PED. CLR D.W. DON'T WALK FL. FLASHING	○ PROPOSED WOOD SPAN POLE ● EXISTING WOOD SPAN POLE □ PROPOSED STEEL SPAN POLE ● EXISTING STEEL SPAN POLE ○ PROPOSED UTILITY POLE ● EXISTING UTILITY POLE □ PEDESTAL MOUNTING □ PEDESTRIAN PUSH BUTTON & SIGN □ DIRECTIONAL ARW. FOR PUSH BUTTON	□ TRAFFIC SIGNAL FACE □ PEDESTRIAN SIGNAL FACE DET. LEADS IN SAW CUT --- PROPOSED RMC (RIGID METAL CONDUIT) --- EXISTING RMC (RIGID METAL CONDUIT) □ AUXILIARY TERMINATION CABINET □ AUXILIARY EQUIPMENT CABINET □ VIDEO DETECTION ZONE	□ PROPOSED CONTROLLER □ EXISTING CONTROLLER □ LOOP DETECTOR SD SYSTEM DETECTOR □ MAGNETIC DETECTOR □ OPTICAL DETECTOR □ VIDEO DETECTOR □ AUDIO DETECTOR	VC VIDEO CAMERA CABLE □ CABLE CLOSURE □ WIRELESS SENSOR □ WIRELESS RECEIVER □ WIRELESS TRANSMITTER □ GUY WIRE □ PROPOSED HANDHOLE □ EXISTING HANDHOLE
--	--	--	--	--

DATE PLOTTED : 5/15/2018 D:\Users\desantica\Desktop\Documents\TR\_MSH\_TCS\_130\_220\_PAFB\_SAMPLE\_PLAN\_REF.dgn



SCALE 1" = 40'