

CONNECTICUT
DEPARTMENT
OF
TRANSPORTATION



CONDITION INSPECTION
FOR THE
DANBURY STATION

GENERAL RECOMMENDATION 3

**CONN. DEPT OF TRANSPORTATION
STATION INSPECTION**

INSPECTION RATING SCALE

The following rating scale is used for inspections:

- 1- Totally deteriorated, or in failed condition.
- 2- Serious deterioration, or not functioning as originally designed.
- 3- Minor deterioration, but functioning as originally designed.
- 4- New condition. No deterioration.
- 5- Not applicable.
- 6- Condition and/or existence unknown.

STATION: Danbury
LINE: Danbury
INSPECTION DATE: 12-1-01
INSPECTION AGENCY / FIRM: UA
INSPECTORS: WV, RGW
WEATHER: Sunny, 60's

CONN. DEPT OF TRANSPORTATION
STATION INSPECTION REPORT
SHEET 3 OF 42

PARKING ELEMENTS

QUADRANT # 1

TYPE OF SURFACE: asphalt x PAVED; _____ GRAVEL; _____ DIRT;
_____ OTHER (DESCRIBE)

CONDITION OF PAVED SURFACE: 4

CONDITION OF STRIPING: 3

CONDITION OF BASIN / DRAINS / ETC: 3
(FOR LOCATION SEE SHEET: see page 1)

SIGNAGE: 4

FENCE AND GUARDRAIL: 3

LANDSCAPE: 3

SIDEWALK: 5

CURB: 2

QUADRANT # 2

TYPE OF SURFACE: asphalt x PAVED; _____ GRAVEL; _____ DIRT;
_____ OTHER (DESCRIBE)

CONDITION OF PAVED SURFACE: 4

CONDITION OF STRIPING: 3

CONDITION OF BASIN / DRAINS / ETC: 3
(FOR LOCATION SEE SHEET: see page 1)

SIGNAGE: 4

FENCE AND GUARDRAIL: 3

LANDSCAPE: 4

SIDEWALK: 3

CURB: 2

STATION: Danbury
 LINE: New Haven-Danbury Branch
 INSPECTION DATE : January 24, 2002
 INSPECTION AGENCY / FIRM: Parsons Brinckerhoff
 INSPECTORS: Jim Connell & Dave Lang
 TIME OF INSPECTION: A.M.
 WEATHER: Light Rain

CONN. DEPT OF TRANSPORTATION
 STATION INSPECTION REPORT
 SHEET 5 OF 42

PLATFORM --- SERVICE

Voltage Rating (V)	n/a	Type of 3 phase connection		Delta	n/a	Wye	n/a
		Method of Entrance		Overhead	n/a	Underground	X
Rating of Main Breaker (A)	n/a	Origin of Service		Pole	n/a	Transformer	n/a
		Code Compliant		Yes	X	No	n/a
Quantity of Phases	n/a	Pole Number & Street	n/a	Wire Sizes	n/a		

Remarks: The electrical service to the platform originates from the building, see Station Building Service Sheet.

PLATFORM --- ELECTRICAL SYSTEMS

Electrical Device	Manufacturer	Model Number	Rating	Location	Estimated Age/Life(y/y)	Visual Condition
Main Distribution Panel	n/a	n/a	n/a	n/a	n/a	n/a
Main Disconnect Switch	n/a	n/a	n/a	n/a	n/a	n/a
Transformer	n/a	n/a	n/a	n/a	n/a	n/a
Receptacles	unknown	unknown	3	platform	2/ 20	minor deterioration
Grounding	unknown	unknown	3	platform	2/ 20	minor deterioration
Lighting Controls	unknown	unknown	3	unknown	2/ 20	minor deterioration
Public Telephone	n/a	n/a	n/a	n/a	n/a	n/a
Station Telephone	n/a	n/a	n/a	n/a	n/a	n/a

Remarks: _____

STATION: Danbury

CONN. DEPT OF TRANSPORTATION
STATION INSPECTION REPORT
SHEET 6 OF 42

INSPECTORS: Jim Connell & Dave Lang

DATE: January 24, 2002

STATION PLATFORM --- ELECTRICAL AND LIGHTING SUMMARY

There are several NEC compliant GFCI receptacles located in various locations on the platform.

A continuous row of lights is installed under the canopy that maintain an average of 17.5 foot-candles, which exceeds the minimum light levels as recommended by the IESNA. However, the gaskets at the lenses are not continuous and may allow moisture to penetrate the fixture and compromise the fixtures light output. There is no recommendation at this time to replace them, but it is likely that these fixtures will need to be replaced within ten years, if the above item is not addressed.

STATION: Danbury
 LINE: New Haven-Danbury Branch
 INSPECTION DATE : January 24, 2002
 INSPECTION AGENCY / FIRM: Parsons Brinckerhoff
 INSPECTORS: Jim Connell & Dave Lang
 TIME OF INSPECTION: A.M.
 WEATHER: Light Rain

CONN. DEPT OF TRANSPORTATION
 STATION INSPECTION REPORT
 SHEET 7 OF 42

STATION BUILDING --- LIGHTING

Fixture Type	Manufacturer	Model Number	Rating	Support Condition	Estimated Age/Life(y/y)	Visual Condition
linear fluorescent	unknown	unknown	3	3	2/ 20	minor deterioration
2'x4' fluorescent	unknown	unknown	3	3	2/ 20	minor deterioration
compact fluorescent	unknown	unknown	3	3	2/ 20	minor deterioration
industrial fluorescent	unknown	unknown	3	3	2/ 20	minor deterioration
Exit	unknown	unknown	3	3	2/ 20	minor deterioration
Emergency Egress	unknown	unknown	3	3	2/ 20	minor deterioration

Remarks: A typical section of the waiting room was measured and found to average 8.18 fc.

STATION BUILDING --- LIGHTING LEVELS (fc)

ROOM DESC:	A	B	C	D
1 waiting room	avg 8.18			
2				
3				
4				

ROOM DESC:	A	B	C	D
1 not used				
2				
3				
4				

ROOM DESC:	A	B	C	D
1 not used				
2				
3				
4				

ROOM DESC:	A	B	C	D
1 not used				
2				
3				
4				

STATION: Danbury
 LINE: New Haven-Danbury Branch
 INSPECTION DATE : January 24, 2002
 INSPECTION AGENCY / FIRM: Parsons Brinckerhoff
 INSPECTORS: Jim Connell & Dave Lang
 TIME OF INSPECTION: A.M.
 WEATHER: Light Rain

CONN. DEPT OF TRANSPORTATION
 STATION INSPECTION REPORT
 SHEET 8 OF 42

STATION BUILDING --- SERVICE

Voltage Rating (V)	120/208	Type of 3 phase connection		Delta	n/a	Wye	X
		Method of Entrance		Overhead	n/a	Underground	X
Rating of Main Breaker (A)	200	Origin of Service		Pole	n/a	Transformer	X
		Code Compliant		Yes	X	No	n/a
Quantity of Phases	3	Pole Number & Street	CL&P 1120 parking lot	Wire Sizes	unknown		

Remarks: _____

STATION BUILDING --- ELECTRICAL SYSTEMS

Electrical Device	Manufacturer	Model Number	Rating	Location	Estimated Age/Life(y/y)	Visual Condition
Main Distribution Panel	Siemens	S3C42ML 275FTS	3	equipment room	2/ 20	minor deterioration
Main Disconnect Switch	Siemens	SN424	3	equipment room	2/ 20	minor deterioration
Transformer	unknown	unknown	unknown	unknown	2/ 20	new condition
Receptacles	unknown	unknown	3	throughout	2/ 20	minor deterioration
Grounding	unknown	unknown	unknown	unknown	2/ 20	unknown
Lighting Controls	Siemens	unknown	3	equipment room	2/ 20	minor deterioration
Public Telephone	unknown	unknown	n/a	building exterior	n/a	operational
Station Telephone	unknown	unknown	n/a	ticket booth	n/a	operational
Panel LP	Siemens	S3C30E4100 FTF	3	equipment room	2/ 20	minor deterioration

Remarks: _____

STATION: Danbury
 LINE: New Haven-Danbury Branch
 INSPECTION DATE : January 24, 2002
 INSPECTION AGENCY / FIRM: Parsons Brinckerhoff
 INSPECTORS: Jim Connell & Dave Lang
 TIME OF INSPECTION: A.M.
 WEATHER: Light Rain

CONN. DEPT OF TRANSPORTATION
 STATION INSPECTION REPORT
 SHEET 9 OF 42

STATION BUILDING --- FIRE ALARM SYSTEM

Fire Alarm Device	Manufacturer	Model Number	Quantity	Location	Estimated Age/Life(y/y)	Visual Condition	Rating
Fire Alarm Control Panel	Simplex	4001	1	equipment room	2/ 20	minor deterioration	3
Heat Detector	unknown	unknown	see remarks	throughout	2/ 20	minor deterioration	3
Smoke Detector	unknown	unknown	see remarks	throughout	2/ 20	minor deterioration	3
Pull Station	Simplex	unknown	see remarks	throughout	2/ 20	minor deterioration	3
Annunciator	n/a	n/a	n/a	n/a	n/a	n/a	n/a
Audio/Visual Device	Simplex	unknown	see remarks	throughout	2/ 20	minor deterioration	3

Remarks: Compliant with NFPA 72 and/or ADA

STATION BUILDING --- SKETCHES

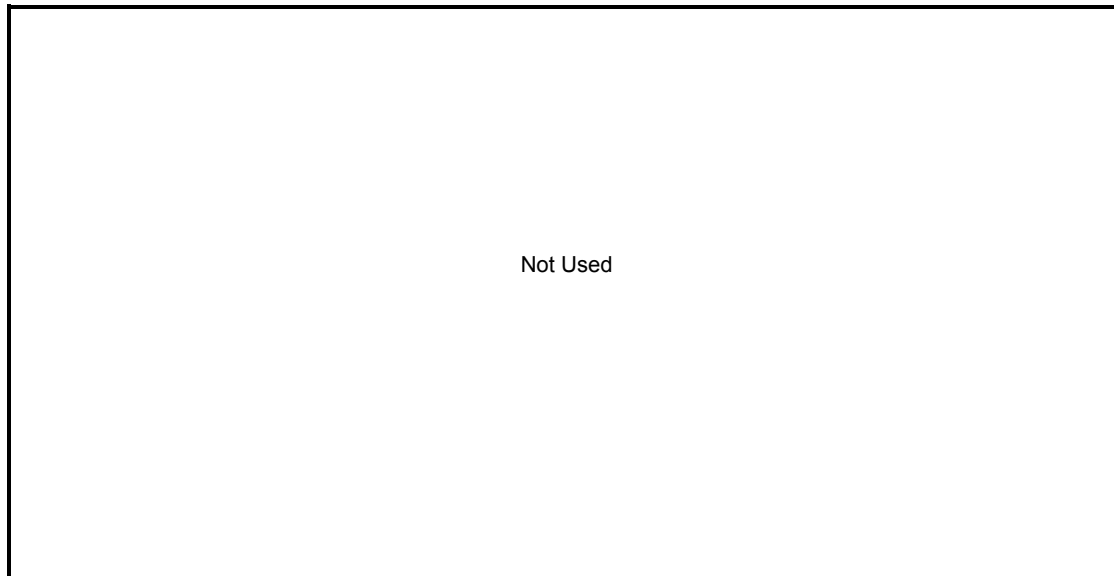

STATION: Danbury

CONN. DEPT OF TRANSPORTATION
STATION INSPECTION REPORT
SHEET 10 OF 42

INSPECTORS: Jim Connell & Dave Lang

DATE: January 24, 2002

STATION BUILDING --- ELECTRICAL AND LIGHTING SUMMARY

The building has recently been built with new electrical systems throughout.

The power panels are adequately serving the space and also have some spare capacity for growth. The building electrical and lighting systems are in good repair and will only need general maintenance to operate into the future.

The waiting room maintains an average of 8.18 foot-candles, which exceeds the minimum light levels as recommended by the IESNA. Exit and emergency lighting are operational and meet the requirements of NFPA 101.

The fire alarm system meets the requirements of the ADA and NFPA 72.

STATION: Danbury
LINE: New Haven - Danbury Branch
INSPECTION DATE : January 24, 2002
INSPECTION AGENCY / FIRM: Parsons Brinckerhoff
INSPECTORS: J. Duncan & T. Abrahamson
TIME OF INSPECTION: A.M.
WEATHER: Light Rain

CONN. DEPT OF TRANSPORTATION
STATION INSPECTION REPORT
SHEET 11 OF 42

BUILDING -- HVAC - Fire Protection

Two small Weil McLain hot water boilers
Model HE II-5 Serial 1
BOILER: Natural Gas input 133,000 Btu/hr, Good Repair

Water Heater 50 gallon gas fired.
WATER HEATER: Good Repair

FUEL TYPE: natural gas

Units (2) in the attic, one unit for waiting area
and restrooms. The other unit is for the cafeteria and ticket office.
Each unit has a hot water heating coil and a cooling
coil. Good Repair
HEATING UNIT / FURNACE: coil. Good Repair

FUEL TYPE: N/A

HEATING FILTER: Filters in Good Repair

Units (2) in the attic, one unit for waiting area
and restrooms. The other unit is for the cafeteria and ticket office.
Each unit has a hot water heating coil and a cooling
coil. Good Repair
AC UNIT: coil. Good Repair

AC FILTER: Filters in Good Repair

DUCTS: Ducts in the attic insulated in Good Repair.

OF DAMPERS: N/A

CONDITION OF DAMPERS: N/A

Each area (each bathroom, waiting room, ticket room) has its own thermostat
not programmable type (Honeywell and Barber Colman), Good Repair
THERMOSTATS: not programmable type (Honeywell and Barber Colman), Good Repair

NIGHT SET BACK: None

PUMPS: Two hot water circulating pumps Model 1 GTS, Good Repair

PIPING: All in Good Repair, all insulated

STATION: Danbury
LINE: New Haven - Danbury Branch
INSPECTION DATE : January 24, 2002
INSPECTION AGENCY / FIRM: Parsons Brinckerhoff
INSPECTORS: J. Duncan & T. Abrahamson
TIME OF INSPECTION: A.M.
WEATHER: Light Rain

CONN. DEPT OF TRANSPORTATION
STATION INSPECTION REPORT
SHEET 12 OF 42

BUILDING -- HVAC - Fire Protection Cont.

Linear diffusers along the two windows/glass doors sides, Good Repair
Return grilles on the ceiling along the wall of the restrooms, Good Repair

One gas meter at the side of the building, Good Repair.

Outdoors

One large air cooled condenser on one side of the building, Make: Trane, Good Repair

Two small air cooled condensers outdoors at the opposite side of the building
Make: Trane XE-1000 Model TTRO24C100A1 Serial K3211LLAF, Good Repair

Fire Protection

Portable fire extinguishers are located in the equipment room and the ticket office.

STATION: Danbury
 LINE: New Haven - Danbury Branch
 INSPECTION DATE: January 24, 2002
 INSPECTION AGENCY / FIRM: Parsons Brinckerhoff
 INSPECTORS: J. Duncan & T. Abrahamson
 TIME OF INSPECTION: A.M.
 WEATHER: Light Rain

CONN. DEPT OF TRANSPORTATION
 STATION INSPECTION REPORT
 SHEET 13 OF 42

PLATFORM - PLUMBING

SPAN NO.	GUTTER	DOWNSPOUT/ PIPING	CLEAN-OUTS	SPAN NO.	GUTTER	DOWNSPOUT/ PIPING	CLEAN-OUTS
All	Platform rain canopy has welded gutters, which are heavy sheet metal. They require recaulking at seams.						
All	Downspouts are heavy sheet metal, painted in very good repair.						

PLATFORM - FIXTURES -- N/A

SPAN #: _____	SPAN #: _____	SPAN #: _____
MODEL: _____	MODEL: _____	MODEL: _____
YEAR: _____	YEAR: _____	YEAR: _____
MANUFACTURER: _____	MANUFACTURER: _____	MANUFACTURER: _____
CONDITION: _____	CONDITION: _____	CONDITION: _____

STATION: Danbury
LINE: New Haven - Danbury Branch
INSPECTION DATE : January 24, 2002
INSPECTION AGENCY / FIRM: Parsons Brinckerhoff
INSPECTORS: J. Duncan & T. Abrahamson
TIME OF INSPECTION: A.M.
WEATHER: Light Rain

CONN. DEPT OF TRANSPORTATION
STATION INSPECTION REPORT
SHEET 14 OF 42

BUILDING - PLUMBING

RESTROOM

PIPING: Insulated, Good Repair
WATER PRESSURE: Normal
DRAINS: Good Repair
FAUCET/FIXTURES:
* MODEL: unidentified
* YEAR: unidentified
* MANUFACTURER: unidentified
* CONDITION: Good Repair

Both restrooms are up-to-date, modern in complete conformance with ADA requirements and have water conservation fixtures

Women's Room

1 Handicapped Toilet - Good Repair
2 Regular Toilets - Good Repair
2 Lavatories with insulated pipes - Good Repair
Hot and cold water
Louvered door
Exhaust fan working
Floor drain - Good Repair
Recessed hot water cabinet heater with remote thermostat-Coleman - Good Repair
Thermostat is not properly calibrated, Good Repair

KITCHEN

PIPING: _____
WATER PRESSURE: _____
DRAINS: _____
FAUCET/FIXTURES: _____ N/A
* MODEL: _____
* YEAR: _____
* MANUFACTURER: _____
* CONDITION: _____

Water meter in equipment room - Good Repair
Slop sink in equipment room - Good Repair

In the waiting area there are two drinking fountains that are stainless steel, one regular, one handicapped, both in Good Repair

EXTERIOR

SPRINKLER:
FAUCET/FIXTURES: _____ N/A
* MODEL: _____
* YEAR: _____
* MANUFACTURER: _____
* CONDITION: _____

Men's Room

1 Handicapped Toilet - Good Repair
1 Handicapped Urinal - Good Repair
1 Regular urinal - Good Repair
1 Lavatory Regular - Good Repair
1 Lavatory with insulated pipes - Good Repair
Hot and cold water
Louvered door
Exhaust fan working
Floor drain - Good Repair
Recessed hot water cabinet heater with remote thermostat-Coleman- Good Repair
Thermostat is not properly calibrated, Good Repair

Building gutters and downspouts in Good Repair.
Downspouts are galvanized sheet metal, one is deteriorated at the bottom.

STATION: Danbury

CONN. DEPT OF TRANSPORTATION
STATION INSPECTION REPORT
SHEET 15 OF 42

INSPECTORS: J. Duncan, T. Abrahamson

DATE: January 24, 2002

STATION – MECHANICAL SUMMARY

The station was recently constructed. All the mechanical equipment is in excellent condition.

HVAC

The HVAC system is forced hot air and cooled air supplied from two HVAC units with a hot water (winter) and a chilled water (summer) coil. The HVAC system is split into two systems each having an air conditioning/heating unit. One unit works with one large air-cooled condenser; this unit serves the restrooms, equipment room and the large waiting area. There are linear supply diffusers and linear air return registers along the perimeter of the waiting area. There is a hot water recessed cabinet unit heater in each restroom and one hot water heater in the equipment room. Each area is equipped with a non-programmable thermostat. The second unit works with two smaller air-cooled condensers, serving the ticket office, and the kitchen area (at the present time not rented and unoccupied). Each area has its own thermostat, which is not programmable type. In these areas there is a two way diffuser and a 2'X2' air return grille.

There is a ¾" back flow preventer for the make-up water for the boiler exchanger, which is defective and is planned to be replaced by the town-engineering department.

Plumbing

The men's room and a women's room are in excellent condition. The plumbing system is in complete compliance with ADA requirements and has water conservation fixtures.

There are two drinking fountains located in the waiting area. One is handicapped accessible.

Storm Drainage for Building/Platform

Building gutters and downspouts are in good condition. The Platform has thick painted sheet metal gutters and downspouts. These are in good condition but require caulking at gutter seams.

STATION: Danbury
 LINE: New Haven-Danbury Branch
 INSPECTION DATE: May 10, 2002
 INSPECTION AGENCY/FIRM: Warren & Panzer Engineers
 INSPECTORS: Hortense Oliveira
 WEATHER: Good

CONN. DEPT OF TRANSPORTATION
 STATION INSPECTION REPORT
 SHEET 16 of 42

HAZARDOUS MATERIALS INSPECTION

LEAD-BASED PAINT

Note: The LBP inspection was conducted using an RMD LPA-1 spectrum X-Ray Fluorescence Analyzer (XRF). The Department of Housing and Urban Development (HUD) recommend XRF analysis for inspection of lead in paint. XRF readings were taken of surfaces coated with suspect LBP. The XRF was operated in "Quick Mode" for this project. In Quick Mode, the measurement time is determined by the LPA-1 Analyzer to achieve a 95% confidence measurement compared to an action level (1.0 mg/cm2).

Platform

Surfaces Tested	# of Locations Tested	Lead Presence (>1 mg/cm2)	Rating
Canopy Columns	3	No	3
Platform Warning Strip	1	No	3
Canopy Beams	2	No	4

Station Building

Surfaces Tested	# of Locations Tested	Lead Presence (>1 mg/cm2)	Rating
Walls	4	No	4
Door Frames	1	No	4
Radiator Covers	1	No	4

Surfaces Tested	# of Locations Tested	Lead Presence (>1 mg/cm2)	Rating
Concrete Barricade	4	No	2
Ramp Hand Rails	1	No	4

SUSPECT ASBESTOS-CONTAINING MATERIALS

Listed below are suspect asbestos-containing materials that were observed during a visual inspection. Materials were found to be in fair to good condition. Any future disturbance of these materials should be preceded by the collection of samples and laboratory analysis of these samples. This work must be performed by a certified inspector.

Platform

Suspect Materials	Rating
Caulking on Canopy Beams	3
Yellow Warning Strip Line Caulking	3
Caulking at Base of Canopy Metal Columns	3

Station House

Suspect Materials	Rating
Caulking at the Perimeter Base of Building	3
Roof Shingles	3
Window Frame Caulking	3

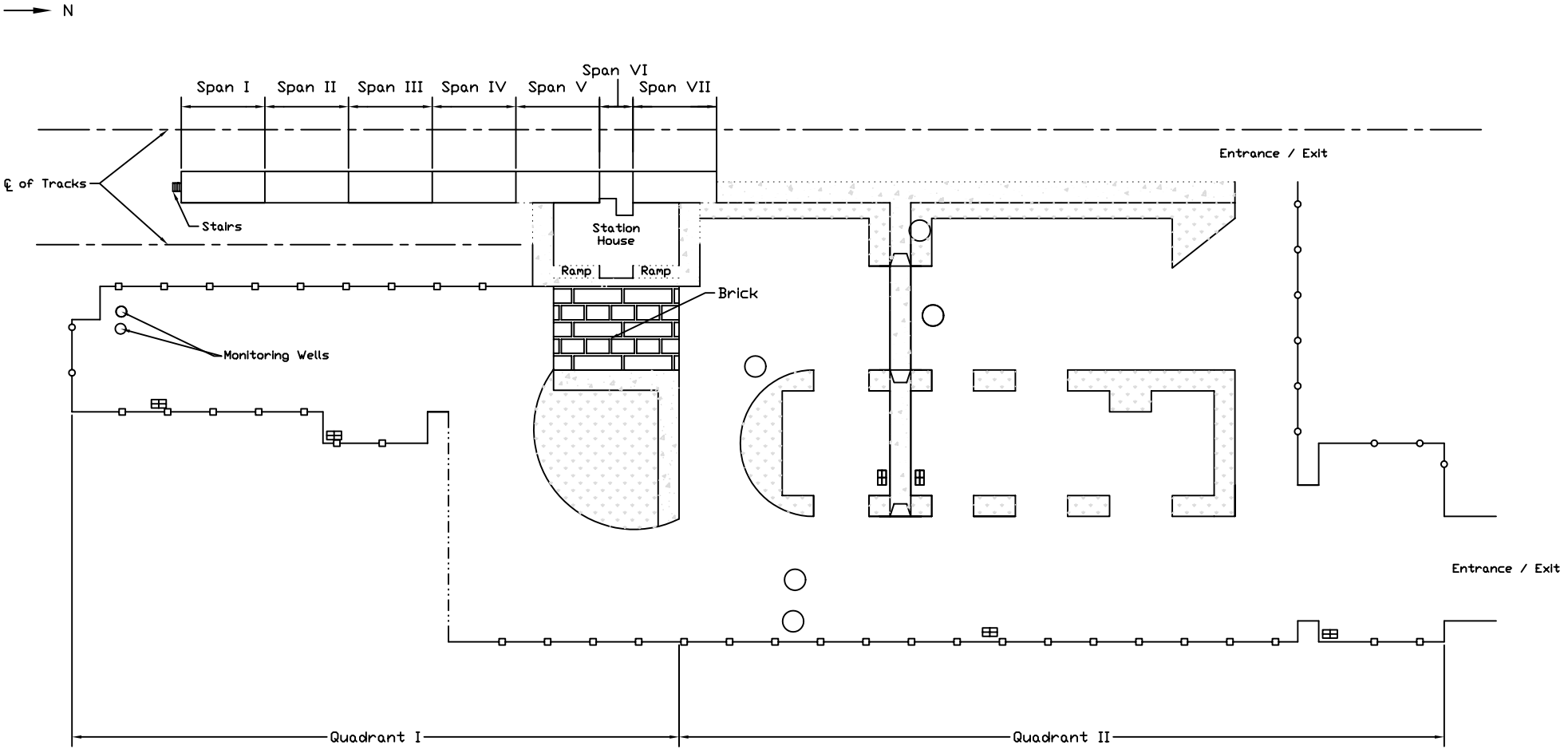

- Legend:
- Fence
 - Fence and Guard Railing
 - - - - - Guard Railing
 - Pedestrian Railing
 - Grass
 - Sidewalk
 - Sanitary Manhole
 - ▤ Drain
 - △ Ramp

Urbitran Associates, Inc.
Connecticut Dept. of Transportation
Danbury Station General Layout
Date: 12-04-01

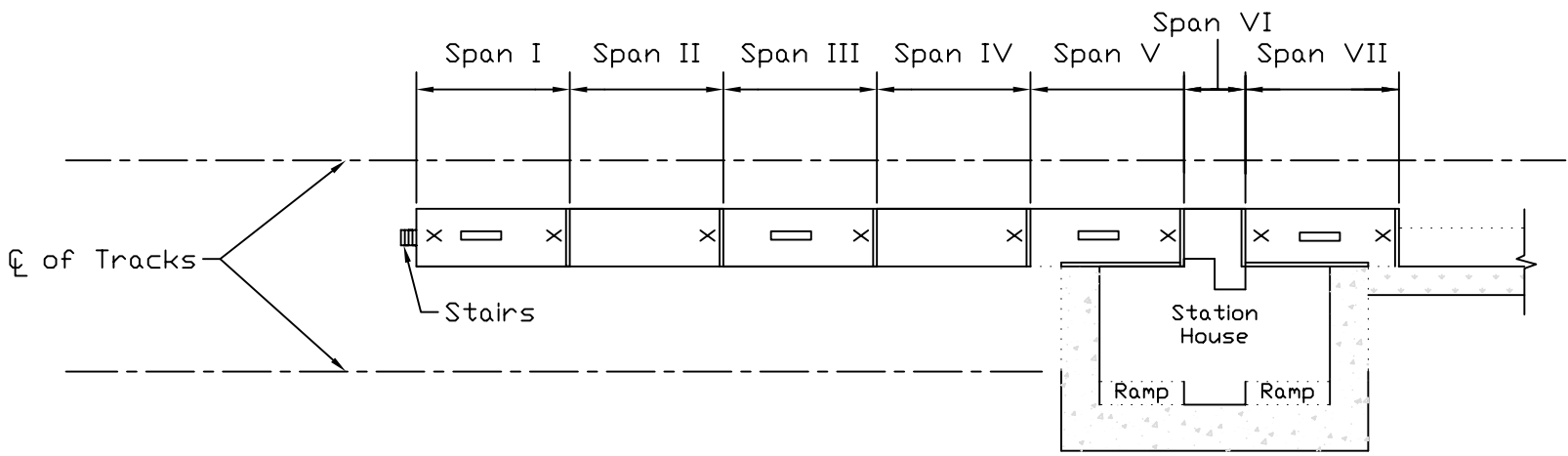

- Legend:**
- Pedestrian Railing
 - [] Grass
 - [] Sidewalk
 - Joint
 - X Canopy Column
 - [] Sign

NOTES:

1. Top of the platform exhibits 25% map cracking in Span VI

Urbitran Associates, Inc.
Connecticut Dept. of Transportation
Danbury Station Platform Plan
Date: 12-04-01

→ N

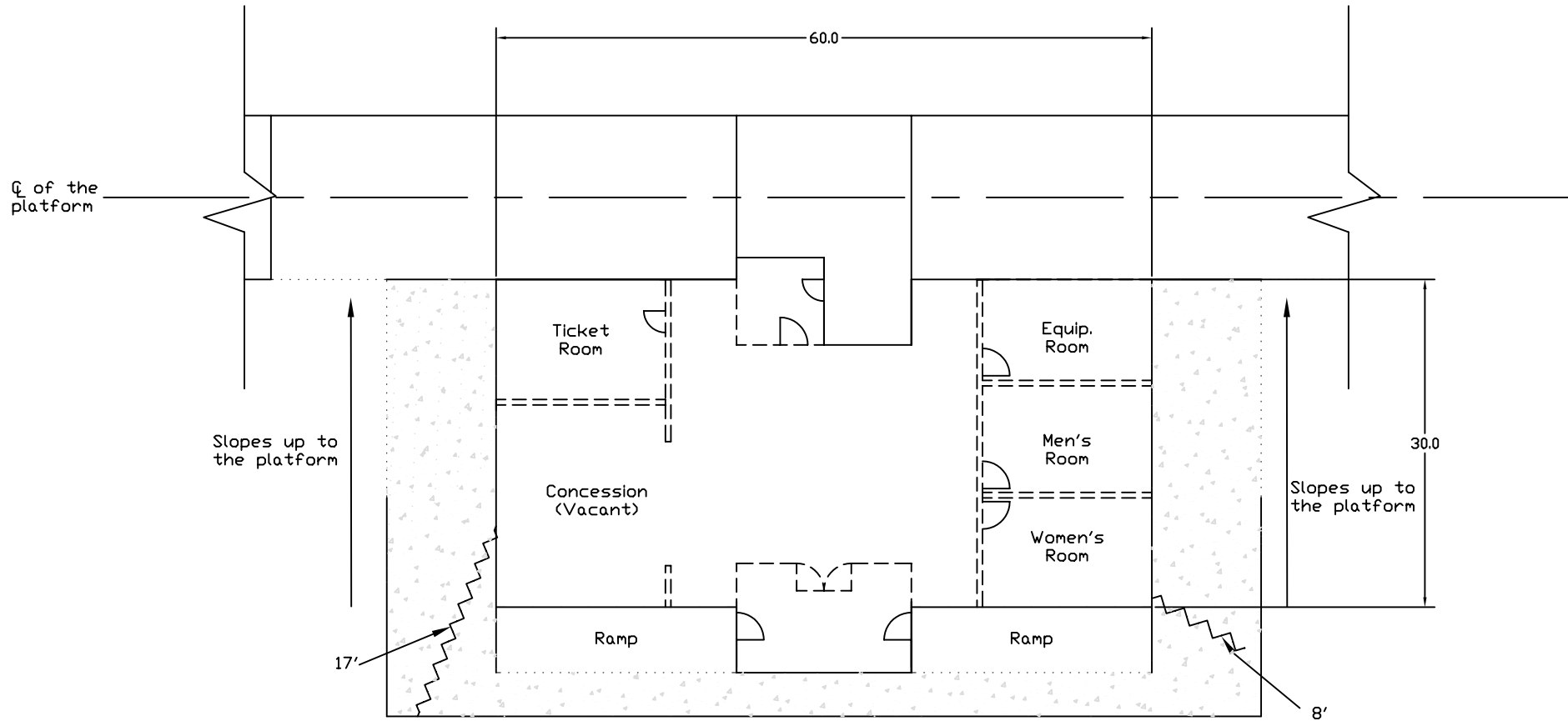

- Legend:
- Pedestrian Railing
 - ~~~~~ Cracks
 - ▭ Sidewalk

- NOTES:
1. A lock to a bathroom stall is missing in both the men's and women's room.

Urbitran Associates, Inc.
Connecticut Dept. of Transportation
Danbury Station Building Plan
Date: 12-05-01

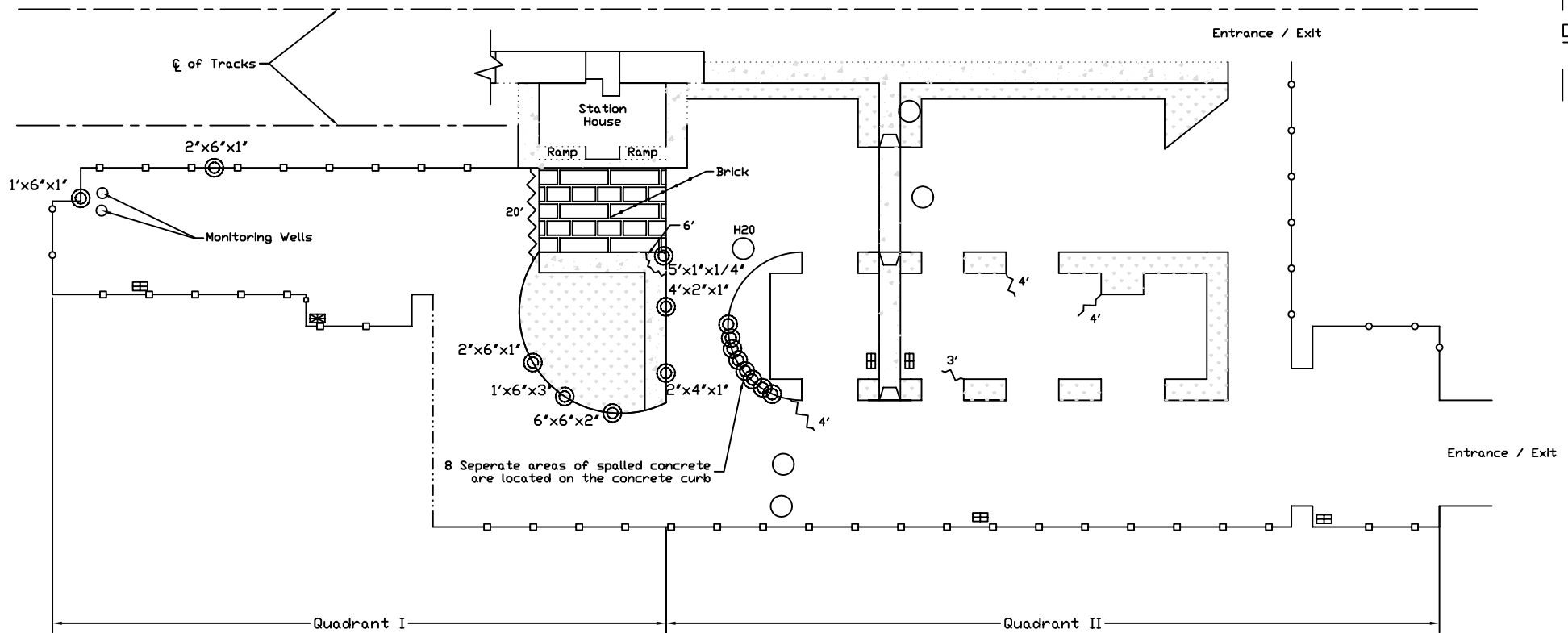

- Legend:**
- Fence
 - Fence and Guard Railing
 - · — · — Guard Railing
 - · · · · — Pedestrian Railing
 - / / / / — Cracks
 - Grass
 - Sidewalk
 - Sanitary Manhole
 - ▣ Drain
 - ▣ Drain covered with vegetation and garbage
 - ⊙ Spalled area
 - ▵ Ramp

NOTES:

- The concrete sidewalk on the West side exhibits typical rusting and cracks below the railing.

Urbitran Associates, Inc.
Connecticut Dept. of Transportation
Danbury Station Parking Plan
Date: 12-04-01

CONN. DEPT OF TRANSPORTATION
STATION INSPECTION REPORT
SHEET 22 OF 42

PHOTO NO. 1

Location: _____
South end of Quad II

Description: _____
General view of Quad I

Reference: _____
Looking South



PHOTO NO. 2

Location: _____
Southeast corner of
Quad II

Description: _____
General view of Quad I

Reference: _____
Looking Southwest



STATION: Danbury

INSPECTORS: WV, RGW

CONN. DEPT OF TRANSPORTATION
STATION INSPECTION REPORT
SHEET 23 OF 42

PHOTO NO. 3

Location: _____
South end of Quad I

Description: _____
General view of Quad I

Reference: _____
Looking North



PHOTO NO. 4

Location: _____
Southwest corner of
Quad I

Description: _____
General view of Quad I

Reference: _____
Looking Northeast



STATION: Danbury

INSPECTORS: WV, RGW

CONN. DEPT OF TRANSPORTATION
STATION INSPECTION REPORT
SHEET 24 OF 42

PHOTO NO. 5

Location: _____
North end of Quad II

Description: _____
General view of Quad II

Reference: _____
Looking South



PHOTO NO. 6

Location: _____
South end of Quad II

Description: _____
General view of Quad II

Reference: _____
Looking North



STATION: Danbury

INSPECTORS: WV, RGW

CONN. DEPT OF TRANSPORTATION
STATION INSPECTION REPORT
SHEET 25 OF 42

PHOTO NO. 7

Location: _____
Westside of Quad II

Description: _____
General view of Quad II

Reference: _____
Looking Southeast



PHOTO NO. 8

Location: _____
Westside of Quad II

Description: _____
General view of Quad II

Reference: _____
Looking Northeast



STATION: Danbury

INSPECTORS: WV, RGW

CONN. DEPT OF TRANSPORTATION
STATION INSPECTION REPORT
SHEET 26 OF 42

PHOTO NO. 9

Location: _____
Eastside of Quad II

Description: _____
General view of Quad II

Reference: _____
Looking Northwest



PHOTO NO. 10

Location: _____
Eastside of Quad II

Description: _____
General view of Quad II

Reference: _____
Looking West



STATION: Danbury

INSPECTORS: WV, RGW

CONN. DEPT OF TRANSPORTATION
STATION INSPECTION REPORT
SHEET 27 OF 42

PHOTO NO. 11

Location: _____
Span VI of the platform

Description: _____
General view of the platform

Reference: _____
Looking North



PHOTO NO. 12

Location: _____
South end of the platform

Description: _____
General view of the platform

Reference: _____
Looking North



STATION: Danbury

INSPECTORS: WV, RGW

CONN. DEPT OF TRANSPORTATION
STATION INSPECTION REPORT
SHEET 28 OF 42

PHOTO NO. 13

Location: Middle of the North end of Quad I

Description: General view of the exterior East elevation of the station house

Reference: Looking West



PHOTO NO. 14

Location: Westside of Quad II

Description: Typical view of the stripping in Quad II that is slightly faded

Reference: Looking North



STATION: Danbury

INSPECTORS: WV, RGW

CONN. DEPT OF TRANSPORTATION
STATION INSPECTION REPORT
SHEET 29 OF 42

PHOTO NO. 15

Location: _____
South end of the
platform

Description: _____
Typical view of the
canopy

Reference: _____
Looking North



PHOTO NO. 16

Location: _____
Span I of the platform

Description: _____
Typical view of the
rubbing board, warning
strip, and an expansion
joint

Reference: _____
Looking North



STATION: Danbury

INSPECTORS: WV, RGW

CONN. DEPT OF TRANSPORTATION
STATION INSPECTION REPORT
SHEET 30 OF 42

PHOTO NO. 17

Location: _____
South island in Quad II

Description: _____
Typical spalled concrete
area (6" x 4" x 1") along
the curb

Reference: _____
Looking North



PHOTO NO. 18

Location: _____
Eastside of Quad I,
close to the Northside
Quad I

Description: _____
Garbage and vegetation
covering the drain

Reference: _____
Looking East



STATION: Danbury

INSPECTORS: WV, RGW

CONN. DEPT OF TRANSPORTATION
STATION INSPECTION REPORT
SHEET 31 OF 42

PHOTO NO. 19

Location: North end of Quad I

Description: 6' crack and spalled concrete curb (5'x1"x1/4") on the Northwest corner of the island in front of the station house

Reference: Looking Southeast



PHOTO NO. 20

Location: Southside of Quad II

Description: 4' crack extending from the Northeast corner of the South island in Quad II

Reference: Looking West



STATION: Danbury
INSPECTORS: WV, RGW

CONN. DEPT OF TRANSPORTATION
STATION INSPECTION REPORT
SHEET 32 OF 42

PHOTO NO. 21

Location: _____
Westside railing in
Quad II

Description: _____
Rust and an 8 inch
crack extending from
bottom of the railing
post, typical throughout
the railing

Reference: _____
Looking West



PHOTO NO. 22

Location: _____
Westside railing in
Quad II

Description: _____
Rust, spalled concrete,
and cracking exhibited
at the base of the railing
post

Reference: _____
Looking down



STATION: Danbury

INSPECTORS: WV, RGW

CONN. DEPT OF TRANSPORTATION
STATION INSPECTION REPORT
SHEET 33 OF 42

PHOTO NO. 23

Location: _____
Middle of the woman's
bathroom

Description: _____
Missing lock on
the handicap stall

Reference: _____
Looking North



PHOTO NO. 24

Location: _____
Northwest corner of
Quad I

Description: _____
20' crack along the
Southside of the brick
in front of the station
house

Reference: _____
Looking East



STATION: Danbury

INSPECTORS: WV, RGW

CONN. DEPT OF TRANSPORTATION
STATION INSPECTION REPORT
SHEET 34 OF 42

PHOTO NO. 25

Location: _____
South end of the
platform

Description: _____
Broken timber rubbing
board (3" x 3" x 2")

Reference: _____
Looking down



PHOTO NO. 26

Location: _____
Eastside of Span VI

Description: _____
25% map cracking in
Span VI

Reference: _____
Looking West



STATION: Danbury

INSPECTORS: WV, RGW

CONN. DEPT OF TRANSPORTATION
STATION INSPECTION REPORT
SHEET 35 OF 42

PHOTO NO. 27

Location: _____
Northeast corner of
the sidewalk around the
station house

Description: _____
8' crack extending from
the Northeast corner of
the sidewalk

Reference: _____
Looking Southwest



PHOTO NO. 28

Location: _____
Northwest corner of
Quad I

Description: _____
17' crack extending to
from the curb to the
South face of the
station house

Reference: _____
Looking West



STATION: Danbury

INSPECTORS: WV, RGW

CONN. DEPT OF TRANSPORTATION
STATION INSPECTION REPORT
SHEET 36 OF 42

PHOTO NO. 29

Location:
parking lot

Description:
electrical utility
service pole

Reference:
Station Building
Service Section



PHOTO NO. 30

Location:
building waiting
room

Description:
waiting room
lighting

Reference:
Station Building
Lighting Section



STATION: Danbury
INSPECTORS: Jim Connell & Dave Lang

CONN. DEPT OF TRANSPORTATION
STATION INSPECTION REPORT
SHEET 37 OF 42

PHOTO NO. 31

Location:
building break
room

Description:
lighting

Reference:
Station Building
Lighting Section



PHOTO NO. 32

Location:
platform

Description:
lighting

Reference:
Platform Lighting
Section



STATION: Danbury
INSPECTORS: Jim Connell & Dave Lang

CONN. DEPT OF TRANSPORTATION
STATION INSPECTION REPORT
SHEET 38 OF 42

PHOTO NO. 33

Location:
DANBURY
STATION

Description:
Side of building
with deteriorated
downspouts

Reference:
Mechanical



PHOTO NO. 34

Location:
COMMON/
WAITING ROOM

Description:
Drinking water
fountains,
one handicapped
accessible

Reference:
Mechanical



STATION: DANBURY
INSPECTORS: J. Duncan & T. Abrahamson

CONN. DEPT OF TRANSPORTATION
STATION INSPECTION REPORT
SHEET 39 OF 42

PHOTO NO. 35

Location:
COMMON/
WAITING ROOM

Description:
Linear
Diffusers at
ceiling side
along glass

Reference:
Mechanical



PHOTO NO. 36

Location:
ATTIC

Description:
Heating and
airconditioning
fabricated unit

Reference:
Mechanical



STATION: DANBURY
INSPECTORS: J. Duncan & T. Abrahamson

CONN. DEPT OF TRANSPORTATION
STATION INSPECTION REPORT
SHEET 40 OF 42

PHOTO NO. 37

Location:
EQUIPMENT
ROOM

Description:
Backflow
preventer for
heating makeup
water

Reference:
Mechanical

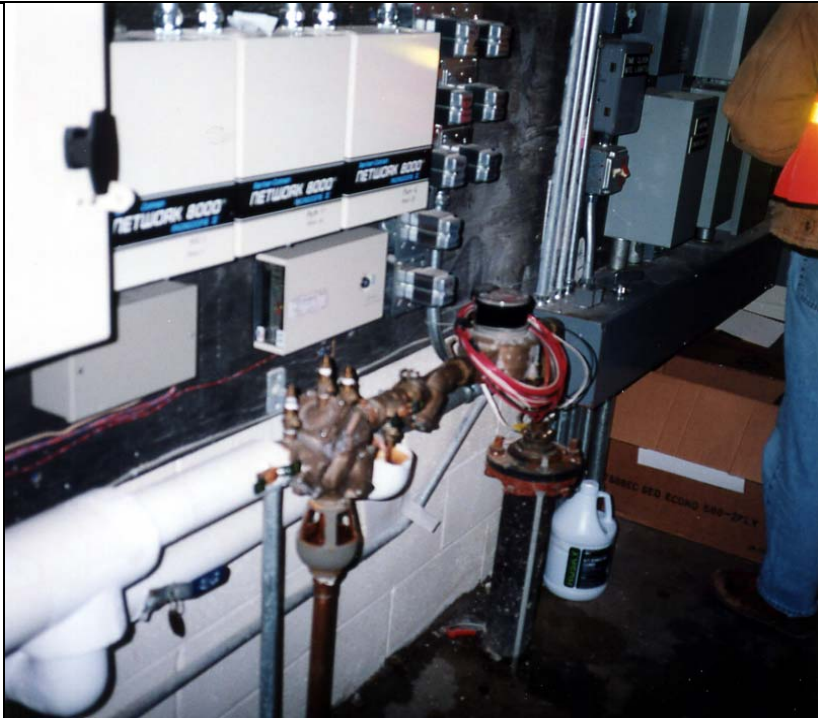

PHOTO NO. 38

Location:
EQUIPMENT
ROOM

Description:
Hot water
heat exchanger,
all pipes insulated

Reference:
Mechanical



STATION: DANBURY
INSPECTORS: J. Duncan & T. Abrahamson

CONN. DEPT OF TRANSPORTATION
STATION INSPECTION REPORT
SHEET 41 OF 42

PHOTO NO. 39

Location:
EQUIPMENT
ROOM

Description:
Two Weil McLain
gas boilers and
two hot water
circulating pumps

Reference:
Mechanical



PHOTO NO. _____

Location: _____

Description: _____

Reference: _____

STATION: DANBURY
INSPECTORS: J. Duncan & T. Abrahamson

Danbury Station				
Description *	Units	Quantity	Price / Unit	Total Cost
Sub-total				0.00
Contingency (10%)				0.00
Grand Total				0.00

* The extent of deterioration noted during our inspection is minimal and does not require immediate repair. The type of extent of deterioration will not affect the station operations or commuters. Therefore, we recommend the that defects noted in this report be included in a future station maintenance rehabilitation contract.