

*1997*  
***CONNECTICUT - RHODE ISLAND  
BOUNDARY LINE PERAMBULATION***



*Prepared by*  
***CONNECTICUT DEPARTMENT OF TRANSPORTATION  
SURVEY OPERATIONS  
(DISTRICT II)***

# CONNECTICUT - RHODE ISLAND STATE LINE PERAMBULATION LIMITS OF REPORT

M A S S A C H U S E T T S

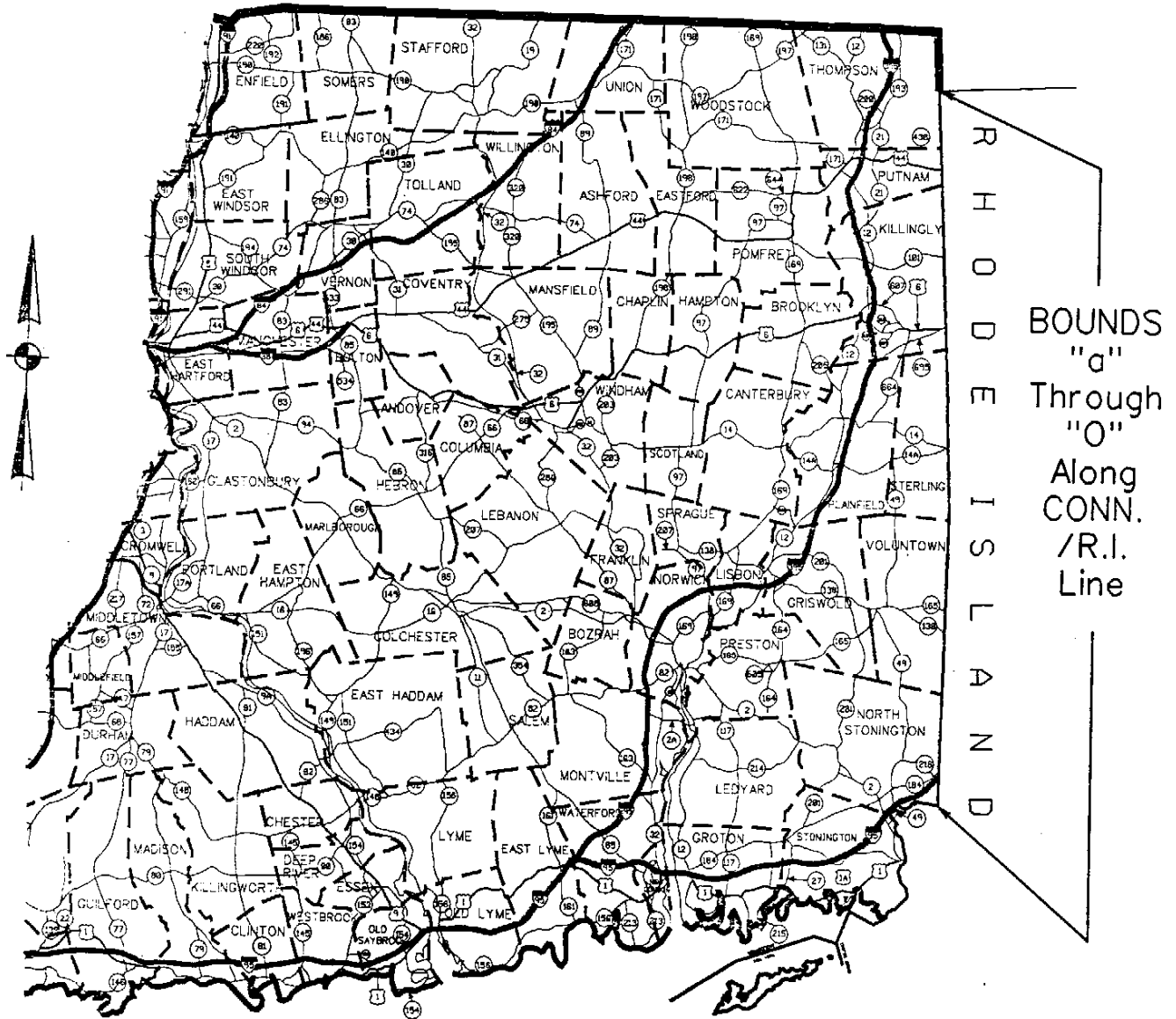

1997

CONNECTICUT- RHODE ISLAND STATE BOUNDARY LINE PERAMBULATION  
CONNECTICUT DEPARTMENT OF TRANSPORTATION

# ***CONNECTICUT - RHODE ISLAND STATE LINE PERAMBULATION SURVEY***

## ***Introduction & Description of Work***

Pursuant to Section 3-8 of the Connecticut General Statutes (Appendix A), the Connecticut – Rhode Island State Line Perambulation Survey has been performed by the Connecticut Department of Transportation. This report represents the portion of this survey traditionally completed by District 2 Surveys. The scope of work covered by this report extends from the Ashaway River (Bound a), northerly to the northwest corner of Rhode Island (Tri-State Bound 1).

Using the written description from the previous (1986) Perambulation Survey, each bound was visited. The current condition of the bound and its immediate surroundings were noted. The descriptions were revised as necessary and any radical changes were more particularly described.

General notes on the written descriptions for each bound are as follows:

Descriptions have been prepared on the basis of approaching each bound as closely as possible by vehicle. All mileage has been checked in the field, but are approximate.

All dimensions in the description, used to approach or find the monuments, are “over the ground” distances.

All geographic positions are referred to the 1927 North American Datum, as computed by the U.S.C.&G.S.

All information on bounds north of the bolt in the rock at the mouth of the Ashaway River were obtained from the 1840 Survey, the 1915 Perambulation, the Connecticut Geodetic Survey of 1938-39 and the 1941 report of the State Agents.

In referring to highway route number and road names in the descriptions, the route numbers and road names, shown on the town road maps accompanying the descriptions, have been used.

### *Description of Work, continued*

Bounds with remote locations are additionally shown on sketches. Some of these sketches include a more particular description of the route from the vehicle or roadway to the bound using approximate directions and distances at described stations. These compass bearing/distance courses were followed during the current survey and appropriate changes, corrections and additions were made.

Two photographs of each bound were taken when the bounds were visited, using 35mm color film. The photographs were developed with both standard prints and digital disk copy.

### *Report Preparation*

This report was assembled using Microsoft Word 97 software. The written description portion of the report was scanned from the previous perambulation report and run through optical character recognition software to make them live text documents for inclusion in the word processing report. The descriptions could then be revised as necessary without complete retyping. The sketches were first manually revised as needed and then scanned and inserted into Microsoft Word 97.

The digital photographs were stored as separate files and inserted into the word processing document. They were labeled and included within the report. Index maps were produced using Delorme Street Atlas USA 4.0 software. These key maps were labeled, stored separately and later collated into the report. All index maps are oriented with north pointing toward the top of the page.

Copies of this report were transferred to CD-ROM format to expedite future revisions. The CD-ROM will accompany the official distribution of this report.

## INDEX

<u>Section</u>	<u>Bounds</u>	<u>Town/Towns</u>	<u>Pages</u>
1	<i>a, b, c, d, d-1</i>	<b>North Stonington</b>	1-14
2	<i>e, f, g, h</i>	<b>North Stonington</b>	15-25
3	<i>i, j, k, l, m</i>	<b>Voluntown</b>	26-34
4	<i>n, o, p, p-1</i>	<b>Voluntown-Sterling</b>	35-44
5	<i>q, r, v11-50, s</i>	<b>Sterling</b>	45-53
6	<i>t, u, v, w</i>	<b>Sterling-Killingly</b>	54-66
7	<i>x, y, z, A</i>	<b>Killingly</b>	67-74
8	<b>B, C, C-1, D, E</b>	<b>Killingly</b>	75-85
9	<b>F, F-1, G, H, I, J, K</b>	<b>Killingly-Putnam-Thompson</b>	86-101
10	<b>L, L-1, M, N, O</b>	<b>Thompson</b>	102-114

**Appendix A** - Connecticut General Statutes, Section 3-8 (Restoration and repair of State Boundary Marks)

**Appendix B** - Boundary agreement between Connecticut & Rhode Island ratified in 1840.



# CT / RI LINE - SECTION 1

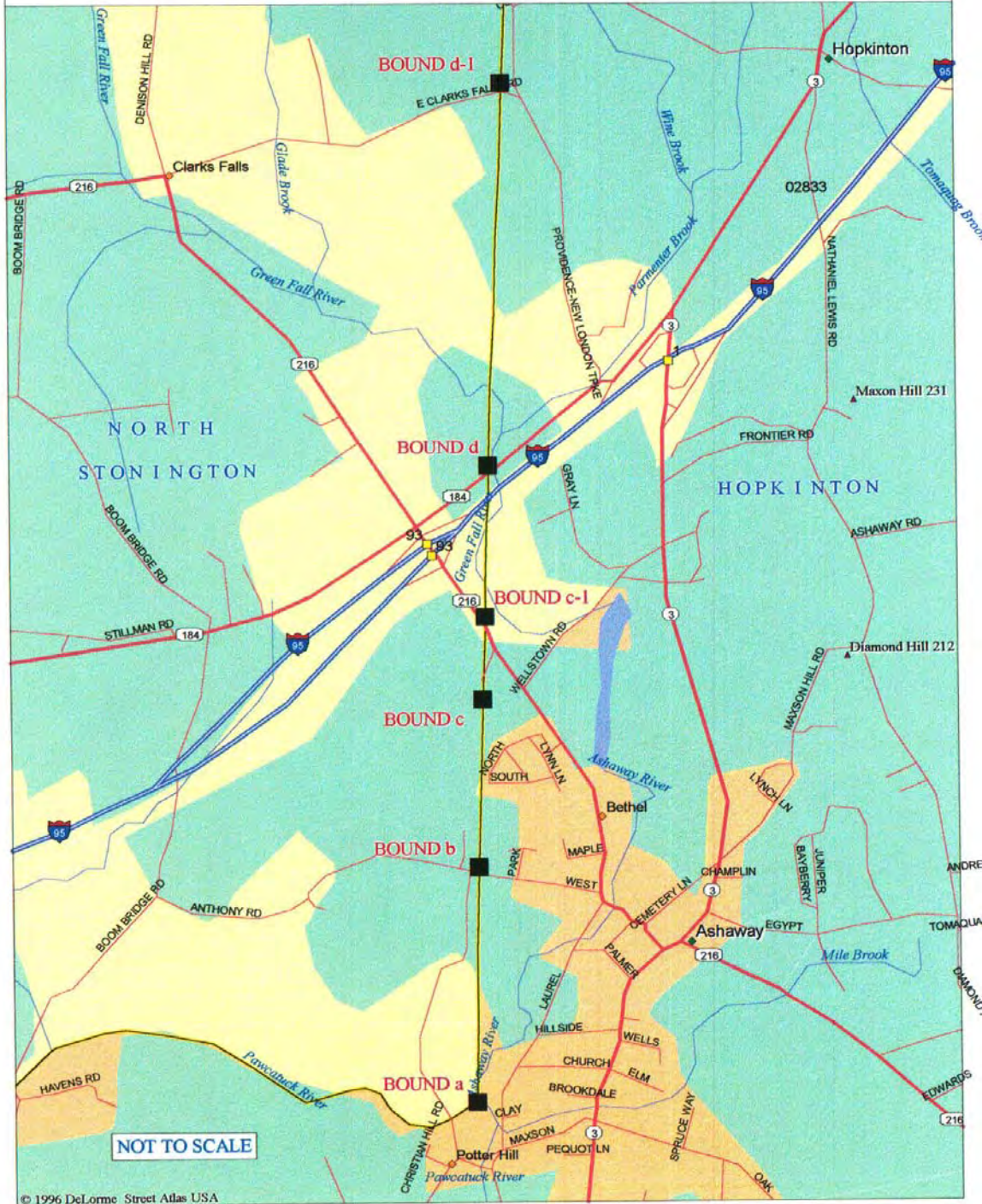

ANGLE BOUND *a***BOLT IN THE ROCK AT THE MOUTH OF THE ASHAWAY**

## REGULATION BRASS BOLT AND PLATE

## INTERIOR ANGLE

Beginning at the intersection of Connecticut Route 216 and the southbound lane of Interstate 95 in the town of North Stonington, proceed southeasterly 1.25 miles on Route 216 to a "Y" type intersection in the town of Ashaway, Rhode Island. Bear to the right and proceed southerly on Laurel Street (see sketch) 0.9 miles to a bridge crossing the Pawcatuck River. Continue northwesterly over the bridge into the village of Potter Hill, a distance of 342 feet, to a gravel drive on the right. Said drive runs parallel to the westerly side of a frame building. Proceed northerly 0.11 miles, bearing left on the gravel drive, to a barway in a residential back yard. From said barway, cross a farm bridge over Pawcatuck River.

From the north end of the bridge, proceed N 60° E, 386 feet along the north bank of the river, at the south side of a pasture, to a small brook just east of the edge of scrub woodland. Proceed N 80° E, 230 feet along the north bank of the river, through scrub woodland, to the mouth of the Ashaway River and bound.

Bound is located in a coarse granite boulder, approximately 10' X 12', almost surrounded by the Ashaway River above which it projects 6 feet. It is against the westerly bank of the Ashaway River, about 35 feet northwest of a point of land lying between two streams at the mouth of the Ashaway River.

Bound is marked by a square wrought iron bolt, showing 13 inches above the boulder, and a regulation brass bolt and plate set 3 inches north of the old bolt. The wrought iron bolt was presumably set in 1839. The brass bolt and plate were set December 12, 1923.

The 1941 commissioners accepted the regulation brass bolt and plate as correctly marking a point on the line established in 1840.

Bound *b* - 3,444 feet north

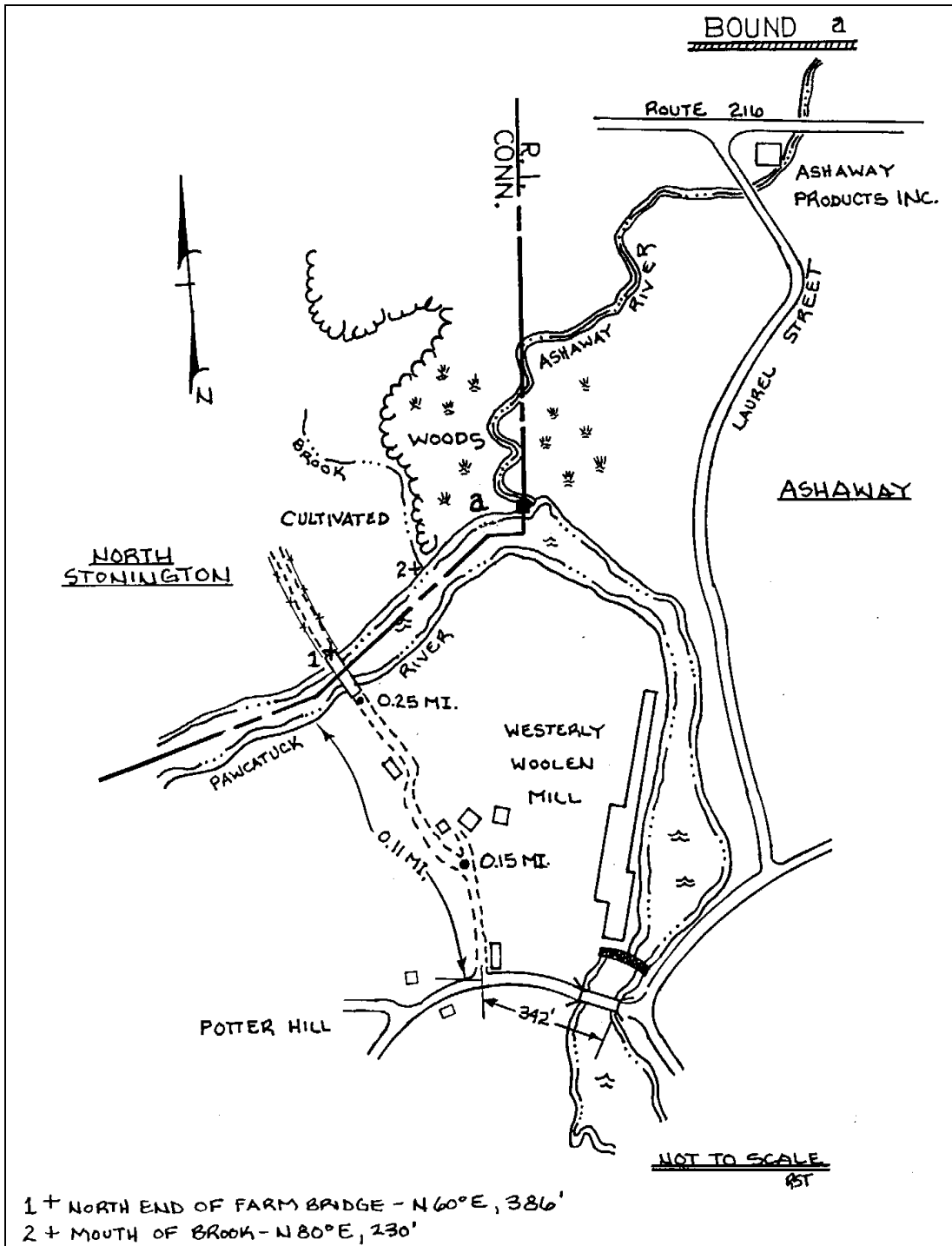

1997

CONNECTICUT- RHODE ISLAND STATE BOUNDARY LINE PERAMBULATION  
CONNECTICUT DEPARTMENT OF TRANSPORTATION





**AERIAL VIEW**



**EASTERLY VIEW**

LINE BOUND *b*

## ROUGH GRANITE MONUMENT

## PAVED HIGHWAY

Beginning under the southbound span of Interstate 95 on Connecticut Route 216 in the town of North Stonington, proceed south-southeasterly 1.2 miles on Route 216 (Clarks Falls Road) to the intersection with West Street on the right in the village of Ashaway, Rhode Island. Proceed northwesterly on West Street 0.35 miles to the bound on the right.

Bound is located 16.5 feet north of the center of the traveled way. Residences are north of the highway, with field on the south sloping away slightly to a pond. Highway is level opposite the bound.

A rough split granite monument, showing 3.7 feet above the ground, marks the bound. It is red Westerly (Rhode Island) granite and measures 13" X 8" at the ground and 9" X 9" at the top. It is lettered "RI" on the east face and "C" on the west face. Bound has a large chip in the southwest top corner and is leaning east.

The 1941 commissioners accepted the monument as correctly marking a point on the line established in 1840.

Bound *a* - 3,444 feet south  
Bound *c* - 2,662 feet north



**NORTHWESTERLY VIEW**



**NORTHWESTERLY VIEW**

LINE BOUND C

## REGULATION GRANITE MONUMENT

## FARM ROAD

Beginning at the intersection of Connecticut Routes 184 and 216 in the town of North Stonington, proceed southeasterly 0.51 miles on Route 216 to a bituminous drive on the right. Proceed southwesterly on said drive for 500 feet, just beyond metal buildings. Monument is near the southwest corner of the bituminous parking area.

Bound is located 44 feet north of a stone wall, 86 feet west of the range of the west side of the most southerly of three metal buildings and 140 feet southwest of the northwest corner of the same building.

Bound is marked by a regulation granite monument 9 feet long and showing 4 feet above ground level. It is 12" X 12" and lettered "RI" on the east face, "CONN" on the west face and "1990" on the north face. Bound has a 5/8" drill hole, 1 1/2" deep in the top.

Bound was set on November 19, 1990, replacing the destroyed monument in the same horizontal position, using the 1970 coordinates.

The 1941 commissioners accepted the monument as correctly marking a point on the line established in 1840.

Bound *b* - 2,662 feet south  
Bound *c-1* - 1,320 feet north  
Bound *d* - 3,452 feet north



**SOUTHWESTERLY VIEW**



**EASTERLY VIEW**



UNOFFICIAL BOUND C-1

ROUGH GRANITE MONUMENT

PAVED HIGHWAY

Beginning under the southbound span of Interstate 95 on Connecticut Route 216 in the town of North Stonington, proceed south-southeasterly 0.3 miles on Connecticut Route 216 (Clarks Falls Road) to bound on left.

Bound is located 17 feet northeast of the center of the traveled way, on the fringe of a large spruce tree. There are mobile homes northeast and southwest of the bound. A Connecticut Department of Transportation boundary marker is located 2.5 feet north of said state line bound. Highway is level opposite the bound, with a residence located to the northwest. There is a narrow strip of lawn beyond which woodland drops away to the Ashaway River.

Bound is marked by a neatly split granite monument, showing 2.2 feet above the ground. It measures 8" X 8" and is lettered "B" on the southwest face. Bound is broken 15 inches below the ground.

No bound was established in this area in 1840 and the 1941 commissioners agreed that the monument should not be considered as marking a point on the line established in 1840.

Bound *c* - 1,320 feet south  
Bound *d* - 2,132 feet north



**NORTHEASTERLY VIEW**



**NORTHERLY VIEW**

LINE BOUND *d*

RAILROAD SPIKE

PAVED HIGHWAY

Beginning at the intersection of Connecticut Routes 184 and 216 in the town of North Stonington, proceed northeasterly 0.25 miles on Route 184 to the bound.

Bound is located 15 feet northwest of the center of the traveled way. It is 45.99 feet southwest of the southeast corner of the north bridge abutment and 60.65 feet west of the northwest corner of the south bridge abutment. Scrub woodland drops away on both sides of the highway.

Bound is marked by a railroad spike set in the bituminous pavement. This spike was set on November 1, 1990 from the bridge ties shown above.

The railroad spike was tied in using brass bolts and CHDs. The angles and distances were recorded in District II field book number 1, page 30.

The 1941 commissioners accepted the monument as correctly marking a point on the line established in 1840.

Bound *c* - 3,452 feet south  
 Bound *d - I* - 6,156 feet north  
 Bound *e* - 7,591 feet north



**AERIAL VIEW**



**NORTHEASTERLY VIEW**

LINE BOUND *d-1*

REGULATION GRANITE MONUMENT

PAVED HIGHWAY

Beginning at the intersection of Denison Hill Road, Connecticut Route 216 and East Clarks Falls Road in the village of Clarks Falls, proceed northeasterly on East Clarks Falls Road 1.02 miles to location of bound on the left.

Bound is located 41 feet north of the center line of the road, 57 feet east of a stone wall (said wall running north to south), and 105.5 feet northwest of the northwest corner of house number 127.

A regulation granite monument measuring 9 feet long and showing 4 feet above the ground level marks the bound. It is 12" X 12" and lettered "RI" on the east face, "CONN" on the west face and "1990" on the north face. Bound has a 5/8" drill hole, 1 1/2 inches deep in the top.

Bound was set November 26, 1990, 29.14 feet north of the original location, which fell in the bituminous pavement.

The 1941 commissioners accepted the monument as correctly marking a point on the line established in 1840.

Bound *d* - 6,156 feet south  
Bound *e* - 1,435 feet north





**EASTERLY VIEW**



**EASTERLY VIEW**

# CT / RI LINE - SECTION 2

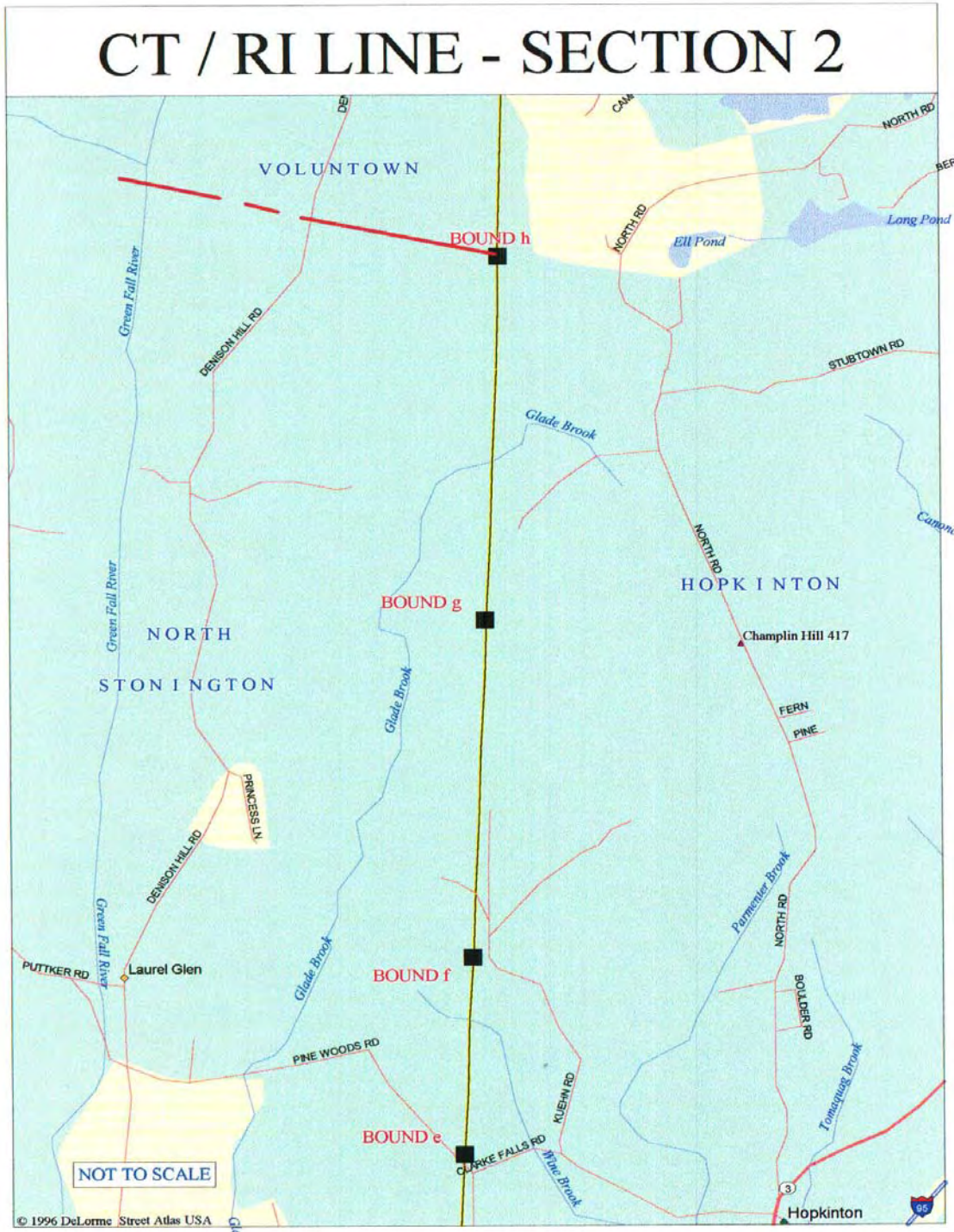

1997

CONNECTICUT- RHODE ISLAND STATE BOUNDARY LINE PERAMBULATION  
CONNECTICUT DEPARTMENT OF TRANSPORTATION

LINE BOUND *e*

## ROUGH GRANITE MONUMENT

## GRAVEL ROAD

Beginning at the intersection of Denison Hill Road, Connecticut Route 216 and East Clarks Falls Road (Clarks Falls Road in Rhode Island) in the village of Clarks Falls, proceed northeasterly on East Clarks Falls Road 1.35 miles to a gravel road on the left called Pine Woods Road. Proceed northwesterly on said gravel road 0.05 miles to bound on the right.

Bound is located 11 feet northeast of the center line of gravel road, 12.6 feet southwest of triangulation station "HOPKINS", 84 feet north of the northeast corner of wire fencing surrounding a swimming pool, and 240 feet northwest of East Clarks Falls Road.

Bound is marked by a roughly split granite monument, with north and east corners broken off, showing 3 feet above the ground level. It is 5 1/2 feet long and is 12" X 10". It is lettered "RI" on the east face and "C" on the west face.

The 1986 Perambulation Survey determined that the monument was loose and possibly broken below the ground. On October 18, 1990, the badly leaning monument was lowered about one foot and reset. The drill hole in the top was redrilled.

The 1941 commissioners accepted the monument as correctly marking a point on the line established in 1840.

Bound *d* - 7,591 feet south  
 Bound *d-1* - 1,435 feet south  
 Bound *f* - 3,429 feet north





**NORTHEASTERLY VIEW**



**NORTHERLY VIEW**

LINE BOUND *f*

## ROUGH GRANITE MONUMENT

## INTERIOR INTERMEDIATE POINT

Beginning at the intersection of Denison Hill Road, Connecticut Route 216 and East Clarks Falls Road in the village of Clarks Falls, proceed northeasterly 1.65 miles on East Clarks Falls Road (Clarks Falls Road in Rhode Island) to the intersection with Kuehn Road on the left. (See sketch following bound "*g*" description). Proceed northerly on Kuehn Road to a gravel drive on the left between NET&T pole numbers 2775 and 2776, a distance of 0.85 miles from East Clarks Falls Road. Proceed on gravel drive southwesterly, by a house trailer, to an A-frame house. The monument is 100 feet from, and opposite to, the rear side of the house.

A rough granite monument showing 2 feet above the ground marks the bound. It measures 8" X 12" at the ground and is lettered "RI" on the east face and "C" on the west face.

The 1941 commissioners accepted the monument as correctly marking a point on the line established in 1840.

Bound *e* - 3,429 feet south  
Bound *g* - 5,277 feet north





**NORTHWESTERLY VIEW**



**NORTHWESTERLY VIEW**

LINE BOUND *g*

ROUGH GRANITE MONUMENT

WOODS ROAD

Beginning at the intersection of Denison Hill Road, Connecticut Route 216 and East Clarks Falls Road in the village of Clarks Falls, proceed northeasterly on East Clarks Falls Road (Clarks Falls Road in Rhode Island) 1.65 miles to the intersection with Kuehn Road on the left. Proceed northerly on Kuehn Road to the end of pavement, a total distance from Clarks Falls Road of 1.45 miles (see sketch).

The road to the northeast deteriorates to an overgrown trail that swings to the north. A dirt drive to a cape with a 2-car garage is to the northwest. Proceed up drive to the northeast corner of the garage. From this point, proceed northerly a distance of 68 feet (from the range of the garage) until just into the woods. At this point, 5' feet to the left is a small, 1 foot stone heap. From this point follow an overgrown trail on a bearing of N 07° E, crossing stone heaps at 255 feet, 107 feet, 468 feet and ending at a 6' X 6' stone heap at an additional distance of 370 feet. From this point, proceed 262' on a bearing of N 38° E to the bound, crossing a stone wall 12 feet southwest of the bound, on this line.

Bound is located 7 feet east of a stone wall. Said wall runs north-northeast and continues a distance of 205 feet north beyond the bound. A brook is located an additional 70 feet from the end of, and in line with, said wall. There is a 15 inch white pine to the west of the bound, twin 18 inch red oak trees 18 feet to the east of the bound and a 15 inch white pine 40 feet to the south of the bound. Dense, scrub woodland drops away to the north, is level to the east and west, and rises slightly to the south.

Bound is marked by a rough granite monument showing 2.3 feet above the ground. It measures 6" X 12" at the ground and 6" X 8" at the top. It is lettered "RI" on the east face and "C" on the west face.

The 1941 commissioners accepted the monument as correctly marking a point on the line established in 1840.

Bound *f* - 5,277 feet south  
Bound *h* - 6,458 feet north

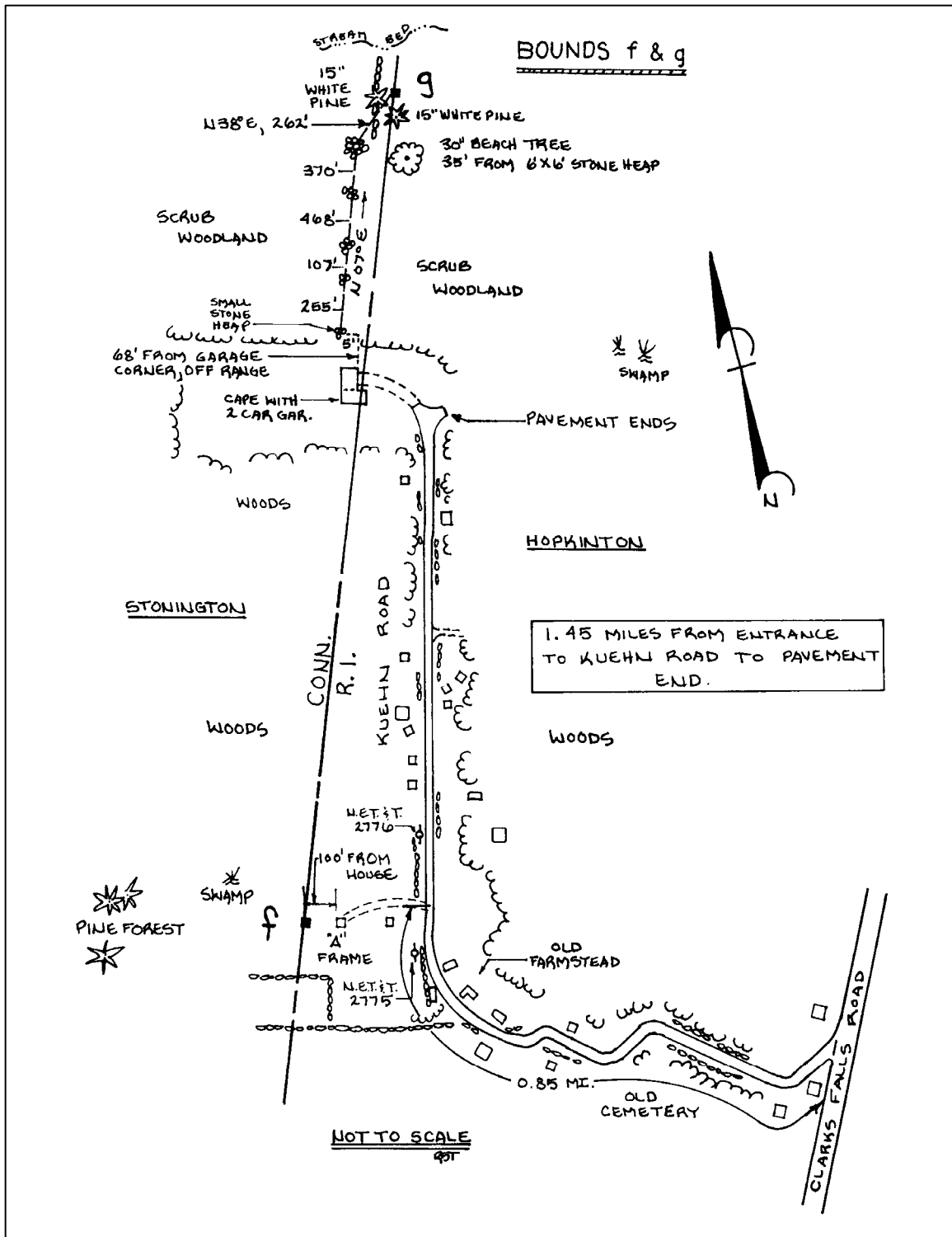

1997



**WESTERLY VIEW**



**NORTHWESTERLY VIEW**

**ANGLE BOUND *h*****NORTH STONINGTON - VOLUNTOWN TOWN CORNER**

ROUGH GRANITE MONUMENT

INTERIOR TOWN CORNER

Beginning at the intersection of Connecticut Routes 165, 138 and 49 in the village of Voluntown, proceed easterly on Routes 165 and 138 to a point where the two highways diverge. Proceed southeasterly on Route 138, a distance of 5.4 miles, to Yawgoog Scout Camp Road on the right. Proceed westerly on Yawgoog Scout Camp Road 0.6 miles to the main gate of the Scout Camp.

From this point, do not go through the gate, but turn sharply right and proceed north-northwesterly on Pendleton Road, passing Bound "*i*" on the left at 1.2 miles where the road name changes in Connecticut to Green Falls Road. Continue westerly on Green Falls Road to an intersecting gravel road on the left, known as Denison Hill Road, at approximately 1.8 miles. Proceed southerly on Denison Hill Road, passing a residence east of the traveled way at 0.9 miles, to the North Stonington-Voluntown town Line at approximately 1.1 miles. The road narrows at this point and there are overhead transmission lines in this area.

Previous descriptions describe a wall running east and west in this area as a town line wall.

From the intersection of said town line wall with the easterly road, proceed easterly 515 feet to a wall to the north. Continue easterly, 120 feet to the end of the town line wall, at a wall to the northeast. Proceed S 66° E, 1,255 feet to a stone heap on a rock, about 200 feet east of a town line summit. Continue S 66° E, 1,135 feet to bound. Indications of cutting along town line can be traced.

Continued



**ANGLE BOUND *h* CONTINUED**

Bound is covered by a laurel thicket and is located in woodland on a low spur running northeasterly. It is S 80° E, 110 feet from a large boulder on ledge outcrop at the northeast brow of the spur. Woodland rises to the west and drops away in all other directions.

A rough granite monument, showing 3.4 feet above the ground, with the broken top in place, marks the bound. It is set in a stone heap. Monument measures 8" X 16" at the ground and 2" to 4" X 15" at the top. It is lettered "RI" on the east face and "C" on the west face.

The 1941 commissioners accepted the monument as correctly marking a point on the line established in 1840.

Bound *g* – 6,458 feet south  
Bound *i* – 7,743 feet north



**NORTHERLY VIEW**



**NORTHERLY VIEW**

# CT / RI LINE - SECTION 3

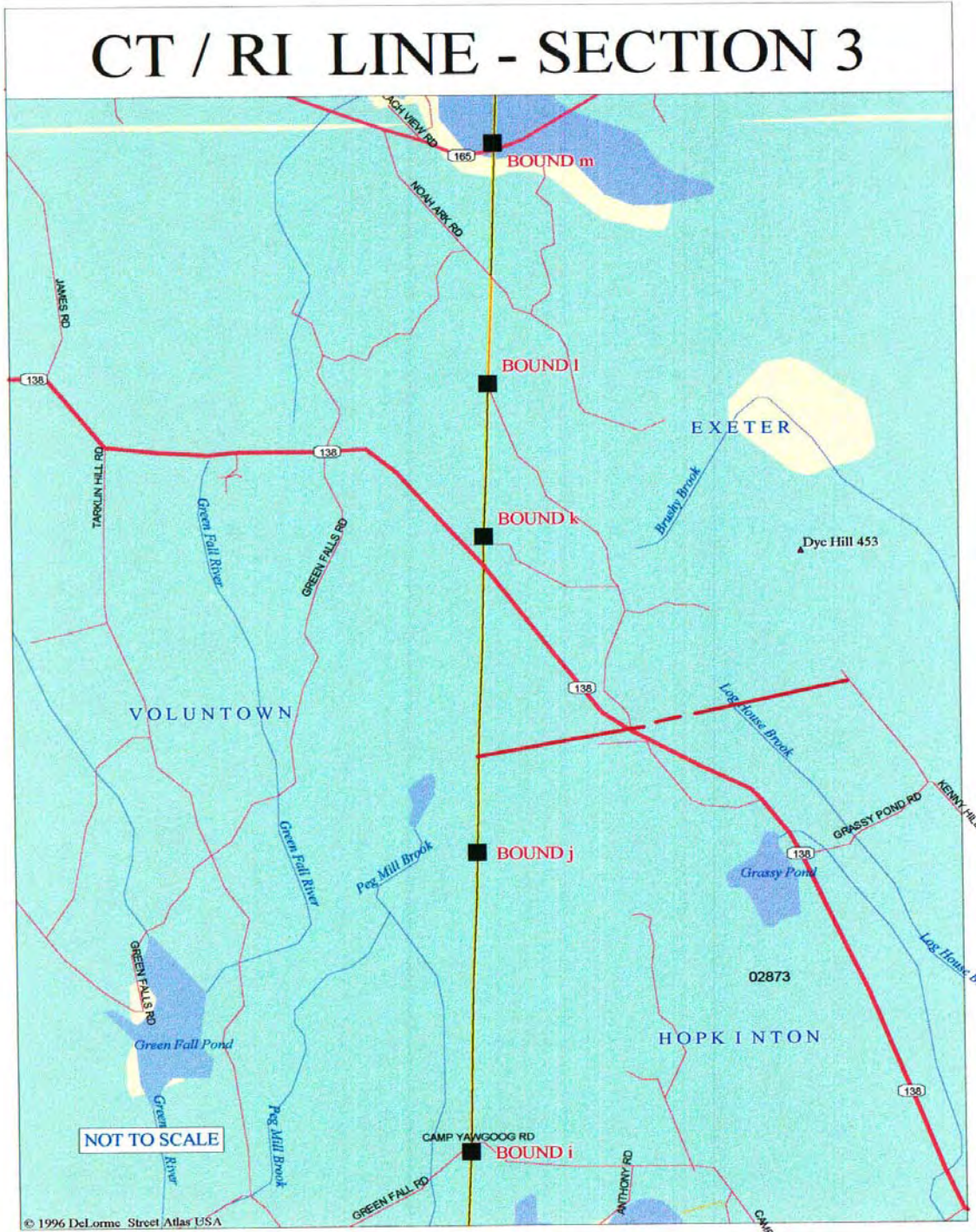

1997

CONNECTICUT- RHODE ISLAND STATE BOUNDARY LINE PERAMBULATION  
CONNECTICUT DEPARTMENT OF TRANSPORTATION

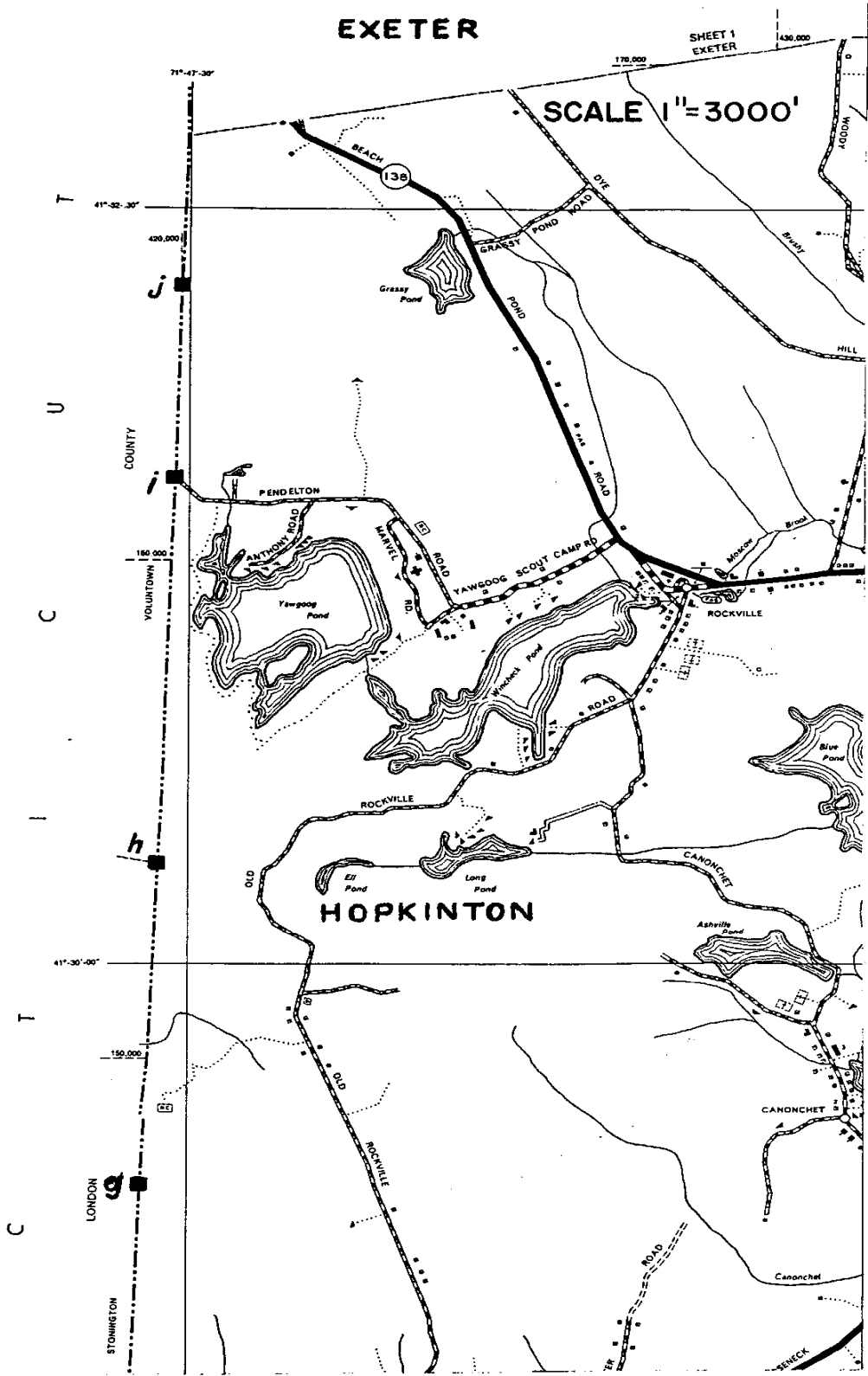



LINE BOUND *i*

## REGULATION GRANITE MONUMENT

## GRAVEL ROAD

Beginning at the intersection of Connecticut Routes 165, 138 and 49 in the village of Voluntown, proceed easterly on Routes 165 and 138 to a point where the two highways diverge. Proceed southeasterly on Route 138, a distance of 5.4 miles, to Yawgoog Scout Camp Road on the right. Proceed westerly on Yawgoog Scout Camp Road 0.6 miles to the main gate of the Scout Camp.

From this point do not go through the gate, but turn sharply right and proceed north-northwesterly on Pendleton Road 1.2 miles to the bound. The bound is situated on the inside of a sharp curve in the road.

The bound is located 33 feet south of the center of the traveled way. It is 65 feet west of an intersecting gravel road to the northeast. A blue marked hiking trail leads north from the road, opposite the bound. Bound is approximately 158 feet east of a boulder 11' X 6' X 8' high on the north side of Pendleton Road. There is scrub woodlands on all sides dropping away to the southeast and rising to the north and west.

A regulation granite monument showing 4.7 feet above the ground marks the bound. It measures 12" X 12", and is lettered "RI" on the east face, "CONN" on the west face and "1990" on the north face.

This bound was reset by coordinates along the line between Bound h and Bound K in 1990. It is 28 feet north of the original 1840 location.

The 1941 commissioners accepted the monument as correctly marking a point on the line established in 1840.

Bound *h* - 7,743 feet south  
Bound *k* -10,014 feet north





**WESTERLY VIEW**



**SOUTHERLY VIEW**

LINE BOUND *j*

## STONE HEAP

## INTERIOR INTERMEDIATE POINT

Beginning at the intersection of Connecticut Routes 165, 138 and 49 in the village of Voluntown, proceed easterly on Routes 165 and 138 to a point where the two highways diverge. Continue southeasterly on Route 138 for a distance of 4 miles to a woods road on the right, just north of Grassy Pond in Rhode Island.

From the edge of Route 138 proceed westerly on the woods road 1,042 feet to an intersection with other woods roads. There are two cellar holes southwest of this intersection. Proceed westerly from the intersection on a well-maintained trail marked with yellow blazes. Proceed a distance of 1,570 feet to a point where the trail turns to the south at the northeasterly side of a slight rise to the south, said rise is 320 feet north of the north edge of a bare flat ledge on the trail. Proceed westerly 150 feet through dense brush and laurel to former bound location at the edge of a swamp.

Bound was marked in 1840 by a stone heap, at a point where the line intersected the southerly edge of the "Great Swamp". Repeated reconnaissance efforts since 1915, and the detailed field surveys made in 1939, failed to recover this bound.

An attempt was made to recover the ring of stones which were photographed and described in the 1976 perambulation, but the stones could not be located.

The 1941 commissioners agreed that this bound must be considered lost.

LINE BOUND *k*

## ROUGH GRANITE MONUMENT

## ABANDONED ROAD

Beginning at the intersection of Connecticut Routes 165 and 138 in the town of Voluntown, proceed southeasterly on Route 138 a distance of 2.75 miles, to ledge-cut, CL&P pole number 1823 and a woods road on the left.

Proceed easterly 0.13 miles down grade through woodland following said road to the bound.

Bound is located 12 feet north of the center of the traveled way. An abandoned road descends southerly from the bound, while gravel road runs level to the east. There is scrub woodland on all sides.

A rough granite monument showing 3.7 feet above the ground marks the bound. It measures 9" X 13" at the ground and 5" X 11" at the top. It is lettered "RI" on the east face and "C" on the west face.

The 1941 commissioners accepted the monument as correctly marking a point on the line established in 1840.

There is a rounded boulder marked "RI", S 35° W and 25.5 feet from the bound, on the south side of the road.

It is shown on the 1840 official map as marking a point on the "REPUTED STATE LINE".

Bound *i* - 10,014 feet south  
Bound *l* - 2,541 feet north



**WESTERLY VIEW**



**SOUTHWESTERLY VIEW**  
With reference point shown in background.

LINE BOUND l

## ROUGH GRANITE MONUMENT

## GRAVEL ROAD

Beginning at the intersection of Connecticut Routes 165 and 138, east of the village of Voluntown, proceed easterly 2.05 miles on Route 165 to a gravel road on the right.

Proceed southeasterly on gravel road, passing cemetery on left at 0.3 miles and junction with a gravel road on the right at 0.45 miles. Continue to a point where the gravel road splits to the southeast and southwest, at a total distance of 0.6 miles from Route 165. A swinging angle iron gate blocks the gravel road to the southeast.

Proceed southwesterly on gravel road 0.3 miles to the bound. Bound is 50 feet southeast of a point where the road curves to the southeast.

Bound is located 20 feet east of the center of the traveled way. A pine plantation drops off steeply west of the road. Level scrub woodland is on the east. The road is level opposite the bound.

A rough granite monument showing 3.6 feet above the ground marks the bound. It measures 12" X 12" at the ground and 9" X 10" at the top, and is lettered "RI" on the east face and "C" on the west face.

The 1941 commissioners accepted the monument as correctly marking a point on the line established in 1840.

Bound *k* - 2,541 feet south  
Bound *n* - 12,288 feet north





**EASTERLY VIEW**



**NORTHEASTERLY VIEW**

LINE BOUND *m*

ROUGH GRANITE MONUMENT

PAVED HIGHWAY

Beginning at the intersection of Connecticut Routes 165 and 138, east of the village of Voluntown, proceed easterly 2.35 miles on Route 165 to the approximate location of Bound "*m*", on the northerly side of the causeway which crosses Beach Pond.

According to the description of the perambulation of 1975-1976, the top portion of the bound, which was broken off, was removed and stored at the District II Administration Office.

Bound was located 20 feet north of the center of the traveled way. It was enclosed in protective highway guide rails at the north side of the causeway across Beach Pond.

Bound was marked by a rough granite monument showing 2.2 feet above the ground. It measured 8" X 12" at the ground and 8" X 5" at the top. It was lettered "RI" on the east face and "C" on the west face.

The 1941 commissioners agreed that the monument had been moved from its original position and could not be considered as marking a point on the line established in 1840.

Bound *l* - 3,925 feet south  
Bound *n* - 8,363 feet north

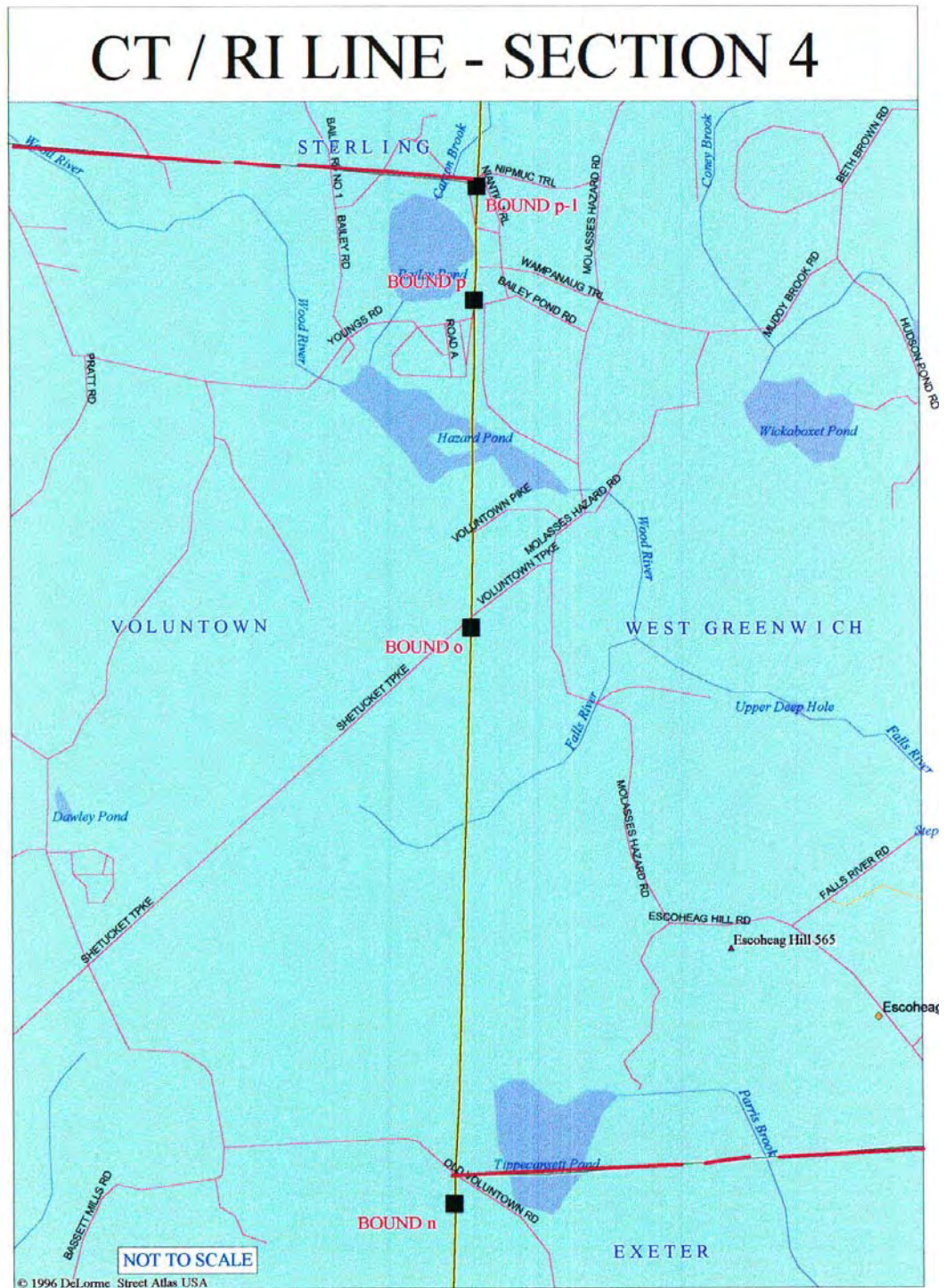

1997

CONNECTICUT- RHODE ISLAND STATE BOUNDARY LINE PERAMBULATION  
CONNECTICUT DEPARTMENT OF TRANSPORTATION



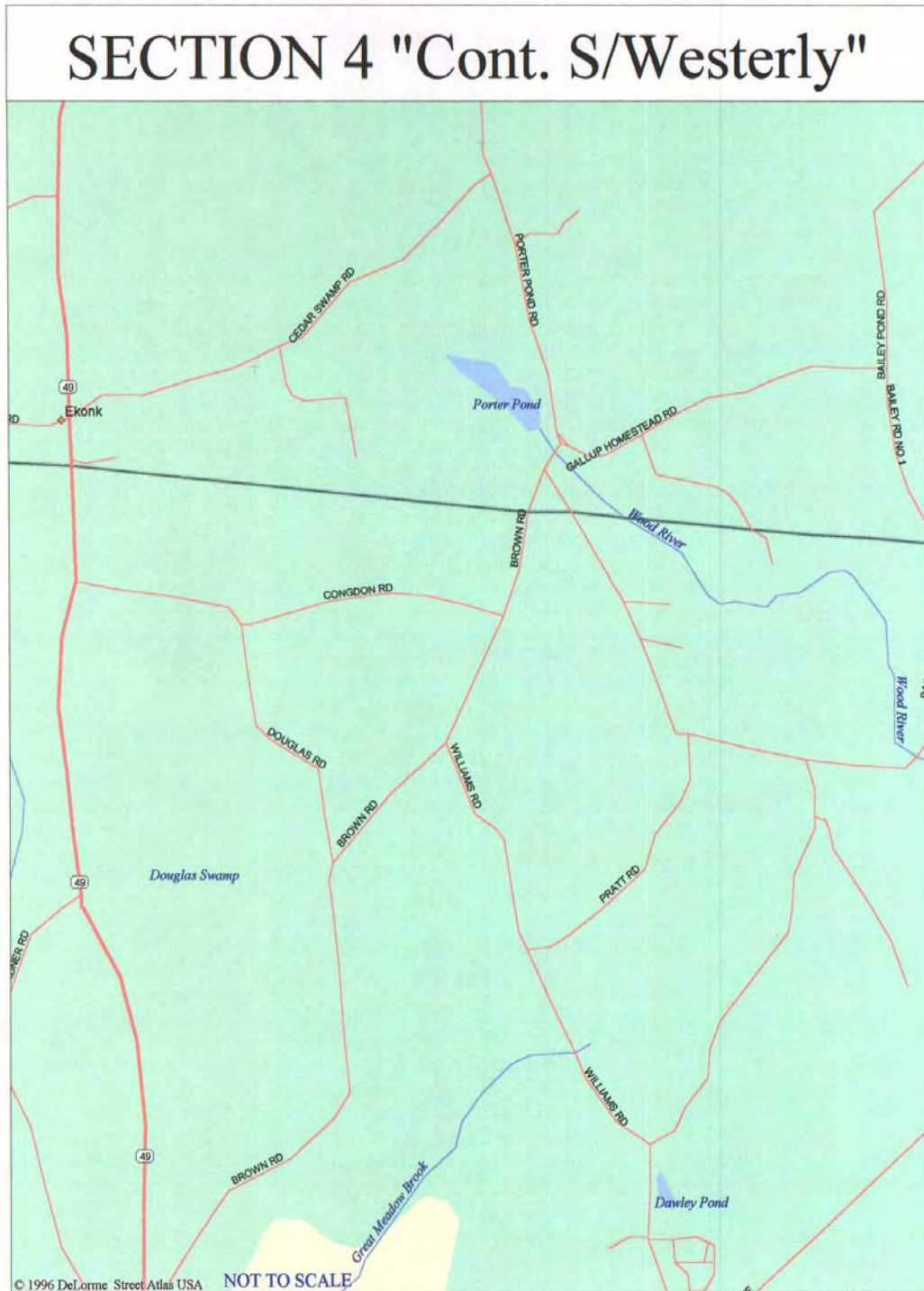

1997

CONNECTICUT- RHODE ISLAND STATE BOUNDARY LINE PERAMBULATION  
CONNECTICUT DEPARTMENT OF TRANSPORTATION

ANGLE BOUND *n***WEST GREENWICH - EXETER TOWN CORNER**

ROUGH GRANITE MONUMENT

INTERIOR TOWN CORNER

Beginning at the intersection of Connecticut Route 138, Connecticut Route 49 and Shetucket Turnpike, east of the village of Voluntown, proceed northeasterly on the Shetucket Turnpike to a gravel road on the right at end of pavement at 3.2 miles. Proceed southeasterly, easterly, and southerly on gravel road to intersection of dirt road at a distance of 4 miles. Proceed easterly on wood road to turn out at state line at 4.65 miles, opposite short section of wall on the north side of the road (see sketch).

From the northwesterly end of the stone wall, opposite the turn out, proceed northwesterly 100 feet along wood road. Proceed S 25° W, 120 feet to the north end of a ledge with its vertical face to the east. Proceed S 15° E, 230 feet along rocky ridge to an unshaped granite slab standing 3 feet high in a stone heap. Proceed S 15° W, 195 feet to a great boulder measuring about 20' X 18' X 8' high, with two small stones on its easterly corner. Proceed on a bearing of S 20° W, 280 feet to bound. Bound is just south of a small ledge outcrop with boulders at its north end.

Bound is located in woodland on the easterly slope of a low hill, west of the south end of Tippetansett Pond. Woodland drops away to the north and east, and is level to the south and west.

Bound is marked by a rough granite monument showing 2.7 feet above the ground. It is set in a stone heap and is lettered "RI" on the east face and "C" on the west face. The top of the bound measures 6" X 4". The southern 1/3 portion of the top is broken off. Monument has a 3/8" drill hole and is 1/2" deep.

The 1941 commissioners accepted the monument as correctly marking a point on the line established in 1840.

Bound *l* - 12,288 feet northBound *o* - 9,467 feet north



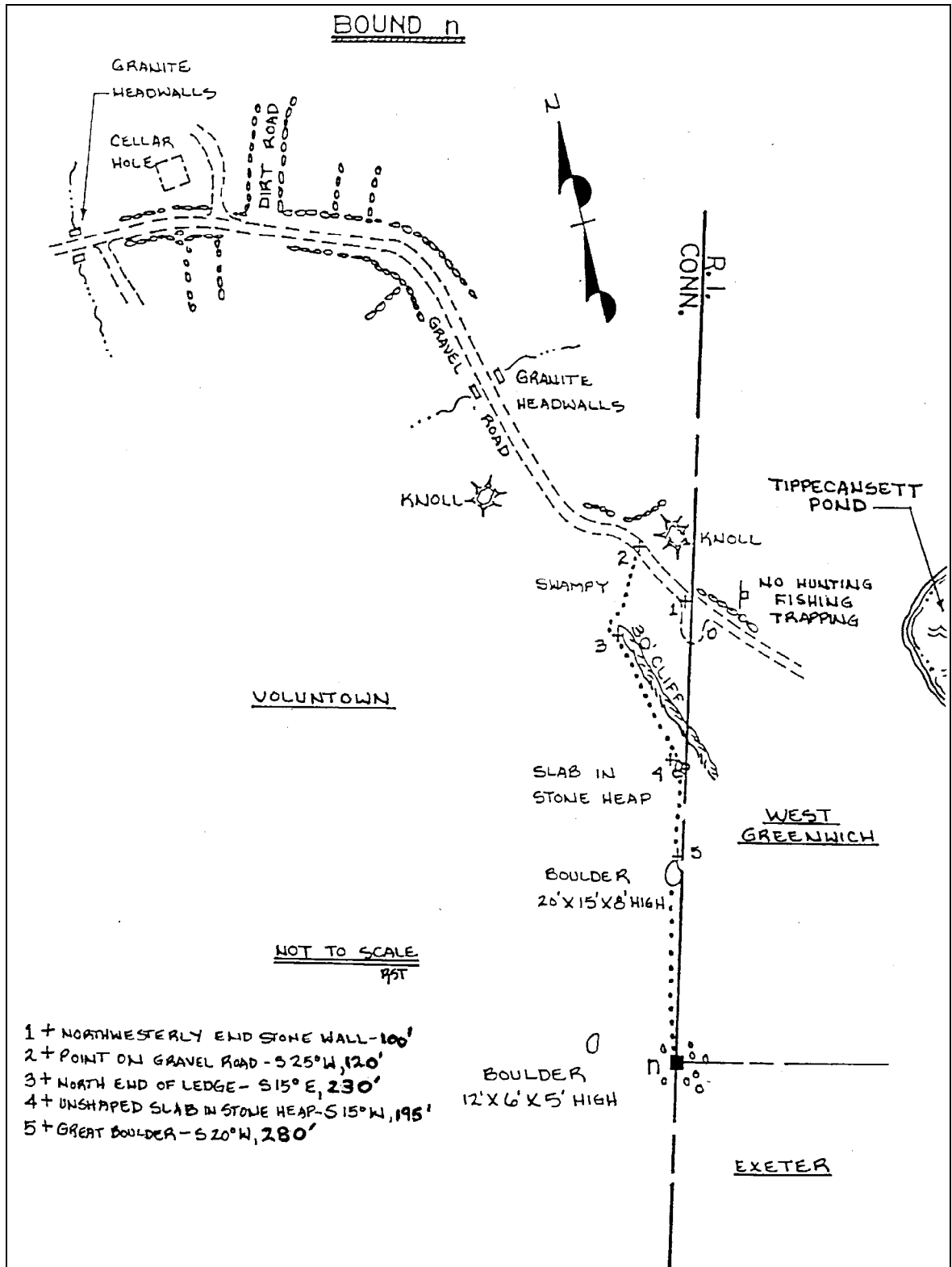



**WESTERLY VIEW**



**WESTERLY VIEW**

**LINE BOUND 0**

ROUGH GRANITE MONUMENT

WOOD ROAD

Beginning at the intersection of Connecticut Route 138, Connecticut Route 49 and Shetucket Turnpike, east of the village of Voluntown, proceed northeasterly on the Shetucket Turnpike to the end of the pavement at the intersection of a dirt road at 3.2 miles. Continue northeasterly on wood road to bound at 4.8 miles.

Bound is located 18 feet southeast of the center of the traveled way and 17 feet northwest of the southeast road wall. Road is descending northeasterly, opposite the bound. Woodland on all sides rises to the north and west and drops away to the south and east.

A rough granite monument showing 4 feet above the ground marks the bound. It measures 8" X 13" at the ground and is lettered "RI" on the east face and "C" on the west face.

The 1941 commissioners accepted the monument as correctly marking a point on the line established in 1840.

Bound *n* - 9,467 feet south  
Bound *p* - 4,965 feet north



**WESTERLY VIEW**



**WESTERLY VIEW**

LINE BOUND *p*

## REINFORCED CONCRETE MONUMENT

## GRAVEL ROAD

Beginning at the intersection of Connecticut Route 49 and Brown Road in the town of Voluntown, proceed on Brown Road 3.1 miles, passing a small cemetery on the right at 1.5 miles and Congdon Road at 2.6 miles, to the intersection of Brown Road and Gallup Homestead Road.

Proceed southerly on Gallup Homestead Road, a distance of 1.1 miles, to the intersection of Bailey Road (not marked). Turning right, proceed southerly from said intersection a distance of 1 mile, to a row of small ranch houses on the right. At this point, a dirt road continues southwesterly. The bituminous road continues northeasterly as "Bailey Pond Road". From the row of ranch houses, proceed northeasterly 0.2 miles, past Bailey Pond on the left, to headwalls and the pond outlet. Proceed 0.3 miles from the pond outlet, through area of dense cottages, to the bound on left. (see sketch)

Bound is located 11 feet north of the center of the traveled way, on the westerly side of a gravel road leading to cabins along Bailey pond. Bound is 7.18 feet southeast of CL&P #836, 25.9 feet southwest of NETET CO pole #8 and 79.7 feet northeast of a well.

Bound is a regulation State Line bronze disk set in the top of a reinforced concrete monument 6 inches by 6 inches by 48 inches long. The top is set 2 inches below the surface of the ground and the base is in a mass of concrete.

On October 18, 1990, the base remains of the original granite monument was recovered. It was plumbed and then located. On June 13, 1991, the new concrete monument was set to the located position.

The 1941 commissioners accepted the monument as correctly marking a point on the line established in 1840.

Nad 27

N = 293,369.19

E = 862896.93

Bound *p - o* 4963.78 feet S 0° - 47' - 04.5" W

Bound *p - q* 7,836.08 feet N 0° - 34' - 50.6" E

---

1997



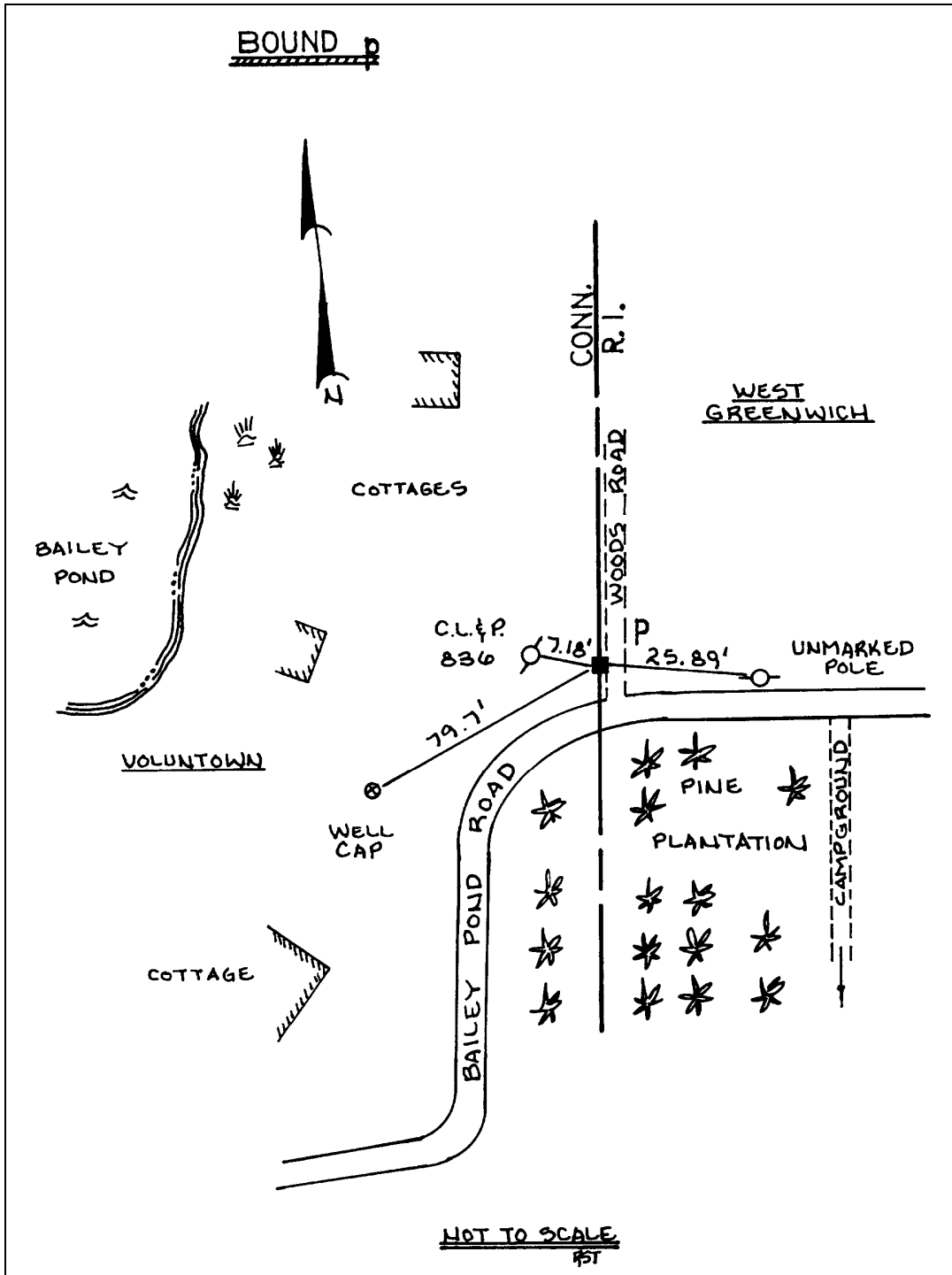

1997

CONNECTICUT- RHODE ISLAND STATE BOUNDARY LINE PERAMBULATION  
CONNECTICUT DEPARTMENT OF TRANSPORTATION



**AERIAL VIEW**



**WESTERLY VIEW**

UNOFFICIAL BOUND *p-1***VOLUNTOWN - STERLING TOWN CORNER**

GRANITE FIELD STONE

GRAVEL ROAD

Beginning at the intersection of Connecticut Route 14A (Main Street) and Newport Road in the town of Sterling, proceed southerly and southeasterly on Newport Road 2.7 miles to the intersection with Hazard Road on the right. Proceed southeasterly on Hazard Road 1.9 miles to the intersection with Niantic Road on the right. Proceed westerly 0.35 miles on Niantic Road to the intersection with Montauk Trail on the right. Proceed westerly on Montauk Trail 174 feet to the approximate location of bound.

Bound was located 12 feet south of the center of the traveled way and 37.3 feet northwest of C.G.S. monument 4047. Road is level opposite the approximate location of the bound. Level scrub land lies north of the road, with a stand of white pines south of the road and east of the line. West of the line the open land to the south drops away to lower, level, filled land along Bailey Road.

Bound was marked by a triangular granite fieldstone showing 1.1 feet above the ground. It measured 5" X 14" at the ground, coming to a point at the top, with the northerly edge vertical. It was unlettered, but had a small cross cut in the top.

It was determined by the 1986 perambulation that the bound had been removed and additional reconnaissance efforts in 1997 did not recover the bound.

No bound was established in this area in 1840 and the 1941 commissioners agreed that the monument should not be considered as marking a point on the line established in 1840.

Bound *p* - 1,936 feet south  
Bound *q* - 5,899 feet north

# CT / RI LINE - SECTION 5

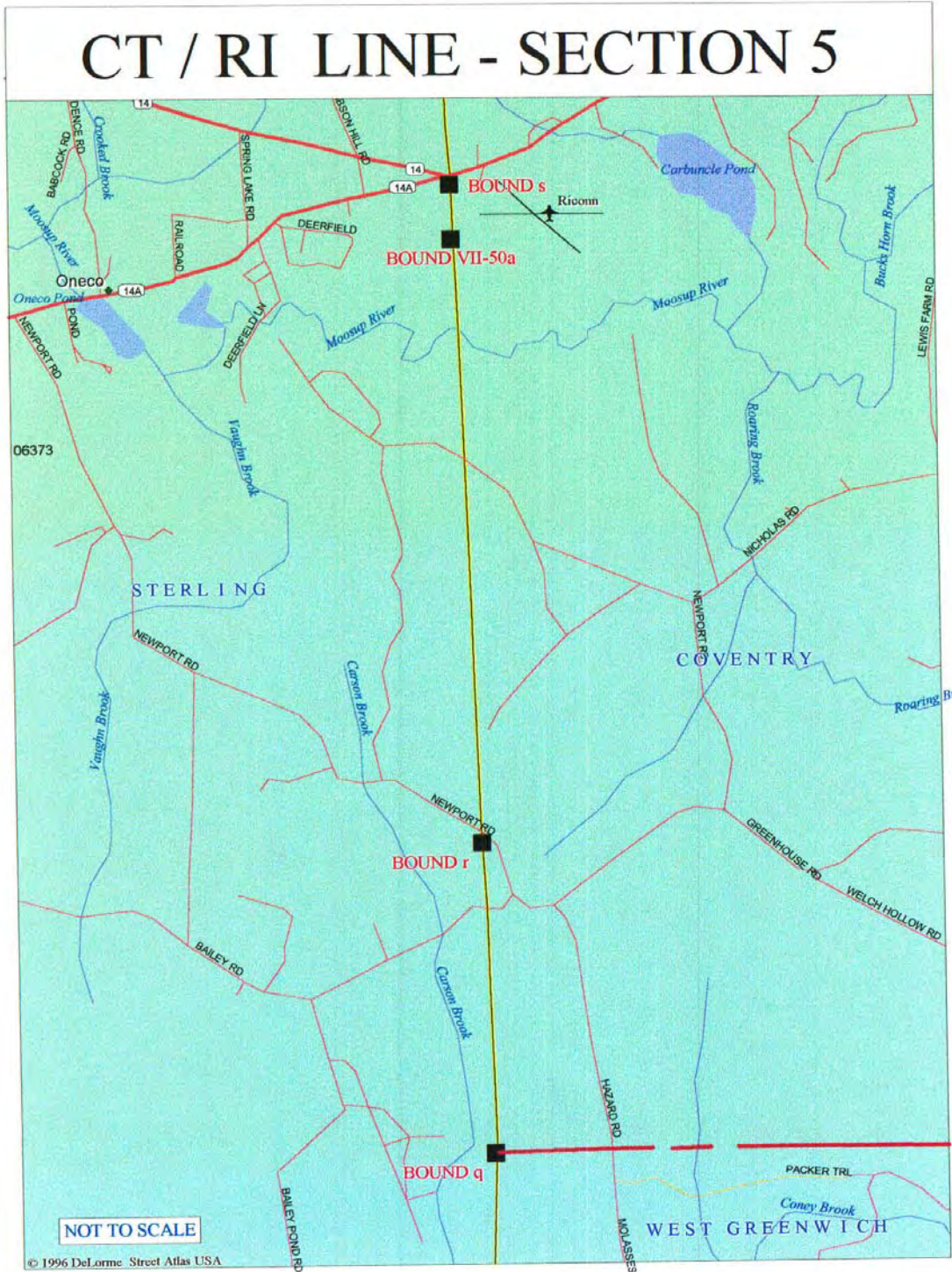

1997

CONNECTICUT- RHODE ISLAND STATE BOUNDARY LINE PERAMBULATION  
CONNECTICUT DEPARTMENT OF TRANSPORTATION



# SECTION 5 "Cont. S/Westerly"

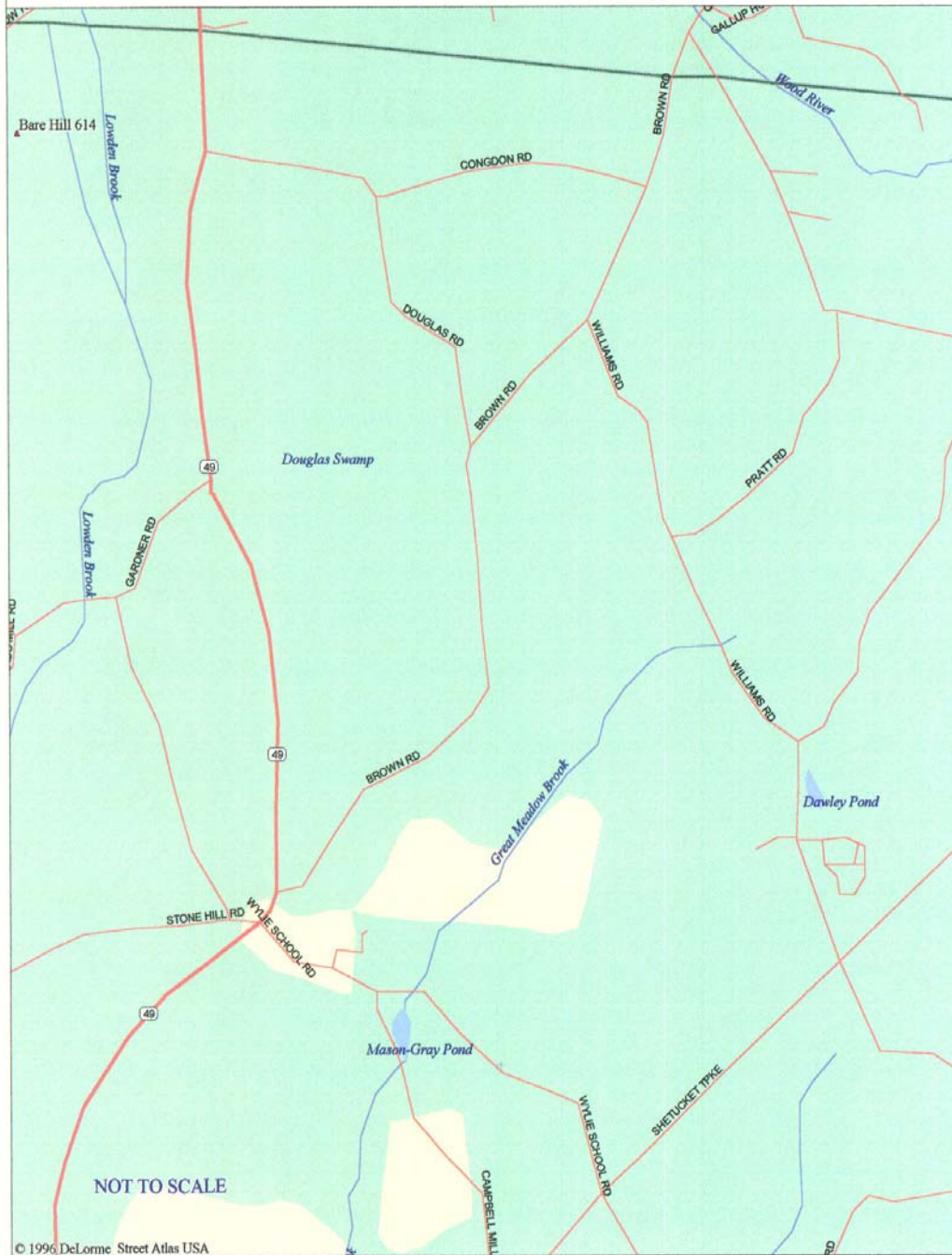

1997

CONNECTICUT- RHODE ISLAND STATE BOUNDARY LINE PERAMBULATION  
CONNECTICUT DEPARTMENT OF TRANSPORTATION



# SECTION 5 "Cont. S/Westerly"

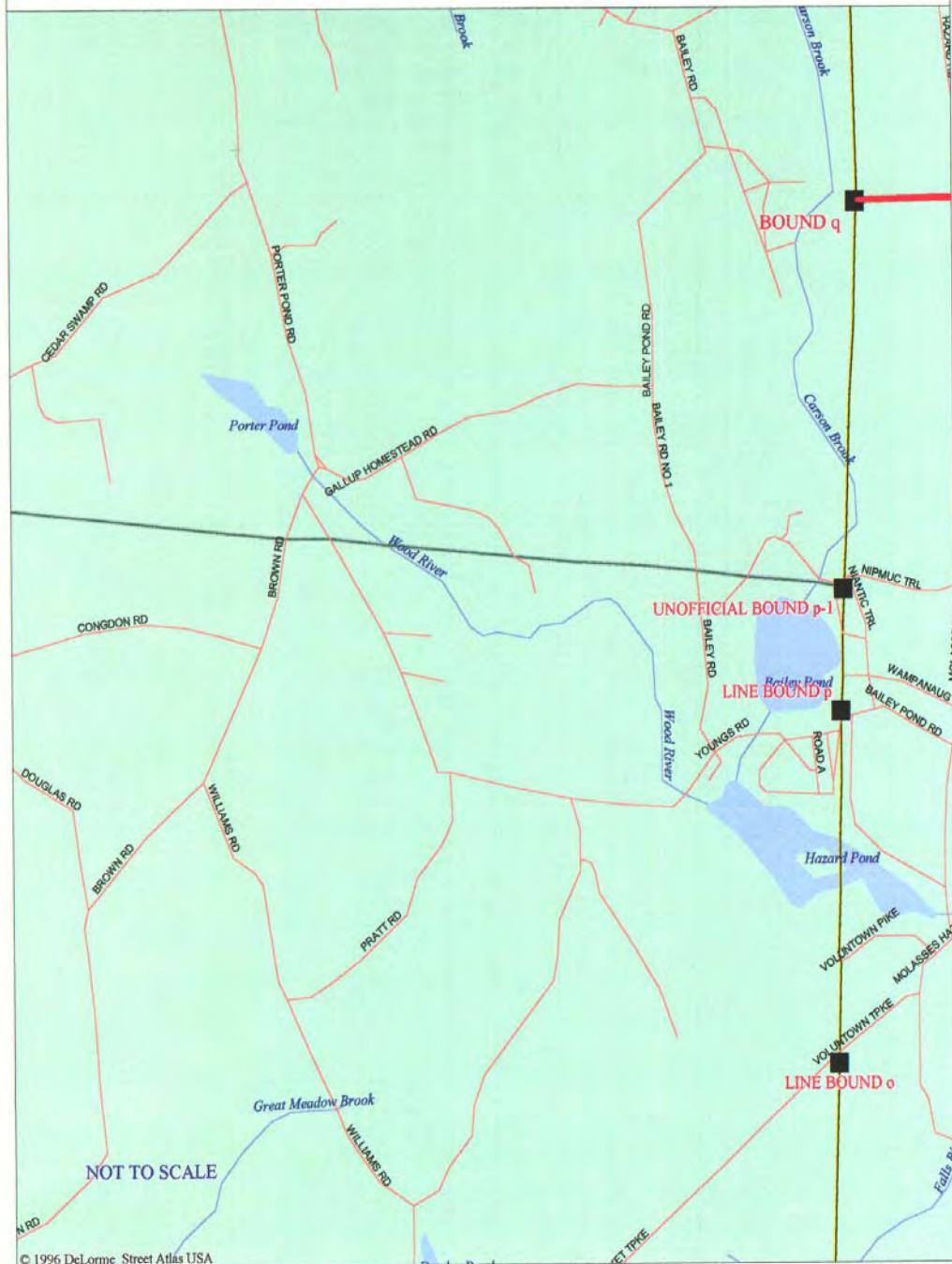

1997

CONNECTICUT- RHODE ISLAND STATE BOUNDARY LINE PERAMBULATION  
CONNECTICUT DEPARTMENT OF TRANSPORTATION

**ANGLE BOUND *q*****WARWICK CORNER****WEST GREENWICH - COVENTRY TOWN CORNER  
(RHODE ISLAND)**

ROUGH GRANITE MONUMENT

INTERIOR TOWN CORNER

Beginning at the intersection of Connecticut Route 49 and Brown Road in the town of Voluntown, proceed on Brown Road to a small cemetery on the right at 1.5 miles and Congdon Road at 2.6 miles. Continue on Brown Road to the intersection of Brown Road, Porter Pond Road and Gallup Homestead Road at 3.1 miles.

Proceed right and easterly, on Gallup Homestead Road, 1.1 miles to the intersection of Bailey Road (not marked). Turn left and proceed northerly on Bailey Road 0.9 miles to a dirt drive at the entrance to Falls Creek Horse Farm on the right (see sketch). Proceed easterly, on the dirt access drive into Falls Creek Horse Farm, to the first split between fenced pastures on the right. Turn right and proceed southerly to the first horse barn to the west, past an octagonal shaped barn to the west. Survey crew will need to check in before passing further.

Continue on dirt road easterly, past a large indoor arena. Thence proceed right and southerly passing a one-level barn with stalls, a fenced riding ring, and a one-level, low barn with stalls. White pine trees and a pond will come into view to the southeast. A silo is to the southwest. Continue on dirt road easterly, past pond, to additional pasture, barn and single story farm ranch. Proceed easterly, on grass roadway between fenced pastures, to Carson Brook. Continue on foot to the center of a concrete surface bridge. From this point, continue on a bearing of N 52° E across open field on the easterly side of Carson Brook, a total distance of 285 feet to the bound, crossing a stream at a distance of 268 feet.

Continued

ANGLE BOUND *q* Continued

Bound is located in a wooded swamp. There is a large white oak to the northeast, a clump of white pines to the south, dense woods to the east and a junkyard beyond.

Bound is marked by a roughly dressed granite monument, showing 7.5 feet above a cemented stone heap, which stands above the adjacent swamp land. It measures 26" X 10" at the ground and 18" X 6" at the top. It is lettered "RHODE ISL" at a point about 4 feet above the ground and "R" about 2 feet above the ground on the east face, "WG" on the south face, "C" on the north face and "C" on the west face, all about 2 feet above the ground.

Monument was set in November 1742 in the stone heap made in September 1728 to mark the Warwick Corner. It was reset, and the stone heap renewed, in 1840. On October 5th and 6th 1923, it was reset in a concrete base.

The 1941 commissioners accepted the monument as correctly marking the principal angle in the line established in 1840.

Nad 27	
N = 301,204.87	Bound <i>q-p</i> 7,836.08 feet S 0° - 34' - 50.6 " W
E = 862,976.35	Bound <i>q-r</i> 4,956.21 feet N 2° - 19' - 46.6" W

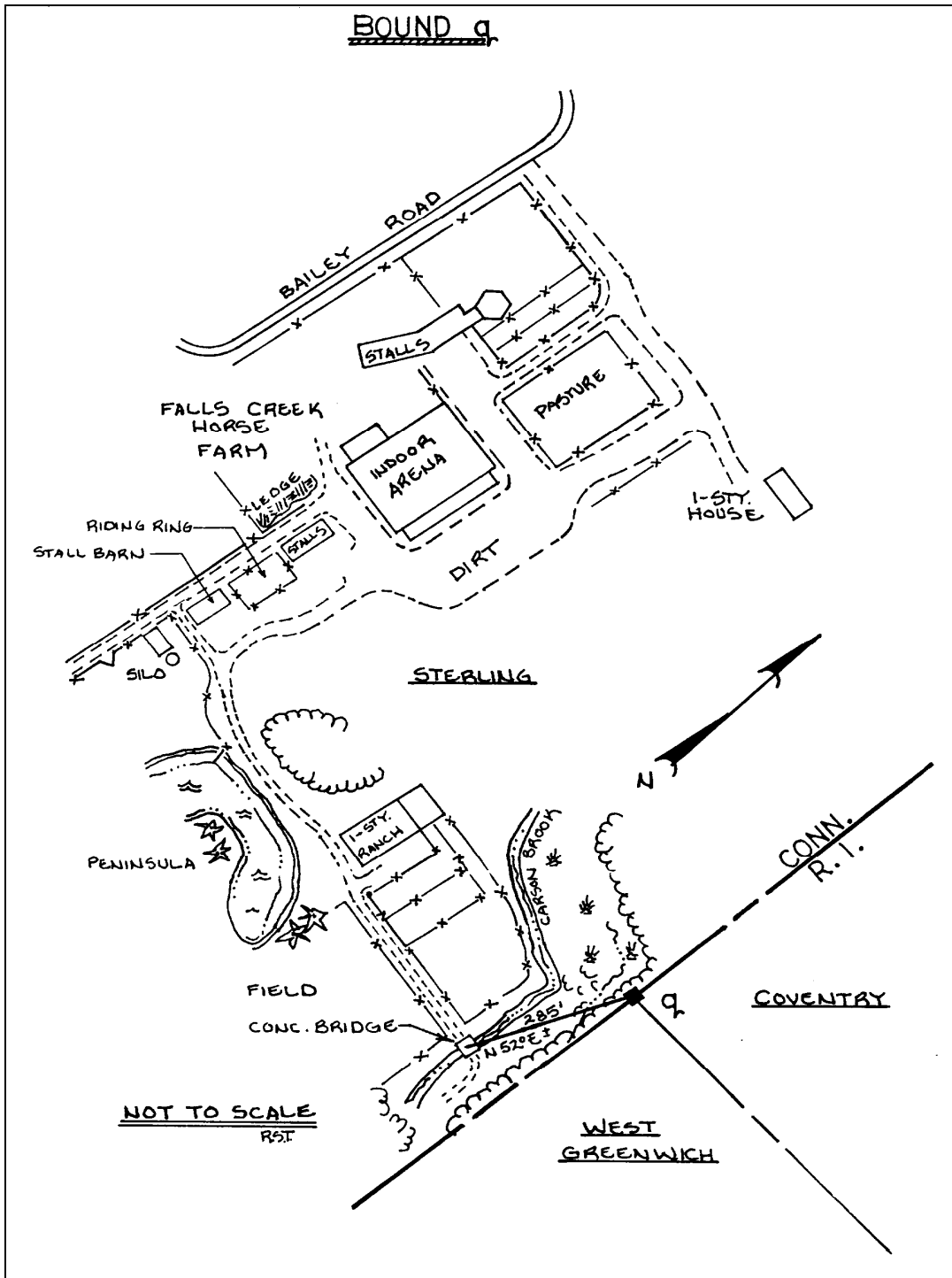



**SOUTHWESTERLY VIEW**



**NORTHEASTERLY VIEW**



LINE BOUND *r*

ROUGH GRANITE MONUMENT

PAVED HIGHWAY

Beginning at the intersection of Connecticut Route 14A (Main Street) and Newport Road in the town of Sterling, proceed southerly and southeasterly on Newport Road to approximate location of bound, at the end of the pavement in Connecticut at 2.5 miles.

Bound was located 13 feet southwest of the center of the traveled way. Woodland drops off to the southwest and rises to the northeast.

Bound was marked by a seamy piece of gray granite showing 2.2 feet above the ground.

It was determined by the 1986 perambulation that the bound had been removed. In November 1990, "*r*" was reset on-line and offset to the south a distance of 10.70'. Bound is a drill hole in a bronze disc marked "State Line Boundary" set in a 12' X 15' boulder, 3 feet high.

The 1941 commissioners accepted the location of the original monument as correctly marking a point on the line established in 1840

Bound *q* 4,956.21 feet south  
Bound *t* 20,008 feet north



**AERIAL VIEW**



**SOUTHERLY VIEW**

UNOFFICIAL BOUND VII - 50a

## GRANITE MONUMENT

## RAILROAD

Beginning at the center of the bridge over the Moosup River, on Connecticut Route 14A in the village of Oneco, proceed easterly 1.2 miles on Route 14A to Route 14.

From the intersection of the northerly edge of the pavement of Route 14A with the southerly edge of the pavement of Route 14, proceed in a southerly direction along a wide brushy fence line, at the easterly edge of cultivated land, to its southeasterly corner. Proceed southerly across a narrow strip of woodland to a railroad. Proceed easterly 100 feet along the railroad to documented location of bound.

Bound was located 8 feet north of the centerline of the railroad track bed and 8 feet east of a stone box culvert under the railroad. Scrub woodland drops away south of the railroad, and rises slightly on the north to cultivated land west of the line. Scrub pasture is on the east, further north.

A granite monument showing 3.7 feet above the ground formerly marked the bound. The top 12 inches were dressed and it measured 7" X 15". The rest of the shaft was rough split and measured 11" X 20" at the ground. The dressed top was lettered "RI" on the east face and "CONN" on the west face. Past and current reconnaissance efforts determined the bound has been removed or destroyed.

No bound was established in this area in 1840. The 1941 commissioners agreed that the monument should not be considered as marking a point on the line.

Bound *r* - 9,457 feet south  
Bound *t* - 10,539 feet north

LINE BOUND S

ROUGH GRANITE MONUMENT

PAVED HIGHWAY

Beginning at the center of the bridge over the Moosup River, on Connecticut Route 14A in the village of Oneco, proceed easterly 1.2 miles on Route 14A to the intersection of Route 14 at bound location.

Bound was located in the fork between the above roads. It was in place in 1915, but it was reported that the bound had been previously moved. Presumably, it was removed in connection with subsequent highway improvements. There was level cultivated land to the south and scrub woodland dropping away to the north. A picnic area was in the fork to the west.

Bound was marked by a rough granite monument measuring 7" X 12". It was lettered "RI 1840" on the east face and "C" on the west face.

The 1941 commissioners agreed that relocation of this bound is impossible and that it is to be disregarded in locating the line established in 1840.



# CT / RI LINE - SECTION 6

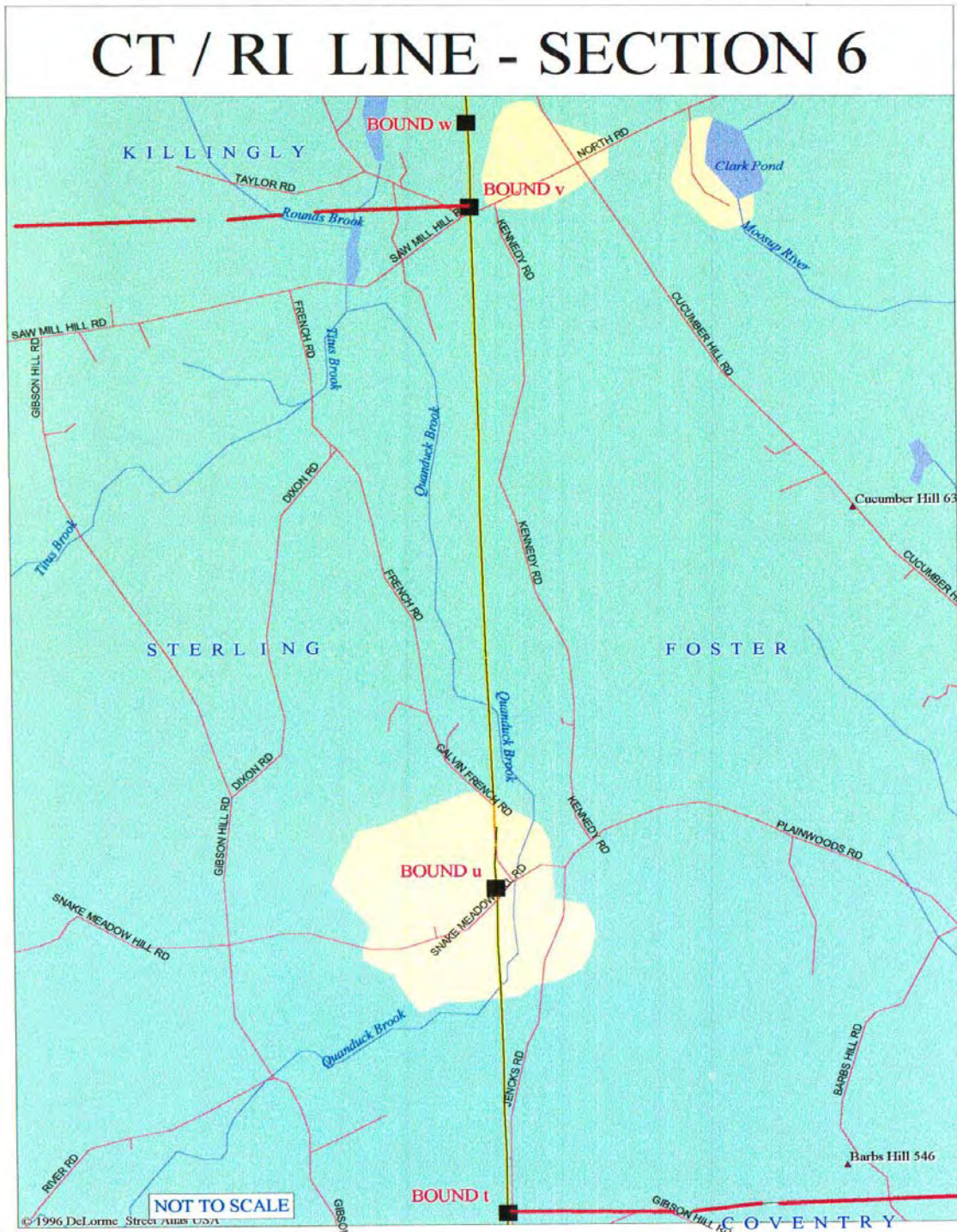

1997

CONNECTICUT- RHODE ISLAND STATE BOUNDARY LINE PERAMBULATION  
CONNECTICUT DEPARTMENT OF TRANSPORTATION



ANGLE BOUND *t***FOSTER - COVENTRY TOWN CORNER**

ROUGH GRANITE MONUMENT

GRAVEL ROAD

Beginning at the intersection of Connecticut Routes 14A and 14, east of the village of Oneco, proceed westerly 0.25 miles on Route 14 to its intersection with Gibson Hill Road on the right. Proceed northerly on Gibson Hill Road 1.35 miles to its intersection with Gibson Lane on the right. Proceed easterly on Gibson Lane to its intersection with Jencks Road on the left. Proceed northerly on Jencks Road in Rhode Island (on bituminous/chip sealed road) to bound at 0.75 miles, at the end of pavement and approximately 300 feet south of the northerly brow of the straight, level stretch of the road.

Bound is located 15 feet west of the center of the traveled way. It is 36.5 feet south of N.E. Co. pole number 1/2. Road is level opposite the bound, with level woodland in all directions.

A rough granite monument, showing 2.4 feet above the ground, marks the bound. It measures 7" X 11" at the ground and 6" X 9" at the top. It is lettered "RI" on the east face and "C" on the west face. It is irregular in shape with a 1/4" drill hole, 1/4" deep in center of top.

The 1941 commissioners accepted the monument as correctly marking a point on the line established in 1840.

Bound *r* - 20,008 feet south  
Bound *u* - 5,229.73 feet north



**WESTERLY VIEW**



**EASTERLY VIEW**

LINE BOUND *u*

ROUGH GRANITE MONUMENT

PAVED HIGHWAY

Beginning at the intersection of Connecticut Routes 14A and 14, east of the village of Oneco, proceed westerly on Route 14 to an intersecting highway at 0.25 miles. Proceed northerly on Gibson Hill Road to intersection of Snake Meadow Hill Road at 3.05 miles. Proceed easterly on Snake Meadow Hill Road to bound at 3.9 miles.

Bound is located 11 feet north of the center of the traveled way, at the southeast corner of a small private cemetery. The road is descending easterly, opposite the bound. There is a stable area off the highway, opposite the bound. Rising pastureland lies to the north. Bound is 7.7 feet from the northeast corner of Griffith's Cemetery stone wall.

An irregularly shaped, rough granite monument showing 3.1 feet above the ground marks the bound. It measures 12" X 12" at the ground and 10" X 5" at the top. It is lettered "RI" on the east face and "C" on the west face.

The 1941 commissioners accepted the monument as correctly marking a point on the line established in 1840.

NAD 27

N = 331,376.87

E = 861,863.97

Bound *u - t* 5,229.73 feet S 1° - 44' - 03.3" EBound *u - v* 11,404.63 feet N 2° - 15' - 01.2" W



**WESTERLY VIEW**



**NORTHEASTERLY VIEW**

LINE BOUND V

ROUGH GRANITE MONUMENT

PAVED HIGHWAY

Beginning near the state line on U.S. Route 6 in the town of Foster, Rhode Island, proceed southerly on Cucumber Hill Road 1.6 miles to the intersection with South Killingly Road. Proceed westerly on South Killingly Road in Rhode Island (Saw Mill Hill Road in Connecticut) 0.35 miles to the bound. The bound is positioned northeasterly of the intersection of Saw Mill Hill Road to the west and South Killingly Road to the northwest.

Bound is located 19 feet north of the center of the traveled way. It is 35 feet south of the southwest corner of a residence to the northeast. There are residences located to the southwest, northeast, and due west with level residential grounds on all sides. A Sterling town line sign straddles the bound.

A rough granite monument showing 3.4 feet above the ground marks the bound. It measures 15" X 8" at the ground and 14" X 5" at the top. A 10" X 4 1/2" portion of the top is missing from the western side. There is the remains of a 1/4" drill hole, 2" deep. The bound is lettered "R1" on the east face and "C" on the west face.

The 1941 commissioners accepted the monument as correctly marking a point on the line established in 1840.

Bound *u* 11,404.63 feet south  
Bound *w* 1,544 feet north





**WESTERLY VIEW**



**WESTERLY VIEW**

**RESTORATION REPORT - 1998****ANGLE BOUND W****STERLING - KILLINGLY TOWN CORNER**

ROUGH GRANITE MONUMENT

INTERIOR TOWN CORNER

Beginning near the state line on U.S. Route 6 in the town of Foster, Rhode Island, proceed southerly on Cucumber Hill Road 1.5 miles to a gate blocking a pasture road on the right. (see following sketch)

From the westerly edge of Cucumber Hill Road proceed in a westerly direction on said pasture road 950 feet to a point where the road flares out into a gravel bank. See sketch. From this point in the center of the road, the bound is S 66° W, a distance of 423 feet. This course crosses the expanse of the gravel bank and climbs up a steep slope to the bound.

Bound is located 37.5 feet east of a stone wall to the west. It is located on the top of the northwesterly rim of the gravel bank, with woodland rising southwesterly and falling away westerly and northerly.

The bound appeared to be broken below the surface during the 1997 Perambulation. It could easily be manipulated by hand, however it was plumb.

Bound is marked by a rough granite monument showing 2.5 feet above the ground. It measures 9" X 13" and is lettered "RI" on the east face and "C" on the west face. It has a 3/8" drill hole 1/4" deep.

The 1941 commissioners accepted the monument as correctly marking a point on the line established in 1840.

Continued

Continued

North of the bound at a distance of 1.5 feet, there is a roughly dressed granite monument showing 2.1 feet above the ground. It is 14 inches square and is lettered "R1" on the east face, "K" on the north face, "S" on the south face and "C" on the west face. Monument has a 1/2" drill hole, 3/4" deep. It was set by town commissioners and has no official significance.

### **DESCRIPTION OF REPAIR**

The bound was repaired in place. The repair of the bound consisted of first setting ties to the bound in its present location. The bound was then excavated 1.5' radius around bound to approximate base of bound @ 18" below grade. One 1/2" diameter hole was then drilled into each face of the bound below grade and rebar installed horizontally to reinforce. The excavation was then filled with concrete to approximately 2-3" below ground level. The ties were then checked to confirm the position of the bound.

Approximately one week later returned to seal joint of collar/bound with epoxy paste and back filled repaired bound with local material.

Bound  $y$  - 1,544 feet south  
Bound  $x$  - 5,902 feet north

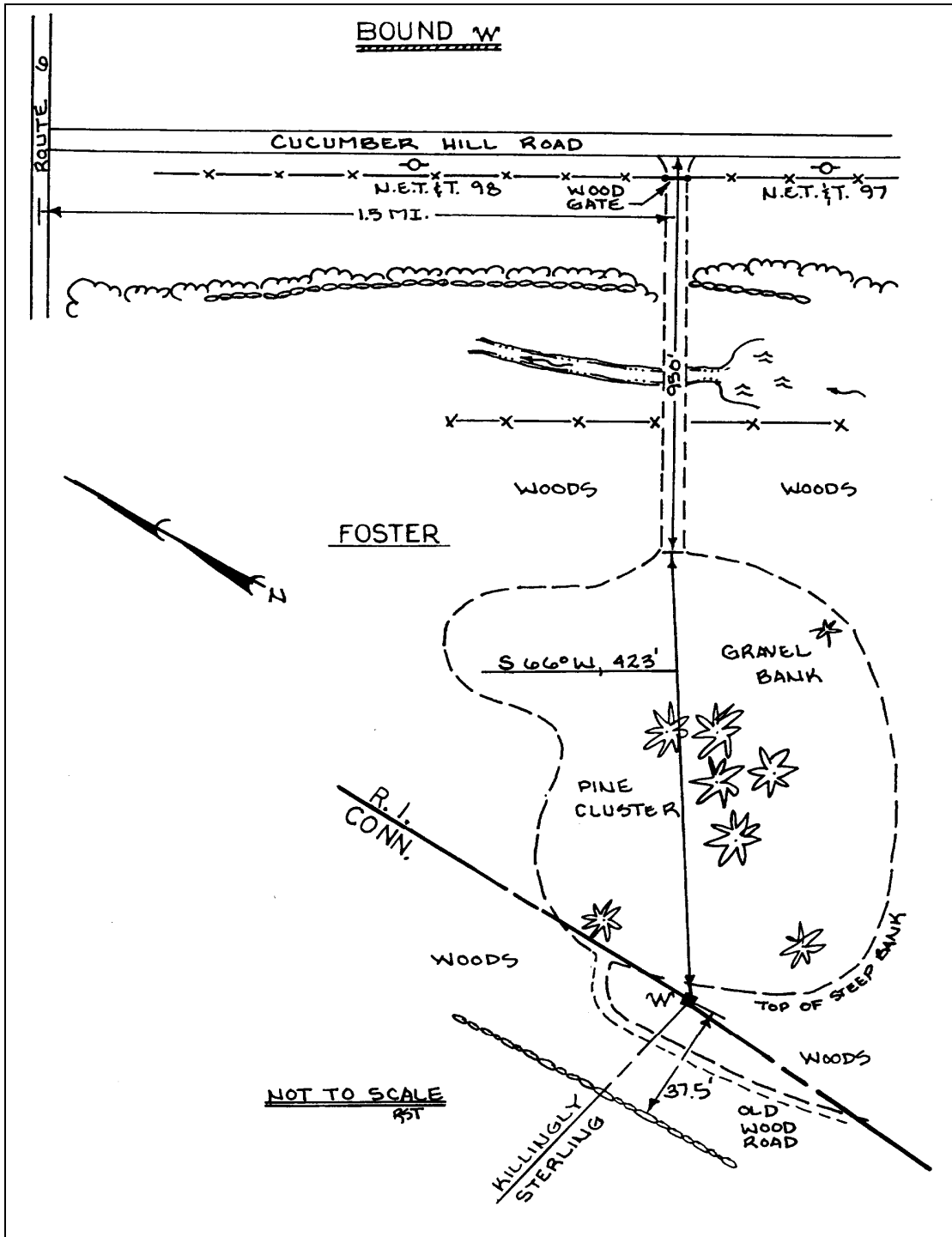

1997

CONNECTICUT- RHODE ISLAND STATE BOUNDARY LINE PERAMBULATION  
CONNECTICUT DEPARTMENT OF TRANSPORTATION









**WESTERLY VIEW**



**SOUTHEASTERLY VIEW**



# CT / RI LINE - SECTION 7

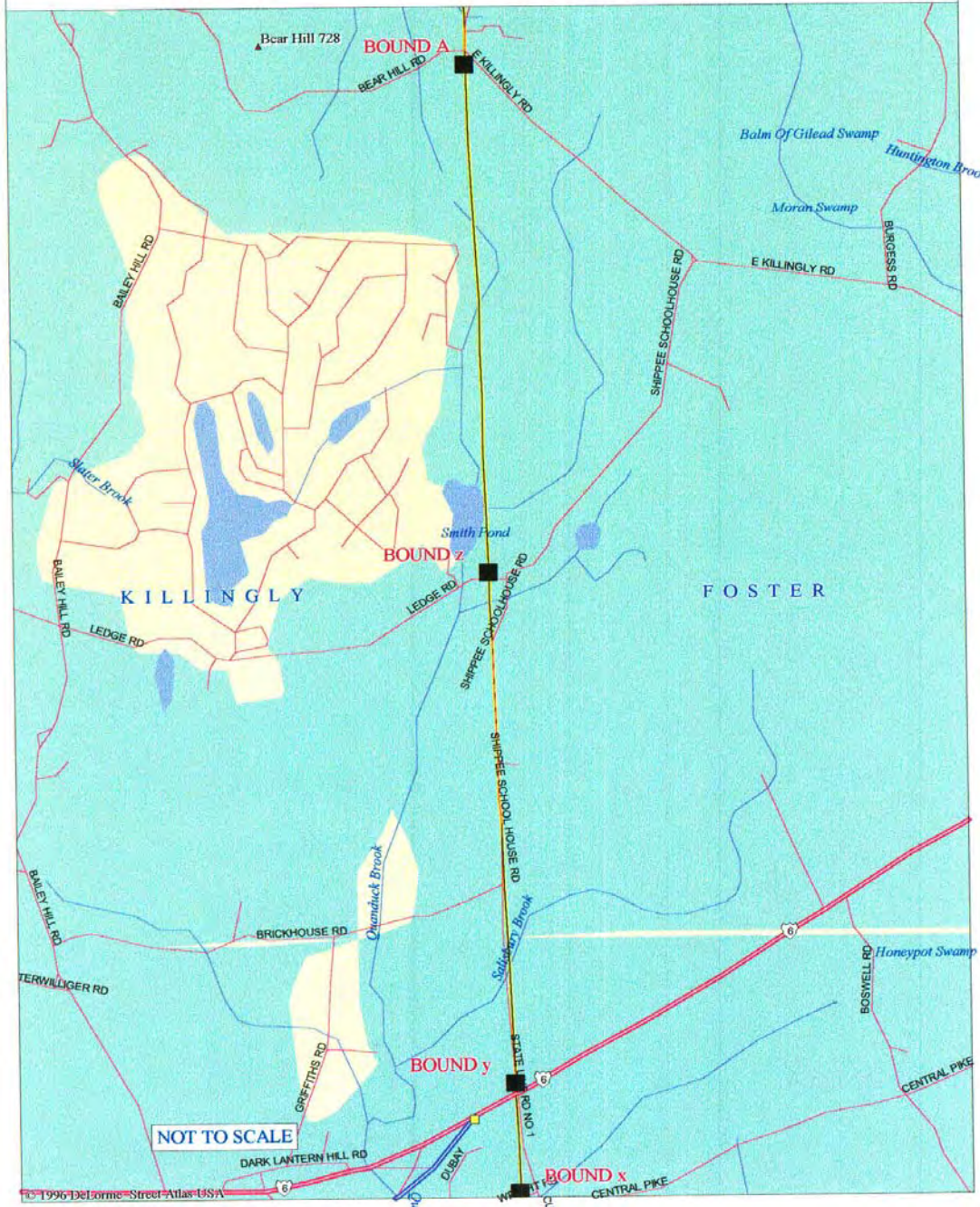

1997

CONNECTICUT- RHODE ISLAND STATE BOUNDARY LINE PERAMBULATION  
CONNECTICUT DEPARTMENT OF TRANSPORTATION

LINE BOUND x

ROUGH GRANITE MONUMENT

GRAVEL ROAD

Beginning near the state line on U.S. Route 6 in the town of Foster, Rhode Island, proceed southerly on Cucumber Hill Road 0.3 miles to the intersection of Cucumber Hill Road with Wright Road to the west.

From the westerly edge of Cucumber Hill Road, follow the center of Wright Road for a distance of 267 feet to the bound.

The bound is located N 8° W, 58 feet from the center of Wright Road. There is a residence due south of the bound, and at 20 feet due west of the bound there is an end of a stone wall which parallels Wright Road running to the southwest. Scrub woodland lies on all sides.

Bound is marked by a rough granite monument showing 2.8 feet above the ground. It measures 14" X 7" and is lettered "RI" on the east face and "C" on the west face. Its shape at the top resembles a "parallelogram". It has a 1/2" drill hole, 1/2" deep.

The 1941 commissioners accepted the monument as correctly marking a point on the line established in 1840.

Bound *w* - 5,902 feet south  
Bound *z* - 9,688 feet north



**SOUTHEASTERLY VIEW**



**SOUTHWESTERLY VIEW**



**LINE BOUND y**

ROUGH GRANITE MONUMENT

PAVED HIGHWAY

Beginning from the intersection of highways on U.S. Route 6 in the center of the village of South Killingly, proceed easterly 2.2 miles on Route 6 to supposed bound location at the intersection of Route 6, Shippee School House Road and Cucumber Hill Road.

Bound was located on the north side of Route 6 and about 40 feet west of the center of the gravel road to the north. It was in place in 1915, but had been removed before 1936, presumably in connection with highway improvements.

A rough granite monument measuring 16" X 11" and 6 feet long marked the bound. It was lettered "RI" with an anchor cut above and "1840" below the letters on the east face and "C" on the west face. A hitching ring was leaded into the top. At the time of the 1976 perambulation, the displaced bound was lying behind the barn, located behind the house at the northeast corner of the intersection. An attempt was made to locate the bound in November of 1986 with no success, and 1997 reconnaissance efforts had no success in recovery.

The 1941 commissioners agreed that a relocation of this bound is impossible and that it be disregarded in the location of the line established in 1840.

LINE BOUND z

ROUGH LIMESTONE MONUMENT

GRAVEL ROAD

Beginning at the intersection of U.S. Route 6 with Shippee School House Road to the north at the state line in the town of Killingly, proceed northerly 1.5 miles on Shippee School House Road to the junction with Ledge Road. Ledge Road is a well-maintained gravel road situated on the westerly side of Shippee School House Road. Proceed westerly on Ledge Road, a distance of 0.05 miles to the bound.

Bound is located 12 feet north of the center of the traveled way, in scattered remains of the southerly road wall, and at the end of the line wall to the north. Road descends westerly opposite the bound. Woodland rises to the northeast and woodland beyond drops away to the northwest. There is a 6' high cut bank at the south side of the road, with a stone wall opposite the bound, beyond which there are 2 residences.

Bound is marked by a rough, sandy limestone monument showing 3 feet above the ground. It measures 12" X 5" and is lettered "RI" on the east face and "C" on the west face. Monument has weathered to such an extent that the "C" is almost obliterated and only traces of the "RI" remain. Remains exist of a 1/2" drill hole, 1/2" deep.

The 1941 commissioners accepted the monument as correctly marking a point on the line established in 1840.

Bound *x* - 9,688 feet south  
Bound A - 8,282 feet north



**NORTHERLY VIEW**



**WESTERLY VIEW**

**LINE BOUND A**

ROUGH LIMESTONE MONUMENT

PAVED HIGHWAY

Beginning at the state line on Connecticut Route 101 at bound "B" in the town of Killingly, proceed southerly on East Killingly Road to its intersection with Bear Hill Road, a distance of 0.7 miles.

Bound is located 24 feet south of projected centerline of Bear Hill Road, and 12 feet southwest of the center of the Rhode Island portion of East Killingly Road. It is also 7.5 feet northeast of the center of a stone wall running parallel along the southwest edge of East Killingly and Bear Hill Roads. Paved highway descends to the west and to the north, and rises to the southeast. Residences lie to the east and west with woodland dropping away to the northwest.

Bound is marked by a rough, sandy limestone monument showing 2.6 feet above the ground. It measures 9" X 6" and is lettered "RI" on the east face and "C" on the west face. Bound has a 3/4" drill hole, 1/4" deep. Bound is leaning toward the north.

The 1941 commissioners accepted the monument as correctly marking a point on the line established in 1840.

BOUND z - 8,282 feet south  
 BOUND C - 5,034 feet north  
 CGS 4076 - 10.9'



**WESTERLY VIEW**



**NORTHWESTERLY VIEW**



# CT / RI LINE - SECTION 8

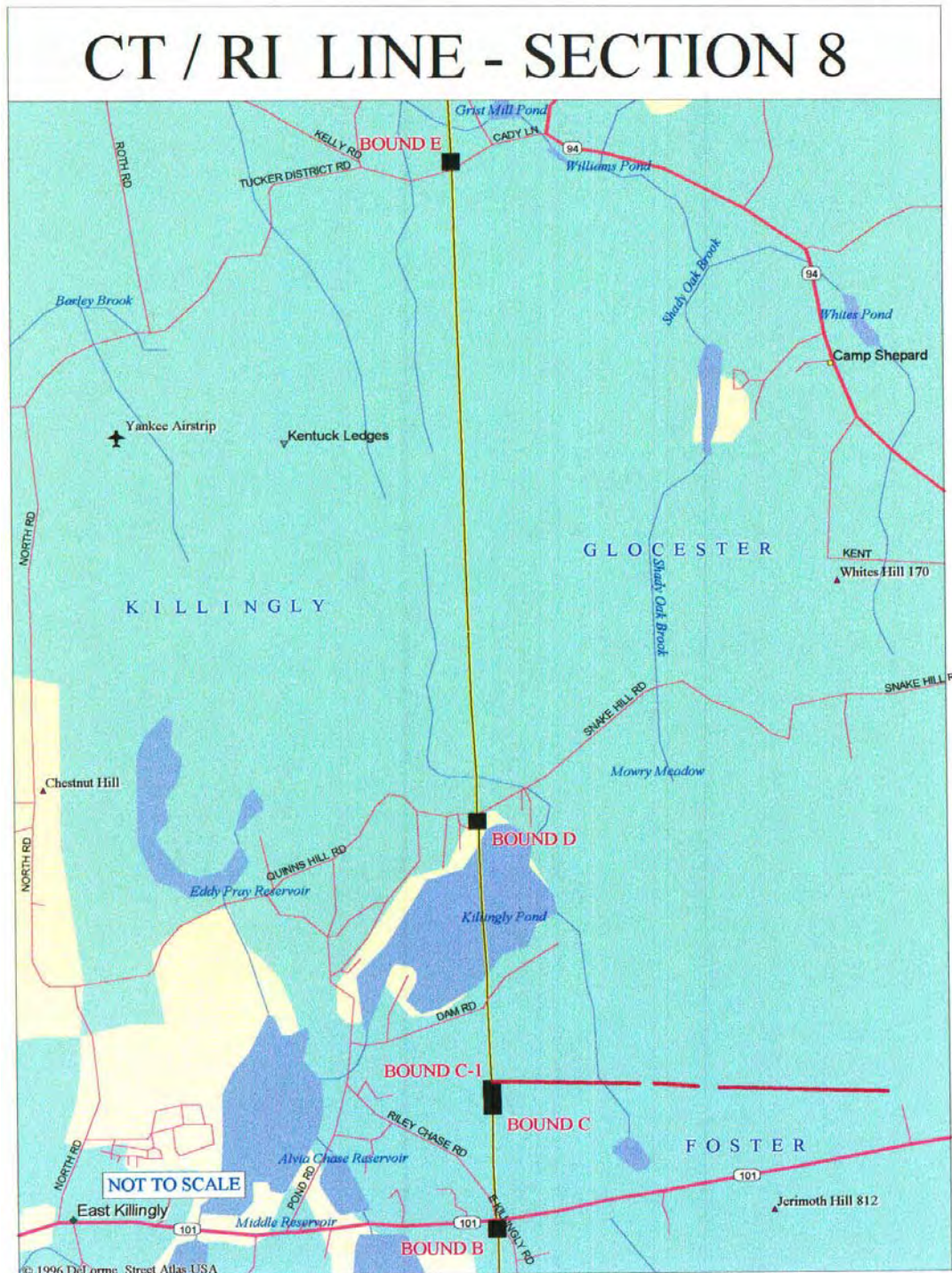

1997

CONNECTICUT- RHODE ISLAND STATE BOUNDARY LINE PERAMBULATION  
CONNECTICUT DEPARTMENT OF TRANSPORTATION

**LINE BOUND B**

ROUGH GRANITE MONUMENT

PAVED HIGHWAY

Beginning at the intersection of Interstate 395 and Connecticut Route 101 in the town of Killingly, proceed southeasterly on Route 101, a distance of 4.7 miles, to the bound. (See sketch following description for bound C-1)

Bound is located at the intersection of Route 101, Riley Chase Road and East Killingly Road. The bound is 37.5 feet due south of the center of Route 101, and 36 feet due west of the center of East Killingly Road. The original bound was moved by the Rhode Island State Highway Department in 1957, approximately 17 feet southerly of its original position.

The 1941 commissioners accepted the original monument as marking a point on the line established in 1840. However, the geographic position and coordinate values shown by the 1940 Connecticut Rhode Island Boundary Survey are now void due to the revised location, and the existing bound is no longer considered as marking the line.

The new position of Bound "B" is shown on Connecticut Highway Department Right-of-Way Map #68-07, sheet 5 of 5, revised October 16, 1957. A rough, sandy, limestone monument showing 1.5 feet above the ground marks the bound. It measures 10" X 8", is lettered "RI" on the east face and "C" on the west face. It is irregular in shape with a 1/4" drill hole, 1/4" deep.

NET&amp;T Pole No. 225 – 13.5 Feet East



**SOUTHEASTERLY VIEW**



**SOUTHEASTERLY VIEW**



**ANGLE BOUND C****ROUGH LIMESTONE MONUMENT****INTERIOR ANGLE**

Beginning at the state line on Connecticut Route 101 at bound "B" in the town of Killingly, proceed northwesterly 0.3 miles on Riley Chase Road (see sketch following bound C-1 description) to a gravel road running northeasterly. The gravel road is between CL&P pole numbers 2716 and 2717. Proceed northeasterly on gravel road to a point where the road terminates at a driveway on the right at a woods road, a distance of 535 feet from the center of Riley Chase Road.

Follow woods road northeasterly 281 feet to an intersection of woods roads. Proceed N 65° E, 100 feet to the next intersection of woods roads. Proceed southeasterly, a total distance of 275 feet on woods road, to a point near the south end of an abandoned quarry. Proceed from this point S 55° E, 66 feet through woodlands and white pines, along the easterly side of the abandoned quarry, to Bound C-1. Proceed S 12° W, 247 feet to the bound.

Bound is located in woodland with dense mountain laurel, which is relatively level on all sides.

Bound is marked by a rough, sandy limestone monument showing 3.4 feet above the ground. It measures 7" X 9" and is lettered "RI" on the east face, "G" on the north face, "F" on the south face and "C" on the west face. It stands in a stone heap and formerly marked the Gloucester-Foster town corner, now marked by Bound C-1.

The 1941 commissioners accepted the monument as correctly marking the line established in 1840.

BOUND A – 5,034 feet south  
 BOUND C-1 – 247 feet north  
 BOUND D – 4,881 feet north



**WESTERLY VIEW**



**NORTHWESTERLY VIEW**



**UNOFFICIAL BOUND C-1****GLOCESTER - FOSTER TOWN CORNER**

ROUGH GRANITE MONUMENT

INTERIOR TOWN CORNER

Beginning at the state line on Connecticut Route 101 at bound "B" in the town of Killingly, proceed northwesterly 0.3 miles on Riley Chase Road (see sketch) to a gravel road running northeasterly. The gravel road is between CL&P pole numbers 2716 and 2717. Proceed northeasterly on gravel road to a point where the road terminates at a driveway on the right at a woods road, a distance of 535 feet from the center of Riley Chase Road.

Follow woods road northeasterly 281 feet to an intersection of woods roads. Proceed N 65° E, 100 feet to the next intersection of woods roads. Proceed southeasterly, a total distance of 275 feet on woods road to a point near the south end of an abandoned quarry. Proceed from this point S 55° E, 66 feet through woodlands and white pines, along the east side of the abandoned quarry, to the bound.

Bound is located in generally level woodland, about 30 feet east of the southerly apex of a small, shallow, triangular shaped abandoned quarry.

Bound is marked by a roughly split, pink granite monument showing 3.5 feet above the ground. It measures 4" X 12" and is lettered "G" on the north face and "F" on the south face. It stands in a small stone heap.

Monument was erected in 1875 by a Rhode Island commission that established the Gloucester-Foster town line. The 1941 commissioners agreed that the monument should not be considered as marking a point on the line established in 1840.

BOUND C - 247 feet south  
BOUND D - 4,634 feet north

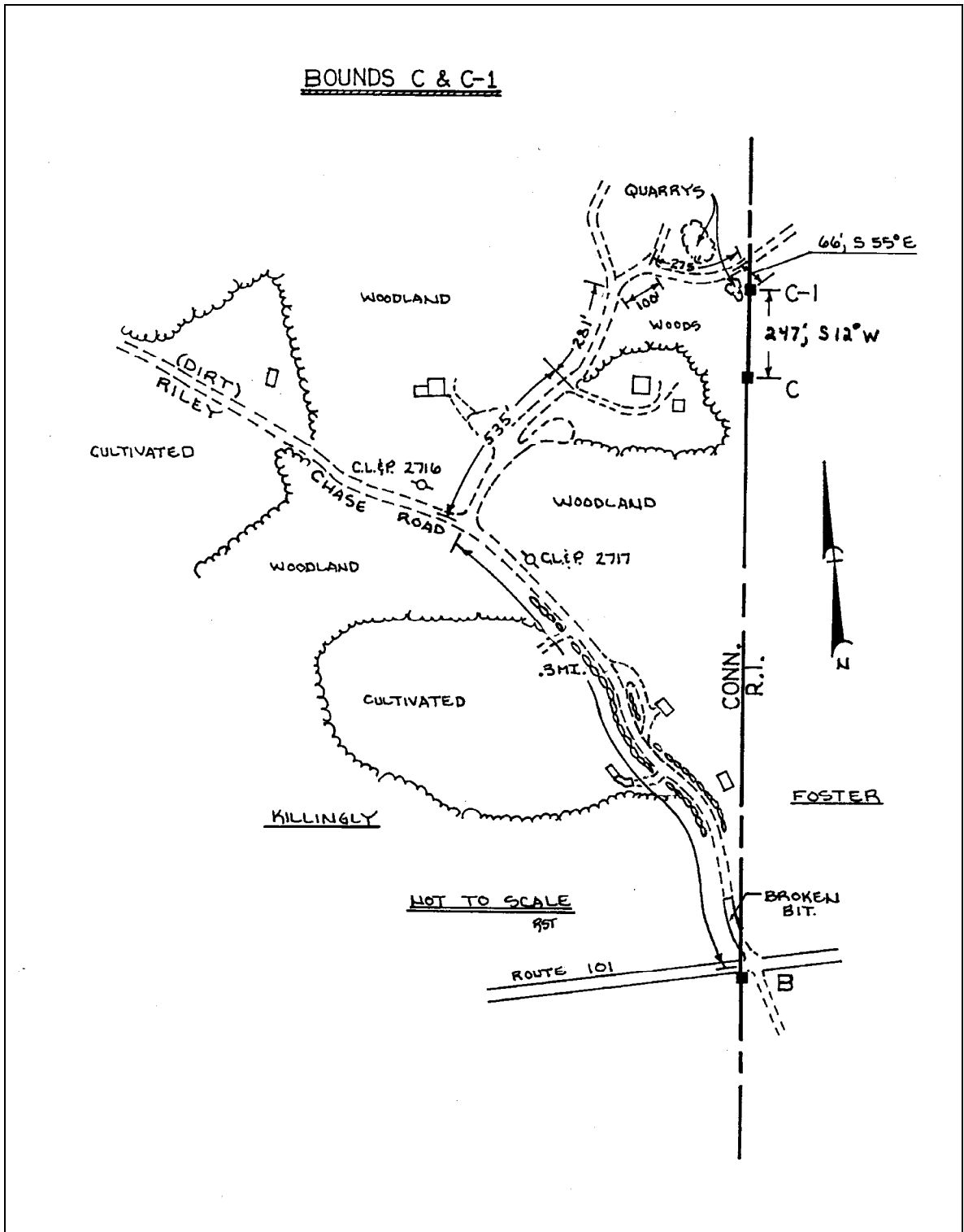

1997



**NORTHERLY VIEW**



**NORTHERLY VIEW**

LINE BOUND D

ROUGH GRANITE MONUMENT

GRAVEL ROAD

Beginning at the intersection of Connecticut Route 101 and Pond Road in the town of Killingly, proceed northeasterly on Pond Road 0.8 miles, to where the road surface changes to gravel, just beyond Killingly Pond. From Killingly Pond, follow gravel road 0.4 miles to a well-defined, three-way intersection of gravel roads come into the intersection from the west, southeast and northeast. There is a dwelling situated to the northwest of the intersection. Proceed northeast on a passable gravel road 0.8 miles to the bound.

Bound is located 7 feet south of the center of the traveled way, in a low swale north of Killingly Pond. The road rises steeply to the west and slightly to the east. Level woodland lies north and south of the road. The road crosses the swale on an embankment about 3 feet above the level of the woodland.

Bound is marked by a roughly split, pink granite monument lying on its edge in the road fill. It measures 5" X 18", and is lettered "RI" on the east face and "C" on the west face. The top is broken off, leaving only the bottom half of the letters.

The 1941 Commissioners agreed that the monument had been disturbed since it was set and that it should not be considered as marking a point on the line established in 1840.

BOUND C - 4,881 feet south  
 BOUND C-1 - 4,634 feet south  
 BOUND E - 10,280 feet north





**NORTHERLY VIEW**



**NORTHWESTERLY VIEW**

LINE BOUND E

ROUGH GRANITE MONUMENT

GRAVEL ROAD

Beginning at the intersection of Putnam Heights Road and U.S. Route 44 in the village of West Glocester, Rhode Island, proceed southwesterly on Putnam Heights Road 0.05 miles to bound "G". At this point the road becomes Five Mile River Road in Connecticut. Proceed 1 mile to the intersection of Blood Road on the left. Proceed southeasterly on Blood Road 0.4 miles to where the pavement ends at the Putnam-Killingly town line. Proceed on gravel road, passing approximate location of Bound "F" on the left at 0.3 miles. From this point, continue an additional 0.3 miles, to the intersection with Kelly Road. Proceed westerly from the intersection on Kelly Road 0.1 miles to the bound.

Bound was located 14 feet north of the center of the traveled way against the north road wall and was 15 feet east of a wall intersection. Said wall runs northeasterly into the woods. The road is level to the east, rising slightly to the west about 160 feet to a summit opposite a residence on the north side of the road. Pine woods drops away to the north. Across the road, pine and maple woods rise slightly to the south.

Bound was marked by a roughly split, granite monument showing 3.2 feet above the ground. It measured 5" X 16" at the ground and 5" X 12" at the top. It was lettered "RI" on the east face and "C" on the west face. Bound was leaning to the north.

The 1941 commissioners accepted the monument as correctly marking a point on the line established in 1840.

The 1997 survey reconnaissance efforts did not succeed in recovering the monument.

BOUND D - 10,280 feet south  
BOUND F - 1,650.25 feet north

# CT / RI LINE - SECTION 9

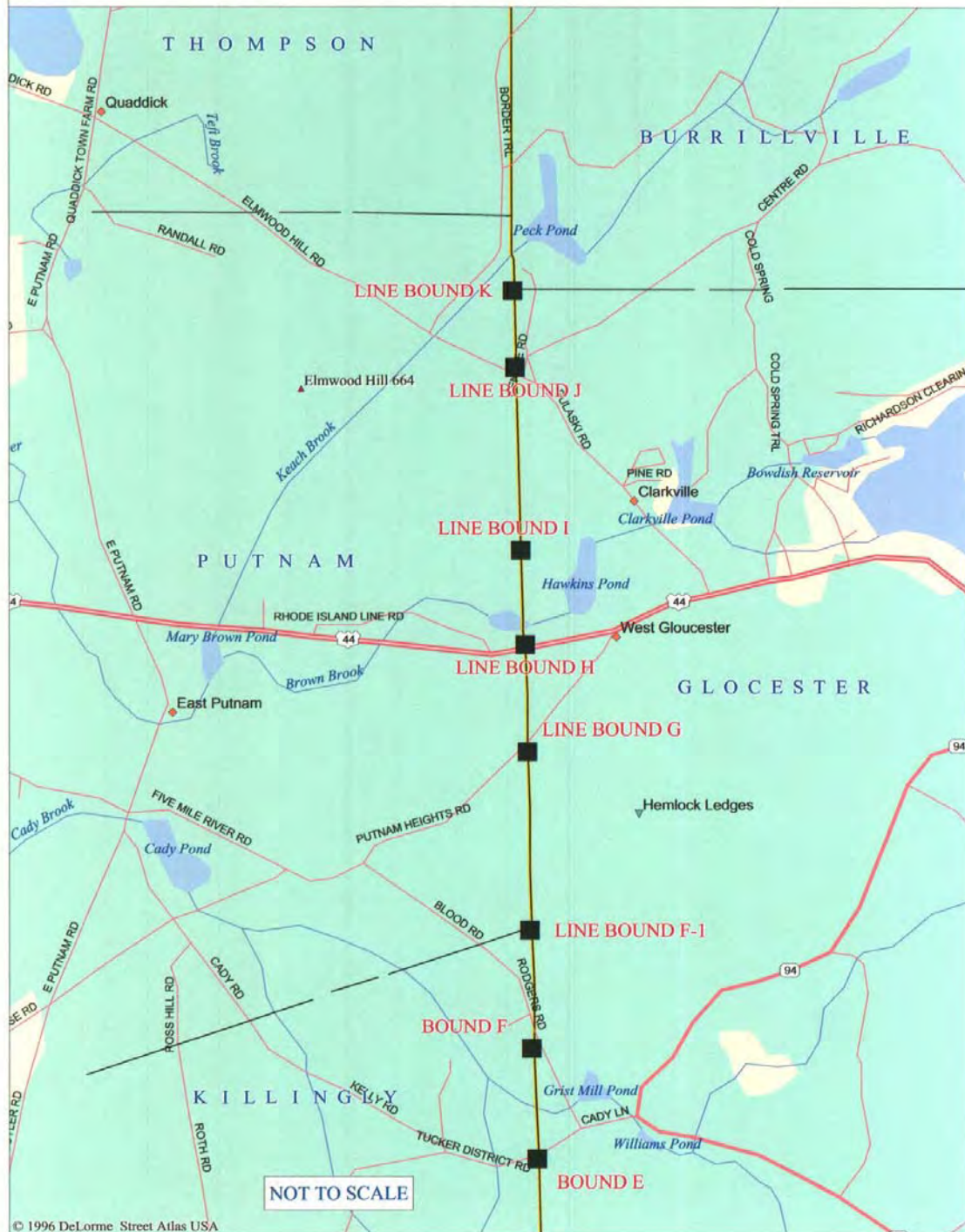

1997

CONNECTICUT- RHODE ISLAND STATE BOUNDARY LINE PERAMBULATION  
CONNECTICUT DEPARTMENT OF TRANSPORTATION

**LINE BOUND F**

## REGULATION GRANITE MONUMENT

## GRAVEL ROAD

Beginning at the intersection of Putnam Heights Road and U.S. Route 44 in the village of West Glocester, Rhode Island, proceed southwesterly on Putnam Heights Road in Rhode Island and Five Mile River Road in Connecticut, 1 mile to the intersection of Rogers Road on the left. Proceed southeasterly on Rogers Road to where pavement ends at the Putnam-Killingly town line at 1.4 miles. Proceed southeasterly on Rogers Road to original location of bound at 1.7 miles.

The 1997 Perambulation Survey found a newer regulation granite monument, more particularly described as follows:

The new bound is located 12.4 feet west of the center of the traveled way. The road is rising slightly to the south, with pine woodland rising to the east and dropping away to the southwest. Woodland drops away to a farm to the northwest. SNET pole number 1575 is 53 feet to the north of the bound in Connecticut. NET&T pole number 1 is 40 feet southeast of the bound, in Rhode Island.

Bound is marked by a regulation granite monument 9 feet long and showing 3.6 feet above the ground level. It is 12 inches by 12 inches and is lettered "RI" on the east face, "CONN" on the west face, and "1990" on the north face. Bound has a 5/8 inch drill hole, 1 1/2 inches deep in the top.

The bound was set on April 25, 1991 about 77 feet south of the original monument location.

The 1941 commissioners accepted the original monument as correctly marking a point on the line established in 1840.

NAD 27  
N = 389,988.38  
E = 859,395.90

Trig-Station Rogers - 48.1 feet west  
BOUND F-E 1,650.25 feet S 2° - 0' - 47.2" E  
BOUND F-G 4,482.37 feet N 2° - 7' - 39.9" W





**WESTERLY VIEW**



**NORTHERLY VIEW**



**UNOFFICIAL BOUND F-1****KILLINGLY - PUTNAM TOWN CORNER**

DRESSED GRANITE MONUMENT

INTERIOR TOWN CORNER

Beginning at the intersection of Putnam Heights Road and U.S. Route 44, in the village of West Glocester, Rhode Island. Proceed southwesterly a total of 1 mile along Putnam Heights Road in Rhode Island, crossing the state line into Connecticut where Putnam Heights Road becomes Five Mile River Road, to its intersection with Blood Road on the left. (See following sketch) Proceed southeasterly 0.4 miles on Blood Road to the Putnam-Killingly town line. An old woods road is about 100 feet north of the town line, east of a farmstead. Proceed easterly on this old woods road, 332 feet up the center of the wheel track, to the westerly edge of a pasture. Proceed up a slope N 67° E, in line with a barn, to a barway situated on the northeast side of the barn, 173 feet from the end of the woods road and edge of pasture.

Proceed northeasterly from the barway 288 feet, following a wheel track up a slope into woodlands, to a four-way intersection. Follow trail down slope, southeast 300 feet into a narrow valley, to a point opposite the bound.

The bound is S 88° E, 59 feet from the center of the trail up a slope. It is situated on the southwesterly slope of a wooded ridge. Slope falls away to the southwest into a swamp. Woodland rises to the north and east. There is a high ledge outcrop due south and another to the southwest some distance away.

A rough dressed granite monument, showing 2.9 feet above the ground, marks the bound. It measures 12" square. It is lettered "K" on the south face, and "P" on the north face.

No bound was established in this area in 1840, and the 1941 commissioners agreed that the monument should not be considered as marking a point on the line established in 1840. It was presumably set in 1895 when the Putnam-Killingly town line was resurveyed and monumented, being shown on the official map of that date.

BOUND E - 3,382 feet south  
 BOUND F - 1,733 feet south  
 BOUND G - 2,749 feet north

1997

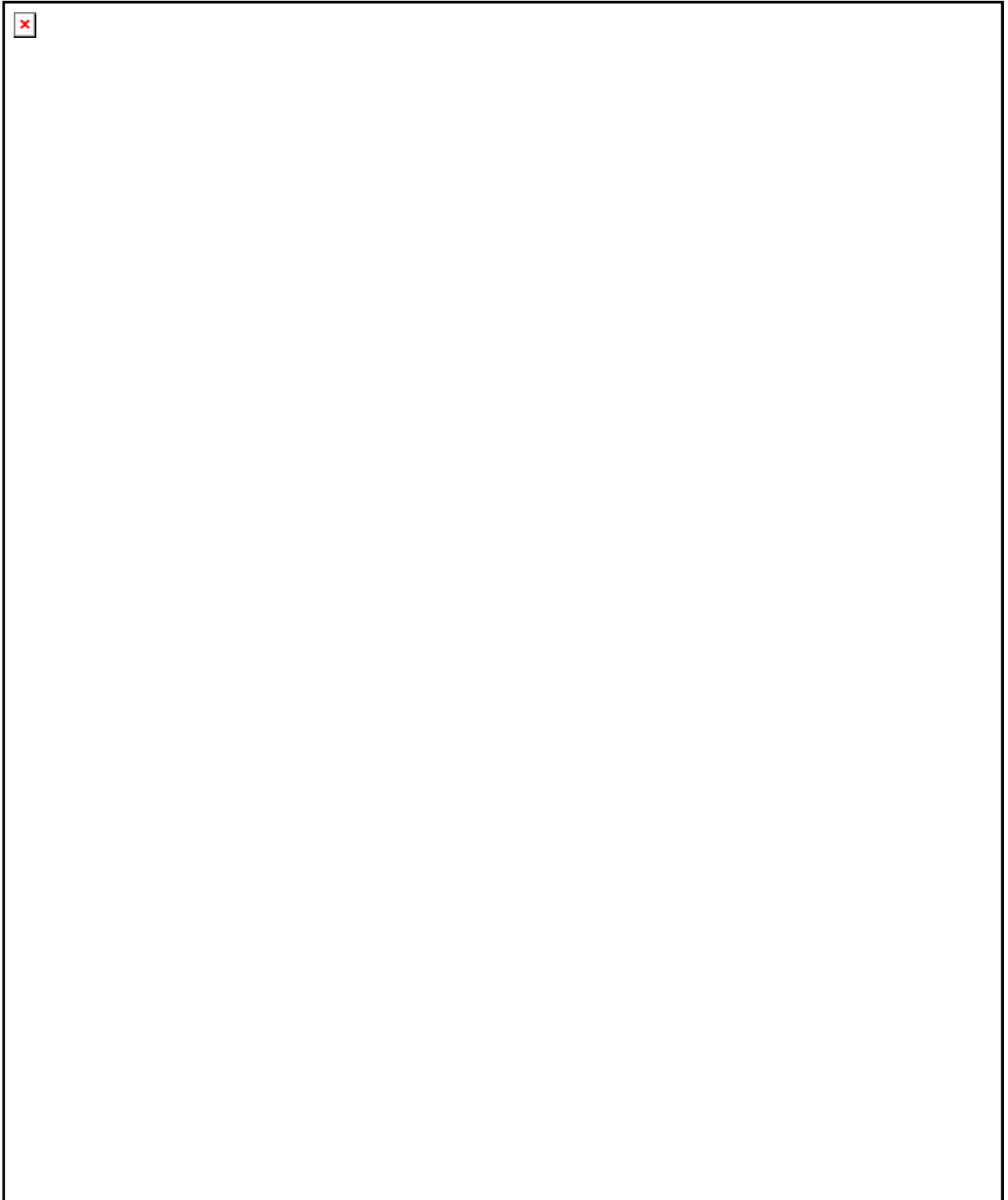



**NORTHERLY VIEW**



**SOUTHWESTERLY VIEW**

**LINE BOUND G**

ROUGH GRANITE MONUMENT

PAVED HIGHWAY

Beginning at the intersection of Putnam Heights Road and U.S. Route 44, in the village of West Glocester, Rhode Island, proceed southwesterly on Putnam Heights Road in Rhode Island (Five Mile River Road in Connecticut) 0.45 miles to the bound.

The bound is located 16 feet southeast of the center of the traveled way, and 4 feet northwest of the southeast highway wall. There is a homestead on rising land to the north, across the highway. Scrub woodland drops away to the south. The highway is descending southwesterly, opposite the bound.

A rough, granite monument, showing 2.2 feet above the ground, marks the bound. It is irregular in shape, measuring 13" X 8" at the ground and 14" X 2" at the top. It has an irregularly shaped 1/4" drill hole, 1/2" deep. It is lettered "RI" on the east face and "C" on the west face.

The 1941 commissioners accepted the monument as correctly marking a point on the line established in 1840.

BOUND F - 4,482.37 feet south  
 BOUND F-1 - 2,749 feet south  
 BOUND H - 1,540 feet north





**EASTERLY VIEW**



**NORTHEASTERLY VIEW**

LINE BOUND H

ROUGH GRANITE MONUMENT

PAVED HIGHWAY

Beginning at the intersection of Putnam Heights Road and U.S. Route 44, in the village of West Glocester, Rhode Island, proceed westerly 0.3 miles on U.S. Route 44 to the bound location.

Bound location was 40 feet north of the center of the traveled way, and 20 feet north of the easterly post in the guide rail fence, at the edge of a pond. The highway, which has four lanes in Rhode Island and two lanes in Connecticut, is level opposite the bound, with the pond to the north. There is a 1 1/2-story frame house south of the bound, a 2-story stone and frame house to the southeast, and heavy woodland to the southwest across the highway.

Bound was a rough granite monument lying completely on its side in swampy ground at the edge of the pond. It was irregularly shaped, measuring 14" X 7" at the top and was 4.2 feet long. It was lettered "RI" on the east face and "C" on the west face. The monument was removed and stored in a maintenance garage. The 1997 survey reconnaissance efforts did not succeed in recovering the bound.

The 1941 commissioners agreed that the monument may have been moved appreciably and should not be considered as marking a point on the line established in 1840.

BOUND G - 1,540 feet south  
BOUND I - 1,394 feet north

**LINE BOUND I****OLD KILLINGLY - THOMPSON TOWN CORNER**

ROUGH GRANITE MONUMENT

INTERIOR INTERMEDIATE POINT

Beginning at the intersection of Rhode Island Line Road and U.S. Route 44 in the town of Putnam, proceed northwesterly 0.1 miles on Rhode Island Line Road, along the southerly edge of a pond, to a gravel road. Said gravel road is located on the northeasterly side of Rhode Island Line Road. (See following sketch)

Proceed northeasterly 415 feet on gravel road, going down a concrete ramp and changing back to gravel, to a brook and concrete bridge. Proceed southeasterly over concrete bridge, passing a residence on the right, for a distance of 400 feet. The gravel road ends at the house, a total distance of 815 feet from the center of Rhode Island Line Road. Continue easterly 126 feet to the center of a stone wall.

Proceed northerly along the stone wall 94 feet to a wall crossing. Proceed N 12° E, 478 feet to a wall running westerly and easterly. Proceed N 12° E, 250 feet to the bound.

Bound is located on the southeasterly side of a small clearing, with a mixture of pines, oaks, and varying deciduous trees all around. Land is level to the north, south and east, and rises slightly to the west.

A rough, granite monument, showing 3.4 feet above the ground marks the bound. It measures 18" X 5" at the ground, and 15" X 5" at the top. It is lettered "RI" on the east face and "C" on the west face. The bound is leaning to the east.

The 1941 commissioners accepted the monument as correctly marking a point on the line established in 1840.

BOUND H - 1,394 feet south  
BOUND J - 2,268 feet north

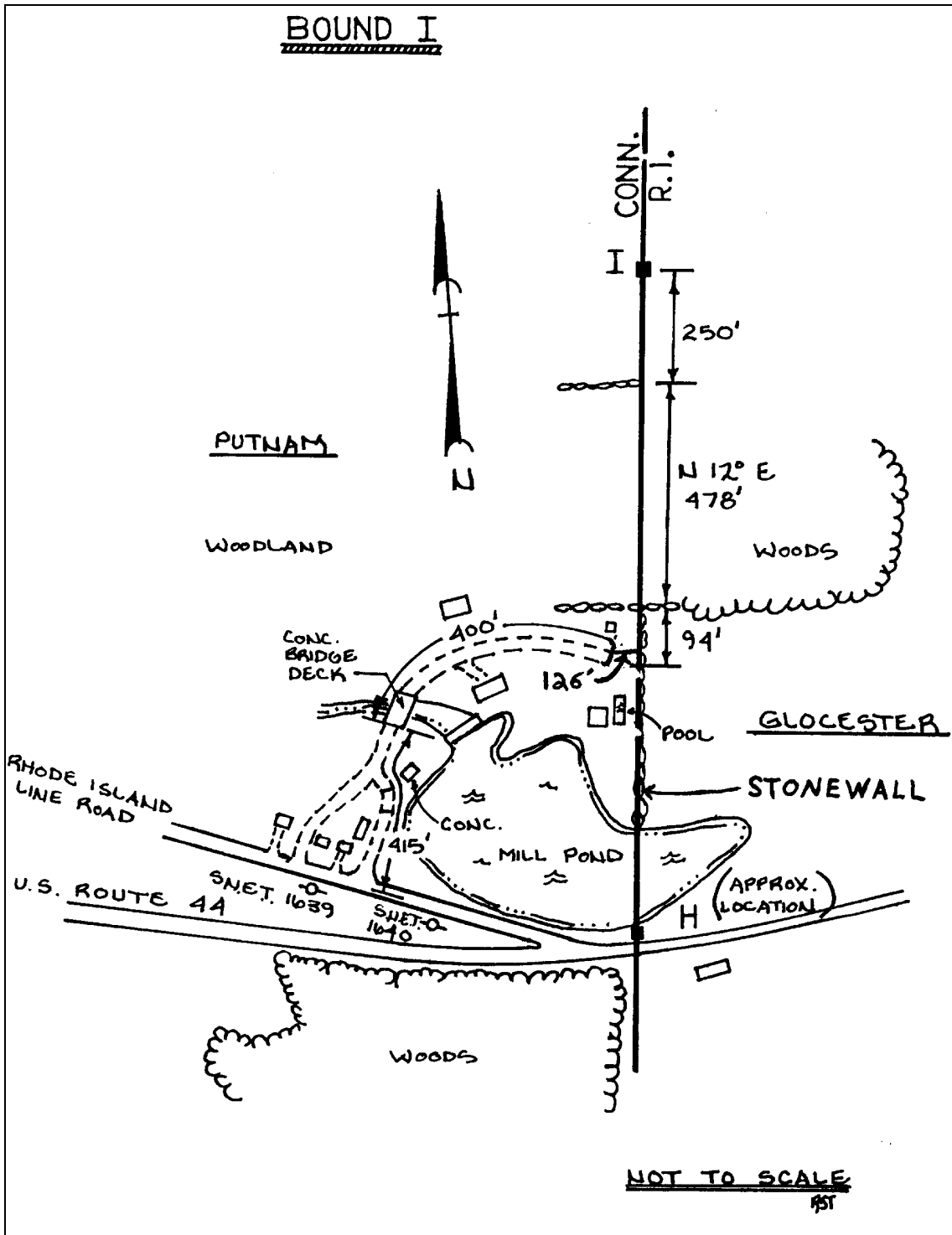

1997

CONNECTICUT- RHODE ISLAND STATE BOUNDARY LINE PERAMBULATION  
CONNECTICUT DEPARTMENT OF TRANSPORTATION



**EASTERLY VIEW**



**NORTHWESTERLY VIEW**



**LINE BOUND J**

ROUGH LIMESTONE MONUMENT

PAVED HIGHWAY

Beginning at the intersection of Putnam Heights Road and U.S. Route 44, in the village of West Glocester, Rhode Island, 0.3 miles east of the State Line, proceed easterly on U.S. Route 44 to Pulaski Road (on the left) at 0.3 miles. Proceed northwesterly on Pulaski Road, 0.8 miles to the entrance of Pulaski Memorial Recreation Area. Continue northwesterly on Pulaski Road 390 feet to the bound. It is 100 feet west of a barway, which is another entrance to the park.

The bound is located 13 feet north of the center of the traveled way. It is 6 feet south of the north highway wall, and 6.5 feet from the intersection of a stone wall running north to south from said north highway wall. Highway is straight and level opposite the bound, which is located with its top 6" below the ground in sloping road fill. It is 14.4 feet west of the center of the south trunk of twin crooked maples, 32 feet north of NET&T pole #35 and 22 feet south of CL&P pole #2031. Woodland lies north of the highway, with residences across the highway to the south and southwest.

A split, seamy, sandy limestone monument marks the bound. It measures 11" X 5" at the top, and when visible was lettered "RI" on the east face and "C" on the west face.

The 1941 commissioners accepted the monument as correctly marking a point on the line established in 1840.

BOUND I - 2,668 feet south  
BOUND K - 1,236 feet north



**AERIAL VIEW**



**SOUTHEASTERLY VIEW**

**ANGLE BOUND K****OLD GLOCESTER-BURRILLVILLE TOWN CORNER**

ROUGH GRANITE MONUMENT

INTERIOR ANGLE

Beginning at the intersection of Putnam Heights Road and U.S. Route 44, in the village of West Glocester, Rhode Island, 0.3 miles east of the state line, proceed easterly .3 miles on Route 44 to Pulaski Road. Proceed northwesterly on Pulaski Road 0.8 miles to the main entrance of Pulaski Memorial Recreation Area. Proceed northerly, into the park on Park Road, to a parking area located on the northwesterly side of Park Road. Proceed to the northwesterly corner of parking area, where a well maintained run-off gutter is located. Proceed from gutter S 60° W, 110 feet up slope, through cleared woodland with picnic facilities, to the bound.

Bound is located 5 feet east of the line wall at the line summit. A park service road lies immediately east of the bound with cleared, rolling woodland dropping away to the east and to the west. To the north, woodland drops away to Keach Pond.

An unshaped granite monument, showing 3.5 feet above the ground, marks the bound. It measures 14" X 8" at the ground, and is triangular at the top, measuring 9" X 9" X 9". It has a 1/2" drill hole, 3/4" deep in the center. It is lettered "RI" on the east face and "C" on the west face.

The 1941 commissioners accepted the monument as correctly marking an angle point in the line established in 1840.

BOUND J - 1,236 feet south  
 BOUND L - 10,804 feet north  
 BOUND K-M - 19835.22 feet north



**SOUTHWESTERLY VIEW**



**NORTHEASTERLY VIEW**



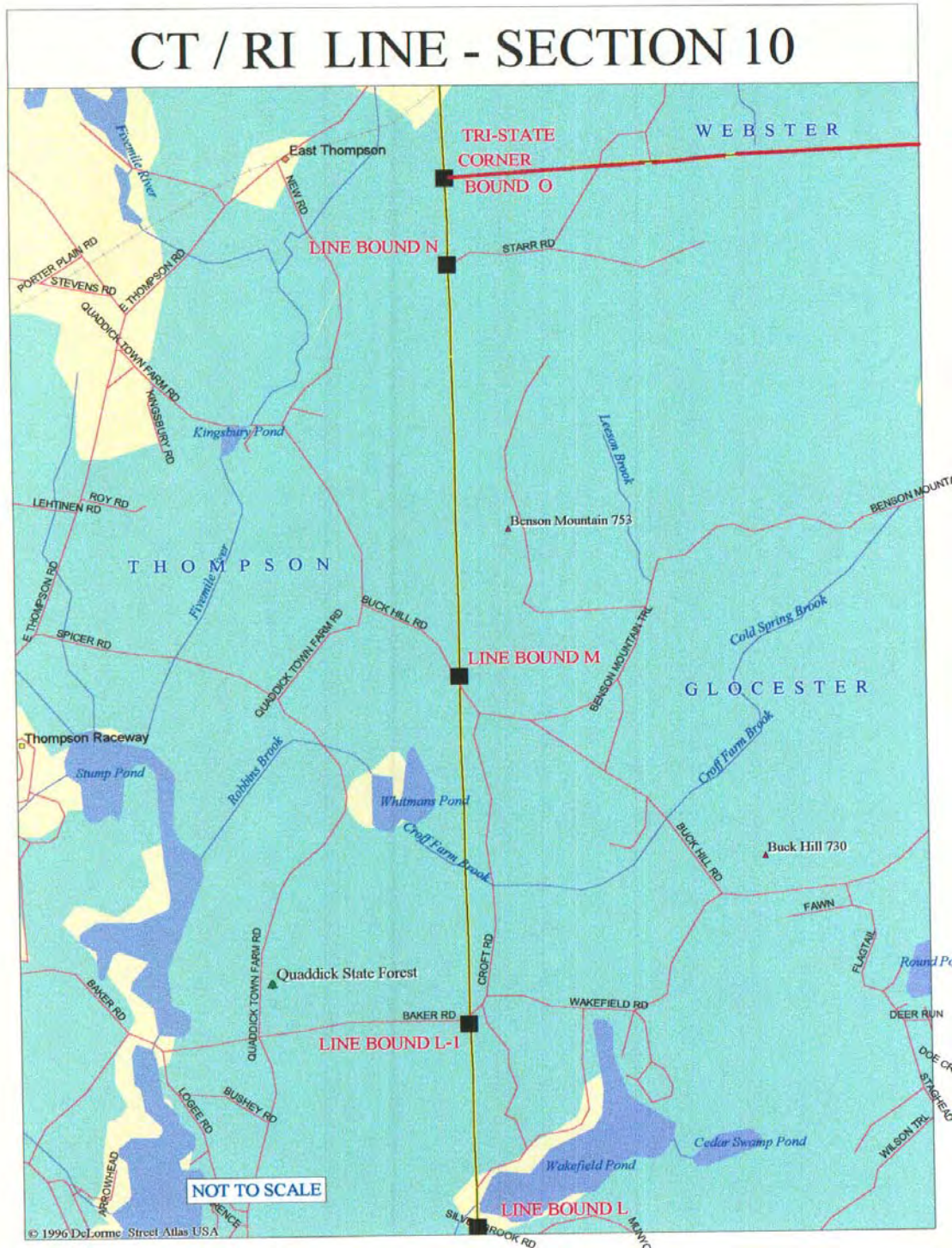



**LINE BOUND L**

ROUGH GRANITE MONUMENT

GRAVEL ROAD

Beginning at the intersection of Interstate 395 and U.S. Route 44, in the town of Putnam, proceed easterly 3.6 miles on Route 44 to East Putnam Road. Proceed northerly 1 mile, road changes to Quaddick Town Farm Road, proceed 2.85 miles going by Quaddick State Park to Baker Road, a gravel road heading easterly. Proceed easterly on Baker Road, 0.5 miles to a four-way gravel road intersection with Wakefield Pond Road running north and south. Proceed southerly and southeasterly on Wakefield Pond Road 0.6 miles to a point where the road turns to the southeast. Proceed 700 feet, from the point of intersection of the centerline of the road at the curve, to a point where the road crosses a stream. Said stream runs northeast to southwest. From this point measure up the center of the road from its intersection with the stream, 319 feet to the bound.

Bound is located 22 feet south of the centerline of the traveled way and 84 feet north of the southerly road wall. It is 55 feet east of the road summit and 60 feet west of a woods road leading north to Wakefield Pond. U.S.C.&G.S. monument (No. 4097) is near the roadside face of a large boulder, 11 feet north of the bound. The road is descending easterly, opposite the bound. Woodland drops away to the southeast and to the northeast to Wakefield Pond. Woodland is rising to the west.

A smoothly split granite monument showing 1.4 feet above the ground, marks the bound. It measures 17" X 6" and is lettered "RI" on the east face and "C" on the west face. The narrow, deep-cut letters are only 3" high.

The 1941 commissioners agreed that the monument differs in so many respects from the other 1840 monuments that it should not be accepted as marking a point on the line established in 1840.

BOUND K - 10,804 feet south  
 BOUND L-1 - 3,588 feet north  
 BOUND M - 9,032 feet north



**NORTHWESTERLY VIEW**



**NORTHERLY VIEW**

**LINE BOUND L-1****ROUGH GRANITE MONUMENT****GRAVEL ROAD**

Beginning at the intersection of Connecticut Route 193 and East Thompson Road in the town of Thompson, proceed northeasterly 2.3 miles on East Thompson Road to Quaddick Town Farm Road. Proceed southeasterly 1.2 miles on Quaddick Town Farm Road to Buck Hill Road. Proceed southeasterly 0.5 miles on Buck Hill Road to Croff Road on the right. Turn on to Croff Road, a well-maintained gravel and surface treated road, and proceed southwesterly 0.95 miles to a triangle intersection, with Wakefield Road to the southeast and Baker Road to the west. Proceed westerly, from a 24" white oak in the center of the triangle, along the center of Baker Road 341 feet to the bound on the left.

Bound is located 11.7 feet southeasterly of the center of Baker Road, and 5 feet northwest of the southeast road wall. It is 60 feet southwest of the entrance to a gravel pit located on the southeasterly side of the road. Scrub woodland rises slightly to the south and east, and drops away to the north and west.

The original bound was a rough, granite monument showing 2.2 feet above the ground. It measured 18" X 3" at the ground, was pointed at the top, and was lettered "RI" on the east face and "C" on the west face. The 1985–1986 Perambulation Survey found the bound broken off 2" above the ground.

The 1997 perambulation survey found that the monument to be tipped approximately 1 foot to the northwest, and that the monument is now beneath a small stone heap.

No bound was established in this area in 1840, and the 1941 commissioners agreed that the monument should not be considered as marking a point on the line established in 1840.

BOUND L - 3,588 feet south  
BOUND M - 5,444 feet north



**EASTERLY VIEW**



**NORTHEASTERLY VIEW**

LINE BOUND M

REGULATION GRANITE MONUMENT

PAVED HIGHWAY

Beginning at the intersection of Connecticut Route 193 and East Thompson Road in the town of Thompson, proceed northeasterly 2.3 miles on East Thompson Road to Quaddick Town Farm Road. Proceed southeasterly 1.2 miles on Quaddick Town Farm Road to Buck Hill Road. Proceed southeasterly 0.4 miles on Buck Hill road to the bound location.

The original bound was a rough granite monument showing 4 feet above the ground. It was located 17 feet northeast of the center of the traveled way. The 1985-1986 perambulation survey determined the bound was missing, and presumed it was removed in connection with highway improvements.

A new bound was set on April 25, 1991, about 25 feet north of the original bound location based on the 1940 coordinates.

The 1997 perambulation survey recovered a regulation granite monument, showing 4.2 feet above the ground, marking the bound. There is a 10' X 14' shed across the highway to the southwest, and further to the southwest are the remains of a shed or barn. There is a 2-story gambrel roof house north of the bound, and a 2-story colonial northwest of the bound. The bound is lettered "CONN" on the west face, "RI" on the east face and "1990" on the north face. There is a 3/4" drill hole, 1 1/2" deep, in the top center.

The 1941 commissioners accepted the original rough, granite monument as correctly marking a point on the line established in 1840.

NAD 27

N = 421,128.20

E = 858,490.84

BOUND M-K 19835.22 feet S 1° - 18' - 40.3" E

BOUND M-N 6854.79 feet N 1° - 29' - 34.2" W

1997





**NORTHEASTERLY VIEW**



**NORTHERLY VIEW**

**LINE BOUND N**

ROUGH GRANITE MONUMENT

WOODS ROAD

Beginning at the intersection of Interstate 395 and Connecticut Route 200 in the town of Thompson, proceed easterly 0.6 miles on Route 200 to its intersection with Route 193. Proceed northeasterly 1.6 miles on Route 193 to East Thompson Road. Proceed northeasterly on East Thompson Road 2.2 miles to Quaddick Town Farm Road. Proceed southeasterly on Quaddick Town Farm Road 0.45 miles to New Road on the left. Proceed on New Road 0.25 miles to the intersection of Starr Road on the right. (See following sketch) Proceed on Starr Road 0.2 miles to the remains of an old farm.

Proceed S 75° E, 68 feet, passing along the southerly side of a chicken house, to where the farm road enters woodland. Continue S 75° E, 330 feet along the farm road, to where the road turns north. Proceed N 55° E, 632 feet to where the road turns northeasterly and becomes overgrown, thence N 80° E, 600 feet to a box culvert. Continue N 80° E, 118 feet to the southerly end of a wall to the north, thence N 80° E, 140 feet to the bound which is 80 feet west of a large box culvert, beyond which the road begins to climb to the northeast.

Bound is located 14 feet north of the center of the woods road in a bull briar tangle. There is a small open area on the north side of the road, just west of the bound which is covered with a low growth of briars, ferns and low brush. Scrub woodland drops away to the northwest. There is a maintained trail on a bearing of N 16° E passing along the Rhode Island face of the bound. Proceeding on this said bearing at a distance of 56 feet from the bound, there is a stream running east to west.

A rough granite monument showing 2.3 feet above the ground marks the bound. It measures 14" X 5", and is lettered "RI" on the east face and "C" on the west face.

The 1941 commissioners accepted the monument as correctly marking a point on the line established in 1840.

BOUND M - 6,854.79 feet south  
BOUND O - 1,438 feet north

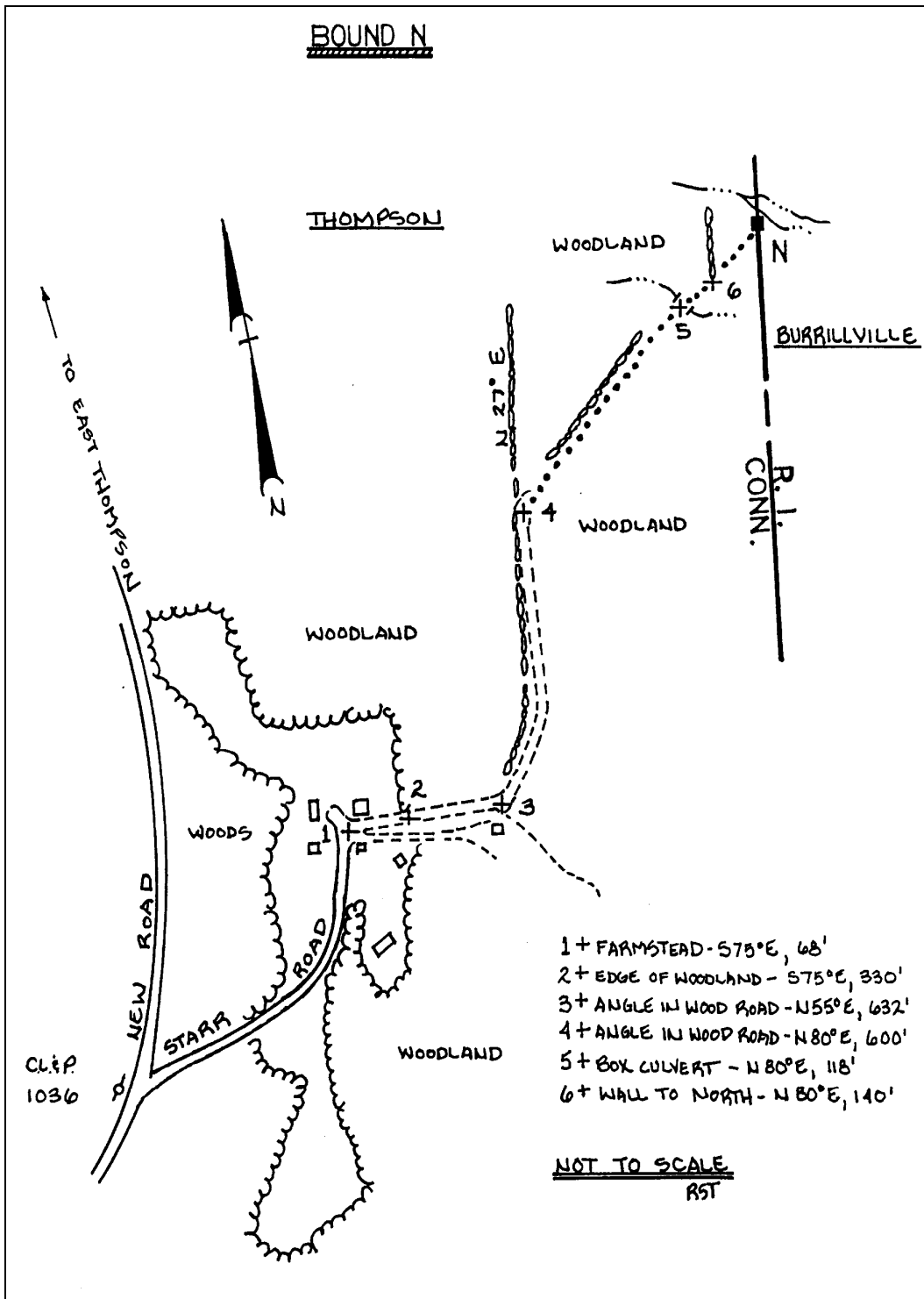



**WESTERLY VIEW**



**SOUTHWESTERLY VIEW**

**ANGLE BOUND 0****TRI-STATE CORNER****GRANITE MONUMENT****INTERIOR ANGLE**

Following sketch, proceed from the Intersection of East Thompson Road, with New Road at the remains of the railroad right-of-way in East Thompson, southeasterly on New Road 0.25 miles, crossing Rocky Brook at 0.2 miles, to a barway on the left. Follow woods road northeasterly from barway 0.4 miles following well marked (Blue Dot) Trail to end of driveable portion of said trail at break in a stone wall. Continue on blue marked trail crossing stone wall and proceeding southerly, southeasterly, and northeasterly up steep slope to summit, and bound.

Bound is located on the southwestern slope of a wooded hill, 45 feet north along the crest from the south end of a sharp break, and about halfway up the steep hillside.

A granite monument, showing 3.9 feet above the ground, marks the bound. It is 14 inches square with a pyramidal top and is lettered "MASS 1883" on the north face, "RI 1883" on the south face and "CONN" on the west face. The lettered sides are dressed. The east side rock is faced. It is 9 feet long to the base from the 6 inch pyramidal top. Monument was set in October, or November, of 1883 by a Massachusetts-Rhode Island commission.

The 1941 commissioners accepted the monument as correctly marking the northerly end of the line established in 1840.

BOUND N - 1,438 feet south



---

1997

CONNECTICUT- RHODE ISLAND STATE BOUNDARY LINE PERAMBULATION  
CONNECTICUT DEPARTMENT OF TRANSPORTATION

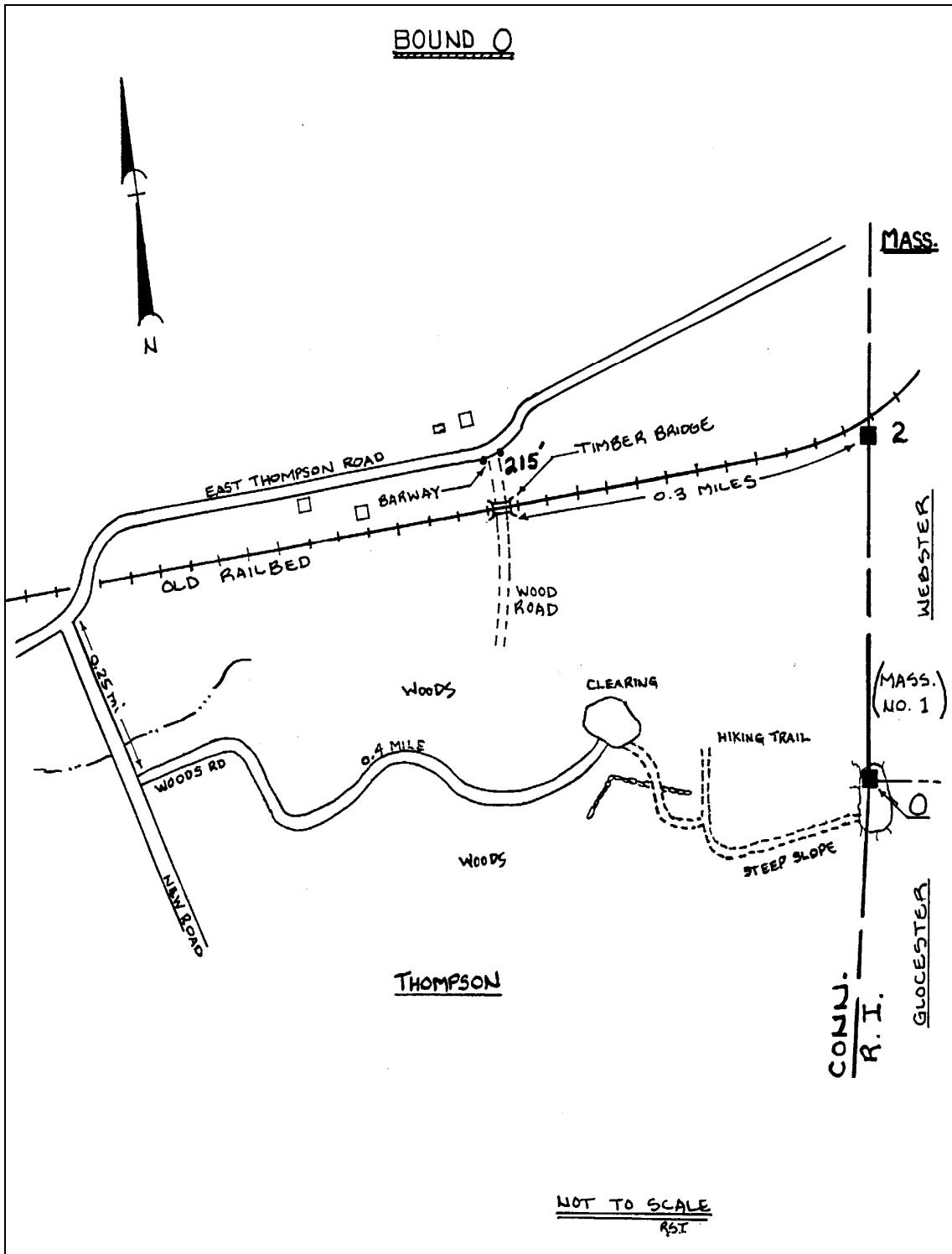

1997

CONNECTICUT- RHODE ISLAND STATE BOUNDARY LINE PERAMBULATION  
CONNECTICUT DEPARTMENT OF TRANSPORTATION



**NORTHERLY VIEW**



**NORTHEASTERLY VIEW**

## *Appendix A*

### *Connecticut General Statutes Section 3-8*

**Sec. 3-8. Restoration and repair of state boundary marks.** The governor shall, in 1975 and decennially thereafter, or whenever any monument or other boundary mark between this state and an adjoining state has become damaged, displaced or destroyed, appoint an agent authorized to act with a duly appointed agent of such adjoining state to examine any or all of such monuments and boundary marks and restore or repair any that are injured or have been removed; and a reasonable portion of the expense thereof, together with the cost of the services of such agent, when approved by the governor, shall be paid from the state treasury. Such agent or his representative may, upon giving reasonable written notice to the owner, enter upon private property for the purpose of surveying, establishing, maintaining or restoring any state boundary mark or monument and shall use care so that no unnecessary damage shall result to such private property, and the state shall pay damages to the owner of any such property, from appropriations made to the department of transportation for any damage or injury such agent or his representative causes such owner by such entry and activity.

## *Appendix B*

### *Designating The Boundary Line Between Connecticut And Rhode Island, As Surveyed And Settled*

**Whereas**, the commissioners appointed by the general assembly of this state, at their session in May, A. D. 1839, to survey and ascertain the boundary line between this state and the state of Rhode Island, in connection with commissioners for that purpose, appointed by said last mentioned state, have made their report in the words and figures following, to wit.

**Whereas**, the general assembly of the state of Connecticut, at their session in May, A. D. 1839, appointed William Dyer of Plainfield, Gurdon Chapman of Norwich, and Jonathan Nichols of Thompson, commissioners, to join with such commissioners as might be appointed by the state of Rhode Island and Providence Plantations, in surveying and ascertaining the boundary line between the two states, and erecting suitable monuments thereon; and the general assembly of the state of Rhode Island and Providence Plantations, at their session in June, A. D. 1839, authorized his honor the acting governor, to appoint commissioners, to join with the commissioners of the state of Connecticut for the purpose aforesaid, and in pursuance of said authority, William Peckham of South Kingston, George D. Cross of Westerly, and Elisha R. Potter of South Kingston, were by his honor Samuel Ward King, appointed commissioners on the part of said state of Rhode Island and Providence Plantations; and the said commissioners have met and exhibited to each other their several commissions, and proceeded to complete the business for which they were appointed:

**Now therefore**, we, the said commissioners, have ascertained, and do by these presents and by virtue of the power given us by the legislatures of our respective states, establish the boundary line between said states, subject however to the final decision and ratification hereof by said legislatures, as follows:

Beginning at a rock near the mouth of Ashawage river, where it empties into Pawcatuck river, and from said rock a straight course northerly to an ancient stone heap at the southeast corner of the town of Voluntown, and from said rock southerly in the same course with the aforesaid line, until it strikes Pawcatuck river; from the southeast corner of Voluntown, a straight line to a stone heap at the southwest corner of West Greenwich; from thence, a straight line to the southwest corner of the ancient town of

*Continued*



*Appendix B*

*Continued*

Warwick, and which is now a corner of the towns of Coventry and West Greenwich; from thence, a straight line to the northwest corner of the town of Coventry; thence a straight line to the northeast corner of the town of Sterling; thence a straight line to the southwest corner of Gloucester; thence a straight line to the southeast corner of Thompson; thence a straight line to the southwest corner of Burrilville, and thence a straight line to a stone heap upon a hill in the present jurisdiction line between the states of Massachusetts and Rhode Island, and at all of said town corners, excepting said Warwick corner, we have erected monuments of stone, marked R. I. & C. And have also placed similar monuments on all the principal roads crossing the line, and at other suitable places, all which will more fully appear by reference to a plat of our survey, of which, duplicate copies have been executed by Jonathan Nichols and Moses B. Lockwood, the surveyors employed by the commissioners; and which plats are hereby made a part of this agreement. And we have caused the ancient monument, which was erected at the Warwick corner in November, 1742, to be re-set and a large heap of stones to be made around it. Said monument is marked with the letter C on one side and on the other RHODE ISLAND; and the traces of other letters or figures.

And it is further agreed by said commissioners, that this present survey and agreement shall not alter or in any wise affect the right or title of any person or persons to any lands, tenements or hereditaments, but the same shall remain as if this agreement had never been made. And it is further agreed that as soon as this agreement shall have been ratified and confirmed by the legislatures of our respective states, copies of the acts of ratification, duly authenticated, shall be forwarded by the secretary of each state to the chief executive magistrate of the other state, to be deposited among the records thereof, in perpetual testimony of said ratification.

Witness our hands and seals hereto affixed at Providence, this twenty-seventh day of April, in the year of our Lord one thousand eight hundred and forty.

WM. PECKHAM	(seal.)
GEORGE D. CROSS	(seal.)
ELISHA R. POTTER	(seal.)
WILLIAM DYER	(seal.)
GURDON CHAPMAN	(seal.)
JONATHAN NICHOLS	(seal.)

**Resolved by this Assembly,** That said report be accepted, and that the boundary line therein designated, be confirmed and established as the boundary line between said states.

# **ACKNOWLEDGEMENTS**

## **DEPARTMENT OF TRANSPORTATION DISTRICT II SURVEYS**

*CHARLES PANTELEAKOS, P.E.*  
DISTRICT ENGINEER

*WILLIAM S. GIRARD*  
PRINCIPAL ENGINEER (SURVEYS)

## **RIGHT OF WAY SECTION**

*JOSEPH C. CASAVECCHIA, L.S.*  
SUPERVISOR

*DAVID R. GOSSELIN, L.S.I.T.*  
*ROBIN S. THOMPSON*  
REPORT PREPARATION, GRAPHICS & FIELD WORK

*CHRISTINE E. AUBREY, L.S.*  
GRAPHICS, RESEARCH & FIELD WORK

*THOMAS BENOIT*  
*JOEL DILLIS*  
FIELD WORK

***1997***  
***CONNECTICUT - RHODE ISLAND***  
***STATE BOUNDARY LINE PERAMBULATION***  
***CONNECTICUT DEPARTMENT OF TRANSPORTATION***