

1997
CONNECTICUT - MASSACHUSETTS
BOUNDARY LINE PERAMBULATION
BOUNDS 100 - 199



Prepared by
CONNECTICUT DEPARTMENT OF TRANSPORTATION
SURVEY OPERATIONS
(DISTRICT IV)

STATE LINE PERAMBULATION

1997

**PHOTOGRAPHS, MAPS AND
DESCRIPTIONS OF BOUNDS**

PREPARED BY

**THE CONNECTICUT DEPARTMENT OF
TRANSPORTATION**

1997

CONNECTICUT-MASSACHUSETTS STATE BOUNDARY LINE PERAMBULATION
CONNECTICUT DEPARTMENT OF TRANSPORTATION

NOTES ON DESCRIPTIONS

DESCRIPTIONS HAVE BEEN PREPARED ON THE BASIS OF APPROACHING EACH BOUND AS CLOSELY AS POSSIBLE BY VEHICLE. ALL MILEAGES HAVE BEEN CHECKED IN THE FIELD BUT ARE APPROXIMATE.

ALL DIMENSIONS IN THE DESCRIPTION, USED TO APPROACH OR FIND THE MONUMENTS, ARE "OVER THE GROUND" DISTANCES.

ALL GEOGRAPHIC POSITIONS ARE REFERRED TO THE 1927 NORTH AMERICAN DATUM, AS COMPUTED BY THE U.S. C. & G.S.

ALL COORDINATES SHOWN IN THESE DESCRIPTIONS ARE BASED ON THE CONNECTICUT COORDINATE SYSTEM.

ALL INFORMATION ON BOUNDS OBTAINED FROM 1907 DESCRIPTIONS WITH MODIFICATIONS NOTED IN REVISIONS MADE ON SUBSEQUENT PERAMBULATIONS.

IN REFERRING TO HIGHWAY ROUTE NUMBERS IN THE DESCRIPTIONS, THE ROUTE NUMBERS SHOWN ON THE TOWN ROAD MAPS ACCOMPANYING THE DESCRIPTIONS HAVE BEEN USED.

ELEVATIONS OF THE ROAD INTERSECTIONS SHOWN ON THE ACCOMPANYING U.S.G.S. MAPS WERE USED IN THE DESCRIPTIONS AS INTERSECTION NUMBERS FOR IDENTIFICATION PURPOSES.

SPECIAL LAWS OF CONNECTICUT 1911,1913
VOLUME 16 PAGES 1003-1005

SENATE BILL #310 & 330

AN ACT ESTABLISHING THE BOUNDARY LINE BETWEEN
CONNECTICUT AND MASSACHUSETTS

Be it enacted by the Senate and House of Representatives in General Assembly convened:

SECTION 1. The boundary line between the state of Connecticut and the commonwealth of Massachusetts, from the northwest corner of Rhode Island to the northwest corner of Connecticut, is as follows: Beginning at a granite monument at the northwest corner of the state of Rhode Island and marking the corner of Massachusetts, Rhode Island, and Connecticut, in latitude $42^{\circ} 00' 29.150''$ and longitude $71^{\circ} 47' 58.778''$; thence north $2^{\circ} 56' 41''$ west, 2,795 feet to a granite monument on the northerly side of the old turnpike from Hartford to Boston through Thompson and Douglas, in latitude $42^{\circ} 00' 56.728''$ and longitude $71^{\circ} 48' 00.680''$; thence north $5^{\circ} 13' 32''$ west, 2,854 feet to a granite monument at the northeast corner of the state of Connecticut, in latitude $42^{\circ} 01' 24.807''$ and longitude $71^{\circ} 48' 04.123''$; thence north $89^{\circ} 09' 56''$ west, 27,908 feet to a granite monument on the westerly side of Webster road, opposite the "Line Hotel" in latitude $42^{\circ} 01' 28.656''$ and longitude $71^{\circ} 54' 13.830''$; thence north $87^{\circ} 52' 26''$ west, 22,881 feet to a granite monument on the easterly side of the road from East Woodstock to Southbridge in latitude $42^{\circ} 01' 36.931''$ and longitude $71^{\circ} 59' 16.780''$; thence north $89^{\circ} 17' 16''$ west 22,890 feet to a granite monument on the easterly side of Forge road from Woodstock Valley to Southbridge, in latitude $42^{\circ} 01' 39.631''$ and longitude $72^{\circ} 04' 20.037''$; thence north $86^{\circ} 52' 14''$ west, 19,423 feet to a granite monument on the easterly side of the main road from Mashapaug, to Holland, in latitude $42^{\circ} 01' 50.026''$ and longitude $72^{\circ} 08' 37.006''$; thence north $89^{\circ} 17' 26''$ west, 53,162 feet to a granite monument on the easterly side of the road from Stafford to Monson by the east base of Peaked Mountain, in latitude $42^{\circ} 01' 55.929''$ and longitude $72^{\circ} 20' 21.364''$; thence north $87^{\circ} 56' 26''$ west, 4,029 feet to a granite monument on the easterly side of the road from Stafford to Hampden, in latitude $42^{\circ} 01' 57.356''$ and longitude $72^{\circ} 21' 14.722''$; thence north $89^{\circ} 11' 36''$ west, 10,377 feet to a granite monument on the easterly side of the road from Stafford to Hampden by the east base of Rattlesnake Mountain, in latitude $42^{\circ} 01' 58.779''$ and longitude $72^{\circ} 23' 32.206''$; thence north $88^{\circ} 23' 38''$ west, 18,542 feet to a granite monument on the easterly side of the road from North Somers to East Longmeadow, in latitude $42^{\circ} 02' 03.840''$ and longitude $72^{\circ} 27' 37.808''$; thence south $89^{\circ} 39' 56''$ west, 8,747 feet to a granite monument on the easterly side of the Hall Hill road from Somers to East Longmeadow, in latitude $42^{\circ} 02' 03.319''$ and longitude $72^{\circ} 29' 33.716''$; thence north $89^{\circ} 16' 52''$ west, 10,684 feet to a granite monument at the corner of the towns of East Longmeadow and Longmeadow in Massachusetts and Enfield in Connecticut, in latitude $42^{\circ} 02' 04.619''$ and longitude $72^{\circ} 31' 55.276''$ thence south $81^{\circ} 56' 34''$ west, 11,309 feet to a granite monument about 620 feet south of Allen Street in Longmeadow in latitude $42^{\circ} 01' 48.933''$ and longitude $72^{\circ} 34' 23.644''$; thence south $51^{\circ} 56' 28''$ west, 3,238 feet to a granite monument 450 feet east of the main road from Thompsonville to Springfield in latitude $42^{\circ} 01' 29.212''$ and longitude $72^{\circ} 34' 57.422''$; thence north $88^{\circ} 35' 49''$ west, 5,834 feet to a granite monument on the top of the

bank, about 175 feet east of the easterly shore of the Connecticut River, in latitude 42° 01' 30.616" and longitude 72° 36' 14.696"; thence in the same direction, 950 feet to the middle of said river; thence northerly along a line midway between the banks thereof, about 2,075 feet; thence north 87° 18' 55" west, 1,260 feet to a granite monument standing on the bank about 225 feet west of the westerly shore of the river, in latitude 42° 01' 51.983" and longitude 72° 36' 44.913"; thence in the same direction, 7,661 feet to a granite monument about 875 feet west of North Street or Suffield Street, the middle road from Suffield to Springfield, in latitude 42° 01' 55.516" and longitude 72° 38' 26.318"; thence north 82° 39' 40" west, 8,966 feet to a granite monument on the easterly side of Halliday Avenue or Front Street, the road from Suffield to Feeding Hills, in latitude 42° 02' 06.813" and longitude 72° 40' 24.149"; thence north 84° 51' 12" west, 7,202 feet to a granite monument on the easterly side of West Street, the road from West Suffield to Westfield, in latitude 42° 02' 13.185" and longitude 72° 41' 59.207"; thence south 89° 46' 25" west, 4,137 feet to a granite monument at the corner of Agawam and Southwick in Massachusetts and Suffield in Connecticut, in latitude 42° 02' 13.019" and longitude 72° 42' 54.032"; thence south 0° 48' 01" east, 132 feet to a granite monument, in latitude 42° 02' 11.716" and longitude 72° 42' 54.008"; thence south 89° 38' 09" west, 11,231 feet to a granite monument on the easterly shore of Congamond Lake, in latitude 42° 02' 10.984" and longitude 72° 45' 22.830"; thence in the same direction, 14.5 feet to the shore of the lake as it would be with the surface of the water at the elevation it was in 1803; thence southerly, by the easterly shore of the lake as it would be with the surface of the water at the aforesaid elevation to a point opposite a granite monument near the shore at the southerly end of the lake (the elevation of the water surface of the lake in 1803 has been determined to be one foot below the top surface of the southwest corner of the brownstone foundation, or footing of the north abutment of the arched culvert carrying the tracks of the New York, New Haven and Hartford Railroad Company over the outlet of the lake about 900 feet north of Congamond Lake railroad station); thence south 4° 26' 29" west, about 25 feet to said monument, in latitude 42° 00' 27.957" and longitude 72° 46' 00.167"; thence in the same direction, 1,632 feet to a granite monument at the southeasterly corner of the "Southwick jog", in latitude 42° 00' 11.881" and longitude 72° 46' 01.841"; thence south 81° 33' 28" west, 13,827 feet to a granite monument at the southwesterly corner of the "Southwick jog", in latitude 41° 59' 51.787" and longitude 72° 49' 02.976"; thence north 3° 33' 56" east, 14,261 feet to a granite monument known as the "Crank monument", in latitude 42° 02' 12.399" and longitude 72° 48' 51.223"; thence north 88° 46' 28" west, 16,177 feet to a granite monument about 325 feet east of the west road from Granby to Granville, in latitude 42° 02' 15.762" and longitude 72° 52' 25.548"; thence south 89° 48' 02" west, 17,833 feet to a granite monument on the easterly side of the road near the east bank of Hubbard Brook, in latitude 42° 02' 15.081" and longitude 72° 56' 21.859"; thence north 88° 32' 56" west, 26,579 feet to a granite monument on the easterly side of the road near the west bank of Slocum Brook, in latitude 42° 02' 21.580" and longitude 73° 02' 13.967"; thence north 87° 33' 48" west, 26,817 feet to a granite monument on the westerly side of the road near the westerly bank of Sandis Brook, in latitude 42° 02' 32.691" and longitude 73° 08' 09.034"; thence north 87° 52' 12" west, 26,698 feet to a granite monument on a large rock near the westerly bank of a brook about 300 feet south of its mouth at Whiting River near Campbell Falls, in latitude 42° 02' 42.342" and longitude 73° 14' 02.615"; thence north 87° 35' 41" west, 28,917 feet to a granite monument near the easterly bank of the Housatonic River, in latitude 42° 02' 54.154" and longitude 73° 20' 25.540"; thence north 88° 07' 02" west, 25,250 feet to a granite monument on a large rock

marked 1803 on its southerly side, in Sage's ravine, in latitude $42^{\circ} 03' 02.214''$ and longitude $73^{\circ} 26' 00.030''$; thence south $88^{\circ} 31' 58''$ west 14,787 feet to a granite monument at the northwesterly corner of the state of Connecticut and marking the corner of Massachusetts, New York and Connecticut, in latitude $42^{\circ} 02' 58.427''$ and longitude $73^{\circ} 29' 15.959''$.

SECTION 2. The geodetic positions given in this description are based on Clark's spheroid and the astronomical data adopted by the United States coast and geodetic survey in 1880.

SECTION 3. The above-described boundary line is shown on plans dated December 26, 1906, deposited with the librarian of the state of Connecticut and with the secretary of the state of Massachusetts, with additional copies filed with the secretary of the state of Connecticut and the harbor and land commissioners of the state of Massachusetts.

SECTION 4. The governor is authorized and requested to transmit a copy of this act to the governor of the state of Massachusetts, and upon receiving acknowledgment of its receipt by the State of Massachusetts the governor shall cause such acknowledgement to be filed in the office of the secretary.

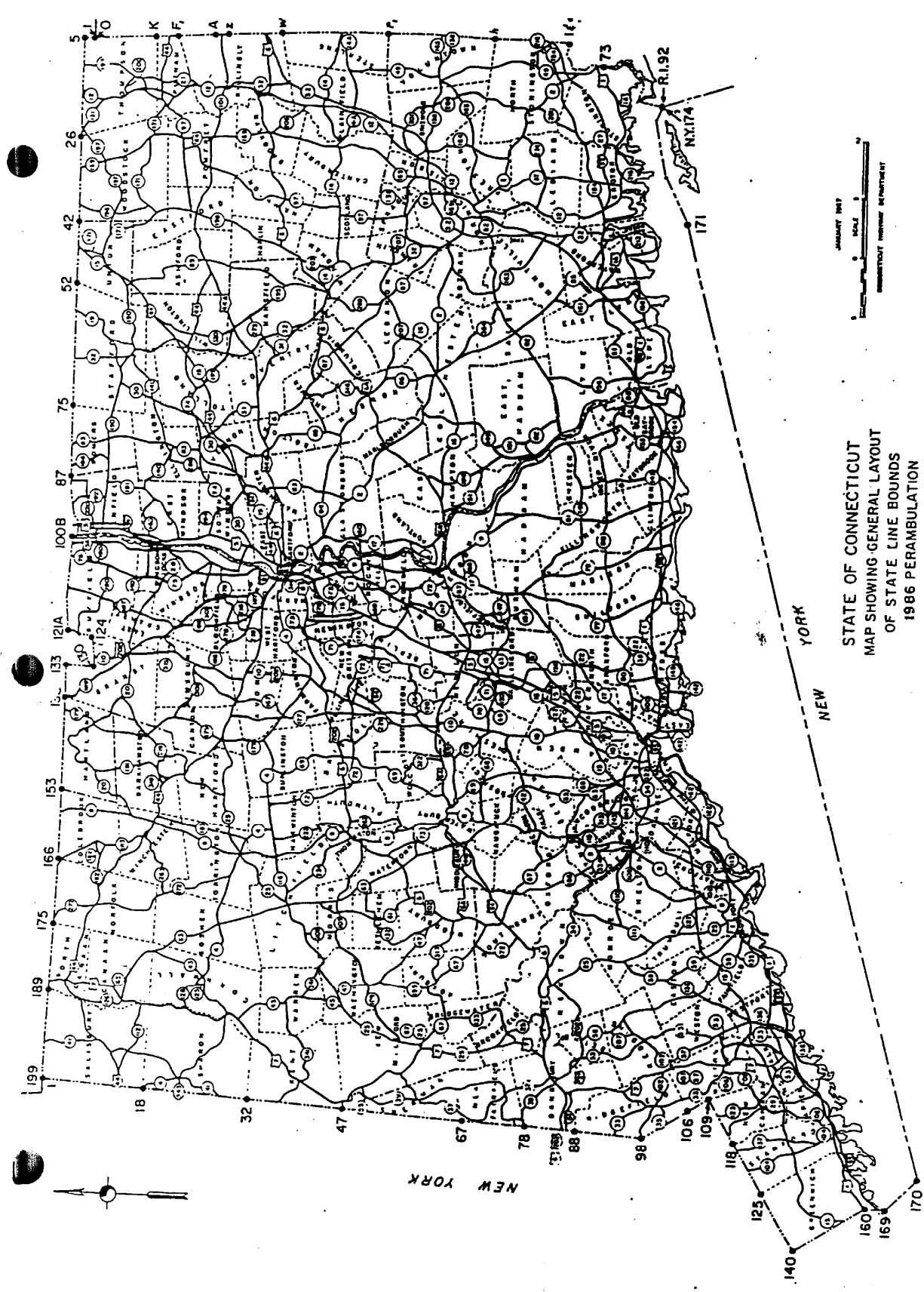

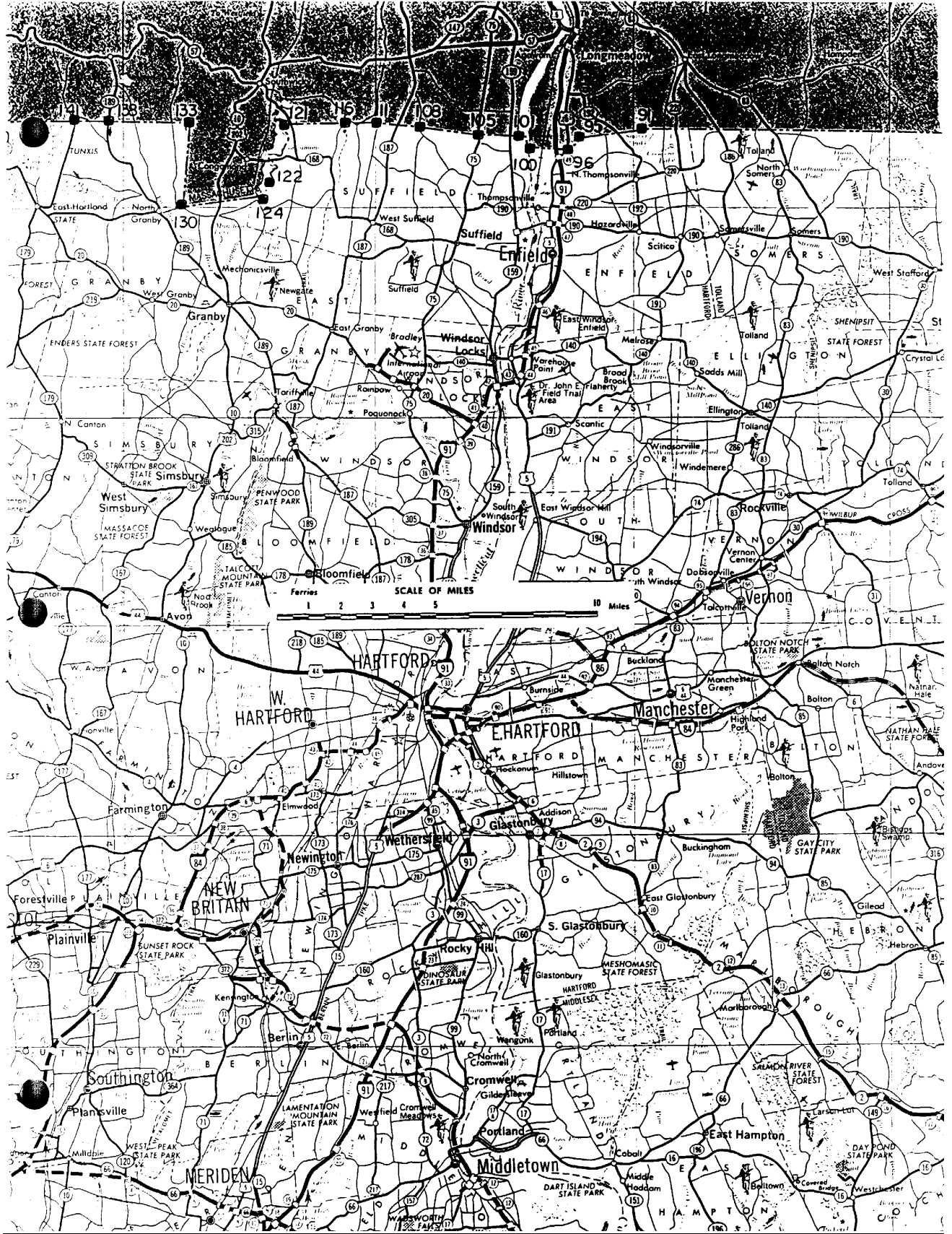

1997

CONNECTICUT-MASSACHUSETTS STATE BOUNDARY LINE PERAMBULATION
 CONNECTICUT DEPARTMENT OF TRANSPORTATION

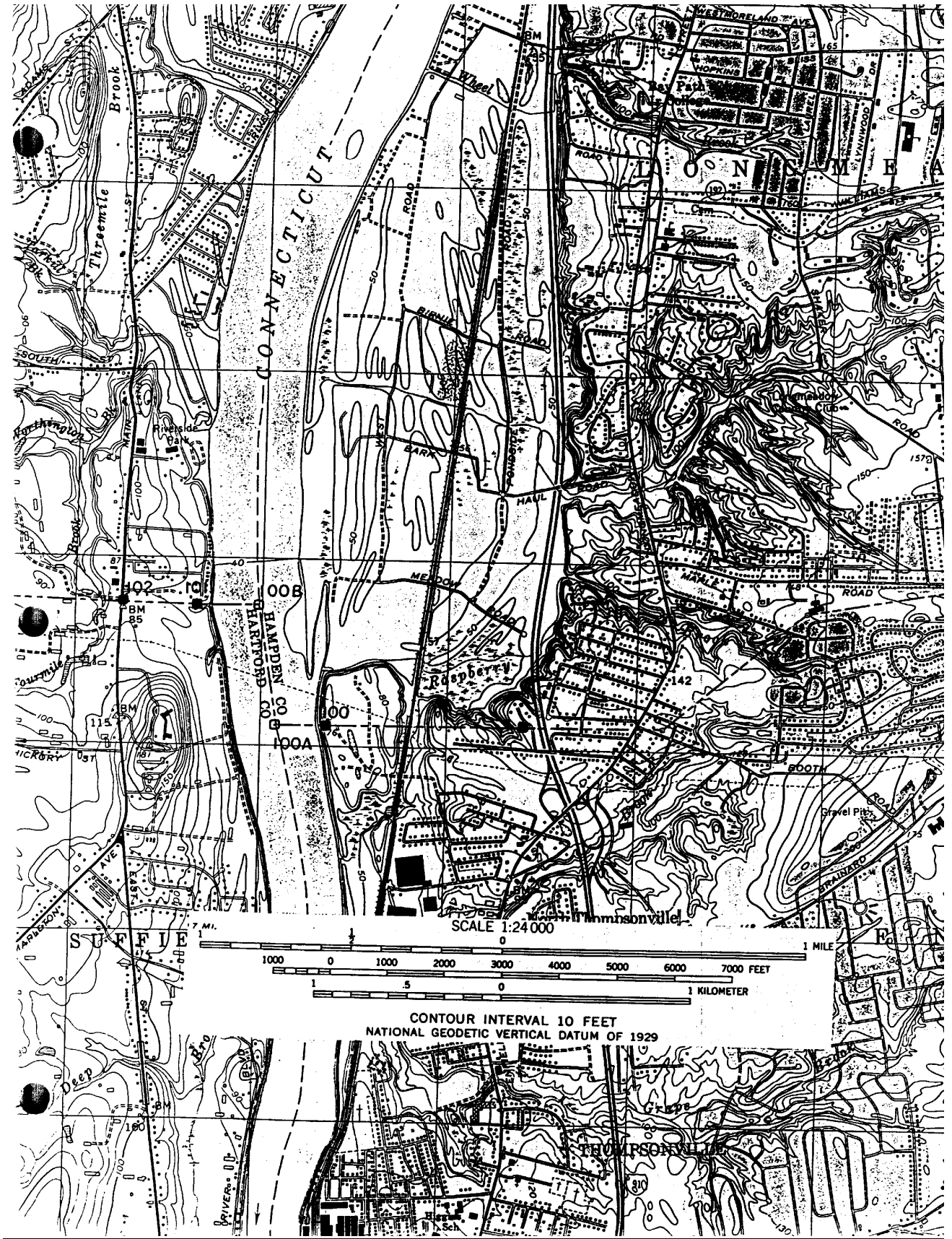

ANGLE BOUND #100-A

ENFIELD-SUFFIELD TOWN CORNER

Bound is an unmarked point in the Connecticut River at the Enfield-Suffield town corner and an angle in the State Line.

1906 Station 225624

Bound #100 - 950 feet east

Bound #100-B - 2075 feet north

ANGLE BOUND #100-B

LONGMEADOW-AGAWAM TOWN CORNER

Bound is an unmarked point in the Connecticut River at the Longmeadow-Agawam town corner and an angle in the State Line.

1906 Station 227699

Bound #100-A - 2075 feet south

Bound #101 - 1260 feet west

BOUND 100



PHOTOGRAPHED NORTHWESTERLY



PHOTOGRAPHED NORTHWESTERLY

LINE BOUND #100

ENFIELD-SUFFIELD TOWN CORNER - WITNESS MARK

REGULATION GRANITE MONUMENT

FARM ROAD

From the State Line, on Route U.S. 5, at Bound #97, proceed southerly on Route U.S. 5 to Bernadino Avenue, at 0.45 mile.

Following sketch proceed westerly and northerly on farm roads. At fork, just east of remains of a boat yard, turn north to the remains of the Wilmes homestead.

Bound is located 42 feet south of the southeast corner of the foundation of the remains of the Wilmes homestead on range of its east face. It is 30 feet east of the river bank and 175 feet east of the east shore of the Connecticut River. Homestead clearing is surrounded by woodland.

Bound is a witness mark for the angle and town corner at Bound #100-A in the center of the river.

Bound is marked by a regulation granite monument showing 3.9 feet above ground. It is lettered "1906" on the east, "L Mass." on the north and "E Conn." on the south face. It is 9.4 feet long, set in excavation made in sand, its bottom resting on rock. Monument was set June 15, 1907, in the exact location of the old 1826 sandstone monument.

1906 Station 224674
Bound #99 - 1440 feet east
Bound #100-A - 950 feet west



PHOTOGRAPHED SOUTHWESTERLY



PHOTOGRAPHED SOUTHWESTERLY

LINE BOUND #101

LONGMEADOW-AGAWAM TOWN CORNER - WITNESS MARK

REGULATION GRANITE MONUMENT

INTERIOR TOWN CORNER

From the State Line on Route 159, at Bound #102, proceed northerly on Route 159, 150 feet to Kanawha Avenue. Proceed easterly on Kanawha Avenue 0.25 mile.

Bound is located about 75 feet south of a one-story ranch house, #104 (Raymond P. Geddis), on the south side of Kanawha Avenue. Kanawha Avenue turns 90 degrees north just past house #104. Bound is 230 feet west of the west shoreline of the Connecticut River. All top corners of Bound are chipped, with a large chip on the southwest corner. Bound is tipped slightly to the northeast.

Bound is a witness mark for the angle and town corner at Bound #100-B in the center of the river.

Bound is marked by a regulation granite monument showing 3.7 feet above ground level. It is lettered "1906" on the west, "A Mass." on the north, and "S Conn." On the south face. It is 9.5 feet long, set in excavation made in loam and sandy clay. Bound was set June 17, 1907.

1906 Station 228959
Bound #100-B - 1260 feet east
Bound #102 - 1290 feet west



PHOTOGRAPHED SOUTHERLY



PHOTOGRAPHED SOUTHERLY

LINE BOUND #102

REGULATION GRANITE MONUMENT

PAVED HIGHWAY

From the intersection of Mapleton Avenue and Route 159, proceed northerly on Route 159 to Bound at 0.8 mile. Road is descending gradually, northerly, and levels off about 300 feet north of the Bound.

Bound is located 37 feet east of the center of the traveled way. It is 3.5 feet west of the east highway fence and opposite its intersection with a line fence running east. Bound is 3 feet north of a 36-inch maple. Level cultivated fields lie southeast of the Bound with "Drewnowski Swimming Pool Company" to the northeast and a farmstead on the west side of the highway directly opposite the Bound.

Bound was marked by a regulation granite monument showing 3.9 feet above ground. It was lettered "1906" on the west, "A Mass." on the north and "S Conn." on the south face. It was 9.5 feet long, set in excavation made in reddish sand. Monument was set June 17, 1907.

In October 1979, Bound was reported broken off. It was found that the monument was broken off at an angle 11 inches below the ground level measured at the center of the monument.

The repair was accomplished on November 9, 1979 by drilling four holes 3 inches deep and inserting ½ inch steel deformed bars 12 inches long. Concrete was then poured into a form 14 inches square and 12 inches deep to a level one inch above the existing ground.

A bronze disk with the words "State Line Bound Mass/Conn 102" was inserted in the center of the concrete. A drill hole was placed in the center of the disk.

1906 Station 230249
Bound #101 - 1290 feet east
Bound #103 - 5293 feet west



1997
 CONNECTICUT-MASSACHUSETTS STATE BOUNDARY LINE PERAMBULATION
 CONNECTICUT DEPARTMENT OF TRANSPORTATION



PHOTOGRAPHED NORTHEASTERLY



PHOTOGRAPHED EASTERLY

LINE BOUND #103

SMALL SANDSTONE MONUMENT

INTERIOR LINE SUMMIT

From the State Line on North Street (Route 75) at Bound #104, proceed easterly on line uphill, between cultivated fields 177 feet to Bound at summit.

Bound is located at the absolute summit of a low hill lying immediately east of, and parallel to, North Street, in an ivy and sumac covered property line between cultivated fields. It is 32 feet west of a 30-inch hickory tree. Bound is 51 feet south of the face of a wood frame house, #1685, and is 9.2 feet west of an intersection of chain link fences. Bound is 2 feet west of a 9-inch square sandstone monument which leans east at an angle of 45 degrees, which marks a property line. There are traces of a wire fence evident along property line.

Bound is marked by a sandstone monument showing 0.9 feet above ground. It is 9 inches by 12 inches in section with a $\frac{3}{4}$ inch drill hole one inch deep in top and is lettered "M State Line" on the north and "C State Line 1803" on the south face. Drill hole has been filled (with lead) and prick punched by an unknown party. Bound is 5.0 feet long, set in excavation made in reddish sand. Monument was set June 18, 1907.

1906 Station 235542
Bound #102 - 5293 feet east
Bound #104 - 177 feet west

BOUND 104



PHOTOGRAPHED SOUTHEASTERLY



PHOTOGRAPHED NORTHEASTERLY

LINE BOUND #104

REGULATION GRANITE MONUMENT

PAVED HIGHWAY

From the intersection of North Street (Route 75) and Hickory Street, north of Suffield, proceed northerly on North Street to Bound at 0.3 mile. Road descends gradually, northerly, with open woodland dropping away on the west and rising northerly to a residence with scrub brush on the east, to a high point east of the Bound.

Bound is located 26 feet east of the center of the traveled way in sloping cut bank. It is 2.39 feet west of the center of a granite monument, tipped westerly, marking a Suffield highway bound, and 3 feet east of a triangular project marker shown on photograph. Brush land rises to the east of the Bound and open woodland descends gradually west of the highway. A residence, #1685 lies 100 feet \pm to the northeast of Bound.

Bound is marked by a regulation granite monument showing 3.0 feet above ground. It is lettered "1906" on the west, "A Mass." on the north and "S Conn." on the south face. It is 9.5 feet long set in excavation made in reddish sand and gravel. Monument was set June 18, 1907.

1906 Station 235719

Bound #103 - 177 feet east

Bound #105 - 901 feet west

BOUND 105



PHOTOGRAPHED NORTHEASTERLY



PHOTOGRAPHED NORTHEASTERLY

ANGLE BOUND#105

REGULATION GRANITE MONUMENT

INTERIOR ANGLE

From the State Line on North Street (Route 75) at Bound #104, proceed westerly on line across cultivated land and marsh swale, 901 feet to Bound.

Bound is located on a low bluff west of a brook and is 22.4 feet southwest of a 15 inch oak which is an angle point in a wire fence at the southeast corner of a golf course (Crestview Country Club, Agawam, Mass.). The Bound is surrounded by second growth woodland with undulating cultivated fields and open pastures beyond the second growth woodland.

Bound is marked by a regulation granite monument showing 3.9 feet above ground. It is lettered "1906" on the east, "A Mass." on the north and "S Conn." on the south face. Bound is tipped slightly to the north with a small chip in the southeast top corner and a chip in the northwest corner 2.3 feet below the top. Bound is 10.0 feet long, set in excavation made in loam and clay. Monument was set June 18, 1907.

1906 Station 236620
Bound #104 - 901 feet east
Bound #106A-3090.7 feet west

BOUND 106A



PHOTOGRAPHED NORTHWESTERLY



PHOTOGRAPHED NORTHWESTERLY

LINE BOUND #106 A

REGULATION GRANITE MONUMENT

INTERIOR LINE SUMMIT

Line Bound 106 A is a Regulation Granite Monument, which was set on September 26, 1990.

It replaces Line Bound 106 which was a dressed sandstone monument 9 inches by 12 inches in section, with a 5/8-inch drill hole 1 inch deep in depression in top and lettered "M" State Line 1803" on the north and "C State Line" on the south face. It was 5.2 feet long, set in an excavation made in clay. Bound was set on June 19, 1907. Due to the original sandstone bounds numerous disturbances by farm equipment, it was replaced by Regulation Granite Bound 106 A. The top 2 feet of the original bound was donated to the Suffield Historical Society. Please refer to the 1985 – 1986 Perambulation Report for further historic details regarding the demise of the original sandstone monument.

Regulation Granite Bound 106 A is set in a wooded area 347 feet westerly of the former sandstone bound 106 location to avoid future disturbance. Regulation Granite Bound 106 A is marked as follows: The north face is lettered MASS, the south face is lettered CONN, and the west face is numbered 1990. There is a chip in the northwest corner of the replaced regulation monument. It is 12 inches x 12 inches with a 5/8 inch drill hole 1 inch deep in the top. It is marked on the north face by the letters "MASS" and on the south face by letters "CONN" and on the west face by numbers "1990". The Bound is 9 feet long and protrudes 4 feet above the surface of the ground.

From the State Line on North Street (Route 75) at Bound #104, proceed northerly to Shoemaker Lane at 0.8 mile. Proceed westerly on Shoemaker Lane to golf course road (Crestview Country Club) at 1.5 miles. Proceed south on road to clubhouse and service road at 2.0 miles. After obtaining permission from the golf course superintendent, following sketch, proceed southerly on service road passing a maintenance garage and golf course on both sides, to an intersection of service roads at 2.2 miles. Proceed westerly 335 feet passing a pond and crossing a wire fence to Bound.

1990 Station 239711

Bound #105 – 3090.7 feet east

Bound #107 – 5760.9 feet west

1906 Station 239364

Bound #105 - 2743.7 feet east

Bound #107 - 6107.3 feet west

BOUND 106A

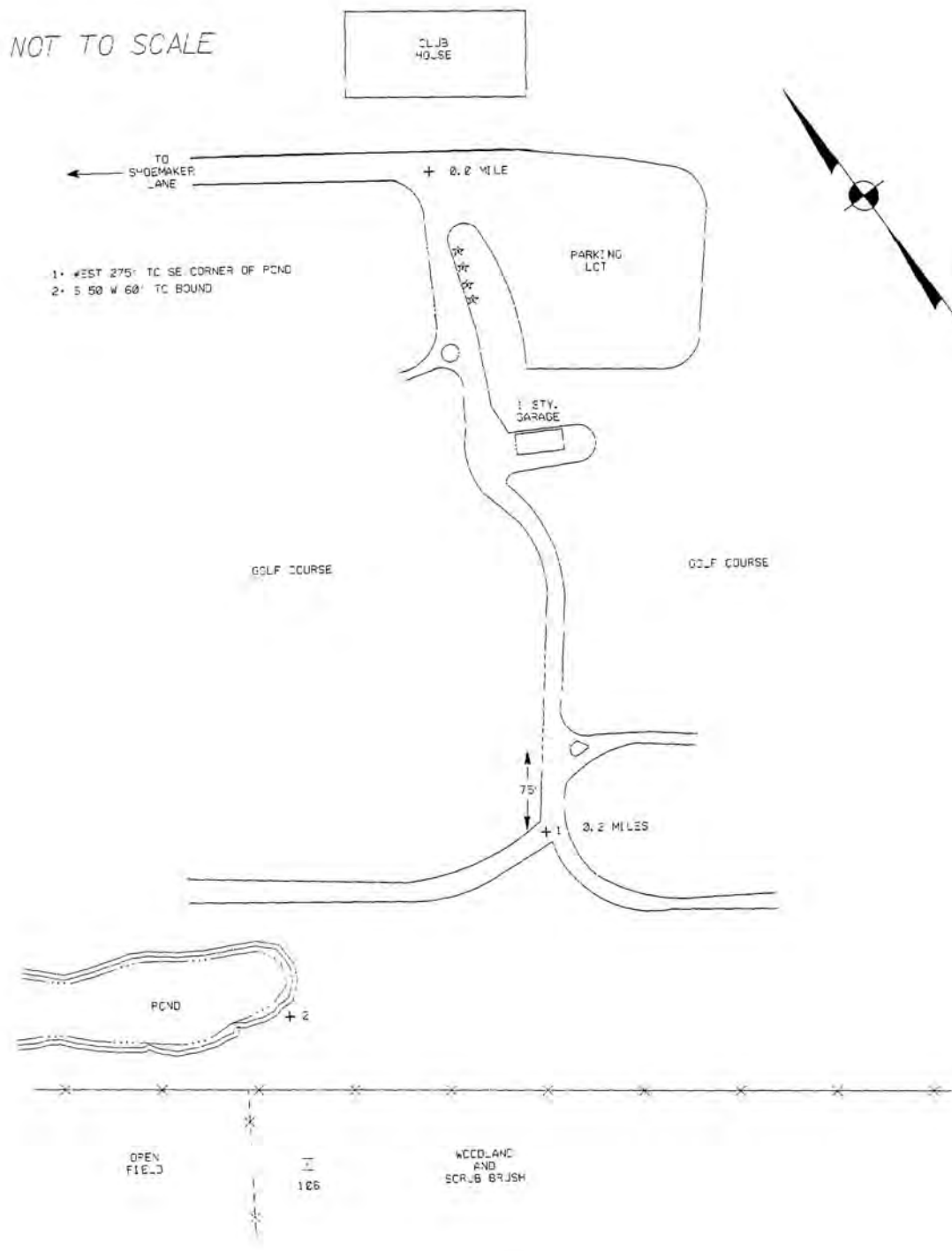



PHOTOGRAPHED NORTHEASTERLY



PHOTOGRAPHED SOUTHEASTERLY

LINE BOUND #107

SMALL SAND STONE MONUMENT

INTERIOR LINE SUMMIT

From the State Line on South Westfield Street or Halladay Avenue, at Bound #108, proceed easterly on line across lawn ascending easterly to Bound, 114 feet east of Bound #108.

Bound is located at the line summit at the westerly brow of the southerly slope of a knoll. There is lawn to the north and a 1 ½ -story Cape Cod dwelling about 30 feet south of the Bound, and level land to the east, sloping away to the south and west and rising to the north.

Bound is marked by a dressed sandstone monument 8 inches by 12 inches in section, with ½-inch drill hole 1 ½ inches deep in the top, showing 1.7 feet above ground. It is lettered "Mass. State Line 1803" on the north and "C State Line" on the south face. It is 5.2 feet long, set in excavation made in red gravel. It was set June 18, 1907.

In April, 1987, the Bound was found to be tipped to the south and loose, possibly broken off below grade. Bound is weathered and has numerous chips.

On September 11, 1990, Bound was replumbed and a concrete collar formed around the broken area. The top of the concrete collar is 3 inches above the ground.

1906 Station 245472
Bound #106A-5760.9 feet east
Bound #108 – 114 feet west



PHOTOGRAPHED SOUTHEASTERLY



PHOTOGRAPHED SOUTHEASTERLY

ANGLE BOUND #108

REGULATION GRANITE MONUMENT

PAVED HIGHWAY

From the intersection of Route 187 and Barry Street, proceed easterly to intersection with South Westfield Street at Bound at 0.7 mile. Highway after crossing brook rises gradually, easterly, to the intersection.

Bound is located 32 feet east of the center of the traveled way of South Westfield Street, also known as Halladay Avenue, opposite the southerly gutter of Barry Street. Residential land rises east of the Bound and descends west of the highway. There is a residence about 200 feet northeast of the Bound. There is a 1 ½ story cape cod dwelling 100± feet southeast of Bound, and a 2 story colonial dwelling on the west side of Halladay Avenue, 100± feet southwest of Bound. CL&P Pole #17999 is 19.5 feet south of Bound.

Bound is marked by a regulation granite monument showing 4.2 feet above ground. It is lettered "1906" on the west, "A Mass." on the north and "S Conn." on the south face. It is 9.8 feet long, set in excavation made in loam and 3.8 feet in hardpan. It was set June 18, 1907, in the exact location of the old 1803 granite monument.

1906 Station 245586
Bound #107 - 114 feet east
Bound #109 - 3279 feet west



PHOTOGRAPHED NORTHWESTERLY



PHOTOGRAPHED NORTHWESTERLY

LINE BOUND #109

REGULATION GRANITE MONUMENT

ABANDONED RAILROAD

From the State Line on Route 187, at Bound #110, proceed easterly on line between newly constructed church to the north and a residence to the south, to the top of railroad cut. Continue to the bottom of cut and Bound at 275 feet east of Bound #110.

Bound is located 25 feet west of the center of the abandoned C.N.E.R.R. right of way in a cut about 850 feet south of the Barry Street bridge and about 450 feet north of a brook crossing the right of way. Level light woods are east and west of the cut. A new house now lies 100± feet southwest of the monument.

Bound is marked by a regulation granite monument showing 3.6 feet above ground. It is lettered "1906" on the west, "A Mass." on the north and "S Conn." on the south face. It is 9.8 feet long, set in excavation made in sand. Monument was set June 22, 1907.

In April 1987, Bound was recovered in good condition and tipped slightly to the east.

1906 Station 248865
Bound #108 - 3279 feet east
Bound #110 - 275 feet west

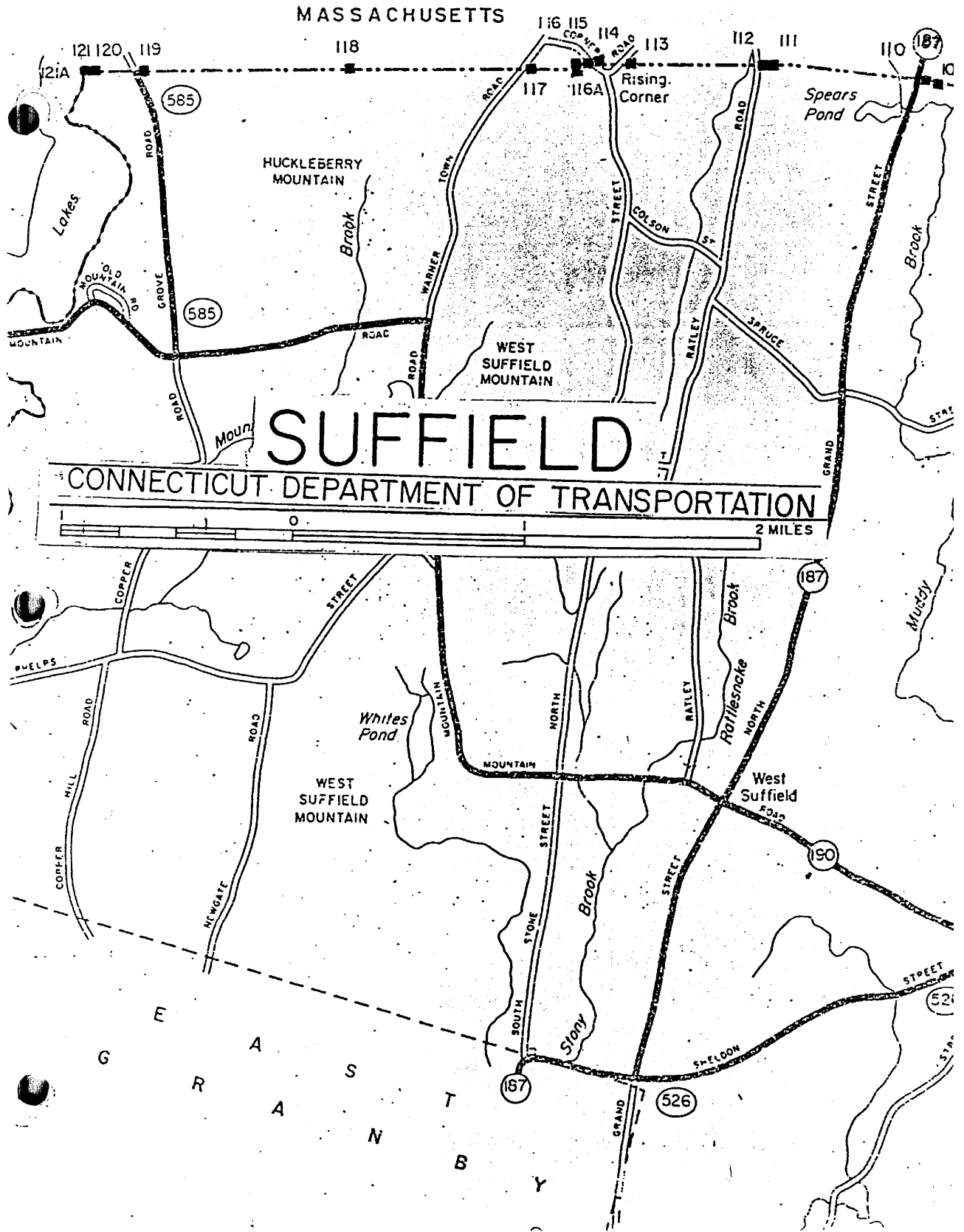

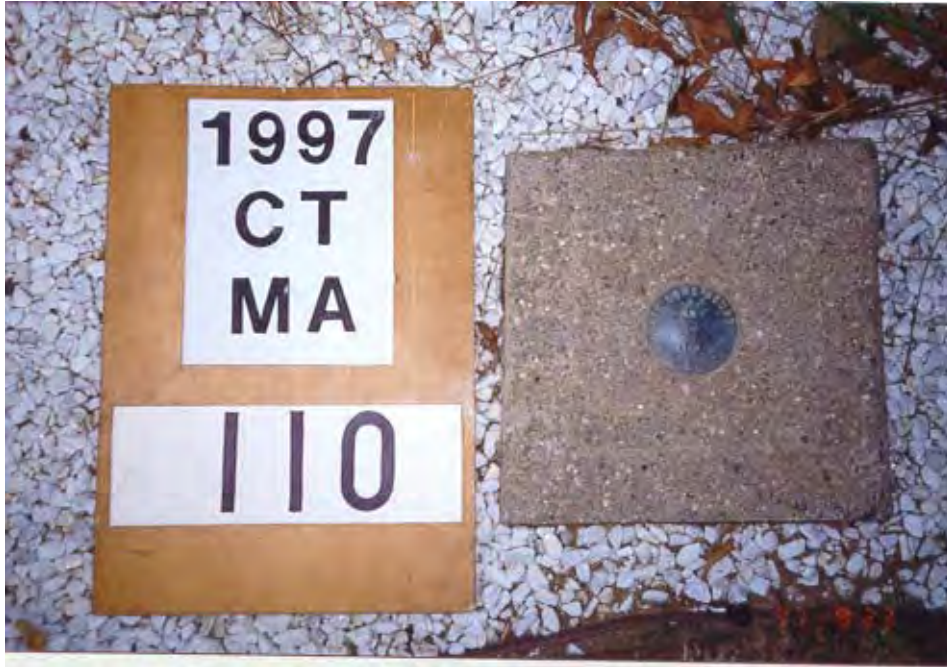

PHOTOGRAPHED NORTHEASTERLY



PHOTOGRAPHED NORTHEASTERLY

LINE BOUND #110

REGULATION GRANITE MONUMENT

PAVED HIGHWAY

From the intersection of Route 187 and Barry Street, proceed southerly on Route 187 to Bound at 0.2 mile. The highway runs straight, ascending slightly, southerly, and drops off abruptly 200 feet south of the Bound.

Bound is located 20 feet east of the center of the traveled way. Level scrub woodland to the east and west of the highway and north of the line. A small barn lies opposite the Bound, west of the highway and south of the line. A residence lies 150 ± feet southeast of the Bound. A new church now lies 150 ± east of Bound.

Bound was marked by a regulation granite monument showing 3.2 feet above ground. It was lettered "1906" on the west, "A Mass." on the north and "S Conn." on the south face. It was 9.4 feet long, set in excavation made in sand. Monument was set June 19, 1907.

Bound was reported to be broken off 13 inches below ground level on November 8, 1973.

The repair was accomplished on November 14, 1979, by drilling four holes 3 inches deep and inserting ½ inch steel deformed bars 15 inches long. Concrete was then poured into a form 14 inches square and 15 inches deep to a level 2 inches above the existing ground.

A bronze disk with the words "State Line Bound Mass/Conn 110" was inserted in the center of the concrete. A drill hole was placed in the center of the disk.

1906 Station 249140
Bound #109 - 275 feet east
Bound #111 - 3538 feet west

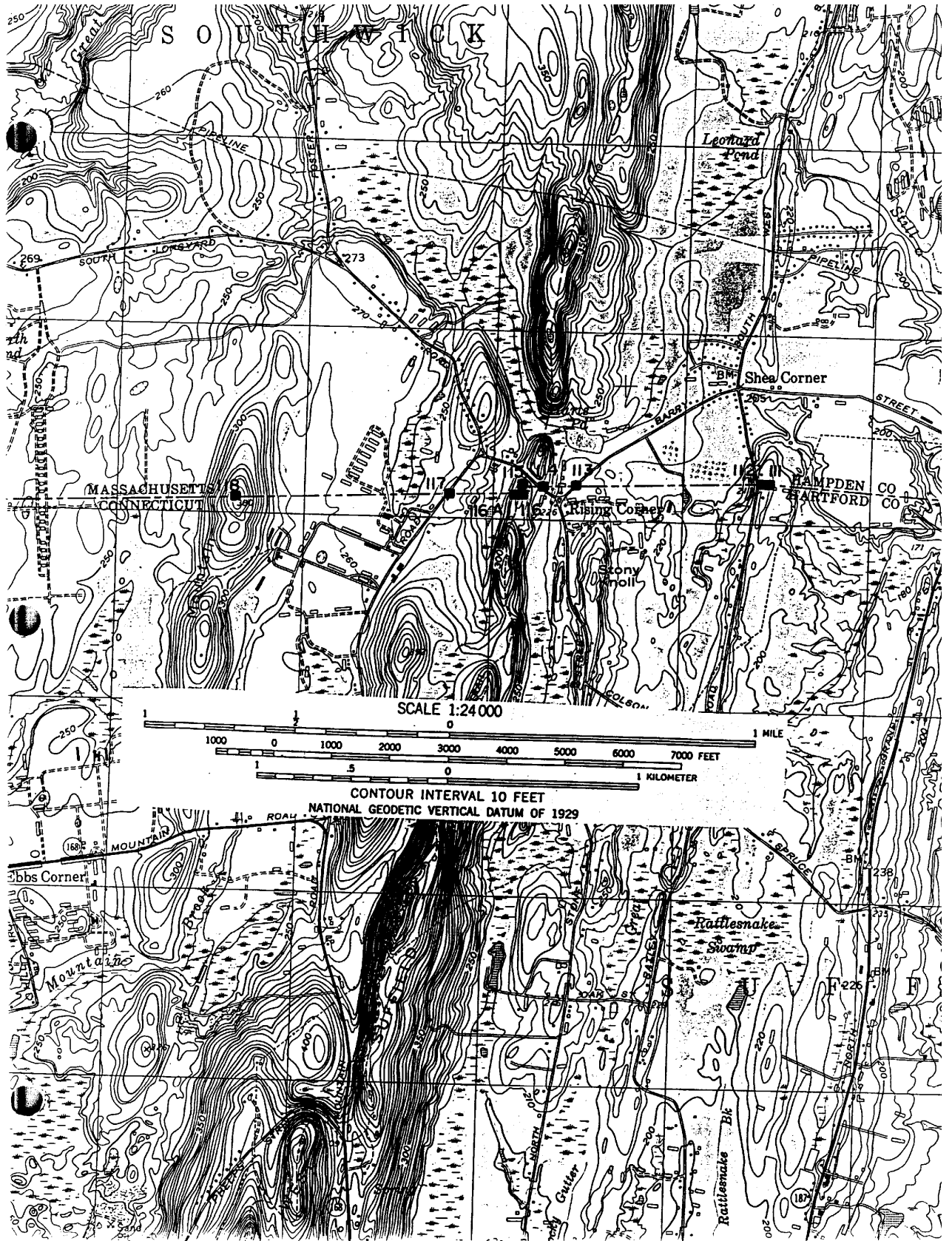



PHOTOGRAPHED SOUTHEASTERLY



PHOTOGRAPHED SOUTHEASTERLY

LINE BOUND #111

SMALL SANDSTONE MONUMENT

INTERIOR LINE SUMMIT

From the State Line on the highway running south from Shea Corner, at Bound #112, proceed easterly on line up grade along north side of yard of residence, 110 feet to Bound.

Bound is located at the line summit, at the side yard of a frame house standing about 60 feet south of the Bound. A 1 ½ story frame house (#861 E.J. Hart residence) is about 75 feet north of the Bound. A wire fence running east-west touches south face of Bound. Northwest and southwest corners of Bound are severely chipped with lesser chips on other corners.

Bound is marked by a dressed sandstone monument showing 1.0 foot above ground. It is 9 inches by 12 inches in section, with a 5/8 inch drill hole 1 ½ inches deep in the top and is lettered "M State Line 1803" on the north and "C State Line" on the south face. It is 4.6 feet long, set in excavation made in loam and 2.6 feet in ledge. Monument was set June 20, 1907.

1906 Station 252678
Bound #110 - 3538 feet east
Bound #112 - 110 feet west



PHOTOGRAPHED EASTERLY



PHOTOGRAPHED NORTHEASTERLY

ANGLE BOUND#112

REGULATION GRANITE MONUMENT

PAVED HIGHWAY

From the intersection of Route 187 and Barry Street, proceed westerly on Barry Street to intersection 205 at Shea Corner at 0.8 mile. Proceed southerly on South West Street to Bound at 1.1 miles. Highway crosses brook 400 feet north of the line, rises gradually, southerly, and curves to the west from the brook to the Bound where it straightens out and levels off to the south.

Bound is located 24 feet east of the center of the traveled way. It is 2.3 feet west of an 8 inch by 8 inch rock faced granite monument showing 1.8 feet above ground, severely tipped to the northwest, lettered "H" on the west face and marking a Suffield highway bound. Bound is 80 feet southwest of a 1 ½ story frame house, #861, E.J. Hart residence. There is a story-and-a-half residence on a knoll (#1646) about 100 feet southeast of the Bound. Land rises to the east with residences north of the line, and drops off abruptly west of the highway to level, scrub oak woods.

Bound is marked by a regulation granite monument showing 3.6 feet above ground. It is lettered "1906" on the west, "A Mass." on the north and "S Conn." on the south face. It is 10.1 feet long, set in excavation made in brown sandy clay. Monument was set June 19, 1907, in the exact location of the old 1803 sandstone monument.

1906 Station 252788
Bound #111 - 110 feet east
Bound #113 - 3123 feet west



PHOTOGRAPHED SOUTHWESTERLY



PHOTOGRAPHED NORTHEASTERLY

LINE BOUND #113

REGULATION GRANITE MONUMENT

PAVED HIGHWAY

From the Village of Rising Corner, proceed northeasterly on paved road (Barry Street) 400 feet to Bound. Highway is rising slightly, northeasterly, to a high point opposite the Bound.

Bound is located 22 feet southeast of the center of the traveled way. Level cultivated land in all directions, with a residence 66 feet west of the Bound on the opposite side of the highway.

Bound was marked by a regulation granite monument, showing 3.3 feet above ground. It was lettered "1906" on the west, "A Mass." on the north and "S Conn." on the south face. It was 8.9 feet long, set in excavation made in sandy loam. Monument was set June 20, 1907.

In 1975, perambulation Bound was found broken off 1 foot below ground level. The lower section is 1 foot north of a 3-inch iron pipe projecting 2 ¼ feet. According to a local resident, the top section was knocked over by an auto in 1972.

The repair was accomplished on November 14, 1979, by drilling four holes 3 inches deep and inserting ½ inch steel deformed bars 13 inches long. Concrete was then poured into a form 14 inches square and 12 inches deep to a level 1 inch above the existing ground.

A bronze disk with the words "State Line Bound Mass-Conn 113" was inserted in the center of the concrete. A drill hole was placed in the center of the disk.

1906 Station 255911
Bound #112 - 3123 feet east
Bound #114 - 639 feet west



PHOTOGRAPHED NORTHEASTERLY



PHOTOGRAPHED EASTERLY

LINE BOUND #114

REGULATION GRANITE MONUMENT

PAVED HIGHWAY

From the Village of Rising Corner, proceed northwesterly on paved road (Rising Corner Road) 360 feet to Bound. Highway crosses a brook 300 feet southeast of the Bound and runs straight, ascending northwesterly to a summit 50 feet beyond the Bound.

Bound is located 28 feet northeast of the center of the traveled way. A lawn slopes down easterly from the Bound with scrub woodland dropping away southwest of the highway. There is a two-story residence 75 feet southeast of the Bound. Woodland rises northwest of Bound. All top corners of Bound are slightly chipped.

Bound is marked by a regulation granite monument showing 3.2 feet above ground. It is lettered "1906" on the west, "A Mass." on the north and "S Conn." on the south face. It is 9.2 feet long, set in excavation made in loam and 3 feet in ledge. Monument was set June 20, 1907.

1906 Station 256550

Bound #113 - 639 feet east

Bound #115 - 376 feet west

BOUND 115



PHOTOGRAPHED WESTERLY



PHOTOGRAPHED WESTERLY

ANGLE BOUND#115

AGAWAM-SOUTHWICK TOWN CORNER

REGULATION GRANITE MONUMENT

INTERIOR TOWN CORNER

From the State Line, on the highway running northwesterly from the Village of Rising Corner at Bound #114, proceed westerly across highway to paved private driveway at 60 ± feet, proceed on private driveway rising moderately for 200 ± feet, proceed 85 feet across lawn to Bound.

Bound is located 18 feet west of the center of an abandoned farm road which descends through woodland to the north. Woodland drops off to the west with lawns rising to the south, with lawn rising slightly then dropping off to the east. Three hundred feet ± to the south is a residence (#1605 Rising Corner Road West Suffield).

Bound is marked by a regulation granite monument showing 3.8 feet above ground. It is lettered "A 1906" on the east, "S Mass." on the west, "Mass." on the

1997

north and "S Conn." on the south face. It is 9.3 feet long, set in excavation made in sandy hardpan. Monument was set on June 20, 1907, in the exact location of the old 1803 sandstone monument.

1906 Station 256926
Bound #114 - 376 feet east
Bound #116 - 131 feet south

BOUND 116



PHOTOGRAPHED WESTERLY



PHOTOGRAPHED SOUTHWESTERLY

ANGLE BOUND#116

REGULATION GRANITE MONUMENT

INTERIOR ANGLE

From the State Line at the interior town corner marked by Bound #115, proceed southerly upgrade across lawn 131 feet to Bound.

Bound is located on the northeastern slope of a low hill in lawn, 35 feet west of the center of a paved driveway. Land rises to the southwest to the summit of the knoll about 80 feet distant. A residence lies 150 ± feet southwest of the Bound. Bound is tipped northeasterly and is chipped on top and on the edges.

Bound is marked by a regulation granite monument showing 3.8 feet above ground. It is lettered "1906" on the west, "S Mass." on the north, "S Conn." on the east and "S Conn." on the south face. It is 9.6 feet long, set in excavation made in sandy hardpan. Monument was set June 20, 1907, in the exact location of the old 1803 sandstone monument.

1906 Station 257057

1997

Bound #115 - 131 feet north
Bound #117 - 1257 feet west
Bound #116-A - 62 feet west

BOUND 116A



PHOTOGRAPHED SOUTHEASTERLY

PHOTOGRAPHED SOUTHWESTERLY

LINE BOUND #116-A

DRILL HOLE

INTERIOR LINE SUMMIT

From the State Line at the interior angle marked by Bound #116, proceed westerly on line 62 feet, slightly upgrade through scrub birch and pine woods to Bound at line summit.

Bound is located on the northerly slope of a hill in scrub birch and pine about 30 feet east of the westerly brow of the hill. There is a 2-story frame house at the top of a knoll 150 feet south of the Bound. It is in a boulder embedded in the ground and showing a 3-foot by 1 ¼-foot top, 6 to 8 inches above ground.

Bound is marked by a 5/8-inch drill hole 2 inches deep, sloping to the northwest, enclosed in a 2 ½-inch countersunk square near the eastern slope of the top of the boulder.

1906 Station 257119
Bound #116 - 62 feet east
Bound #117 - 1195 feet west



PHOTOGRAPHED NORTHEASTERLY



PHOTOGRAPHED NORTHEASTERLY

LINE BOUND #117

REGULATION GRANITE MONUMENT

PAVED HIGHWAY

From the Village of Rising Corner, proceed northwesterly on paved road (Rising Corner Road) passing Bound #114, at 0.05 mile, to intersection at 0.3 mile. Proceed southwesterly on Warner Town Road to Bound at 0.5 mile. Warner Town Road from the intersection runs straight, descending slightly, southwesterly, along a flat ridge.

Bound is located 23 feet southeast of the center of the traveled way. Cultivated fields slope gently away from the highway on the west, with scrub brush rising slightly on the east. A residence lies 200 ± feet to the northeast with a residence lying 300 ± feet southwesterly of Bound. All top corners and edges are slightly chipped. Road descends slightly to the south, past the Bound.

Bound is marked by a regulation granite monument showing 3.6 feet above ground. It is lettered "1906" on the west, "S Mass." on the north and "S Conn." on the south face. It is 9.5 feet long, set in excavation made in sandy loam and red gravel. Monument was set June 21, 1907.

1906 Station 258314

Bound #116 - 1257 feet east

Bound #118 - 3701 feet west

BOUND 118



PHOTOGRAPHED SOUTHERLY



PHOTOGRAPHED SOUTHWESTERLY

LINE BOUND #118

SMALL SANDSTONE MONUMENT

INTERIOR LINE SUMMIT

From the State Line on Warner Town Road at Bound #117, proceed southwesterly along Warner Town Road to a gravel drive on right at 0.2 mile. Proceed northwesterly on gravel drive to fork at 0.25 mile. Proceed northwesterly from fork along drive to a fork at 0.65 mile. Proceed northwesterly from fork to end of a gravel drive at 0.75 mile and Garrison style house at the top of the northerly summit of Huckleberry Mountain.

From the northeast corner of the range line of the Garrison house, proceed 191 feet north, then 26 feet east to the Bound. Bound is located 4 feet south of a line fence at the wooded northerly summit of Huckleberry Mountain. Woodland drops away in all directions. With line cleared it would see Bounds #116 and #117 to the east and Bounds #119 and #120 to the west.

Bound is marked by a dressed sandstone monument showing 1.2 feet above ground. It is 9 inches by 12 inches in section with a $\frac{3}{4}$ -inch drill hole one inch deep in top and is lettered "M State Line 1803" on the north and "C State Line" on the south face. It is 5.1 feet long. Monument was set June 21, 1907.

1906 Station 262015

Bound #117 - 3701 feet east

Bound #119 - 5107 feet west



PHOTOGRAPHED NORTHERLY



PHOTOGRAPHED NORTHERLY

LINE BOUND #119

REGULATION GRANITE MONUMENT

PAVED HIGHWAY

From the intersection of Route 168 (Mountain Road) and Grove Road, east of Congamond Lakes, proceed northerly on Grove Road to Bound at 1.2 miles. Highway passes along the west side of extensive tobacco fields. A 2 ½ story brick apartment building is 80 feet northeast of Bound.

Bound is located 23 feet east of the center of the traveled way. Level land on either side of the highway, with a tree plantation west of highway south of line, with woodland east of Bound just beyond a small clearing, with a pine grove west of highway north of line. All top corners of Bound are chipped.

Bound is marked by a regulation granite monument showing 2.6 feet above ground. It is lettered "1906" on the west, "S Mass." on the north and "S Conn." on the south face. It is 8.9 feet long, set in excavation made in yellow loam and red sand. Monument was set June 21, 1907.

1906 Station 267122

Bound #118 - 5107 feet east

Bound #120 - 918 feet west

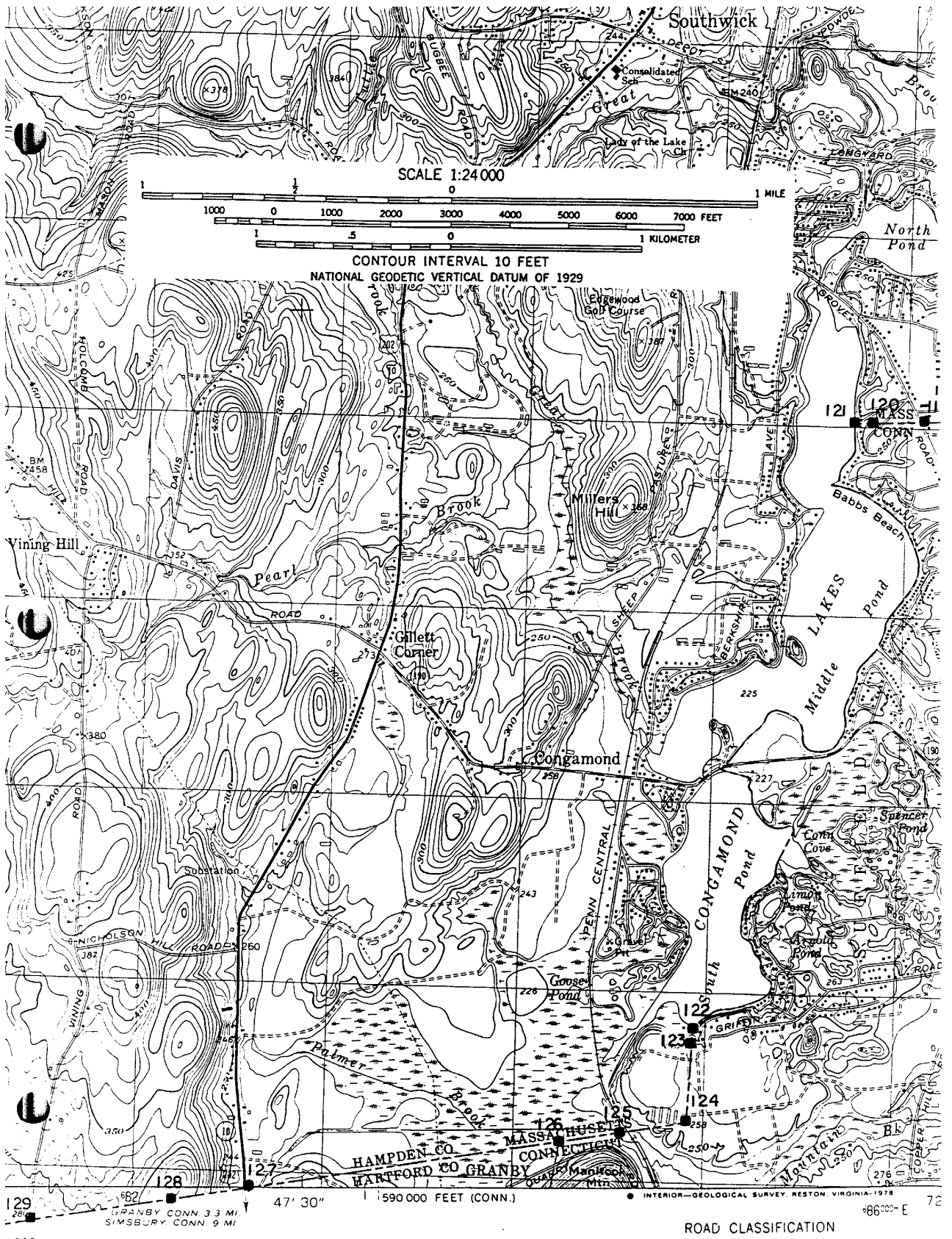

1997
CONNECTICUT-MASSACHUSETTS STATE BOUNDARY LINE PERAMBULATION
CONNECTICUT DEPARTMENT OF TRANSPORTATION



PHOTOGRAPHED SOUTHERLY



PHOTOGRAPHED WESTERLY

LINE BOUND #120

SMALL SANDSTONE BOUND

INTERIOR LINE SUMMIT

From the State Line on the east shore of Congamond Lakes, at Bound #121, proceed easterly on paved driveway in the bottom of a hollow, a distance of 200 feet. Proceed southerly up bank at right angles to paved driveway, 110 feet to Bound.

Bound is located at the westerly brow of a wooded plain, between wood road to the south and paved driveway to the north, leading west from Grove Road to cottages along the east shore of Congamond Lakes. Brushy woodland, level to the east and south, drops off to the west and north. Westerly and northwesterly are residences.

Bound is 12 feet north of an electric power line running east and west. Top northeast and northwest corners have large chips, with a smaller chip on top southwest corner.

Bound is marked by a dressed sandstone monument showing 0.9 feet above ground. It is 9 inches by 9 inches in section, with a $\frac{3}{4}$ inch drill hole one inch deep in the top and is lettered "M State Line" on the north and "C State Line" on the south face. It is 5.1 feet long, set in excavation made in sharp sand. Monument was set June 21, 1907.

1906 Station 268040
Bound #119 - 918 feet east
Bound #121 - 248 feet west



PHOTOGRAPHED NORTHEASTERLY



PHOTOGRAPHED EASTERLY

LINE BOUND #121

REGULATION GRANITE MONUMENT

INTERIOR LAKE SHORE

From the State Line on Grove Road, at Bound #119, proceed northerly on Grove Road 400 feet to intersecting paved road. Proceed westerly on paved road, taking northerly fork immediately after leaving highway and westerly at 0.2 mile, following along bottom of hollow to rear of residence, on east shore of Congamond Lakes at 0.3 mile. Proceed westerly, passing south of residence to lake shore and Bound.

Bound is located at the water's edge at the southwest corner of a wooden deck. Bound is hidden from the east by the wooden deck and is on the center line of the hollow to the east. During the 1986 Perambulation, the Bound was found to be leaning several inches to the west, due to lake shore erosion. Bound shows 5.5 feet above ground. Due to continuing water action and shore erosion the condition of this Bound will deteriorate unless corrective action is taken.

Bound is a witness mark for the angle at Bound #121-A, 15 feet to the west in the lake.

Bound is marked by a regulation granite monument showing 5.5 feet (4.2 feet originally above ground). It is lettered "1906" on the east, "S Mass." on the north and "S Conn." on the south face. It is set in excavation made in sandy gravel. Original monument was set June 21, 1907, in the exact location of the old 1803 sandstone monument. On the 1915 Perambulation, it was found broken in three pieces. The present monument, cut in accordance with the original specifications, was set December 19, 1915, in the exact location of the undisturbed base of the original monument.

1906 Station 268288
Bound #120 - 248 feet east
Bound #121-A - 15 feet west
Bound #122 - 19553 feet south

BOUND 121A REFERENCE POINT



PHOTOGRAPHED NORTHEASTERLY

ANGLE BOUND#121-A

REFERENCE POINT

Bound is an unmarked point (15 feet west of Bound 121) on Congamond Lakes, at the easterly shore of the lake, as it would be with the surface of the water at the elevation it was in 1803.

The line from Bound #121-A to Bound #121-B is defined as “the easterly shore of the lake as it would be with the surface of the water at the elevation it was in 1803.”

The elevation of the water surface of the lake in 1803 has been determined to be one foot below the top surface of the southwest corner of the brownstone foundation, or footing, of the north abutment of the arched culvert carrying the tracks of the New York, New Haven and Hartford Railroad Company over the outlet of the lake (#121-A Reference Point) about 900 feet north along railroad tracks from their intersection with Connecticut Route #168 (Mountain Road).

1906 Station 268273
Bound #121 - 15 feet east
Bound #121-B - 19500 feet south

ANGLE BOUND#121-B

Bound is an unmarked point in Congamond Lakes at the southerly shore of the lake as it would be with the surface of the water at the elevation it was in 1803.

1906 Station 287803
Bound #121-A - 19500 feet north
Bound #122 - 38 feet south

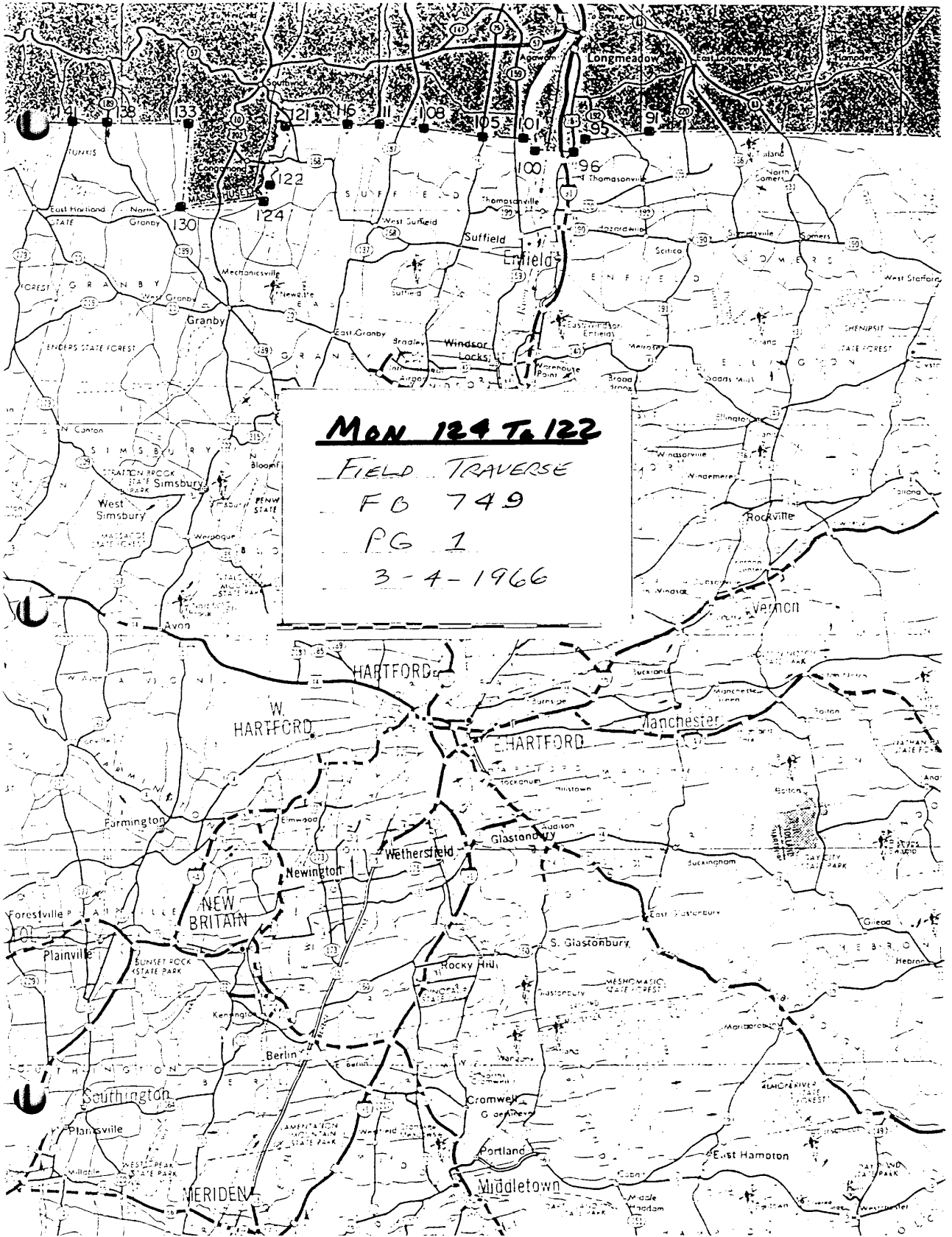

MON 124 TO 122

FIELD TRAVERSE

FB 749

PG 1

3-4-1966

BOUND 122, 123, & 124

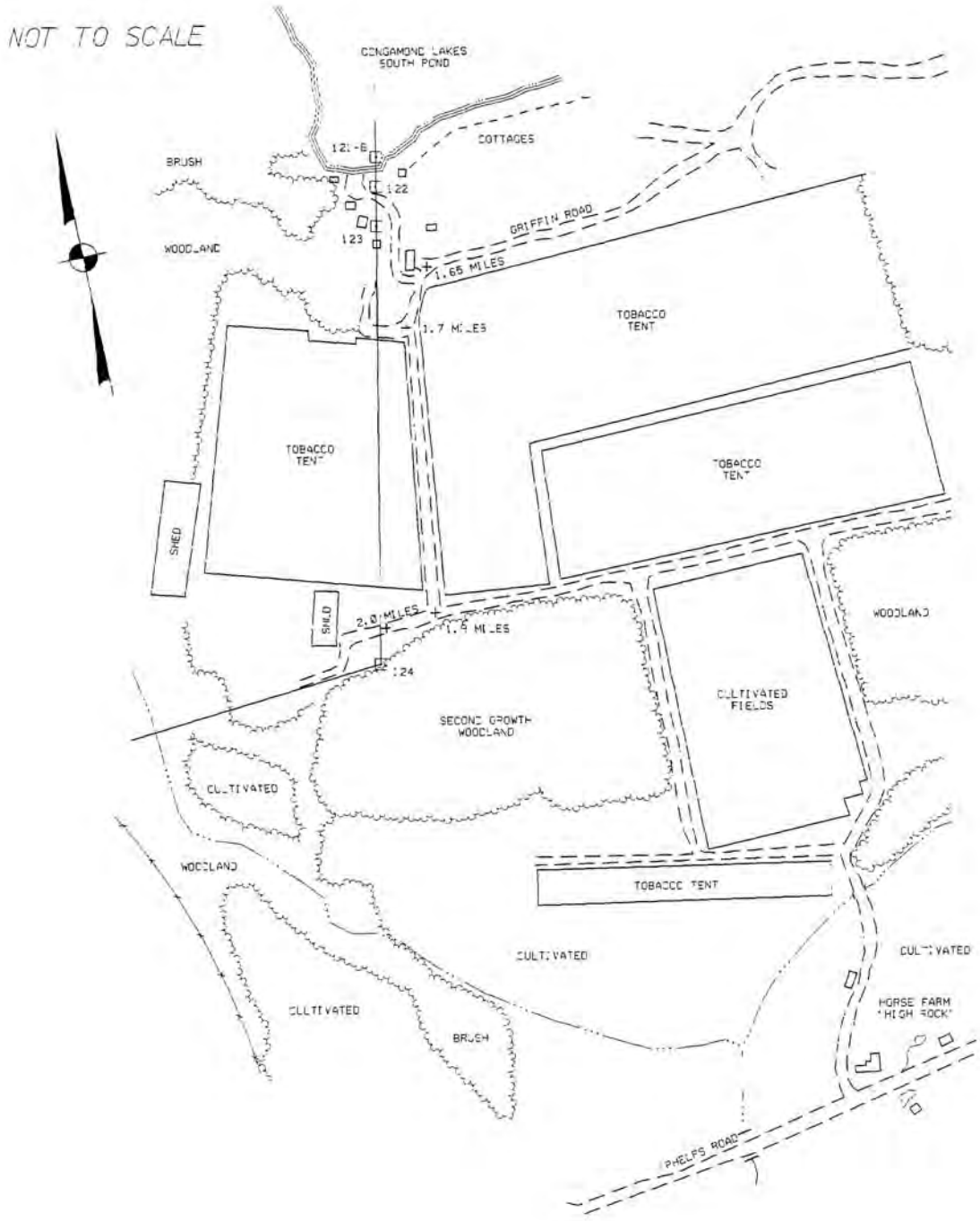



PHOTOGRAPHED SOUTHEASTERLY



PHOTOGRAPHED SOUTHEASTERLY

LINE BOUND #122

REGULATION GRANITE MONUMENT

INTERIOR LAKE SHORE

From the intersection of Copper Hill Road and Phelps Road, southeast of Congamond Lakes, proceed northerly on to intersecting Griffin Road at 0.75 mile. Following sketch, proceed westerly on Griffin Road to a point where highway turns 90 degrees southerly at 1.65 miles. Proceed southerly 50 feet to intersecting paved private road, turn westerly on private road descending and jogging northerly, and then westerly to small parking area at private beach. Bound is on east side of grass area south of beach and north of parking area.

Bound is located at the south edge of the beach in the north edge of the bushes lying east of the cleared land in front of the cottage. Woodland rises to the east and south with cottages close by on both sides. Bound is tipped slightly south with all top corners and edges slightly chipped.

Bound is a witness mark for the angle at Bound #121-B, 38 feet to the north in the lake.

Bound is marked by a regulation granite monument showing 3.6 feet above ground. It is lettered "1906" on the south, "S Mass." on the west and "S Conn." on the east face. It is 9.9 feet long, set in excavation made in sand and backfilled with concrete. Monument was originally set June 24, 1907, in the exact location of the old 1803 sandstone monument. Some time before 1910, it was pushed over by ice, and on November 22, 1915, it was reset 13.20 feet further south on line in a larger concrete base.

1906 Station 287841 (new location)
Bound #121 - 19553 feet north
Bound #121-B - 38 feet north
Bound #123 – 183.95 feet south



PHOTOGRAPHED SOUTHERLY



PHOTOGRAPHED NORTHEASTERLY



PHOTOGRAPHED SOUTHERLY



PHOTOGRAPHED NORTHEASTERLY

LINE BOUND #123

SMALL SANDSTONE MONUMENT

INTERIOR LINE SUMMIT

Following sketch, from Bound #122 on the southerly end of Congamond Lakes (South Pond) proceed 184 feet southerly, crossing paved road up a wooded steep slope onto a lawn east of residence (#560 Griffin Road) to Bound.

Bound is located in lawn east of the cottage. It is 10.20 feet from the southeast corner of the cottage, 9.50 feet at right angles to the base board, and 27.26 feet from the northeast corner of the front porch. The east face of the cottage measures 29.50 feet, corner to corner, including the porch.

Bound was marked by a dressed, sandstone monument 9 inches by 12 inches in section, originally 5.0 feet long and set with 1.0 foot showing above ground, broken off with the top of the remaining base 4 inches below ground surface. It is set in excavation made 1 ½ feet in sandy loam and 2 ½ feet in sharp sand. Monument was set June 25, 1907. In the fall of 1927, a truck backed into the monument and broke it off at ground level. It was further damaged by a bulldozer during grading operations in 1950.

On the 1965 perambulation, the monument was found in the same condition described above on a prior perambulation. In March 1966, a survey was run from monument #122 to monument #124 to determine the line. In September 1967, monument #123 was reset on line between #122 and #124.

The monument was repaired by straightening the original base of the monument. A 1 ½ foot collar of concrete 13 inches by 16 inches was then poured around the top foot of the base to make it flush with the ground. A bronze disk 3 inches in diameter with "State Line" inscribed on it was inserted in the concrete in its correct position on the line. Disk is 3 inches below surface of lawn.

1906 Station 288025

Bound #122 - 183.95 feet north

Bound #124 - 1434.6 feet south



PHOTOGRAPHED NORTHEASTERLY



PHOTOGRAPHED NORTHERLY

ANGLE BOUND#124

REGULATION GRANITE MONUMENT

INTERIOR ANGLE

From the intersection of Copper Hill Road and Phelps Road, southeast of Congamond Lakes, proceed northerly on Copper Hill Road to intersection of Griffin Road at 0.75 mile. Proceed westerly on Griffin Road to a point where the highway turns 90 degrees southerly at 1.65 miles. Following sketch, proceed southerly to the intersection with a gravel field road at 1.7 miles. Continue southerly on gravel field road passing between tobacco fields on both sides to a "T" intersection at 1.9 miles. Proceed westerly on field drive to bound at 2.0 miles.

Bound is located in open second growth woodland south of Congamond Lakes. Tobacco tents lie north of Bound and farm road. Nearly level land in all directions. All top corners of Bound are slightly chipped.

Bound is marked by a regulation granite monument showing 3.8 feet above ground. It is lettered "1906" on the west, "S Mass." on the north, "S Conn." on the east and "S Conn." on the south face. It is 10.0 feet long set in excavation made in sandy gravel. Monument was set June 24, 1907, in the exact location of the 1803 sandstone monument.

1906 Station 289460
Bound #123 – 1434.6 feet north
Bound #125 - 1156 feet west



PHOTOGRAPHED SOUTHEASTERLY



PHOTOGRAPHED SOUTHWESTERLY

LINE BOUND #125

REGULATION GRANITE MONUMENT

ABANDONED RAILROAD

From the underpass on Phelps Road, at the abandoned Northampton division of the N.Y., N.H. and H. R.R., Bound is located 1930 feet northerly on railroad right of way.

From the intersection of Phelps Road and Quarry Road proceed northerly on Quarry Road to dirt drive at 0.15 mile. Proceed easterly on dirt drive 125 feet to intersecting dirt road just west of abandoned railroad bed. Proceed northerly on dirt road following railroad bed 1100 feet to the remains of a small bridge over the outlet from a swamp lying west of the right of way behind the Bound. Proceed 85 feet north to Bound.

Bound is 30 feet west of the centerline of the railroad bed, from which the rails and ties are removed. A wooden witness post (#307) for underground cable is 10 feet east of Bound. Low brushy swamp land on both sides of the right of way. Bound leans to the southeast and has a large chip on the southeast corner.

Bound is marked by a regulation granite monument showing 4.0 (5.0 in 1986) feet above ground. It is lettered "1906" on the west, "S Mass." on the north and "S Conn." on the south face. There is no drill hole and a rough cross has been cut in the top. There is a 4-inch chip in the southeast corner. It is 8.8 feet long, set in a 6-foot square excavation on three 8-inch by 16-inch timbers 5 feet long, laid flat, east and west on top of four equal timbers laid north and south, with 6 inches of gravel bedding under base of monument. Top of the timber crib is 2.6 feet below the old ground surface. The entire excavation was filled with gravel and mounded up around the monument and paved 2 feet wide with cobbles.

1906 Station 290616

Bound #124 - 1156 feet east

Bound #126 - 1092 feet west



PHOTOGRAPHED NORTHEASTERLY



PHOTOGRAPHED WESTERLY

LINE BOUND #126

SUFFIELD - GRANBY TOWN CORNER

REGULATION GRANITE MONUMENT

INTERIOR TOWN CORNER

From the intersection of Phelps Road and Quarry Road, east of the northerly brow of Manitick Mountain, proceed northerly and westerly around the northerly end of Manitick Mountain to wood road to the southwest at town line at 0.5 mile.

Town line crosses Quarry Road, about 100 feet west of the east end of the long, straight and level section of Quarry Road and opposite the east edge of a good wood road leading to the southwest. From the center of Quarry road, at the town line, proceed N 25 degrees E 450 feet along wire fence remains on the west and through tall pines to Bound. Traces of a former wood road which led to the Bound may be followed by the evidences of filling. Wire fence corner is 25 feet east of CL&P #2094.

Bound is located in the southerly edge of a brush swamp. Low, level scrubby woodland in all directions, with swampy growth to the north and taller trees to the east and south. The lower one foot of exposed Bound is below water line.

Bound is marked by a regulation granite monument showing 3.9 feet above ground. It is lettered "G 1906" on the west, "S" on the east, "S Mass." on the north and "Conn." on the south face. It is 9.3 feet long, set in excavation made 2.3 feet in clay, 1.5 feet in tough clay and 1.5 feet in quicksand. Monument was set June 25, 1907. Small chips on corners and edges of Bound.

South 9.5 feet from the Bound is a granite monument showing 1.0 foot above ground, marking the Suffield-Granby town line. The top foot is dressed 8 inches by 8 inches, the rest is rock faced. It is furrowed diagonally across the top and is lettered "C S C" on the northeast, "1883" on the northwest, "S" on the southeast and "G" on the southwest face.

1906 Station 291708
Bound #125 - 1092 feet east
Bound #127 - 5465.9 feet west



PHOTOGRAPHED WESTERLY



PHOTOGRAPHED NORTHERLY

LINE BOUND #127

REGULATION GRANITE MONUMENT

PAVED HIGHWAY

From the Village of Five Points on Route U.S. 202, proceed northerly on Route U.S. 202 to Bound at 0.35 mile. A road, after running straight and descending slightly northerly, curves to the north 300 feet south of the line and crosses a culvert 160 feet south of the Bound.

Bound is located 27 feet east of the center of the traveled way. Scrub brush drops off east of the Bound to a brook with cultivated land to the southeast. Cultivated land rises west of the highway; woodland to the northwest of highway. There is a filling station and residence about 150 feet north of the Bound.

Bound is marked by a regulation granite monument set flush with ground. It is lettered "1906" on the west, "S Mass." on the north and "G Conn." on the south face. It is 9.5 feet long, set in excavation made in sand. Monument was set June 26, 1907.

On the 1965 Perambulation, the monument was found to be leaning to the east. In May, 1967, a survey was run from monument #126 to monument #128 to determine the line. In June, 1967, the monument was reset on the line between monuments #126 and #128.

When straightening the monument, it was found to be broken off 3.2 feet from the top. The top portion was then placed on its base and a 1.5 foot thick concrete collar 2.5 feet in diameter was then placed around the break. About 1.5 feet of sand fill was then placed on top of the collar.

The monument is flush with surrounding area.

1906 Station 297174
Bound #126 - 5465.9 feet east
Bound #128 - 1282 feet west



PHOTOGRAPHED NORTHERLY



PHOTOGRAPHED NORTHERLY

LINE BOUND #128

SMALL SANDSTONE MONUMENT

INTERIOR LINE SUMMIT

From the State Line on Route U.S. 202 at Bound #127, proceed southerly on Route U.S. 202 to church on the west side of the highway at 0.1 mile.

From the westerly edge of Route U.S. 202 near the southerly end of a parking lot located just north of a church proceed westerly 130 feet \pm , crossing a foot bridge over a small watercourse and passing just south of the parsonage to a fence corner, 40 feet \pm off range of north side of church, at the northeast corner of a parking lot. Continue westerly along fence 365 feet through woodland at the foot of the hill. Continue westerly along fence through open woods up hill 590 feet to an iron pipe at a fence to the north. Proceed northerly along fence 167 feet N 10 E to an iron pipe in the fence line, 3 feet north of a 20-inch hickory. Proceed N 80 W, 87 feet to line summit and Bound.

Bound is located at the southerly end of a flat hilltop in open woods, a little east of the line summit. It is 87 feet west of an iron pipe in a wire fence 167 feet north of its southerly end at a fence running east and west. Woodland, which is level for 100 feet north and south of the Bound, drops away beyond and in other directions. Bound is heavily damaged due to vandalism; the top half of the "1803 C" is chipped off.

Bound is marked by a dressed sandstone monument showing 0.8 foot above ground. It is 8 inches by 12 inches in section, with a $\frac{1}{2}$ inch drill hole $1\frac{1}{4}$ inches deep in top and is lettered "M Line" on the north and "1803 C" on the south face. It is 4.2 feet long, set in excavation made in sandy loam. Monument was set June 25, 1907.

1906 Station 298456
Bound #127 - 1282 feet east
Bound #129 - 2502 feet west



PHOTOGRAPHED NORTHEASTERLY



PHOTOGRAPHED NORTHEASTERLY

LINE BOUND #129

REGULATION GRANITE MONUMENT

PAVED HIGHWAY

From the Village of Five Points on Route U.S. 202, proceed westerly on East Street to intersection at 0.6 mile. Proceed northerly on paved highway (Vining Hill Road) to Bound at 0.8 mile. Road runs straight, ascending slightly, northerly, and curves to the east and levels off, 200 feet south of the Bound. A witness stake lies 0.5 feet north of Bound, marking an underground cable.

Bound is located 15 feet east of the center of the traveled way and 2 feet east of a concrete town line sign post. Undulating cultivated fields on all sides slope away slightly to the south and east.

Bound is marked by a regulation granite monument, showing 3.9 feet above ground. It is lettered "1906" on the west, "S Mass." on the north, and "G Conn." on the south face. It is 8.9 feet long, set in excavation made in gravel. Monument was set June 26, 1907.

1906 Station 300958
Bound #128 - 2502 feet east
Bound #130 - 2329 feet west

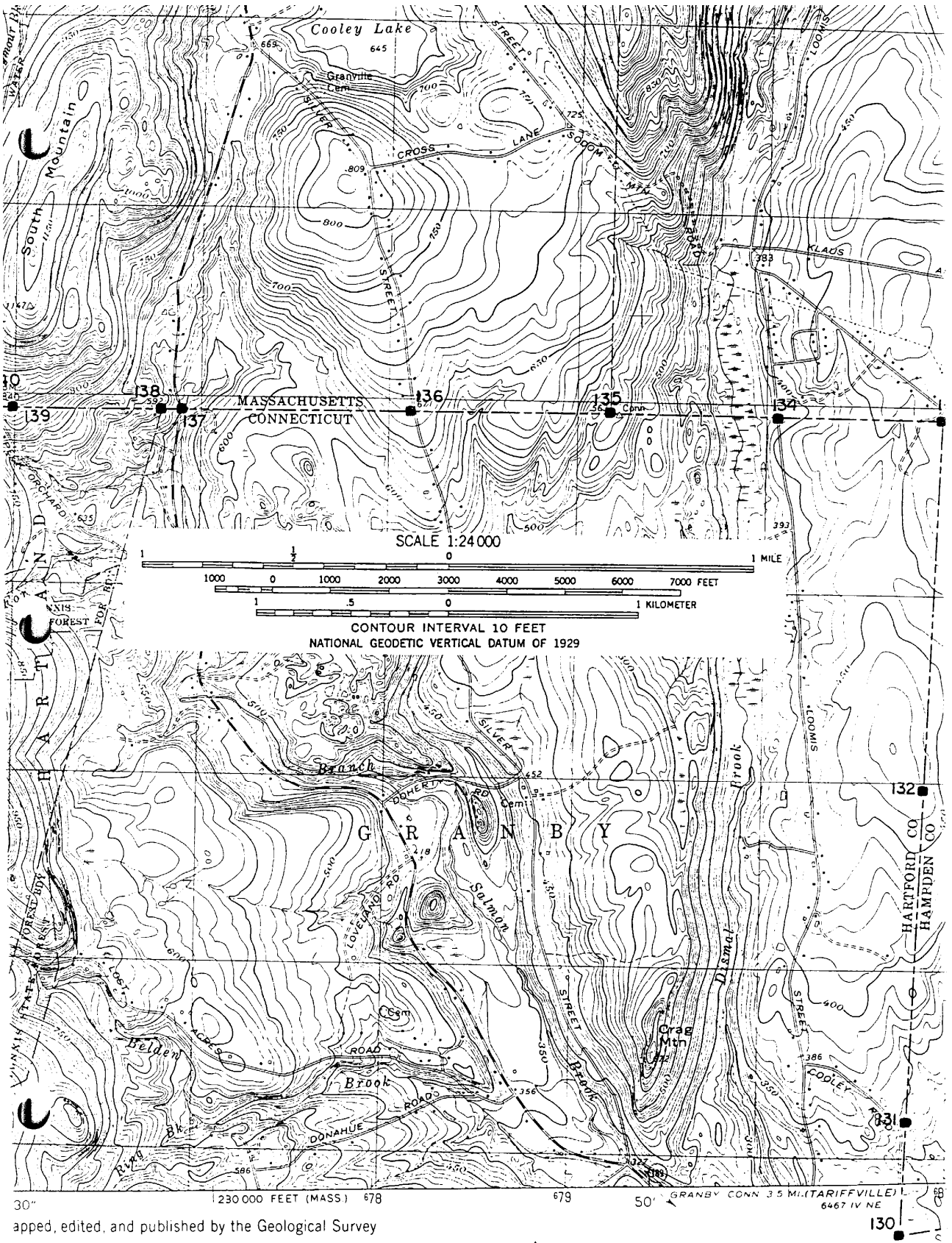



PHOTOGRAPHED NORTHWESTERLY



PHOTOGRAPHED NORTHEASTERLY

ANGLE BOUND#130

REGULATION GRANITE MONUMENT
(Bottom Portion Remains)

PAVED HIGHWAY

From the Village of Five Points on Route U.S. 202, proceed westerly on East Street, through intersection at 0.6 mile, to intersection at 1.1 miles. Proceed northerly to Bound, 85 feet north of the intersection. Cooley Road runs straight past Bound, ascending slightly, northerly, from the intersection.

Bound is located 20 feet east of the center of the traveled way and 36 feet south of the south end of the east highway wall. Relatively level cultivated land north and east of bound. A residence lies just west of Cooley Road west of Bound. A farm lies south of Bound along south side of East Street. Scrub woodland lies north of line west of Cooley Road.

Bound was marked by a regulation granite monument showing 4.0 feet above ground. It was lettered "1906" on the east, "S Mass." on the north, "G Conn." on the west and "G Conn." on the south face. It was 9.0 feet long, set in excavation made in sandy gravel. Monument was set June 26, 1907, in the exact location of the old 1803 sandstone monument.

In the winter of 1994-1995, the top 3 feet 9 inches of the Bound was broken off at ground level. The broken off monument piece was brought to the State of Connecticut, District IV Office, in Thomaston, Connecticut, in January, 1995, for storage.

On September 4, 1997, the broken off piece of monument was delivered to the Granby Historical Society by the State of Connecticut, District IV Survey Section, Thomaston, Connecticut.

On September 4, 1997, State of Connecticut, District IV Surveys, set a state line disc in the center of the remaining bottom section of the Bound. The bottom section was found to be in the same location as it was before it was broken off.

The disc was set and drilled with a 3/16 inch drill hole in the center of the disc and stamped 130. The disc also has "State Line" stamped on it and is 3 inches in diameter. Also see "Swing Tie" sketch.

1906 Station 303287
Bound #129 - 2329 feet east
Bound #131 - 1957 feet north

BOUND 130

NOT TO SCALE

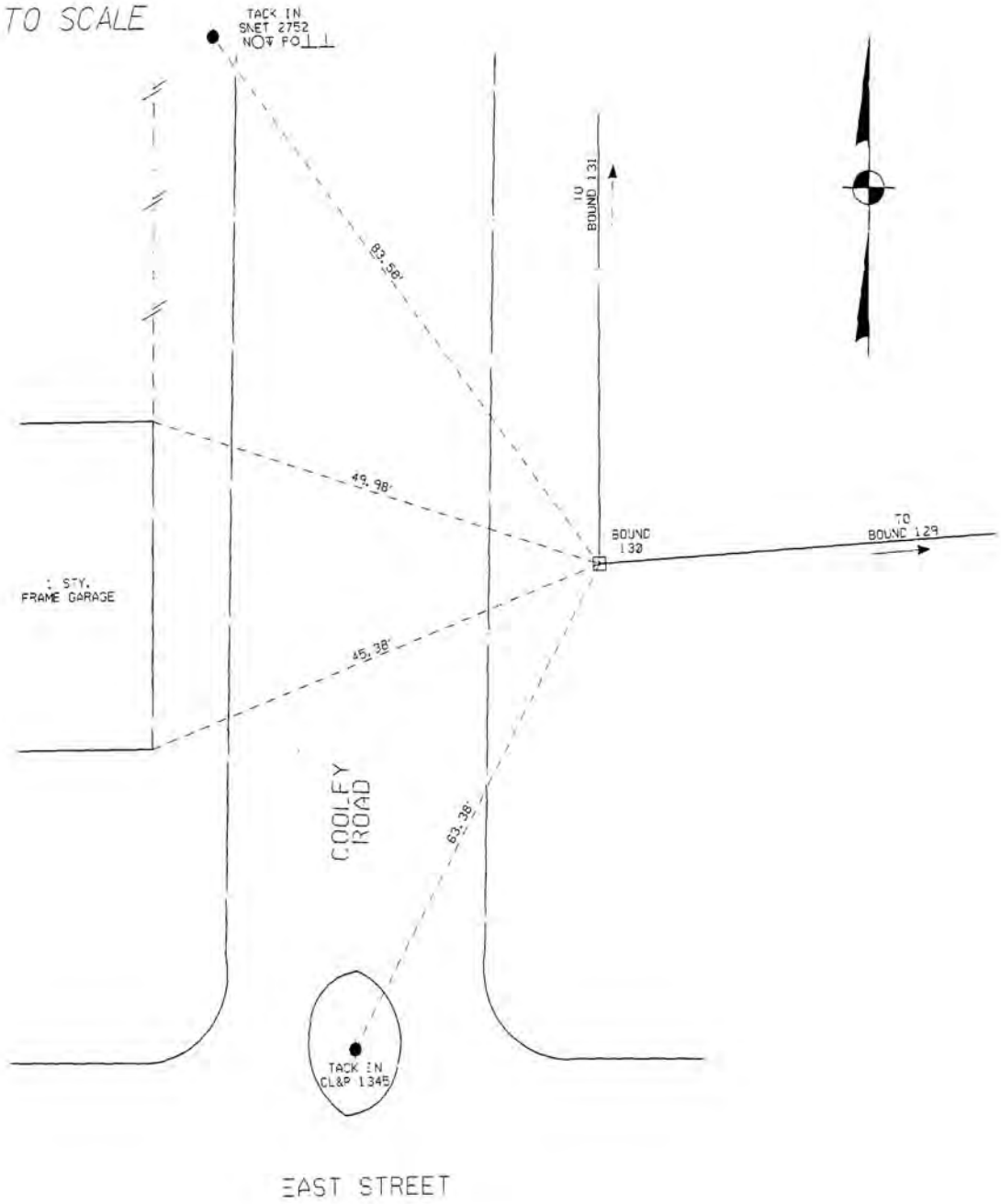



PHOTOGRAPHED WESTERLY



PHOTOGRAPHED WESTERLY

LINE BOUND #131

SMALL SANDSTONE MONUMENT INTERIOR INTERMEDIATE POINT

From the Village of Five Points on Route U.S. 202, proceed westerly on East Street, through intersection at 0.6 mile, to intersection at 1.1 miles. Proceed northerly on Cooley Road, passing Bound #130, to a point opposite Bound at 1.45 miles. Road runs straight north from East Street to a point opposite Bound, where it bends sharply to the northwest. Proceed northwesterly to drive to House #32 at 1.5 miles.

The Bound is located 216 feet S 50 E degrees from a driveway entrance to House #32, Cooley Road (Cianfarani Residence). The Bound is on a knoll in a lawn and at east edge of a flower garden. Bound is 66 feet southeast of the southeast corner of 1 ½ story house and 80 feet southeast of the southwest corner of house. Scrub woodland drops off to the east, as do pastures and cultivated land to the south and on the west of the highway. Top corners and edges of Bound are chipped.

Bound is marked by a dressed sandstone monument showing 0.8 foot above ground. It is 9 inches by 11 inches in section with drill hole in top and is lettered "M State Line" on the east and "C State Line" on the west face. It is 5.1 feet long, set in excavation made in sand. Monument was set June 26, 1907.

1906 Station 305244
Bound #130 - 1957 feet south
Bound #132 - 5786 feet north



PHOTOGRAPHED WESTERLY



PHOTOGRAPHED WESTERLY

LINE BOUND #132

SMALL SANDSTONE MONUMENT

INTERIOR LINE SUMMIT

From the intersection of Route 189 and East Street in the center of the Village of North Granby, proceed easterly on East Street to Loomis Street at 0.4 mile. Proceed northerly on Loomis Street to intersection at 1.7 miles. Proceed easterly on Heather Lane, jogging northerly to house #27 at 2.1 miles.

House #27 is located on east side of Heather Lane in a residential development. From the northeast corner of a four bay attached garage of house #27, proceed easterly on northerly range of garage, 220 feet across lawn and into open woodland to line. Proceed southerly 15 feet to Bound. Bound is located at the line summit on the southeasterly slope of a flat wooded hill. Residences lie west of the line with woodland dropping off slowly to the east and south, and level woodland to the north.

Bound is marked by a dressed sandstone monument showing 1.0 foot above ground. It is 10 inches by 12 inches in section with a 5/8 inch drill hole 1 ½ inches deep in top and is lettered "M State Line" on the east and "C State Line 1803" on the west face. It is 4.9 feet long, set in excavation made in sandy loam. Monument was set June 27, 1907.

1906 Station 311030
Bound #131 - 5786 feet south
Bound #133 - 6519 feet north



PHOTOGRAPHED NORTHEASTERLY



PHOTOGRAPHED SOUTHEASTERLY

ANGLE BOUND#133

REGULATION GRANITE MONUMENT

INTERIOR ANGLE

From the intersection of Route 189 and East Street in the center of the Village of North Granby, proceed easterly on East Street to Loomis Street at 0.4 mile. Proceed northerly on Loomis Street to Bound #134 at 3.1 miles. Continue northerly to intersection at 3.6 miles. Proceed southeasterly on Vining Hill Road to a point opposite Bound at 4.4 miles. Road emerges from woodland to cultivated field on both sides, descends to a low point and then ascends, southeasterly, passing a farmstead on the northeast side of the highway. High tension power lines cross highway 400 feet \pm to the southeast.

Bound is located 172 feet southwest of the center of the traveled way in scrub brush, sloping gently to the southwest with a large pine plantation beyond an overgrown field. There is a 2-story frame dwelling (#173) 100 feet southeast of Bound. The remains of a wire fence which begins 10 feet southwest of the edge of the highway passes by Bound. All top corners and edges of Bound are chipped. Bound is slightly tipped to the northwest.

Bound is marked by a regulation granite monument showing 3.8 feet above ground. It is lettered "1906" on the west, "S Mass." on the north, "S Mass." on the east and "G Conn." on the south face. It is 9.6 feet long, set in excavation made in loam, clay and hardpan. Monument was set June 26, 1907, in the exact location of the old 1803 monument, known as the "Crank Monument".

Monument leans 1 inch to the south but is firmly set.

1906 Station 317549
Bound #132 - 6519 feet south
Bound #134 - 2859 feet west



PHOTOGRAPHED SOUTHEASTERLY



PHOTOGRAPHED SOUTHEASTERLY

LINE BOUND #134

REGULATION GRANITE MONUMENT

PAVED HIGHWAY

From the intersection of Route 189 and East Street in the center of the Village of North Granby, proceed easterly on East Street to Loomis Street at 0.4 mile. Proceed northerly on Loomis Street to Bound at 3.1 miles. Road, after passing between extensive cultivated fields and residences, enters woodland running straight and undulating. It crests about 600 feet south of the line, descends northerly and flattens out opposite the Bound, running level to the north. Road opposite Bound and northerly is wider.

Bound is located 24 feet east of the center of the traveled way opposite a point 120 feet north of a culvert. Woodland on both sides of the road rises south of the line. East of highway north of line is level with a small pine grove. Bound is 20 feet south of the centerline of a private drive that leads easterly 100 feet \pm to a small clearing used for storage of construction equipment and materials. A residence lies 250 feet \pm northwest of Bound, west of highway. All top corners and edges of Bound are badly chipped and slightly tipped to the east.

Bound is marked by a regulation granite monument showing 3.9 feet above ground. It is lettered "1906" on the west, "S Mass." on the north and "G Conn." on the south face. It is 9.6 feet long, set in excavation made in gravel and loose stones. Monument was set June 26, 1907.

1906 Station 320408
Bound #133 - 2859 feet east
Bound #135 - 2899 feet west

BOUND 135 REFERENCE POINT
TRIANGULATION STATION



PHOTOGRAPHED EASTERLY



PHOTOGRAPHED NORTHEASTERLY



PHOTOGRAPHED SOUTHWESTERLY



PHOTOGRAPHED WESTERLY

LINE BOUND #135

SOUTHWICK-GRANVILLE TOWN CORNER

REGULATION GRANITE MONUMENT

INTERIOR TOWN CORNER

From the State Line on Silver Street, at Bound #136, proceed southeasterly 660 feet to an intersection of Silver Street and Silver Brook Lane. Proceed northerly and then easterly along Silverbrook Lane for 2990 feet to a point on the road, 175 feet \pm east of a pair of "C" catch basins. Following sketch, proceed N 40 degrees E, 665 feet along wire fence remains to a concrete monument. Continue N 40 degrees E, 65 feet along wire fence remains to an intersecting fence. Proceed easterly 55 feet to Bound.

Bound is located 55 feet north of the line fence and 2 feet west of the town line fence dividing woodland on the east from woodland on the west, with large oak trees along the town line fence. A 48 inch oak tree is 15 feet west of the Bound. Woodland rises to the east about 150 feet to the line summit which sees 20 miles to the east. Woodland drops away to the west about 100 feet to a small swamp. Level woodland to the south, rising slightly to the north.

Bound is marked by a regulation granite monument showing 4.1 feet above ground. It is lettered "S 1906" on the east, "G" on the west, "Mass." On the north and "G Conn." On the south face. It is 9.7 feet long, set in excavation made in sandy loam and hardpan. Monument was set June 27, 1907.

There is a U.S.G.S. triangulation station 158 feet east of Bound #135 and 33 feet north of the line fence. There is also wire fence running east-west directly atop the station. Station is marked by a $\frac{1}{2}$ inch drill hole enclosed in a 6 inch triangle cut in the top of a boulder showing 3 feet by 1.5 feet, 6 inches above ground.

1906 Station 323307

Bound #134 - 2899 feet east

Bound #136 - 3448 feet west



PHOTOGRAPHED SOUTHEASTERLY



PHOTOGRAPHED SOUTHEASTERLY

LINE BOUND #136

REGULATION GRANITE MONUMENT

PAVED HIGHWAY

From the intersection of Route 539 and 189 in the center of the Village of North Granby, proceed northerly on Route 189 to intersection at Cregg Pond at 0.4 mile. Turn east (on Silver Street), cross bridge and proceed northerly to Bound at 3.2 miles. After crossing brook above Carson Pond at 2.5 miles, road rises steeply and emerges on a ridge ascending northerly between cultivated fields. Road curves slightly to the east and flattens out opposite the Bound.

Bound is located 23 feet west of the center of the traveled way at the south side of the driveway to a residence lying north of the line on the west side of the highway. It is 2.5 feet east of the center of the west highway wall and 55 feet west of the east highway wall. A wall to the west joins the west highway wall 13 feet south of the Bound. A residence lies 150 feet \pm northeast of Bound, with another residence 350 feet \pm southwest of Bound. All top corners of Bound are slightly chipped.

Bound is marked by a regulation granite monument showing 3.6 feet above ground. It is lettered "1906" on the west, "G Mass." on the north and "G Conn." on the south face. It is 9.7 feet long, set in excavation made in sand. Monument was set June 27, 1907.

1906 Station 326755
Bound #135 - 3448 feet east
Bound #137 - 4034 feet west

BOUND 137



PHOTOGRAPHED EASTERLY



PHOTOGRAPHED SOUTHEASTERLY

LINE BOUND #137

REGULATION GRANITE MONUMENT

PAVED HIGHWAY

From intersection 479, on Route 189, at Pecks Orchard Road, proceed northerly on Route 189 to Bound at 0.8 mile. The road, after rising northerly on an irregular alignment, straightens out opposite a farmstead west of the highway, about 1000 feet south of the line, curving to the west opposite the Bound.

Bound is located 19 feet east of the center of the traveled way. East of the Bound the land slopes down to a brook 100 feet to the east with woodland rising to the east of the brook. Woodland rises gently north of line and woodland rises steeply west of the highway. Slight chips on northwest and southwest top corners of Bound.

Bound is marked by a regulation granite monument showing 2.7 feet above ground. It is lettered "1906" on the west, "G Mass." On the north and "G Conn." on the south face. It is 9.7 feet long, set in excavation made in sandy gravel. Monument was set June 28, 1907.

1906 Station 330789
Bound #136 - 4034 feet east
Bound #138 - 322 feet west



PHOTOGRAPHED NORTHEASTERLY



PHOTOGRAPHED NORTHEASTERLY

LINE BOUND #138

GRANBY-HARTLAND TOWN CORNER

REGULATION GRANITE MONUMENT

INTERIOR TOWN CORNER

From the State Line on Route 189, at Bound #137, proceed westerly on line entering woodland west of the highway 20 feet south of the line and following along the northerly edge of brier-filled little valley in pine woods, 325 feet to Bound.

Bound is located in woods on the steep southeasterly slope of a knoll, 30 feet north of and 10 feet above the floor of a little valley running westerly into the gravel hillside from a point on the highway 65 feet south of Bound #137.

Bound is marked by a regulation granite monument showing 4.2 feet above ground. It is lettered "G 1906" on the east, "H" on the west, "G Mass." on the north and "Conn." on the south face. It is 9.5 feet long, set in excavation made in gravel. Monument was set June 28, 1907.

1906 Station 331111
Bound #137 - 322 feet east
Bound #139 - 2615 feet west



PHOTOGRAPHED WESTERLY



PHOTOGRAPHED WESTERLY

ANGLE BOUND#139

REGULATION GRANITE MONUMENT

INTERIOR ANGLE

From the State Line on Pecks Orchard Road, at Bound #140, proceed on farm road 15 feet north of Bound #140. Proceed easterly 315 feet along north side of line wall. Proceed 15 feet south of centerline of farm road to Bound. Farm road passes south of a residence which lies north of line wall.

Bound is located in the line wall at its junction with range of a wall 50 feet to the south. Apple orchards rise to the north and descend to the south with a residence 250 feet \pm north of Bound.

Bound is marked by a regulation granite monument showing 3.4 feet above ground. It is lettered "1906" on the west, "G Mass." on the north and "H Conn." on the south face. It is 9.6 feet long, set in excavation made in sand and loose rocks. Monument was set June 28, 1907, at the exact location of a hub known as Granville-Hartland 1 in the 1906 survey.

1906 Station 333726
Bound #138 - 2615 feet east
Bound #140 - 314 feet west



PHOTOGRAPHED NORTHEASTERLY



PHOTOGRAPHED SOUTHEASTERLY

LINE BOUND #140

REGULATION GRANITE MONUMENT

PAVED HIGHWAY

From intersection 479 on Route 189 at Pecks Orchard Road, proceed northwesterly on Pecks Orchard Road to Bound at 1.1 miles. Road rises steeply, northwesterly, straightening out opposite an old stone foundation in an orchard on the northeast, 1,000 feet southeast of the line. Twenty feet southeast of the Bound there is an entrance to the orchard.

Bound is located 16 feet east of the center of the traveled way and one foot west of the junction of the highway wall and the line wall to the east. Apple orchards southeast of the Bound with woodland west of the road sloping down to Seymour Brook. Woodland rises steeply west of the brook, south of the line. A wood frame residence lies 75 feet \pm northeast of Bound. North of Bound 15 feet is the centerline of a farm road running easterly north of the line wall.

Bound is marked by a regulation granite monument showing 3.4 feet above ground. It is lettered "1906" on the west, "G Mass." on the north and "H Conn." on the south face. It is 9.2 feet long, set in excavation made in sandy loam. Monument was set June 28, 1907. At the time of the 1997 Perambulation, there were chips on all corners of the Bound.

1906 Station 334040
Bound #139 - 314 feet east
Bound #141 - 2281 feet west

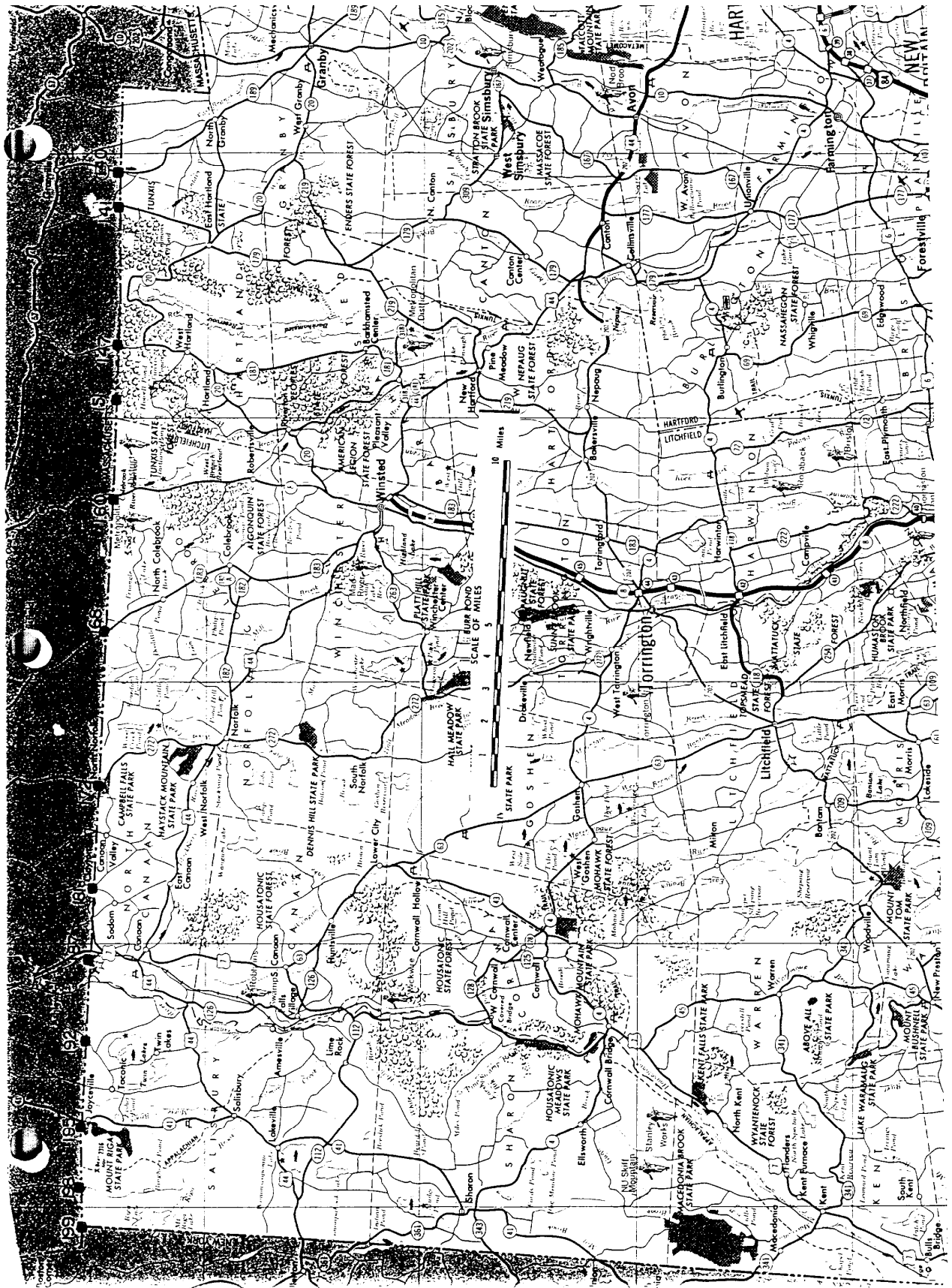

1997

CONNECTICUT-MASSACHUSETTS STATE BOUNDARY LINE PERAMBULATION
 CONNECTICUT DEPARTMENT OF TRANSPORTATION

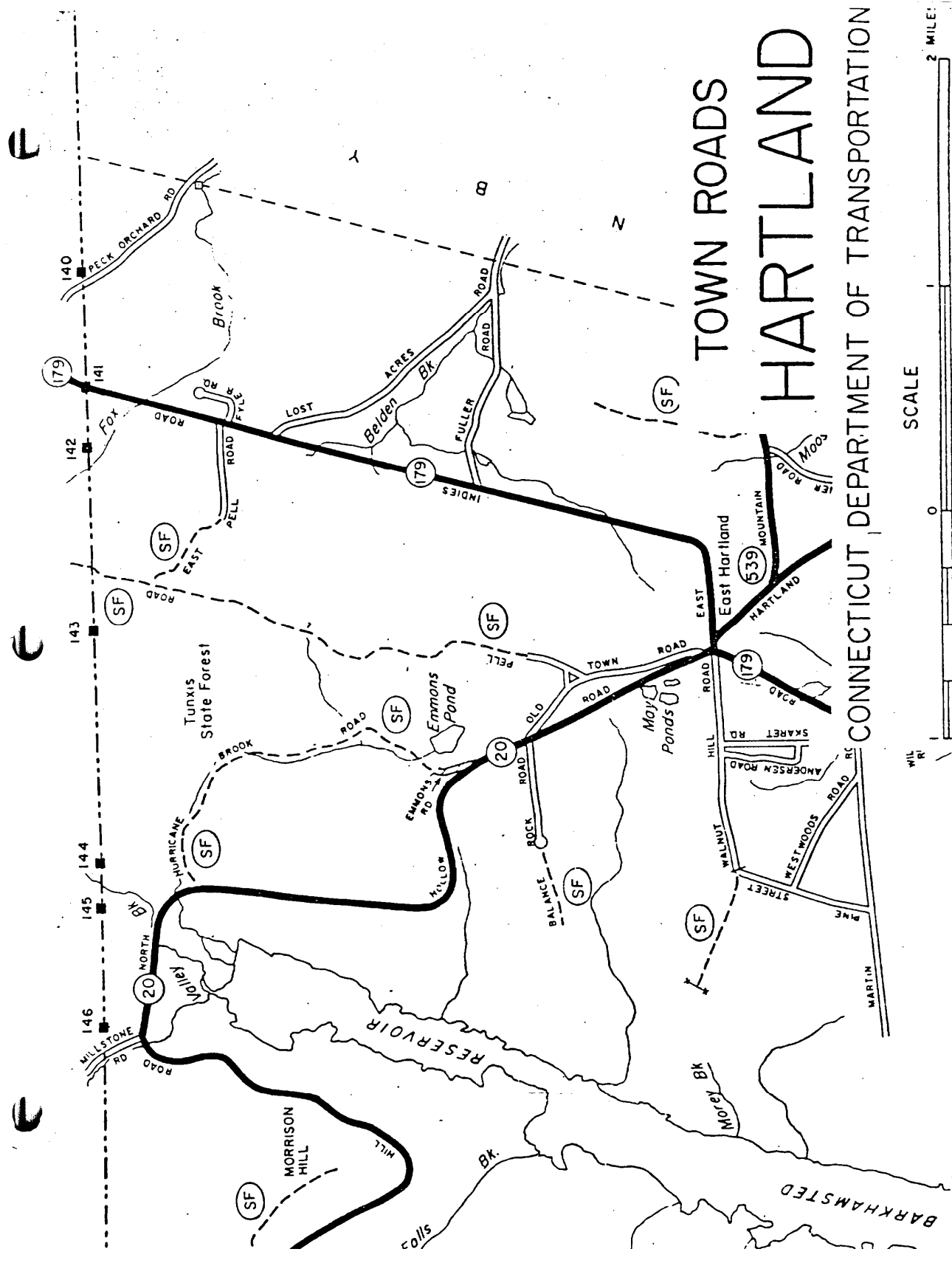

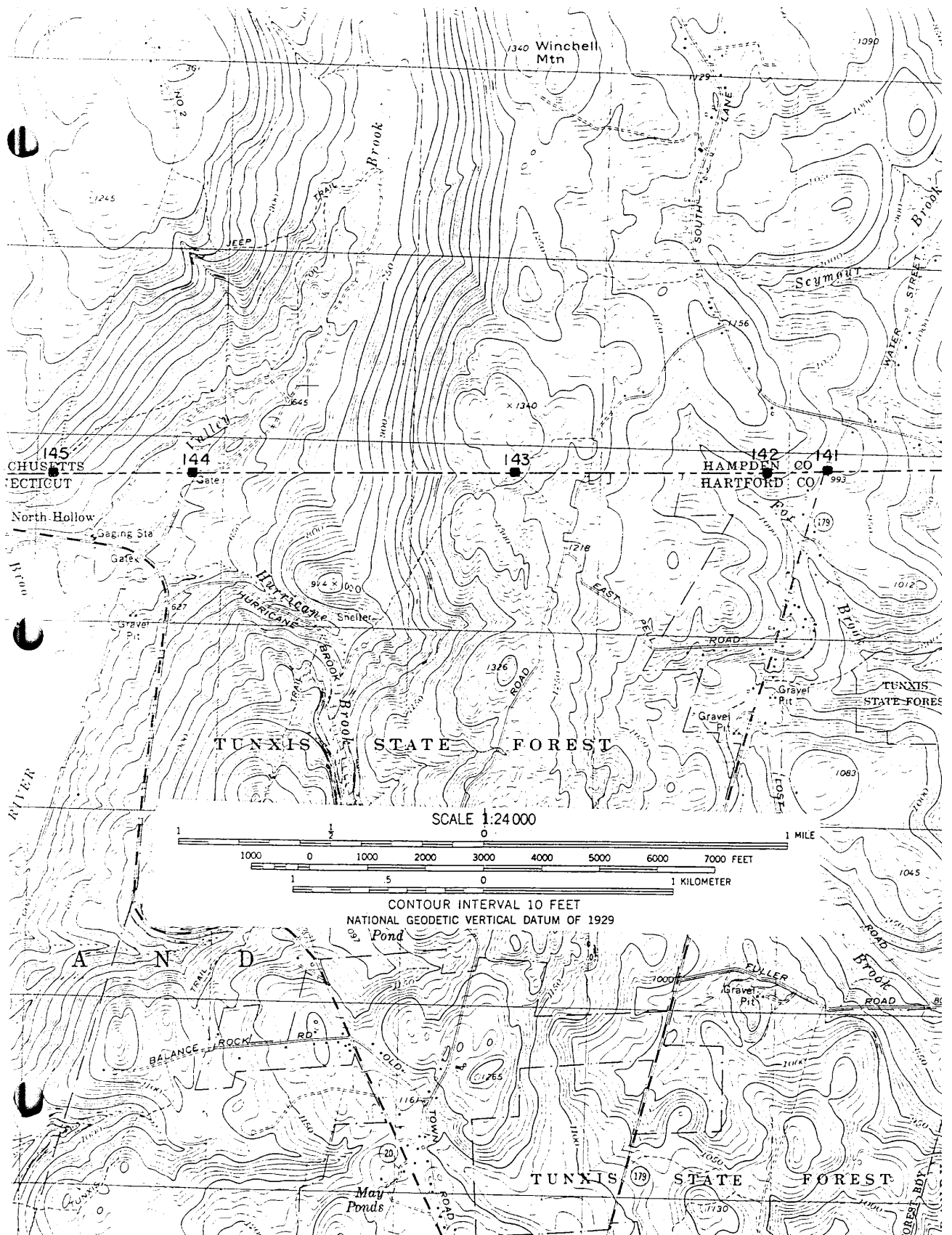



PHOTOGRAPHED NORTHEASTERLY



PHOTOGRAPHED NORTHEASTERLY

LINE BOUND #141

REGULATION GRANITE MONUMENT

PAVED HIGHWAY

From intersection 959 on Route 179 at Lost Acres Road, proceed northerly on Route 179 to Bound at 0.8 mile. Road, after crossing Fox Brook, rises steeply, northerly, crests opposite a farmstead 400 feet south of the line, descends northerly and curves slightly to the east opposite the Bound. Road rises again 300 feet north of the Bound to an intersection with South Lane No. 1, about 1,000 feet north of the Bound.

Bound is located 17 feet east of the center of the traveled way, 12 feet north of a culvert and 58 feet east of the west highway wall. West of highway woodland rises with level woodland northeast of highway. Woodland slopes away to the east. There is a residence 450 feet southwest of the Bound. All top corners and edges of Bound are slightly chipped.

Bound is marked by a regulation granite monument showing 3.4 feet above ground. It is lettered "1906" on the west, "G Mass." on the north and "H Conn." on the south face. It is 9.3 feet long, set in excavation made in sand and mica sand. Monument was set June 29, 1907.

1906 Station 336321
Bound #140 - 2281 feet east
Bound #142 - 1044 feet west



PHOTOGRAPHED NORTHERLY



PHOTOGRAPHED SOUTHWESTERLY

LINE BOUND#142

SMALL SANDSTONE MONUMENT

INTERIOR LINE SUMMIT

From the State Line on Route 179 at Bound #141, proceed westerly following line wall and fence 1,045 feet to line summit and Bound. Cross west highway wall at 60 feet and follow along north side of line wall in woodland, crossing wall at northeast at 250 feet, wall to north at 350 feet, wall to north at 600 feet, coming to end of line wall at 710 feet, crossing walls to north and south at 760 feet, to large stone heap on remains of line wall, 5 feet north of remains of line fence, at 1, 045 feet. Proceed southerly from stone heap 36 feet to Bound.

Bound is located 36 feet south of a large stone heap on the remains of the line wall at the edge of the cutting. Remains of line fence lie 5 feet south of the stone heap. Bound is at the west brow of the flat line summit on the southern slope of a rounded hill. It is 285 feet west of a stone wall running south from the line wall at the northwest corner of an old apple orchard grown up to briars. Woodland rises north of the line and pasture grown up to ferns and briars descends south of the line. Land drops off to the west and is fairly level to the east.

Bound is marked by a dressed sandstone monument showing 1.4 feet above ground. It is 7 inches by 11 inches in section with a 5/8-inch drill hole 1 ½ inches deep in top and is lettered "M State Line" on the north and "C State Line 1803" on the south face. It is 4.9 feet long, set in excavation made in sandy loam. Monument was set June 29, 1907.

1906 Station 337365
Bound #141 - 1044 feet east
Bound #143 - 4420 feet west



PHOTOGRAPHED SOUTHWESTERLY



PHOTOGRAPHED SOUTHERLY

LINE BOUND #143

REGULATION GRANITE MONUMENT

INTERIOR LINE SUMMIT

From the State Line on Route 179 at Bound #141, proceed southerly on Route 179 to intersecting paved road (East Pell Road) at 0.6 mile. Proceed westerly and northwesterly on paved road which turns to gravel at 1.0 mile, continue to intersection 1218 at Pell Road at 1.5 miles. Proceed northerly on gravel-surfaced Pell Road to end of graded road at foot of steep rise to the north at 1.8 miles.

The line west of the road is a terrace wall 50 feet south of a cellar hole 100 feet west of the road. A good hiking trail marked with blue paint signs leaves the road directly opposite the parking area at the end of the road, about 75 feet south of the line wall. Proceed westerly following hiking trail which parallels the line, crossing brook at 165 feet, coming to point opposite southeast corner of cleared land north of the line at 810 feet, crossing wall to the south at 910, to definite summit at 1315 feet. Proceed northerly off trail 50 feet across narrow strip of woodland to Bound.

Bound is located at the easterly brow of the line summit on the southerly slope of the rounded top of a hill. Large open acreage rises to north. To the south there is second growth woodland which descends to the south.

Bound is marked by a regulation 12" x 12" granite monument 9 feet long, the lower 4'-6" set in sandstone ledge, and the lower 2 feet imbedded in concrete. The top 4'-6" is dressed granite with Mass. inscribed on the north face, Conn. on the south face, 1967 on the east face, and a ¼" drill hole in the top. The monument was set October 9, 1968, and replaces the 1803 sandstone monument set July 1, 1907, which was broken off.

1906 Station 341785

Bound #142 - 4420 feet east

Bound #144 - 5601 feet west



PHOTOGRAPHED NORTHERLY



PHOTOGRAPHED NORTHERLY

LINE BOUND #144

REGULATION GRANITE MONUMENT

WOOD ROAD

From the bridge over Valley Brook on Route 20 at the north end of Barkhamsted Reservoir, proceed easterly on Route 20 to intersecting wood road at 0.15 mile. Crossing gate at beginning of wood road, proceed northerly on wood road to gate and Bound at 0.45 mile. Road leaves highway west of a pine plantation and passes a summit 400 feet south of the line. The low point in the road is opposite the Bound, and 75 feet to the north behind the gate the road curves sharply to the east.

Bound is located 16 feet west of the center of the traveled way at the westerly gate post of a gate maintained by the Metropolitan District Commission. There is fairly level woodland either side of the road which rises slightly to the north and east. There is a culvert under the road 36 feet north of the line.

Bound is marked by a regulation granite monument showing 3.8 feet above ground. It is lettered "1906" on the west, "G Mass." on the north and "H Conn." on the south face. It is 9.6 feet long, set in excavation made in wet gravel. Monument was set July 2, 1907.

1906 Station 347386
Bound #143 - 5601 feet east
Bound #145 - 2433 feet west

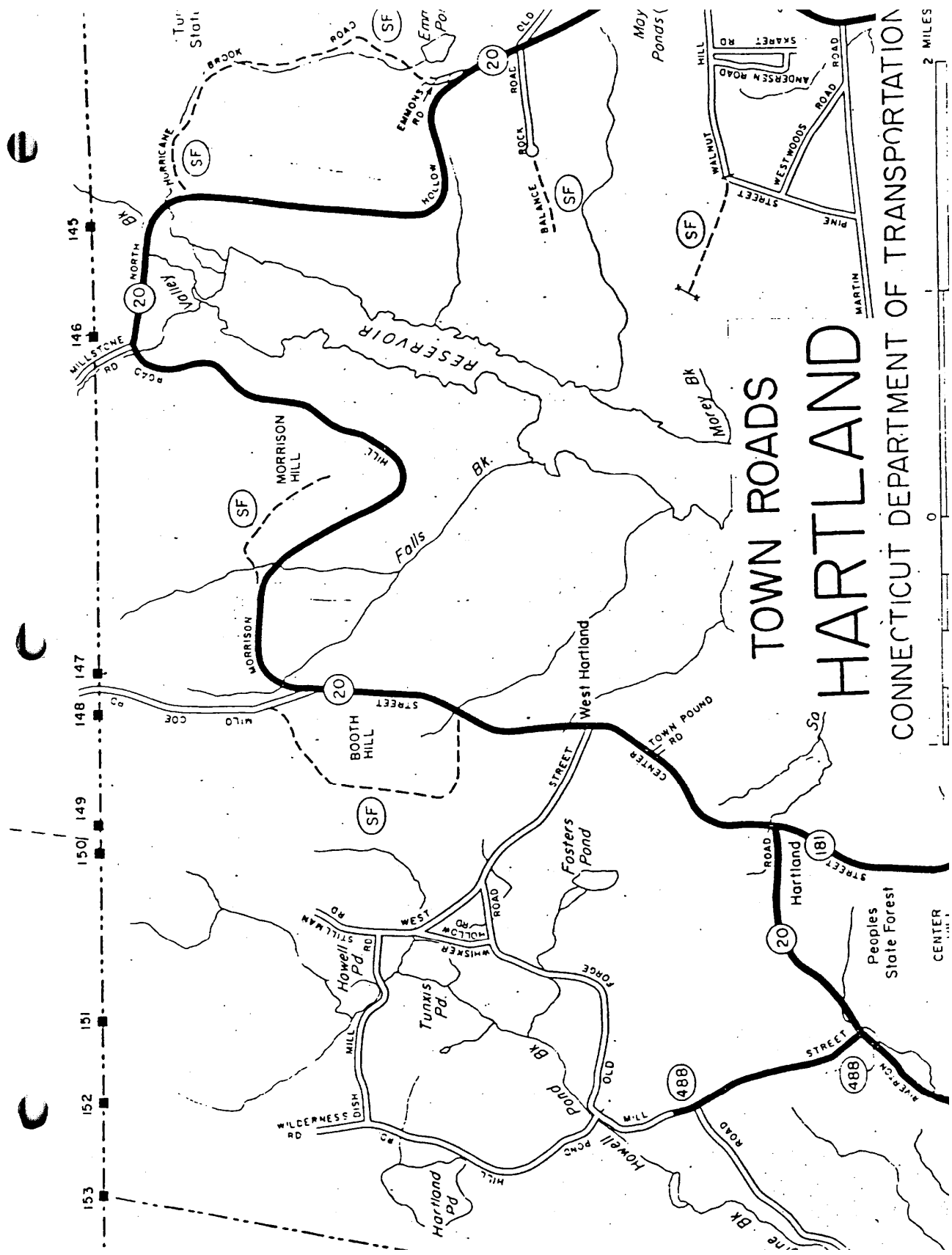



PHOTOGRAPHED SOUTHWESTERLY



PHOTOGRAPHED WESTERLY

LINE BOUND #145

REGULATION GRANITE MONUMENT

WOOD ROAD

From the intersection of Route 20 with a paved highway to the north in North Hollow, proceed northerly on paved highway for 75 feet and turn easterly on gravel road parallel to, above and just north of, Route 20. Proceed easterly about 250 feet to a gate across the road where it enters woodland at the foot of a steep rise. Proceed northeasterly 1,265 feet on wood road up steep hill in woodland to 50 feet south of fork in road at the top of the steep rise and Bound.

Bound is located 35 feet west of, and 6 feet above, the center of the wood road. It is 3 feet east of the center of the remains of the west and road wall. Woodland rises steeply to the northwest behind the Bound and falls away steeply to the southeast across the road. At the time of the 1997 Perambulation, there were chips on the north, south and east face of the Bound.

Bound is marked by a regulation granite monument showing 3.8 feet above ground. It is lettered "1906" on the west, "G Mass." on the north and "H Conn." on the south face. It is 9.5 feet long, set in excavation made in sandy loam and gravel. Monument was set July 2, 1907.

1906 Station 349819
Bound #144 - 2433 feet east
Bound #146 - 1740 feet west

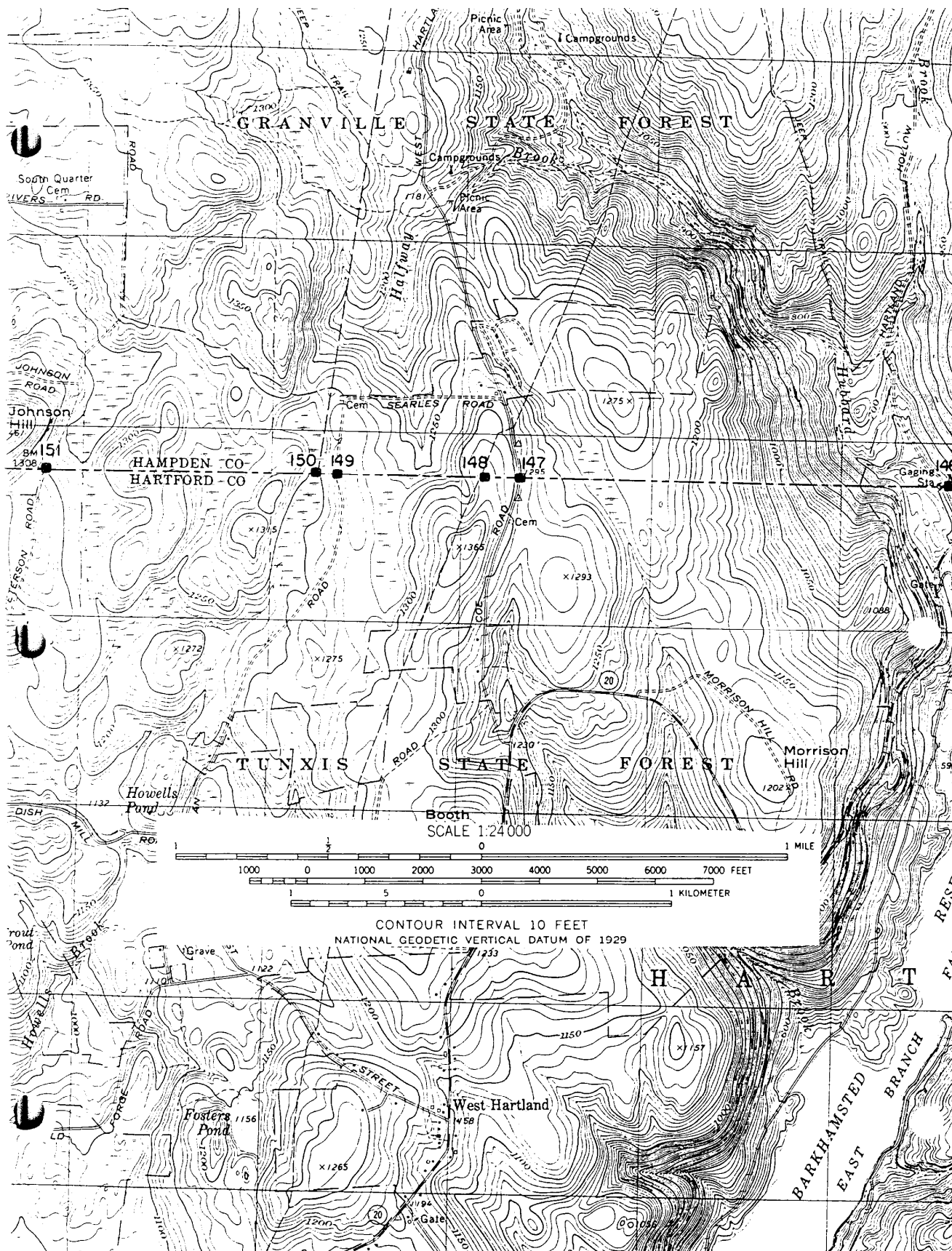

1997

CONNECTICUT-MASSACHUSETTS STATE BOUNDARY LINE PERAMBULATION
CONNECTICUT DEPARTMENT OF TRANSPORTATION



PHOTOGRAPHED SOUTHWESTERLY



PHOTOGRAPHED EASTERLY

ANGLE BOUND#146

REGULATION GRANITE MONUMENT

PAVED HIGHWAY

From the intersection of Route 20 with a paved highway to the north in North Hollow, proceed northerly on paved highway to Bound at 0.2 mile at end of pavement in Connecticut.

Bound is located 46 feet east of the center of the traveled way, measured on the slope, at the top of a steep cut bank, about 20 feet above the highway and 10 feet south of a large white oak tree. East of the Bound, woodland rises to the northeast. West of the highway, woodland drops off to a brook and a concrete gauging weir of the Metropolitan District and rises gradually beyond the brook. Southeast corner of Bound is chipped. A C.H.D. monument is located one foot east of Bound.

Bound is marked by a regulation granite monument showing 4.1 feet above ground. It is lettered "1906" on the west, "G Mass." on the north and "H Conn." on the south face. It is 9.4 feet long, set in excavation made in gravel. Monument was set July 2, 1907.

1906 Station 351559
Bound #145 - 1740 feet east
Bound #147 - 7400 feet west

BOUND 147



PHOTOGRAPHED SOUTHEASTERLY



PHOTOGRAPHED NORTHEASTERLY

LINE BOUND #147

REGULATION GRANITE MONUMENT

PAVED HIGHWAY

From the intersection of highways in the center of the village of West Hartland on Route 20, proceed northerly on Route 20 to intersection at 1.3 miles. Turn westerly onto Milo Coe Road and continue northerly on paved highway to Bound at 2.2 miles. Highway, after running straight and descending northerly, curves to the west 200 feet south of the Bound, runs straight past the Bound, curving west again 100 feet further north.

Bound is located 15 feet east of the center of the traveled way and 145 feet north of a culvert under the highway. Woodland slopes down east of the Bound and rises west of the highway. CL&P pole #6750 is 3 feet east of Bound. All top corners and edges of Bound are chipped. At the time of the 1997 Perambulation, the Bound was found tipped one inch east.

Bound is marked by a regulation granite monument showing 3.2 feet above ground. It is lettered "1906" on the west, "G Mass." on the north and "H Conn." on the south face. It is 10.0 feet long, set in excavation made in sand. Monument was set July 12, 1907.

1906 Station 358959
Bound #146 - 7400 feet east
Bound #148 - 596 feet west



PHOTOGRAPHED NORTHEASTERLY



PHOTOGRAPHED SOUTHWESTERLY

LINE BOUND #148

SMALL SANDSTONE MONUMENT

INTERIOR LINE SUMMIT

From the State Line on Milo Coe Road leading north from Route 20 to West Granville at Bound #147, proceed westerly on line following a well blazed survey line and line cutting along the south side of the Granville Forest 600 feet to Bound.

Bound is located at the flat line summit of the northerly spur of a wooded hill. It is 25 feet, S 25 degrees W from a 12-inch beech tree with a twisted trunk and 25 feet N 25 degrees E from a 12-inch hemlock. The clearing for a natural gas pipe line laid in 1952, running north and south, lies 75 feet west of the Bound. Woodland is level to the south, dropping away gently in other directions. Bound has a large chip on northwest top corner and edge.

Bound is marked by a dressed sandstone monument showing 1.1 feet above ground. It is 7 inches by 12 inches in section with the east and west edges of the top cut off, 3 inches back by 4 inches down, with a ½ inch drill hole 1 inch deep, 2 inches east of center of top, and is lettered "M State Line 1803" on the north and "C State Line 1803" on the south face. It is 4.9 feet long, set in excavation made in gravelly loam and ledge. Monument was set July 13, 1907.

1906 Station 359555
Bound #147 - 596 feet east
Bound #149 - 2512 feet west



PHOTOGRAPHED NORTHEASTERLY



PHOTOGRAPHED NORTHEASTERLY

LINE BOUND #149

REGULATION GRANITE MONUMENT

ABANDONED ROAD

From the Village of West Hartland at the intersection of Route 20 and West Street, proceed northwesterly on West Street to intersection 1148 (Dish Mill and Stillman Road) east of Howells Pond at 1.4 miles. Continue northerly on paved highway (Stillman Road) changing to Wood Road at 1.8 miles to a closed gate at 1.9 miles. Proceed northerly on Wood Road for 4500 feet to Bound. Road passes a flat summit 70 feet south of line, descends slightly northerly and flattens out opposite Bound.

Bound is located 27 feet east of the center of the road and 7 feet west of the east road wall. Woodland rises gradually to the east and descends more abruptly west of the road to a laurel swamp. Bound has a small chip on top southeast corner.

Bound is marked by a regulation granite monument showing 3.8 feet above ground. It is lettered "1906" on the west, "G Mass." on the north and "H Conn." on the south face. It is 9.8 feet long, set in excavation made in sandy loam and hardpan. Monument was set July 12, 1907

1906 Station 362067
Bound #148 - 2512 feet east
Bound #150 - 380 feet west



PHOTOGRAPHED WESTERLY



PHOTOGRAPHED WESTERLY

LINE BOUND #150

GRANVILLE-TOLLAND TOWN CORNER

REGULATION GRANITE MONUMENT

INTERIOR TOWN CORNER

From the State Line on the abandoned road (Stillman Road) running north from intersection 1148 east of Howells Pond, at Bound #149, proceed westerly on line 380 feet down hill through laurel tangle to Bound in swamp.

Bound is located about 140 feet west of the east edge of a wooded and ferned swamp. Bound has a large chip on top northeast corner.

Bound is marked by a regulation granite monument showing 3.7 feet above ground. It is lettered "G 1906" on the east, "T" on the west, "MASS" on the north and "H CONN" on the south face. It is 9.7 feet long, set in excavation made 9 feet in bog and peat, the lower 4 feet filled with rock for a base and the monument set in concrete. Monument was set July 19, 1907

The dates "1920 and 1943" have been rough cut on the west face.

1906 Station 362447
Bound #149 - 380 feet east
Bound #151 - 4700 feet west

BOUND 151