



**Northeast
Utilities System**

ORIGINAL

107 Selden Street, Berlin, CT 06037
Northeast Utilities Service Company
P.O. Box 270
Hartford, CT 06141-0270
(860) 665-2036

Kris Aberg
Project Manager
Tel: (860) 665-6733

March 22, 2010

Daniel F. Caruso, Chairman
Connecticut Siting Council
Ten Franklin Square
New Britain, CT 06051

RECEIVED
MAR 23 2010

CONNECTICUT
SITING COUNCIL

Re: Docket No. 398
Sherwood Substation
6 New Creek Road
Westport, Connecticut

Dear Chairman Caruso:

The enclosed information was provided to the Town of Westport Conservation Commission in response to the Commission's letter to the Council (dated January 11, 2010) regarding the Connecticut Light and Power Company's application associated with Docket 398.

We respectfully request that you please include these enclosures as part of CL&P's application submission. Thank you in advance for your assistance.

Respectfully submitted,

NORTHEAST UTILITIES SERVICE COMPANY

by 
Kris Aberg, Project Manager



Vanasse Hangen Brustlin, Inc.

March 22, 2010

Ms. Alicia Mozian
Conservation Director
Town of Westport
110 Myrtle Avenue
Westport, CT 06880

**Re: Proposed Sherwood Substation
New Creek Road
Westport, Connecticut**

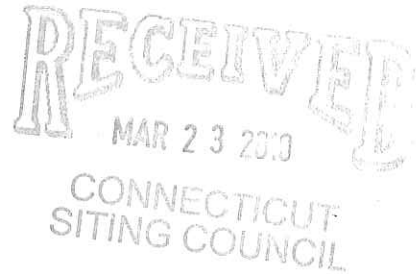

Dear Ms. Mozian:

On behalf of the Connecticut Light and Power Company (CL&P) and in response to your letter to the Connecticut Siting Council (dated January 11, 2010) regarding CL&P's revised site plans for the proposed Sherwood Substation, Vanasse Hangen Brustlin, Inc. (VHB) is providing you with a revised planting plan and a sediment and erosion control plan as requested.

Further, VHB coordinated with Jim Kousidis of the Westport Department of Public Works/Engineering regarding the revised driveway location and associated drainage. Mr. Kousidis indicated that he had reviewed the revised site plans (dated December 28, 2009) that were included in CL&P's Application to the Connecticut Siting Council and had no further comments.

Thank you again for your cooperation and support throughout the design and permitting process for this project. If you require any additional information, please do not hesitate to contact us.

Sincerely,

Michael Libertine, LEP
Director, Environmental Services, CT

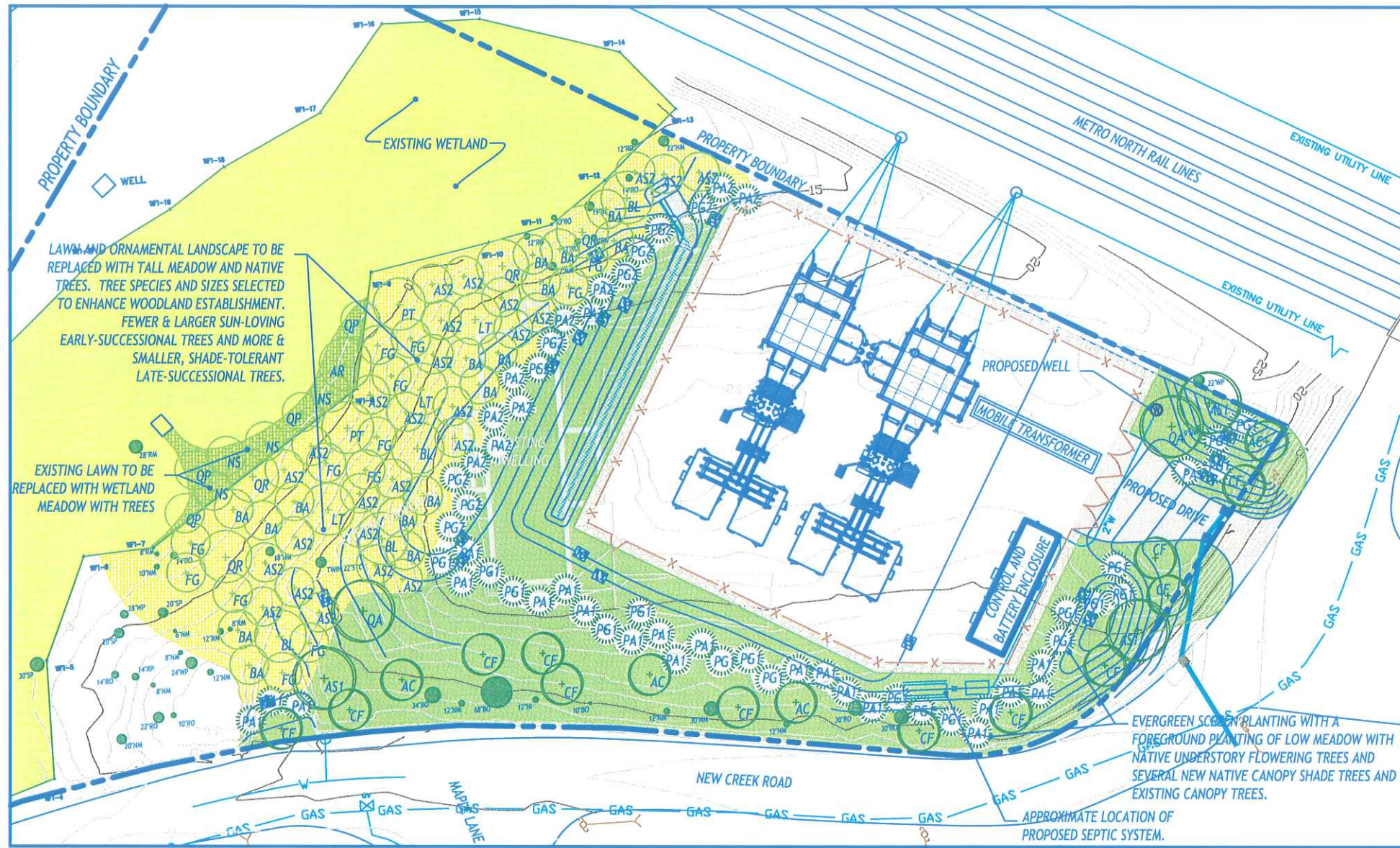

PLANT LIST

SYM.	QTY.	SCIENTIFIC NAME	COMMON NAME	SIZE	ROOT	GROWTH RATE	NATURE HEIGHT
TREES							
AC	4	AMELANCHIER CANADENSIS	MULTI-STEM SERVICEBERRY	8'-10' HT.	CONT.	MED.	35'-50'
AR	1	ACER RUBRUM	RED MAPLE	6'-8' HT.	B&B	MED.-FAST	75'-100'
AS1	3	ACER SACCHARUM	SUGAR MAPLE	2.5'-3' CAL.	B&B	SLOW	75'-100'
AS2	26	ACER SACCHARUM	SUGAR MAPLE	6'-8' HT.	CONT.	SLOW	75'-100'
BA	16	BETULA ALLEGHANIENSIS	YELLOW BIRCH	6'-8' HT.	CONT.	SLOW-MED.	50'-75'
BL	4	BETULA LENTA	BLACK BIRCH	6'-8' HT.	B&B	MED.	50'-75'
CF	12	CORNUS FLORIDA	FLOWERING DOGWOOD	8'-10' HT.	CONT.	MED.	35'-50'
FG	13	FAGUS GRANDIFOLIA	AMERICAN BEECH	6'-8' HT.	CONT.	SLOW	75'-100'
LT	3	LIRIODENDRON TULIPIFERA	TULIP TREE	6'-8' HT.	B&B	MED.-FAST	75'-100'
NS	4	NYSSA SYLVATICA	BLACK TUPELO	6'-8' HT.	CONT.	SLOW	50'-75'
PA1	19	PIKEA ABIES	NORWAY SPRUCE	12'-14' HT.	B&B	MED.-FAST	50'-75'
PA2	10	PIKEA ABIES	NORWAY SPRUCE	5'-6' HT.	B&B	MED.-FAST	50'-75'
PG1	19	PIKEA GLAUCA	WHITE SPRUCE	12'-14' HT.	B&B	SLOW-MED.	50'-75'
PG2	9	PIKEA GLAUCA	WHITE SPRUCE	5'-6' HT.	B&B	SLOW-MED.	50'-75'
PT	2	POPULUS TREMULOIDES	QUAKING ASPEN	6'-8' HT.	B&B	FAST	35'-50'
QA	3	QUERCUS ALBA	WHITE OAK	2.5'-3' CAL.	B&B	SLOW	75'-100'
QP	4	QUERCUS PALUSTRIS	PIN OAK	6'-8' HT.	CONT.	MED.-FAST	50'-75'
QR	4	QUERCUS RUBRA	RED OAK	6'-8' HT.	CONT.	MED.	50'-75'
TOTAL:	156						

SEED MIXES

WETLAND MEADOW: NEW ENGLAND WETMIX AS PRODUCED NEW ENGLAND WETLAND PLANTS, INC (WWW.NEWP.COM). APPLIED AT A RATE OF 1 LB/2,500 SQUARE FEET.

TALL MEADOW: NEW ENGLAND CONSERVATION/WILDLIFE MIX AS PRODUCED NEW ENGLAND WETLAND PLANTS, INC (WWW.NEWP.COM). APPLIED AT A RATE OF 1 LB/1,750 SQUARE FEET.

SHORT MEADOW: "NO MOW MIX" AS PRODUCED BY PRAIRIE NURSERY (WWW.PRAIRIENURSERY.COM OR 1-800-476-9453) "NO MOW" SEED MIX CONSISTS OF LOW MAINTENANCE, NO WATERING, NO FERTILIZING COOL SEASON GRASSES (PRIMARILY FESTUCA RUBRA AND FESTUCA OVINA).

GENERAL NOTES

1. PROPOSED PLANTING INFORMATION PROVIDED BY WILLIAM KENNY ASSOCIATES LLC., EXISTING AND OTHER PROPOSED INFORMATION TAKEN FROM A PLAN PREPARED BY VANASSE HANGEN BRUSTLIN, INC.
2. ALL TREE LOCATIONS SHOWN ARE APPROXIMATE.

LEGEND

	EXISTING 5' CONTOUR		PROPOSED SHORT MEADOW
	EXISTING 1' CONTOUR		PROPOSED TALL MEADOW
	EXISTING SPOT GRADE		PROPOSED WETLAND MEADOW
	PROPOSED CONTOUR		PROPOSED NATIVE FLOWERING TREE
	PROPOSED SPOT GRADE		PROPOSED NATIVE CANOPY TREE
	PROPERTY BOUNDARY		PROPOSED EVERGREEN TREE
	EXISTING WETLAND		PROPOSED NATIVE EARLY SUCCESSIONAL CANOPY TREE
	EXISTING TREE TO REMAIN TO THE EXTENT POSSIBLE		PROPOSED NATIVE LATE SUCCESSIONAL CANOPY TREE
	PROPOSED FREE STANDING STONEWALL		
	PROPOSED RETAINING WALL		
	SUBSURFACE OR OVERHEAD UTILITY LINE OR STRUCTURE		

WILLIAM KENNY ASSOCIATES LLC

SOIL SCIENCE
ECOLOGICAL SERVICES
LAND USE PLANNING
LANDSCAPE ARCHITECTURE

217 WEBB ROAD
FAIRFIELD, CT 06825
PHONE: 203 366 0588
FAX: 203 366 0067
wkassociates.net

CONCEPT PLANTING PLAN

OWNER:

NORTHEAST UTILITIES SERVICE CO. for
CONNECTICUT LIGHT AND POWER COMPANY

LOCATION:

SHERWOOD SUBSTATION
WESTPORT, CONNECTICUT

DATE: JUNE 8, 2009

SEPTEMBER 21, 2009 (REV. 1)
DECEMBER 28, 2009



WKA REF. NO. 1542