

BALTIMORE, MD.

Seed mimeo. sent '44

owner: George H. Lewis
Address: J.S. Young & Co.,
2701 Boston St.

1/14/29 - 2 pls.
#65806 - C. moll.

1/14/29 - 2 pls.
#70317 - C. seguinii

Baltimore, Md.

John Willem
3505 Rosekemp Ave.

10/31/41 - Willis J. Howe, City Forester
sent 2 photos of a chestnut
tree growing on his (Willem's)
property.

BALTIMORE, MD.

W. A. Jones
107 N. East Ave.

1935. 10 Asiatic chestnut trees [TENN. VALLEY AUTHORITY]

BALTIMORE, MD.

Seed mimco. sent '44

Dr. D. S. Johnson
Johns Hopkins Univ.

1/31/08 - 1 #17876 *Castanea sativa*

Baltimore 18, Maryland.

Goucher College

Malcolm Forbes, Supt. Bldgs + Grounds

Nr. Otho F. Kraushaar, Pres.

3/30/50 - 4 FP-378 *Quercus acutissima*
6 FP-1329 *C. mollissima*

Baltimore 7, Md.

Herbert A. Kunst

3718 Milford Ave.

Jan'y 1952 - Has a chestnut tree in his yard, that, with 3 others, were grown from nuts in pots by his father; about 4 years ago a "soft spot" developed in three trees & all died. The 4th tree has had "hard luck" & has been transplanted & now seems to be thriving doesn't know the species; G76 asked for leaves & twigs for identification. No reply to 7.1/52

39721 Baltimore Co.

Mollissima

Seed mimeo. sent '44 /

3 pls. 3-27-17 Henry F. Eckels, 1704 Gough St. Balto. Md.

Independent city

X

| S.P.I.No. | Scientific Name | Common Name |
|-----------|---------------------|-------------|
| 39721 | Castanea mollissima | Chestnut |

A prompt reply to the following questions regarding the tree above named will be thankfully received:

Number of trees alive... 1 Height of trees... 3-27-17 10 ft

Have trees fruited?..... Size and quality of nuts... no

Approximate location of trees on your place... Sid lawn

Kindly use inclosed envelope.

Knowles Ryerson,
Horticulturist in Charge.

Date... 5-11-28

Sign here... *Henry F. Eckels*

..... Henry F. Eckels
Experimenter

Baltimore, Md.
Address *Hamilton*

41358 Baltimore Co pumila x crenata

12

1 pl. 12-27-18 Eckels, H. F. 1703 Gough St. Balto. Md.

Baltimore, Md.

George J. Eder

3236 Abell Ave (33rd + Abell)

1951 - Has received chestnut trees from
Mr. Herbert C. Fooks.

Baltimore, Md.

W-1951

Herbert C. Fooks,

2006 Mt. Royal Terrace.

12/9/44 Advises having several acres set with
Chinese chestnuts in 1943 and 1944. Apparently
on poor site, dry, with clay soil, as leaves
last summer during dry spell turned brown.
Literature and advice on care sent to him
by RBC 12/16/44.

Bel Air, Md.

Adna R. Bond, Dis. Forester

3/7/47 - 45 #58602 *Castanea mollissima*.
10 7P.1170 " "

Bel air, Md.

W-1951

Dr. Herbert Hoopes
Waverly Stock Farm.

8/6/48 - about 20 trees growing satisfactorily + most of them bearing but only three seem to produce a full crop each year. Use DDT spray for jap. beetles which seems also to be effective against weevils. Heaviest crop raised in 1946 - 1 1/2 bu. The largest tree now 20 ft tall, 40 ft spread + about 1 ft in diameter. One tree a bit taller but less spread. Both pounders.

3/14

1933 Shipment

Bel air, Md.

Dr. H. Hoopes,
Waverly Stock Farm

Castanea mollissima

Quan. No.

20 MI.

~~4/3~~

~~4/31 - 12 MI + 3 MI~~

Remarks:

7/6/33 - Chart in file includes 1931 shpt also.

Apparently received 26 trees in 1933

9/27/36 - advised Fr. + Veg. (C. Reed) + sent in nut from the MI trees. Only 1 developed. Nut spoiled, for some reason.

Bel air, Md.

Dr. Herbert Hoopes,
Waverly Stock Farm.

3/20/35 = 10 FP-530 Castanea mollissima

2/26/35 - "Lost 3 or 4 of the other trees"

March, 1936. 29 left of the 30 trees. One killed by mice. Several look sick but most are OK.

Seed mimeo. sent '44
BEL AIR, MD.

Dr. Herbert Hoopes
Waverly Stock Farm

Leevil Memo Sent 1948
mol

(2 for Wilmer P. Hoopes)

12 MX Castanea mollissima (1936)

2/11/39 - Trees originally planted on a stony knoll where they could not be cultivated & "they did no good there," several died; trees then removed & scattered around. Those being cultivated making some headway, the others not very promising. FMI (1933) but tree

On U.S. Hwy. 1 (Conowingo Rd.) 5 mi N. of Bel Air, west side, new cinder block cow barn, metal roof, metal silo.
(over)

July 1946 - 25 trees living, 25# nuts in 1944 on one tree; expect 2 bu. (this year, for which one nurseryman has offered 40¢ per lb.

10/13/46 - This letter gives details of yields, etc.

10/14/46 - Sent 5# nuts to Mr. Reed from 2 of the most prolific ^{trees} & best size nuts. nuts a bit too small

Bell, Maryland
George M. Darrow

1942-1 PI-95632 C. mol. graft (1938)
1 " 104002 C. " " "
1 " 104006 C. " " "
1 " 104007 C. " " "
1 " 104008 C. " " "
1 " 104009 C. " " "
1 #4937 C. " cross (F₁) (1937)
1 5037 C. " " " "

2/19/45 He advised M. Grawatt that all these died back
and only stocks are living.

Bell, Md.

Nelson Leitch (No longer at Bell - RBC 1948)
(P. J. G., Bell).

4/5/46 6 - FP. 1146 (Dr. A. H. Graves hybrids, O. P.)

Prince Georges Co.

58602

Castanea mollissima

Chestnut ✓

Chinquapin X

S.P.I.No.

Scientific Name

Common Name

A prompt reply to the following questions regarding the above-named tree will be thankfully received:

Number of trees sent.....150.....Date sent...4-23-26.....

Number of trees alive...143...Height of trees...24" to 36".....

Have trees fruited? No...Size and quality of nuts.....

Approximate location of trees on your place...S.E. corner of Station grounds.....

Kindly use inclosed envelope.

There were 7600 trees grown at Bell, all have been distributed with the exception of 143 plants in per. planting

Knowles Ryerson,
Horticulturist in Charge.

E. Guerber

Date 5-21-28

Sign Here

Plt. Introduction Garden

Bell, Maryland

Town: Bell Station

Owner:

Address:

Caretaker:

Address:

CASTANEA *mollissima*

FPI No. 58602 or Origin:

FPI No. 48849
Number of trees: 143

If several trees, make separate cards for each, using this outline.

Age: Ht.: DBH: Nuts: Quan.: Size: Qual.:

C. B. present: Location: Age of cankers:

Description:

Other pathological symptoms: *1938: 6 trees of this no. now growing at P.D.G., Bell.*

Average twig growth preceding year: this year:
Site and growing conditions poor fair good

REMARKS

Planted 2/1/24, released from detention 4/1/25, and 7600 transplants planted to field. All distributed, with exception of trees in orchard and a few others, during 1925-26 season. Flowers pollinated with S-8 6/--/29.

Noted by: Date Letter (Gunning) 5/18/29
(On reverse side sketch location of trees and number each 1,2,3 etc.)

Princes George & Co
Town: Bell State: Maryland Name: Plant Introduction Garden

Castanea mollissima

Hold 150 plants SPI No. 58602 *Castanea mollissima* ✓

| | | | | |
|-------|---|-------------|---------------------|----------|
| 55984 | - | 80 pls. | <i>Castanea</i> sp. | 4/4/23 |
| do | - | 24 pls. | do | 2/6/23 |
| do | - | 47 pls. | do | 2/6/23 |
| do | - | 2 lbs. seed | " <i>mollissima</i> | 12/22/22 |
| do | - | 57 pls. | " " | 4/27/23 |

GLENDALE, MD.

Gerald Seaton
(employed at P.I. Station)

4/23/36 4 MR Castanea mollissima

3/28/41 - 5 FP-790 mixed varieties

SHIP: Pick-up

FROM: Glenn Dale, Maryland

ORDER DATE: ~~July~~ April 25, 1956

FOR: Gerald Seaton
Glenn Dale, Maryland

DIVISION OF
PLANT EXPLORATION AND INTRODUCTION
BUREAU OF PLANT INDUSTRY,
SOILS AND AGRICULTURAL ENGINEERING
BELTSVILLE, MARYLAND

EXPRESS ADDRESS:

10 Chinese chestnut seedlings, P.I. 70314

WT. OF SHIPMENT _____ LBS.

NOTE: REPORT TO BELTSVILLE IF MATERIAL DOES NOT ARRIVE IN GOOD CONDITION.

Seed mimeo. sent '44

Chisholm, A. J.

Glenn Dale, Md.

small

castanea

April 15, 1933. 3 T 30 and 3 FP. 203. Mr. Chisholm is a store owner in Glenn Dale and well known to the FPI personnel at Bell.

Bell, Md., Plant Garden

Prince Georges Co

Castanopsis argentea

Supt.

8 plts. 61238 - 2-17-26

1928 report "4 trees alive, 18" high".

Prince Georges Co

61238

Castanopsis argentea

Chestnut

Chinquapin

S.P.I.No.

Scientific Name

Common Name

A prompt reply to the following questions regarding the above-named tree will be thankfully received:

Number of trees sent.....⁸.....Date sent.....2-17-26.....

Number of trees alive.....⁴.....Height of trees.....^{18"}.....

Have trees fruited?.....^{No}.....Size and quality of nuts.....

Approximate location of trees on your place.....

4 plants in Greenhouse No 1, plants 18" in 5" pots

Kindly use inclosed envelope.

Knowles Ryerson,
Horticulturist in Charge.

Date. 5-21-28.....

Sign Here.....*E. Goucher*.....

Pl. Intr. Garden

Bell, Maryland.

Beltsville, Md.

Dr. Myron Anderson, Soil + Fertilizer
Investigations, Room 321 Soils Bldg. Br. 155.

6/5/44 3 T 4 Chinese Chestnut seedlings,
potted, from greenhouse.

Beltsville, Md.

Dr. M. S. Anderson, Soil & Fertilizer Invest.
Room 321, Soils Bldg. (1433 Manchester Lane, N.W.)

4/7/37 ~~2~~ 5 F.P. 388 C. crenata

8 MAC C. mollis.

(See JDD for reports).

Beltsville, Maryland.

Harry M. Allcock
Plant Industry Station

11/27/46 - 10 Quercus dentata.

Beltsville, Md.

Herbert E. Bennett, gardener, Range 2
Greenhouses, Plant Industry Station.

4/15/38 3 FP. 538 *C. mollissima*.

Beltsville, Md.

Thomas O Cannon
Plant Industry Station
Beltsville, Md.

From Savannah 2/20-28/46

72 FP-1170 *Castanea mollissima* (58602)

62 FP-1194 Chestnut hybrids (Dunham)

5/9/50

Beltsville, Md.

H. E. Clark, Emer. Pl. Dis. Prevention
115 North Bldg, Pl. Ind. Sta.

3/23/45 - 3 FP-1123 *C. mol.* (85723)

Beltsville, Md.

Hugh E. Clark, Div. Cotton and Other Fiber
Crops + Diseases. Br. 203, Room 317 Adms. Bldg.

3/27/44 2 FP-1056 *C. mollissima*

(To be grown on his place near Richmond, Va.)

Beltsville, Md.
Dr H. L. Crane
Hort. Field Sta.

2/16/37 - 5 # 26028 R. 33 T. 3 C. mal. grafted
5 26029 " 33 " 34 " " "
5 26030 " 34 " 36 " " "
5 26031 " 34 " 39 " " "

3/15/42 8 scions # 66037 from D-33-30
8 " " " " D-33-34
8 " " " " D-34-36

1/17/44 - 15 scions # 66037 C. mal. DR 33 T 30 from
Chico, Calif.

BELTSVILLE, MD.
Fruit & Veg. Crops & Diseases
U. S. D. A.

4/22/36
see attached

Delivered to Fr. Crane's truck 4/22/36 and 4/27/36

SHIP

DIVISION OF Forest P.
PLANT EXPLORATION AND INTRODUCTION
BUREAU OF PLANT INDUSTRY
U. S. DEPARTMENT OF AGRICULTURE
WASHINGTON, D. C.

FROM: Bell, Md.
ORDER DATE: April 29, 1936

FOR: Fruit & Vegetable Crops & Disease
U.S.D.A.

EXPRESS ADDRESS:

- ✓ 10 FP373 Castanea orenate from Korea
- ✓ 100 FP386 " mollissima hybrids from Bell orchard (graft stock)
- ✓ 100 FP388 " orenate from Bell Orchard (grafting stock)
- ✓ 100 FP462 " mollissima from Tientsin China (grafting stock)
- ✓ 50 FP495 " mollissima from Bell orchard (grafting stock)
- ✓ 100 GS " orenata from Iwate-ken, Japan
- ✓ 15 ME " mollissima from Korea
- ✓ 10 MI " " Kobe, Japan
- ✓ 40 ML " " Nanking, China
- ✓ 40 MM " " Peiping, China
- ✓ 35 MN " " "
- ✓ 10 MP " " Shanghai
- ✓ 20 NQ " " " "
- ✓ 20 NR " " Peiping
- ✓ 30 NT " " " "
- ✓ 25 MAC " " " "
- ✓ 25 MAD " " " "
- ✓ 25 MAR " " " "
- ✓ 25 MAS " " " "
- ✓ 50 MAU " " Chekiang Province
- ✓ 10 MKE " " China
- ✓ 8 MKF " " " "
- ✓ 20 MKL " " " "
- ✓ 26 NKM " " " "
- 25 016 VanFleet C. mollissima hybrid

NOTE: REPORT TO WASHINGTON IF MATERIAL DOES NOT ARRIVE IN GOOD CONDITION.

Rediform (TRADE MARK) INTERLEAVED, PATENTED, OTHER PATS. PEND. - MFD. AM. SALES BOOK CO., LTD., NIAGARA FALLS, N.Y.

Bellville Md.

H. L. Crane, Nut Investigations

3/16/43 36 scims each of the best 5 trees
P.O. 66037 at Chico, Calif.

33-12, 33-30, 34-13, 34-24, 34-36

SHIP:

FROM: Chico, California

DIVISION OF
PLANT EXPLORATION AND INTRODUCTION
BUREAU OF PLANT INDUSTRY
U. S. DEPARTMENT OF AGRICULTURE
WASHINGTON, D. C.

ORDER DATE: March 13, 1943

FOR: Dr. H. L. Crane
Bureau of Plant Industry Station
U. S. Dept. of Agriculture
Beltsville, Maryland

EXPRESS ADDRESS:



Approx. 36 scions each:

PI-66037 Castanea mollissima, D 33-12, 34-13, 33-30,
34-24, 34-36

*Enter
Card*

WT. OF SHIPMENT 26 1/2 LBS.

NOTE: REPORT TO WASHINGTON IF MATERIAL DOES NOT ARRIVE IN GOOD CONDITION.

22 1943

Chico, California
March 16, 1943

Dr. H. L. Crane
Bureau of Plant Industry Station
U. S. Department of Agriculture
Beltsville, Maryland

Dear Dr. Crane:

We just received permission from the State of California and the Federal Plant Quarantine authorities to forward a shipment of chestnut scion wood to you as per the enclosed plant order copy. This shipment was forwarded today by express on Gov't B/I A-2098130, the original of which is enclosed.

This shipment was forwarded directly to you as some of the buds are quite advanced and, if not used immediately, should be placed in cold storage. We collected these scions at our earliest opportunity but we had quite a warm spell during February which started the buds swelling on most all trees.

I sincerely hope that you will find sufficient material for propagation. If not, kindly advise us and we will make a note to forward additional material at the proper time next year.

Very truly yours,

Karl Gregoire
Acting in Charge

Enclosures - 2

SHIP:

FROM: Chico, Cal.

DIVISION OF
PLANT EXPLORATION AND INTRODUCTION
BUREAU OF PLANT INDUSTRY
U. S. DEPARTMENT OF AGRICULTURE
WASHINGTON, D. C.

ORDER DATE: Jan. 17, 1944

FOR:

EXPRESS ADDRESS:

Dr. H. L. Crane
Bureau of Plant Industry Station
Beltsville, Md.

15 scions 6637 *Castanea mollissima* DR33T30
(cut as late as possible)

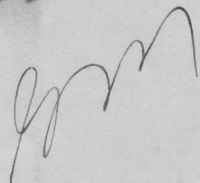

WT. OF SHIPMENT _____ LBS.

NOTE: REPORT TO WASHINGTON IF MATERIAL DOES NOT ARRIVE IN GOOD CONDITION.

Beltsville, Md.

J.D. Diller, for planting on the
Hritmiller tract, P1 Station

3/11/47 - 2 FP-1194 Kalamazoo hybrids
5 C. Henryi
? Quercus acutissima & other
hardwood species grown at
Arlington, Va.

Beltsville, Md.

Dr. J. D. Diller
North Bldg.
Plant Ind. Sta.

From Savannah nursery

3/20/45 200 FP-905 Castanea mollissima (66037)
100 FP-1205 " " (7270 Albany)
(Used as replants in fertilizer plots)

Beltsville, Md

Mrs. Priscilla Follett
Agr. Engin. Lab.
Agr. Research Center

(for cooperators in Illinois)

3/24/50 - 25 seeds of #58602 C. mollissima

Beltsville, Md.

G. F. Gravatt

Div. Forest Path.

Bureau Plant Industry Station

Beltsville, Md.

From Chico 3/4/46

PJ-66037 C. mollissima D-33-3

PJ-66037 C. mollissima D34-39

Beltsville Md.

G. F. Gravatt
Forest Pathology

4/2/48

6 scions P 76 (58602) mollissima
3 scions O 63 (66037) mollissima
2 lots of scions, moll x Dentata F₁ hybrids
1 FP. II65 D/I060 Chico 66037-33-34 mollissima
1 " " /I040 " " " " "
1 FP. II65 B/I049 " " 33-12 "
1 FP. II66 B/I048 Eidson's MAT or MAV (mollissima)
3 P.I. I04007/I049 Peter Lin mollissima.
2 FP. 470/I049 Bennett upright tree. (mollissima)
4 FP. 470 A/I048 " spreading tree "

SHIP: Pick-up

FROM: Glenn Dale, Maryland

ORDER DATE: April 25, 1956

FOR: Albert L. Graves
Beltsville, Maryland

DIVISION OF
PLANT EXPLORATION AND INTRODUCTION
BUREAU OF PLANT INDUSTRY,
SOILS AND AGRICULTURAL ENGINEERING
BELTSVILLE, MARYLAND

EXPRESS ADDRESS:

6 Chinese chestnut seedlings, P.I. 70314.

WT. OF SHIPMENT _____ LBS.

NOTE: REPORT TO BELTSVILLE IF MATERIAL DOES NOT ARRIVE IN GOOD CONDITION.

Beltsville, Md.

Paul R. Henson
321 So. Bldg., P1 Station

3/29/50 - 2 # FP-1329 *C. mollissima*
2 FP-378 *L. acutissima*

Beltsville, Md.

Dr. Carl Hartley,
Dir. Forest Pathology, U.S.D.A.

Mar. 1932 1-58602 *C. mollissima*
(From P.I.G., Bell, Md.)

~~2/27/34~~

Beltsville, Md.

E. H. Killen,
Finance and Accounts
Room 236 Administration Bldg., Ex. 177
Beltsville, Md. Plant Industry Station

3/23/45-4 FP-1123 *Castanea mollissima* (P.I.-85723)

Beltsville, Md.

Wm. J. Latimer
Soil Survey
North Bldg., Pl. Ind. Sta.
Room 21, extension 67

3/23/45 6 FP-1101 Castanea mollissima (PI-58602)

Beltsville Md.
Dr. C. E. Leighty, Dry Land Agriculture,
North Bldg. B. P. I. Station.

5/6/44 12 FP. 1101 (58602) 1 yr. stock

Beltsville, Md.

Dr. C. E. Leighty
Dry Land Agriculture
Room 120, North Bldg.
Plant Industry Station
Extension 125 (Retired later in 1945)

3/23/45

3 FP-1123 Castanea mollissima (PI-85723)

Beltville, Md.

~~Arlington Farm, Va.~~

Gordon Marcey (at South Farm
Plant Ind. Station.)

4/7/38 - 2 FP-498 *C. mollissima*

4/7/39 - 3 FP-721 Mixed varieties

Beltville, Md.

J. E. McMurtrey, Tobacco Insect. Bldg. 4,
Zel. Ext. 118-119.

4/8/43: 3 FP-994 *C. mollissima*
3 FP-998 *C. crenata*.

Beltville, Md.

Dr. A. H. Moseman, Assnt. to Chief of
Bureau, P. I. Station.

4/20/48: 1 FP-1165D/FP-1040 graft (*Mollis*)
3 FP-1225D (66037 *moll*) seedlings.

Seed lined. sent '44
Town: Beltsville, Md. mal CASTANEA mal
Owner: E. W. Sheets FPI No. 70315 or Origin:
Address: Animal Husbandry Number of trees: 5 (1929)
Caretaker: Exp Farm If several trees, make separate
Address: 1831 Lamont St., N.W. cards for each, using this outline.

Age: Ht.: DBH: Nuts: Quan.: Size: Qual.:
C. B. present: Location: Age of cankers:
Description:

Other pathological symptoms:

Average twig growth preceding year: this year:
Site and growing conditions poor fair good

REMARKS

(1929) 6 #71028 C. mal.
" " 9-8

Noted by: Date
(On reverse side sketch location of trees and number each 1,2,3 etc.)

Soil Conservation Service
Beltsville, Maryland

1942-100 FP-1500 C. mollissima
100 FP-1501 C. "
100 FP-1503 C. "
1250 FP-1505 C. "
100 FP-1510 C. crenata x chinquapin
100 FP-1511 ~~C. crenata hybrid~~
C. mollissima

Mr. Brett - 1942: 172 FP-378 Quercus acutissima
15 FP-48 C. crenata scions
15 FP-45 C. " "

Mr. Steiner - 3/29/46: 50 FP-1138 Chinquapin hybrids

Beltsville, Md.

Edgar L. Evinger, Supt. of Station for Hillculture Research,
Soil Conservation Service, Tel. 9-1410 Br. 35

100 hybrids of 1931 and 1932 transferred from Bell Dec. 14,
1938. See list attached.

3/21/39 - 100 FP-719 C. mollissima

4/11/39 - 100 ± O.P. Chestnuts hybrids, 3-yr.
old, weak, + etiolated

4/17/40 - See attached lists

4/17/41 - " " lists.

December 13, 1938.

Mr. Edgar L. Evinger,
Hillculture Research Station,
Soil Conservation Service,
Beltsville, Maryland.

Dear Mr. Evinger:

There is enclosed a list of the hybrids which were dug and prepared for your station yesterday. I understand these will be collected by your station on December 14th.

Each of the trees has a celluloid label which gives the serial number of the tree and the parents which entered in the cross. It would be very much appreciated if your planter would furnish a chart of the planting indicating thereon the location of each tree by its serial number. I do not expect the labels to last more than a year or two and a chart will permanently indicate the location of each hybrid.

Another purpose in charting these hybrids is so that notes may be taken now and then in the future in an attempt to discern what effect change of site and soil may have on time of nut drop, appearance, size and quality of nuts.

According to my list there are 100 trees in the lot.

Very truly yours,

A. B. Clapper,
Prin. Sci. Aid.

CHESTNUT HYBRIDS TRANSFERRED TO HILLCULTURE RESEARCH
STATION, SOIL CONSERVATION SERVICE,
BELTSVILLE, MD. DEC. 14, 1938,
BY THE DIVISION OF FOREST
PATHOLOGY, B.P.I.

| <u>1931 hybrids</u> | | <u>1932 hybrids</u> | | |
|---------------------------|-------------------|---------------------|-------|--------|
| <u>0 16 X Cult'd.Jap.</u> | <u>S 8 X Jap.</u> | <u>S 8 X Jap.</u> | | |
| 15531 | 24831 | 75932 | 88132 | 93932 |
| 15731 | 24931 | 80732 | 88632 | 94032 |
| 15831 | 25031 | 81132 | 88932 | 94732 |
| 15931 | 26431 | 81432 | 89132 | 95132 |
| 16031 | 26631 | 81832 | 89532 | 95732 |
| 17931 | <u>0 16 X S 8</u> | 82132 | 89632 | 95932 |
| 18531 | 27031 | 82432 | 89732 | 96032 |
| 18731 | 27131 | 82532 | 90432 | 96732 |
| 18931 | 27231 | 82732 | 90732 | 97032 |
| 18931A | <u>S 8 X Jap.</u> | 82932 | 90832 | 97732 |
| <u>0 16 X S 8</u> | | | | |
| 19031 | 27331 | 83432 | 90932 | 98432 |
| 19731 | | 84732 | 91032 | 99232 |
| 19831 | | 84832 | 91532 | 99332 |
| 2 0131 | | 85232 | 91832 | 99732 |
| 20331 | | 85432 | 91932 | 100032 |
| 20431 | | 85832 | 92032 | 100832 |
| 20531 | | 86032 | 92232 | 100932 |
| 20631 | | 86232 | 92432 | |
| <u>0 16 X Jap.</u> | | 86332 | 92532 | |
| 23631 | | 86632 | 92732 | |
| <u>S 8 X Jap.</u> | | 86932 | 92932 | |
| 24031 | | 87132 | 93432 | |
| 24231 | | 87732 | 93532 | |
| 24331 | | 87832 | 93632 | |
| 24431 | | 88032 | 93732 | |
| 24631 | | | | |

*Entered in
listing file
RBC*

SHIP

To call for trees

FROM: BELL

DIVISION OF
PLANT EXPLORATION AND INTRODUCTION
BUREAU OF PLANT INDUSTRY
U. S. DEPARTMENT OF AGRICULTURE
WASHINGTON, D. C.

ORDER DATE: APRIL 30, 1940

FOR: SOIL CONSERVATION SERVICE
FOR BLANTING AT BELTSVILLE

EXPRESS ADDRESS:

- ✓ 40 FP-634 Castanea mollissima hybrids, 4-year-old stock
- ✓ 20 FP-636 " crenata, Bell cultivated, 4-yr.-old"
- ✓ 22 FP-630 " mollissima, 4-year-old-stock
- ✓ 18 FP-637 " crenata, forest type, open pollinated, 5-year-old stock
- ✓ 38 FP-794 " " forest type, open pollinated, 2-year-old stock

NOTE: REPORT TO WASHINGTON IF MATERIAL DOES NOT ARRIVE IN GOOD CONDITION.

WT. OF SHIPMENT _____ LBS.

FROM: BELL

DIVISION OF
PLANT EXPLORATION AND INTRODUCTION
BUREAU OF PLANT INDUSTRY
U. S. DEPARTMENT OF AGRICULTURE
WASHINGTON, D. C.

ORDER DATE: APRIL 13, 1940

FOR: SOIL CONSERVATION SERVICE
[For planting at Beltsville]

EXPRESS ADDRESS:

2-year stock:

- ✓ 10 FP-56 Castanea mollissima (Bell)
- ✓ 50 FP-799 Mixed hybrids, Arlington
[Intermediate game food type]
- ✓ 15 FP-48 Castanea crenata, cultivated type

3-year stock:

- ✓ 100 SE Castanea seguini
- ✓ 25 PI-120652 Oak
- ✓ 25 PI-120653 "
- ✓ 25 PI-120654 "
- ✓ 25 PI-120657 "

4-year stock:

- ✓ 10 FP-616 Castanea mollissima (Mutual)
- ✓ 20 FP-710 " " "
- ✓ 20 FP-638 " crenata, Bell Cultivated
- ✓ 20 MBG " mollissima from Tientsin
- ✓ 20 MBE " " " Chekiang
- ✓ 20 NBJ " " " Shantung

5-year stocks:

- ✓ 5 FP-56 Castanea mollissima
- ✓ 5 FP-665 " " (Chico)
- 5 FP-576 " " "
- ✓ 25 FP-634 " " hybrid

NOTE: REPORT TO WASHINGTON IF MATERIAL DOES NOT ARRIVE IN GOOD CONDITION.

WT. OF SHIPMENT _____ LBS.

SHIP called for 4/17/41

FROM: Bell, Md.

DIVISION OF
PLANT EXPLORATION AND INTRODUCTION
BUREAU OF PLANT INDUSTRY
U. S. DEPARTMENT OF AGRICULTURE
WASHINGTON, D. C.

ORDER DATE: 4/17/41

FOR: Mr. O. S. Britt
Soil Conservation Service
Beltsville, Maryland (College Park)

EXPRESS ADDRESS:

1 yr. stock:

- ✓ 50 FP 968 C. mollissima
- ✓ 50 FP 971 C. crenata cultivated (Hogs)
- ✓ 50 FP 941 C. mollissima
- ✓ 50 FP 954 C. crenata cultivatec (Hogs)
- ✓ 50 C-1 C. mollissima
- ✓ 300 S-8 Jap. chinquapin hybrid (game)
- ✓ 50 FP 964 C. mollissima
- ✓ 50 FP 947 C. mollissima
- ✓ 50 FP 1011 C. mollissima
- ✓ 50 FP 48 C. crenata cultivated (Hogs)
- ✓ 50 FP 927 Arlington mixed hybrids (game)
- ✓ 200 FP 949 C. mollissima
- ✓ 25 FP 378 Quercus acutissima

2 yr. stock:

- ✓ 300 FP 869 C. mollissima
- ✓ 50 FP 874 C. crenata cultivated
- 50 FP 906 C. mollissima

1325

no card made

NOTE: REPORT TO WASHINGTON IF MATERIAL DOES NOT ARRIVE IN GOOD CONDITION.

WT. OF SHIPMENT _____ LBS.

Washington, D.C.

Charles Swinick, Soil Conservation Service.

Dec. 16, 1938 Telephones that 700 lbs *C. mollis*, seed being purchased from Mutual Supply Co. San Francisco @ 25¢ per lb.

300 lbs to be freighted to Pa.

350 " " " " " " to Jamesville, D.

50 " " " " " " for California.

W. W. Wagener is preparing the shipment.

Soil Conservation Service, D.C.

5/7/37 - Called at Bell & received the following

✓ 5 FP-388 *C. crenata*

✓ 5 " - 432 *C. mol.* x S-8

✓ 5 " - 462 *C. mol.*

✓ 5 " - 496 mixed varieties

✓ 5 " - 530 *C. mol.*

✓ 5 " 531 *C. mol.*

✓ 5 ma e *C. mol.*

✓ 5 ma F "

✓ 5 ma U "

✓ 5 ma W "

15 S-8 *C. mol. hybrid*

over

15 GR } *c. crenata*
15 GP }
5 HE } *c. henryi.*
5 HJ }

Beltsville
College Park, Md.

C. S. Britt, asst. Soil Conservationist
Hill culture section, SCS, Beltsville

3/21/41 - 150 FP-873 *C. crenata*
150 FP-845 *C. mollissima*
150 FP-1011 Chico "
1200 FP-933 *C. mol. hybrids*
150 FP-929 *C. "* "

To be redistributed by SCS

SHIP:

FROM:

Crasonville, Md.

ORDER DATE:

DIVISION OF
PLANT EXPLORATION AND INTRODUCTION
BUREAU OF PLANT INDUSTRY,
SOILS AND AGRICULTURAL ENGINEERING
BELTSVILLE, MARYLAND

FOR:

EXPRESS ADDRESS:

W. W. Steiner, In charge
National Observational Nursery
Soil Conservation Nursery
Beltsville, Md.

1 can (approximately 35 lbs.) of Chinese chestnut seed,
(*Castanea mollissima*), P.I. #70314. Seed from
which original trees were grown came from Nanking,
China.

WT. OF SHIPMENT _____ LBS.

NOTE: REPORT TO BELTSVILLE IF MATERIAL DOES NOT ARRIVE IN GOOD CONDITION.

SHIP:

FROM:

North farm, P. I. Station

ORDER DATE:

February 10, 1953

FOR:

DIVISION OF
PLANT EXPLORATION AND INTRODUCTION
BUREAU OF PLANT INDUSTRY,
SOILS AND AGRICULTURAL ENGINEERING
BELTSVILLE, MARYLAND

EXPRESS ADDRESS:

W. W. Steiner, In charge
National Observational Nursery
Soil Conservation Service
Beltsville, Maryland

500 - Chinese chestnut (*Castanea mollissima*) seedlings,
F. P. 1498 - Seed from which original trees were
grown came from Chekiang Province, China
A mixture of a number of strains from southern
China introduced by Peter Liu.

WT. OF SHIPMENT _____ LBS.

NOTE: REPORT TO BELTSVILLE IF MATERIAL DOES NOT ARRIVE IN GOOD CONDITION.

Seed minco. sent '44

Beltsville, Md.

Walter A. Barnes, Gardener, Range 2
Greenhouse, Plant Industry Station.

4/28/37

1 MKB *C. mollissima*.

1 F.P. 462 "

Beltsville, Md.

Mr. Edmund Stephens
207 Administration Bldg.
Plant Industry Station

4/14/45 - 1 graft FP-56 *Castanea mollissima* (McCampbell)
1 " FP-1126A " " (*Austin's best mollis.*)

Beltsville Md.

Mr. Bernard Synovec
Forest Pathology

4/12/48

(For planting on his place at Hollywood, Md.)

10 FP.-II61 *Castanea mollissima* (66037)
5 FP.-II75 " *dentata* hybrids, open pollinated
5 FP.-II63 " *mollissima* (71027)
10 FP.-II97 " " (71029)

Beltsville, Md.

C. W. Whittaker

Soils, etc.

4/15/47 - 2 FP-1200 *C. mollissima*

Beltsville, Md.
C. R. Wright
Fr + Veg., PI Station

4/14/44 - 7 FP-1006H C. mol. x C. crenata. 0 seedlings

Beltsville, Md.
George Y. Young
Plant Industry Station

11/6/52 - 1 *Castanea mollissima*, 8938/FP-1200.

SHIP: Pick up

FROM: Plant Introduction Garden

DIVISION OF
PLANT EXPLORATION AND INTRODUCTION
BUREAU OF PLANT INDUSTRY
U. S. DEPARTMENT OF AGRICULTURE
WASHINGTON, D. C.

ORDER DATE: 4/1/55

FOR: Mr. George Y. Young
Montgomery Avenue
Beltsville, Maryland

EXPRESS ADDRESS:

4 - 2 year-old Chinese chestnut seedlings RP-1591

Berwyn, Md.

A. P. Winebrener, Dir. Fruits & Veg. Crops & Dis.,
Beltsville. He is a long time breeder and gifter
in the Dept. for Hughes et al; he grafted for
Dr. Hutchins this spring (1943), and bred,
bench grafted and top worked chestnut for Clapper.
April 1943 He was given following chestnuts:

6 F.P. 998
4 T4/FP.1003 grafts
4 F.P. 1003

Bethesda, Md.

~~BALTIMORE, MD.~~

Seed memo. sent '44

Dr. V. L. Ellicott ^{mail is} 1/29/29 - 6 #70314 C. moll.

Health Dept.

6818 Glenbrook Rd., Bethesda, Md.

8/31/35 - Nuts requested; replied saying only
one tree has grown well. Others too
crowded, none have produced nuts
as yet.

9/7/39 - one tree alive. Dr. Elliott now
at 6818 Glenbrook Rd., Bethesda
Md.

Bethesda Md.

W-1951

Gordon Farrer

7210 Radnor Road (Just off Bradley
Lane)

10/8/47 - Has 2 fine chestnut trees, bearing
tall as house.

Seed mimeo. sent

1931 Shipment

Bethesda, Md.

Castanea mollissima

Dr. Gilbert Grosvenor
Grosvenor Lane

Quan.

No.

3

FP1-78744

Remarks:

5/4/31 - ack. receipt

ROCKVILLE, MD.

G. H. Grosvenor

R. F. D. #3

5/13/15 - 3 #39721 C. moll.

8/31/35 - Nuts requested

BETHESDA, MD.

Mr. Swinburne
5605 Oak Place

FP-

W-1951

Letter 9/12/49 from Burnett H. Ballard, Rt. 4. Box 103,
Vienna, Va., states:

"About 17 or 18 years ago, when Dr. Hedgcock had chestnut trees in outdoor beds around the old greenhouses on Constitution Avenue, he directed me to discard some potted trees that had been inoculated for chestnut blight. They looked so good and healthy I took a few home and planted them around my woods, by stumps of the dead native variety. Later I dug one up and gave it to a friend; today it is growing and bearing a good crop and is a fine clean tree, about 30 feet high, and has borne nuts the past 4 years. I am mailing you a fair sample of the 1949 crop; the tree is growing in the front yard of my friend, Mr. Antonio Nasuti, and as he expects to move to California soon, he advises me that he welcomes any Forest Path. men to visit the tree, take specimens, and make inspections while he is there."

Over

Mr. Nasuti turns the place over to Mr. Swinburne as of
Sept. 15, 1949;

These nuts are to be planted in our forest plantings. The
tree seems to be self-pollinating and the nuts should go
into forest plantings. -- GFG

Note: Miss Ballard works in Room 2423 South Agric. Bldg.,
Bureau of Agric. Statistics, Crop Estimates. GFG
called her and got the above information about
Mr. Nasuti.

Bethesda, Md.

Tony Nasuti,
— Oak Place.

I. c. crenata

about 1933-34.

See sketch over. One plant given to
Nasuti by Mr. Ballard at time dissections
of chestnuts were made at Path. Greenhouse.
Ballard reports Aug 1939 that tree is about
20 ft. high and several inches caliper at base.
Has two burrs this year.

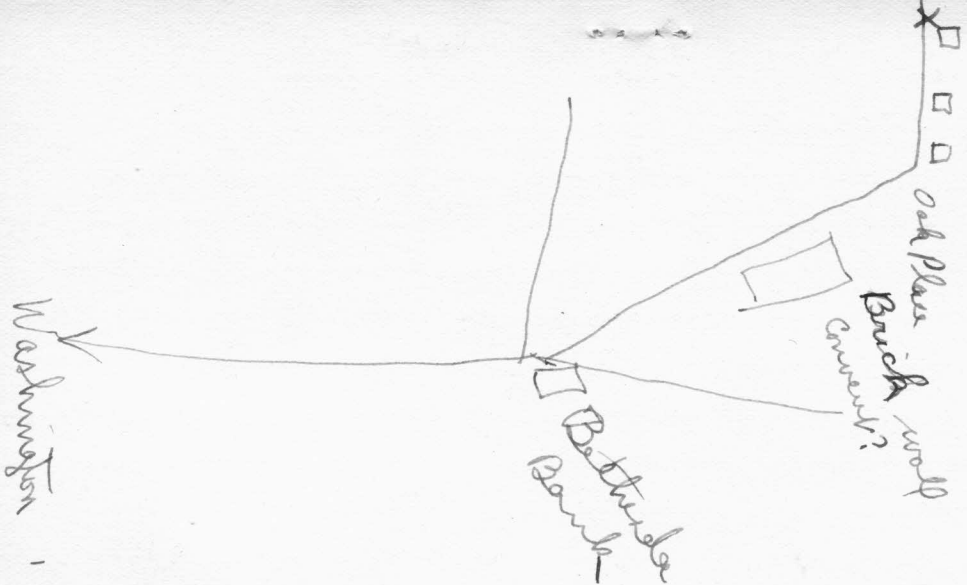

Bethlehem, Pa.

Seed mimeo. sent '44

W-1951

Dept Bldgs + Grounds

Lehigh University

A. Litzzenberger, Supr.

3/15/39 - 5 trees each GX, GY, GAA, GAB,
and FP-617, C. Crenata
5 trees each FP-616, FP504, MAZ,
MBD + MBC, C. mollissima

4/21/39 - map in file.

8/10/51 - Trees healthy, nuts scarce.

Bloomsburg

Town:

~~Mainville~~, Pa.

Columbia Co.

Seed mimeo. sent '44

Owner:

~~R. R. Lutz, R. L.~~

CASTANEA

real.

Address:

Rt. 1, R. L.

FPI No. 70315 or Origin:

Garretaker:

L. R. Lutz

Number of trees: 25 (1929)

Address:

If several trees, make separate cards for each, using this outline.

| | | | | | | |
|----------------|------|-----------|-------|--------|-----------------|--------|
| Age: | Ht.: | DBH: | Nuts: | Quan.: | Size: | Qual.: |
| C. B. present: | | Location: | | | Age of cankers: | |
| Description: | | | | | | |

Other pathological symptoms:

Average twig growth preceding year:

this year:

Site and growing conditions poor

fair

good

REMARKS

No one on premises.

Searched apple orchard
and grounds but found
no trees. 10/11/37. RBC.

Noted by:

[OVER]

Date

(On reverse side sketch location of trees and number each 1, 2, 3 etc.)

Go thru Mainville, ^{eastward} on 342
to first Y, 1 1/2 miles from
town, turn left. Go 10
miles to church + school at
cross roads. Turn left on dirt
road 1/2 mile. Turn left side.

8/24/34 advises 17 trees alive - 3 died this spring from
blight or winter injury.

Written 3/3/36. No reply

Bayertown Pa.

Seed mimeo. sent '44

Mr. Gordon Barneman

41.139-12 FP-633 *C. mollissima*
12 O-16 *C. mal. hybrids*

Boyertown, Pa.

Dr. Frank L. Baum.

1944-45:

Dr. Baum dead, Mrs. Isabella J. Baum, Route #2,
Douglassville, Pa. Now owns. Card filed under
Douglassville, Pa.

Boyertown, Penna.
Elmer Eidel
RFD #1

3/17/47 - 7 #58602 C. mol. (R9T5, Sav.)

BOYERTOWN, PA.

Weevil Memo Sent 1948

JOHN Z. HARNER, 309 E. Philadelphia Ave.
Pres. Union Mfg. Co., Inc.

Letter 11/29/37 -

"I have planted some chestnut trees and some nuts as per
circular from Chas. V. Stein, Maheim, Pa., herewith enclosed. Some
of my trees are four years old and a few are eight years old. The
latter are bearing. * * * * *

10/19/43 sent about 1 dozen small nuts which appeared to
have dentate blood. Were too dry on receipt to plant.

Boyerstown, Pa.
Mrs. Norma Mensch
R. F. D. 1

1939. J. D. says has 1 Jap chestnut
growing between 2 black
walnut trees; supposed
to have a number of other
40yr-old Jap chestnut trees, about
1939 - J. D. ordered 100 seeds.
11/5/40 - Burrs empty this year

Boyerstown, Pa. Berks Co
H. W. Rickard
R. F. D. 2

4/23/41 - 1 lb seed FP-979 C. mol. v
1 1/2" " FP-1003 hybrid

Brockway, Pa.
A. V. Bassetti
Borough
Brockway Municipal Authority

For reforestation on watershed:
4/27/51 - 100 FP-1514 C. mol. [map in file]

BRYN MAWR, PENNA.

W-1951

MRS. WYKOFF SMITH

10/18/37 - Received seedlings in 1937 from Bartlett trees

Seed mimeo. sent '44

Butler, Pa

W-1951

Ray Monnier
R # 10 # 2

4/9/38 - 15 H-497 *C. erenata*
15 5-8 Ball hybrid

4/18/30 - ack receipt of trees; map in file.

4/11/39 - map in file. 5-8 Ball ^{not} so good
but all of the large size grew;
rabbits killed several before
netting put up. Balance in
good condition. Trees to be
cultivated

WASHINGTON, D. C.

Seed mimeo. sent '44

Mrs. Adon D. Phillips, Bradley Hills,

R.F.D. 3, Bethesda Station (14) Md.

2/26/36

3 FP-462 *Castanea mollissima*

2 FP-476 " *crenata*

Oct. 1944 - 4 trees doing well; 2 produced nuts this year; one tree died first winter; one does not seem to grow as fast as others, it blossoms freely & bears a few nuts each year. Jap beetles bad this summer.

July 1946 - Three trees living.

BETTERTON, Md. Kent Co.

crenata

4, 7

Harry Willis check by Reed.

Fall, 1924. Has 50 Japs in orchard. Reed examined in fall, 1924 and found them doing fine. Gravatt to visit. (GFG)

Planted 16-18 yrs. ago.

{ Mr Arthur L. Harris, a large fruit grower in same neighborhood and same P.O. contemplating planting. }

Some of the trees came from Denton, Md. (J. W. Kern) and some from Felton, Del. (J. W. Killers)

Big Pool, Md. [Express: Big Springs, Md.]

W.C. Smith, caretaker

Indian Spring Wildlife

Demonstration Area

| | | | |
|--------|-----|--------|--------------------------|
| #11141 | -25 | T-4 | <i>C. mol. hybrids</i> |
| | 25 | FP-929 | Mixed varieties |
| | 25 | S-8 | Jap-ching. hybrid |
| | 25 | FP-925 | <i>C. crenata</i> , wild |

BOWIE MD.

Wm. Brown
(Wade employed at PI Station)

4/29/36

4 ME Castanea mollissima

Bowie, Md. ✓ Prince Georges Co. ^{mixed plants from}
Victor Dufour. See Horvitz. ^{camp Meade planting}

About a dozen trees from broken odd
lots of faps & Chinese trees at Meade. April 1926.

In Hartford Co., Md. Did not look up former
residence. 5/7/30 Fowler & Clapper.

Bowie, Md. ✓ Prince Georges Co. ^{mixed plants from}
Raymond Fowler. (Mother at P.O.) ^{camp Meade planting}

About a dozen odd trees from faps & Chinese
trees Meade. April 1926. He had mostly
Chinese if not traded with the other
boys working on the job.

Big white house near white church

But 1 seedling left, very small. Topped off
by stock? Fowler & Clapper 5/7/30.

Bowie, Md.

Mr. W. E. Henry

Pres., Md. State Teachers College.

4/11/51 - 100 FP-1514 C. mollissima

Bowie, Md.

Seed memo. sent '44

John M. Jones

4/15/38 - 3 FP-530 C. mollissima

Bowie, Md. ✓

mixed plants from Camp Meade plantings

Bruce Seaman Co.

Nelson Kimmel in Baltimore, see his father at store in Bowie.

Oriental chestnut about a dozen odd plants from Camp Meade. April 1926. Had three altogether, one plowed up, two plants 1 foot high some budding. 1 seven feet high very good condition. These back of store slight budding on largest. 5/7/30 Fowler + Clapper. These plants back of this store in garden.

BOWIE, MD

W-1951

Joe Manner

Seed nuce. sent 1944

Manner

4/23/36 4 MP Castanea mollissima

9/13/44 - 3 trees just beginning to bear.

July 1946 - 3 trees living, no nuts yet. Four trees would have produced no fruit
No crop this year

Bowie, Md.

Paul Mulligan (was employed at Bell.)

4/8/38 - 6 FP-495 C. mollissima

Mullikin, R. E.
Bowie, Maryland.

CASTANEA MOLLISSIMA "ME"
15 plants. April 1933.

Mr. Mullikin ^{was} employed by FPI at Bell, has worked with chestnuts there and is very much interested in them.

Written 3-10-36. No reply.

BOWIE, MD.

Biological Survey
see Mr. L. C. Morley
U./S. D. A.

Now the Fish & Wildlife Service,
Patuxent ^{Wildlife Research} Game Refuge, Wa. 4205 - 102
L.C. Morley.

4/7/36

- ✓ 800 FP-385 Castanea mollissima (Bell)
- ✓ 800 FP-386 Mixed molliss. ~~specimens~~ type (Bell)
- ✓ 2175 FP-288B " species etc. (Bell)
- ✓ 375 FP-256 Castanea mollissima (Bell)
- 850 FP-288 " " (Bell)

5,000

Mr. Morley took approx. 3500 of these; see attached sketch of location north of Bowie, Md. Mr. J.L. Stearns, Supt. CCC Camp A-1 Beltsville Res. Center, took approximately 1500; see card filed under "Beltsville Research Center, Md."

11/10/43 - invited inspection

11/17/48, Uhler, wild life food biologist, is much interested in these and wishes identification on some next fall.
gfg

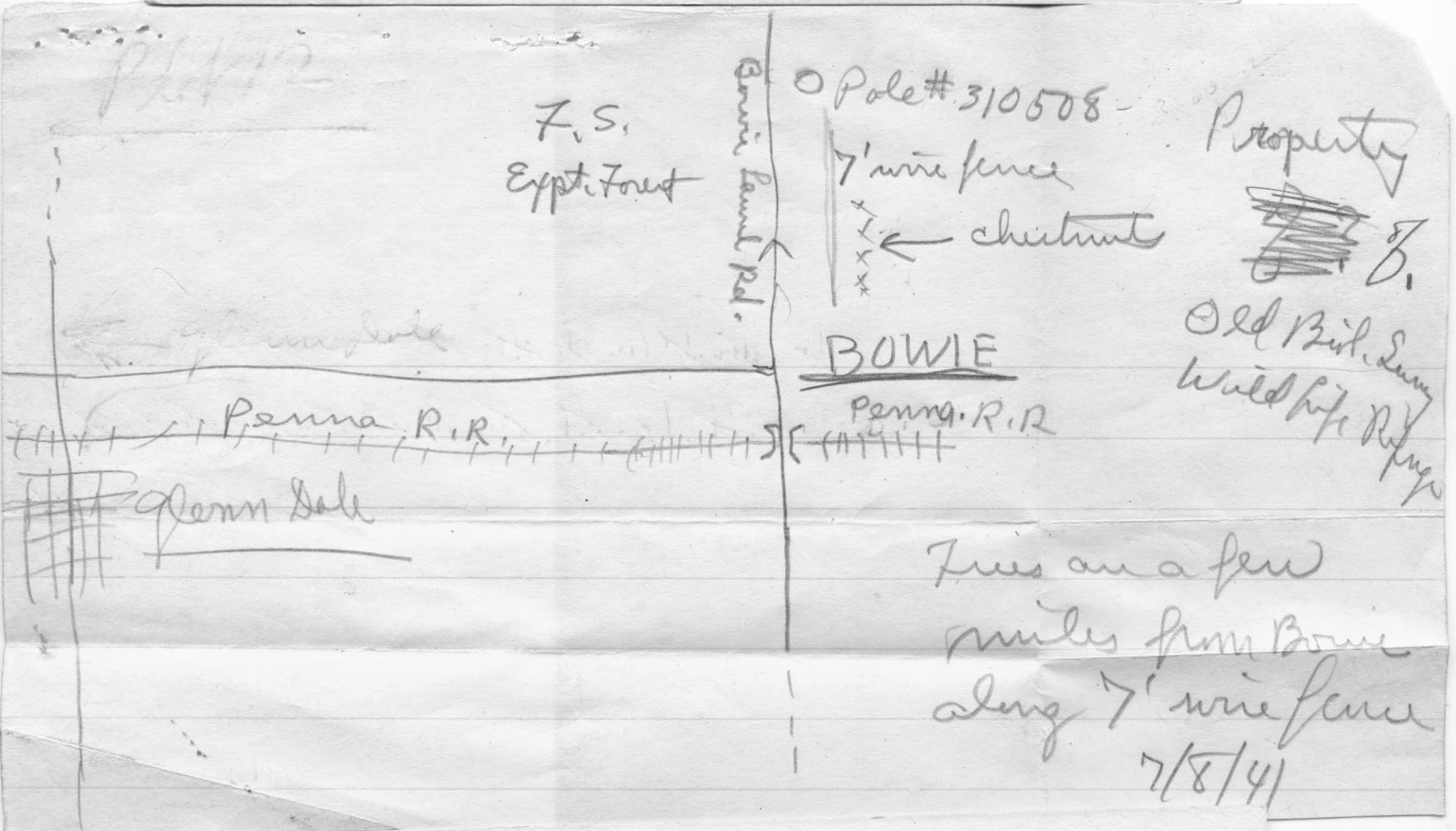

Laurel, Md.

Leonard M. Llewellyn
Patuxent Wildlife Research Refuge

4/21/50 - 25 FP-1225 C. mollissima

Mixed plants from camp
meade planting
Prince Georges Co
Bowie, Md.,
Wm. Reilly. On road to Highbridge 1 mi. from Bowie

About a dozen trees from broken odd lots of
japs & Chinese trees at Meade. April 1926.

(Overholser on Mr. Reilly's former
place. Near Catholic church, there)

Mr. Reilly's place located 1 mi. S. of Bowie
on Highbridge road - opposite Standard Oil Co. Tanks.

4 burned off - dead: 1 4 ft. high, healthy (one
stem - 5 other stems cut off) - 1-3 ft. h. healthy
5/7/30 Chappin & Fowler.

BOWIE, MD.

Jacob Sikes

4/23/36 6 FP386 Bell Mollissima hybrids

Bowie, Md. Prince Georges Co
Albert Smith. Has named several links, Still in
Bowie.

About a dozen japs & Chinese chestnuts from
broken odd lots at Meade. April 1926.

No trees found on place. See
Miss Grace Smith. 402 A st. S.E. Wash.

Mr. Albert Smith dead since 1922.
5/7/30 Fowler & Clapper.

BOWIE, MD.

~~Mr. W. S. Trott~~ deceased
Pa. R. R. Agt.

Seed memo. sent '44

4/23/36 4 MR Castanea mollissima

July 1946 - Mr. Trout dead.
RBC to check.

Bradley Hills, Md.

1931 Shipment

Castanea mollissima

L. T. Leonard

Quan. No.

S. F. J. ~~Box~~ No. U.S.D.F. ~~(S. F. J.)~~

5 MF

G. H. Range #1, Br. 54 R2

5 MJ

Remarks:

4/8/31 - Kept 1 MJ + 1 MF. See cards for rest of following

W. H. Lauer, Port Royal, Pa.

Harry Schwartz " " "

Bryan Crawford, McCaysville, Pa.

D. S. Leonard, Thompsonstown, Pa.

Conococheague R & Club, East Waterford, Pa.

Letter also gives directions for finding all the trees.

Leonard

45507

Castanea crenata

Chestnut

S.F.I. No.

Scientific Name

Common Name

3/29/23

A prompt reply to the following questions regarding the tree above named will be thankfully received:

Number of trees alive... 1 Height of trees... 3 1/2 feet

Have trees fruited? No Size and quality of nuts.....

Approximate location of trees on your place... Center

Seven Locks + Bradley Rd., Montg. Co., Md.

Kindly use inclosed envelope.

Knowles Ryerson,
Horticulturist in Charge.

Date... 5-5-28

Sign here.....

Lewis T. Leonard

Thompsonstown, Pa.

D. S. Leonard

(Soils, P. O. Station, Beltsville, Md)

Brandywine, Md.

Cedarville State Forest.

Undated letter, 1950, from P. W. Miller, For. Supt.,
advises there are 15 trees in the
planting, in clusters due to repeated
attacks of blight, from 2 to 5 ft high.
& #1 to 1.5 in dbh.

4/3/51 - 50 #58602 *C. mollissima*

Brighton, Md.

Fred Gilpin

3/29/50 - 6 FP. 1457 - *C. mollissima*

Brighton, Md.
Harold Leishear

3/21/50 - 6 FP-1457 *C. mollissima*

Brookdale, Md.

Seed mimeo. sent '44

Henry W. Fisher, Jr.
4701 Merivale Road

4/9/40 - 5 MBG *C. mollissima*.

②
BROOMES ISLAND, MD.
CALVERT COUNTY

Mr.

Latimer (Delivered by GFG)

4/15/36 10 MAB *Castanea mollissima*
15 MY " "

Father is James B.
son is John S. Seed mimeo. sent '44

July 1946 - Only 2 trees growing now. This the first year trees have blossomed. All other trees were distributed among neighbors who apparently did not have much success with them, one ^{opposite} on creek from Mr. Latimer that has a few buds this fall. --- J. B. Latimer.

WASHINGTON, D. C.

Seed mimeo. sent '44

Mrs. Adon D. Phillips, Bradley Hills,

R.F.D. 3, Bethesda Station (14) Md.

2/26/36

3 FP-462 Castanea mollissima

2 FP-476 " crenata

Oct. 1944 - 4 trees doing well; 2 produced nuts this year; one tree died first winter; one does not seem to grow as fast as others, it blossoms freely & bears a few nuts each year. Jap beetles bad this summer.

July 1946 - Three trees living.

BETTERTON, Md. Kent Co

crenata

4, 7

Harry

Willist check by Reed.

Fall, 1924. Has 50 Japs in orchard. Reed examined in fall, 1924 and found them doing fine. Gravatt to visit. (GFG)

Planted 16-18 yrs. ago.

{ Mr Arthur L. Harris, a large fruit grower in same neighborhood and same P.O. contemplates planting. }

Some of the trees came from Denton, Md. (J. W. Kew) and some from Felton, Del. (J. W. Killers)

Big Pool, Md. [Express: Big Springs, Md.]

W.C. Smith, Caretaker

Indian Spring Wildlife

Demonstration Area

#/11/41 - 25 T-4 C. mol. hybrids

25 FP-929 mixed varieties

25 S-8 Jap-ching. hybrid

25 FP-925 C. crenata, wild

BOWIE MD.

Wm. Brown
(Wade employed at PI Station)

4/29/36

4 ME Castanea mollissima

Bowie, Md. ^{mixed plants from} Prince Georges Co ^{camp Meade planting}
Victor Dufour. See Horvitz.

About a dozen trees from broken odd
lots of faps & Chinese trees at Meade. April 1926.

In Hartford Co., Md. Did not look up former
residence. 5/7/30 Fowler & Clapper.

Bowie, Md. ^{mixed plants from} Prince Georges Co ^{camp Meade planting}
Raymond Fowler, (Mother at P.O.)

About a dozen odd trees from faps & Chinese
trees Meade. April 1926. He had mostly
Chinese if not traded with the other
boys working on the job.

Big white house near white church

But 1 seedling left, very small. Topped off
by stock? Fowler & Clapper 5/7/30.

Bowie, Md.

Mr. W. E. Henry

Pres., Md. State Teachers College.

4/11/51 - 100 FP-1514 C. mollissima

Bowie, Md.

Seed memo. sent '44

John M. Jones

4/15/38 - 3 FP-530 C. mollissima

Bowie, Md.

mixed plants from Camp Meade plantings

Nelson Kimmel in Baltimore, see his father at store in Bowie.

Oriental chestnut about a dozen odd plants from Camp Meade. April 1926. Had three altogether, one plowed up, two plants 1 foot high some budding. 1 seven feet high very good condition. These back of store slight budding on largest. 5/7/30 Fowler + Clapper. These plants back of this store in garden.

BOWIE, MD

W-1951

Joe Manner

Seed nince. sent 1944

Manner

4/23/36 4 MP Castanea mollissima

9/13/44 - 3 trees just beginning to bear.

July 1946 - 3 trees living, no nuts yet. Four
trees would have produced no fruit
No crop this year

Bowie, Md.

Paul Mulligan (was employed at Bell.)

4/8/38 - 6 FP-495 C. mollissima

Mullikin, R. E.
Bowie, Maryland.

CASTANEA MOLLISSIMA "ME"
15 plants. April 1933.

Mr. Mullikin ^{was} employed by FPI at Bell, has worked with
chestnuts there and is very much interested in them.

Written 3-10-36. No reply.

BOWIE, MD.

Biological Survey
see Mr. L. C. Morley
U./S. D. A.

Now the Fish & Wildlife Service,
Patuxent ^{Wildlife Research} Game Refuge, Wa. 4205 - 102
L.C. Morley.

4/7/36

- ✓ 800 FP-385 Castanea mollissima (Bell)
- ✓ 800 FP-386 Mixed molliss. ~~specimens~~ type (Bell)
- ✓ 2175 FP-288B " species etc. (Bell)
- ✓ 375 FP-256 Castanea mollissima (Bell)
- 850 FP-288 " " (Bell)

5,000

Mr. Morley took approx. 3500 of these; see attached sketch of location north of Bowie, Md. Mr. J.L. Stearns, Supt. CCC Camp A-1 Beltsville Res. Center, took approximately 1500; see card filed under "Beltsville Research Center, Md."

11/10/43 - invited inspection

11/17/48, Uhler, wild life food biologist, is much interested in these and wishes identification on some next fall.
gfg

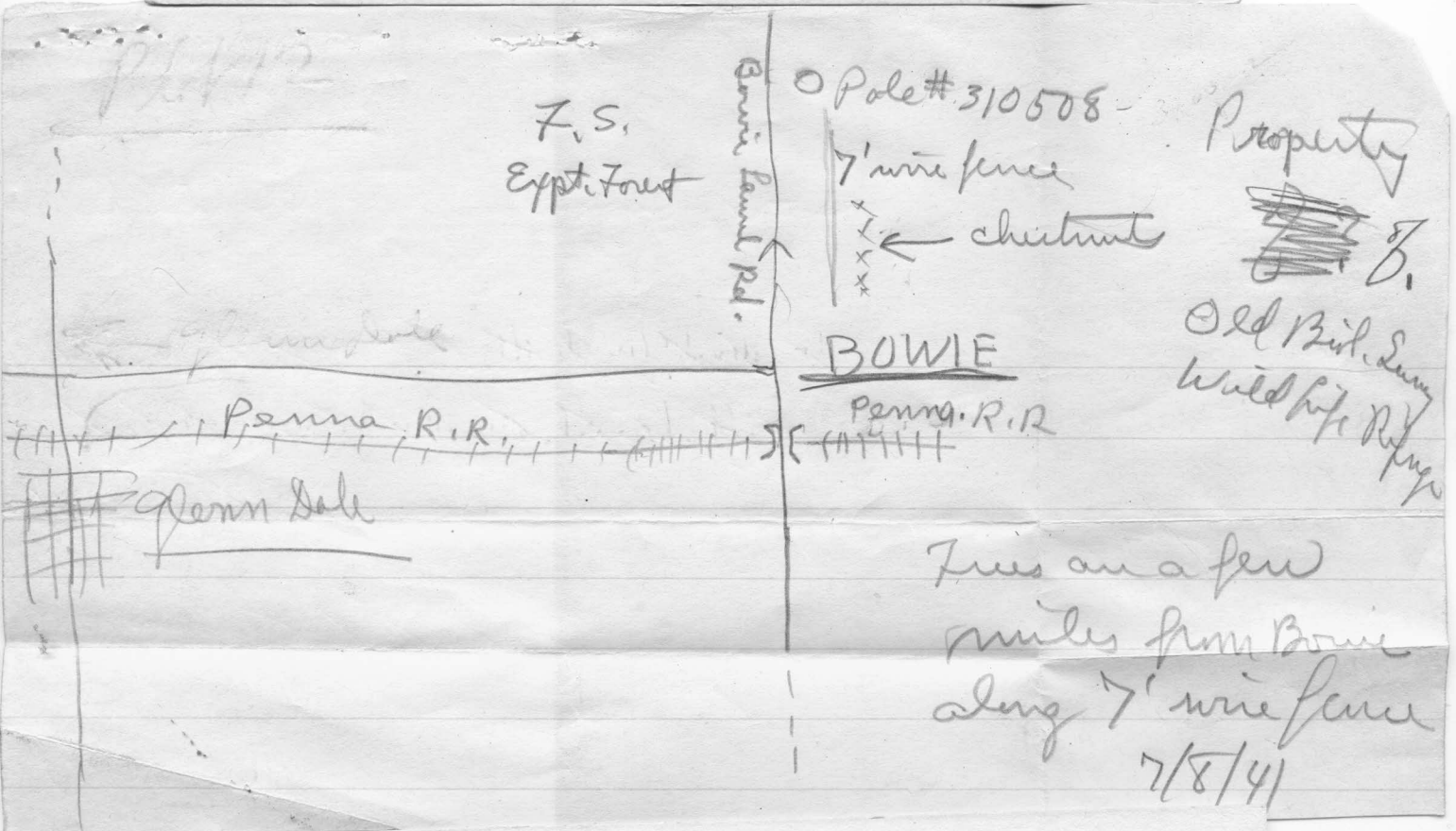

Laurel, Md.

Leonard M. Llewellyn
Patuxent Wild Life Research Refuge

4/21/50 - 25 FP-1225 C. mollissima

Mixed plants from camp
meade planting
Prince Georges Co
Bowie, Md.,
Wm. Reilly. On road to Highbridge 1 mi. from Bowie

About a dozen trees from broken odd lots of
japs & Chinese trees at Meade. April 1926.

(Overholser on Mr. Reilly's former
place. Near Catholic church, there)

Mr. Reilly's place located 1 mi. S. of Bowie
on Highbridge road - opposite Standard Oil Co. Tanks.

4 burned off - dead: 1 4 ft. high, healthy (one
stem - 5 other stems cut off) - 1-3 ft. h. healthy
5/7/30 Chappin & Fowler.

BOWIE, MD.

Jacob Sikes

4/23/36 6 FP386 Bell Mollissima hybrids

Bowie, Md. Prince Georges Co
Albert Smith. Has named several links, Still in
Bowie.

About a dozen japs & Chinese chestnuts from
broken odd lots at Meade. April 1926.

No trees found on place. See
Miss Grace Smith. 402 A st. S.E. Wash.

Mr. Albert Smith dead since 1922.
5/7/30 Fowler & Clapper.

BOWIE, MD.

~~Mr. W. S. Trott~~ deceased
Pa. R. R. Agt.

Seed memo. sent '44

4/23/36 4 MR Castanea mollissima

July 1946 - Mr. Trout dead.
RBC to check.

Bradley Hills, Md.

1931 Shipment

Castanea mollissima

L. T. Leonard

Quan. No.

S. F. J. ~~Box 110~~, U.S.D.F. (~~5-1-1946~~)

5 MF

G. H. Range #1, Br. 54 R2

5 MJ

Remarks:

4/8/31 - Kept 1 MJ + 1 MF. See
cards for rest of following

W. H. Lauer, Port Royal, Pa.

Harry Schwartz " " "

Bryan Crawford, McCoyville, Pa.

D. S. Leonard, Thompsonstown, Pa.

Conococheague R & Club, East Waterford, Pa.

Letter also gives directions
for finding all the trees.

Leonard

45507

Castanea crenata

Chestnut

S.F.I. No.

Scientific Name

Common Name

3/29/23

A prompt reply to the following questions regarding the tree above
named will be thankfully received:

Number of trees alive... 1 Height of trees... 3 1/2 feet

Have trees fruited? No Size and quality of nuts.....

Approximate location of trees on your place... Center

Seven Locks + Bradley Rd., Montg. Co., Md.

Kindly use inclosed envelope.

Knowles Ryerson,
Horticulturist in Charge.

Date 5-5-28

Sign here.....

Leonard

Thompsontown, Pa.

D. S. Leonard

(Soils, P. O. Station, Beltsville, Md)

Brandywine, Md.

Cedarville State Forest.

Undated letter, 1950, from P. W. Miller, For. Supt.,
advises there are 15 trees in the
planting, in clusters due to repeated
attacks of blight, from 2 to 5 ft high.
+ #1 to 1.5 in W.B.H.

4/3/51 - 50 #58602 *C. mollissima*

Brighton, Md.

Fred Gilpin

3/29/50 - 6 FP. 1457 - *C. mollissima*

Brighton, Md.
Harold Leishear

3/21/50 - 6 FP-1457 *C. mollissima*

Brookdale, Md.

Seed mimeo. sent '44

Henry W. Fisher, Jr.
4701 Merivale Road

4/9/40 - 5 MBG *C. mollissima*.

② BROOMES ISLAND, MD.
CALVERT COUNTY

Mr.

Latimer (Delivered by GFG)

4/15/36 10 MAB *Castanea mollissima*
15 MY " "

Father is James B.
son is John S. Seed mimeo. sent '44

July 1946 - Only 2 trees growing now. This the first year trees have blossomed. All other trees were distributed among neighbors who apparently did not have much success with them, one ^{opposite} on creek from Mr. Latimer that has a few buds this fall. --- J. B. Latimer.

Bethlehem, Pa.

Seed mimeo. sent '44

W-1951

Dept Bldgs + Grounds

Lehigh University

A. Lützenberger, Supr.

3/15/39 - 5 trees each GX, GY, GAA, GAB,
and FP-617, C. Crenata
5 trees each FP-616, FP504, MAZ,
MBD + MBC, C. mollissima

4/21/39 - map in file.

8/10/51 - Trees healthy, nuts scarce.

Bloomsburg

Town:

~~Mainville~~, Pa.

Columbia Co.

Seed mimeo. sent '44

Owner:

~~R. R. Lutz, R. L.~~

CASTANEA

real.

Address:

Rt. 1, R. L.

FPI No. 70315 or Origin:

Garretaker:

L. R. Lutz

Number of trees: 25 (1929)

Address:

If several trees, make separate cards for each, using this outline.

| | | | | | | |
|----------------|------|-----------|-------|--------|-----------------|--------|
| Age: | Ht.: | DBH: | Nuts: | Quan.: | Size: | Qual.: |
| C. B. present: | | Location: | | | Age of cankers: | |
| Description: | | | | | | |

Other pathological symptoms:

Average twig growth preceding year:

this year:

Site and growing conditions poor

fair

good

REMARKS

No one on premises.

Searched apple orchard
and grounds but found
no trees. 10/11/37. RBC.

Noted by:

[OVER]

Date

(On reverse side sketch location of trees and number each 1, 2, 3 etc.)

Go thru Mainville, ^{eastward} on 342
to first Y, 1 1/2 miles from
town, turn left. Go 10
miles to church + school at
cross roads. Turn left on dirt
road 1/2 mile. Turn left side.

8/24/34 Advises 17 trees alive - 3 shed this spring from
blight or winter injury.

Written 3/3/36. No reply

Boyerstown Pa.

Seed mimeo. sent '44

Mr. Gordon Barneman

4/1/39-'12 FP-633 *C. mollissima*
'12 O-16 *C. mal. hybrids*

Boyertown, Pa.

Dr. Frank L. Baum.

1944-45:

Dr. Baum dead, Mrs. Isabella J. Baum, Route #2,
Douglassville, Pa. Now owns. Card filed under
Douglassville, Pa.

Boyertown, Penna.
Elmer Eidel
RFD #1

3/17/47 - 7 #58602 C. mol. (R9T5, Sav.)

BOYERTOWN, PA.

Weevil Memo Sent 1948

JOHN Z. HARNER, 309 E. Philadelphia Ave.
Pres. Union Mfg. Co., Inc.

Letter 11/29/37 -

"I have planted some chestnut trees and some nuts as per
circular from Chas. V. Stein, Maheim, Pa., herewith enclosed. Some
of my trees are four years old and a few are eight years old. The
latter are bearing. * * * * * "

10/19/43 Sent about 1 dozen small nuts which appeared to
have dentata blood. Were too dry on receipt to plant.

Boysertown, Pa.
Mrs. Norma Mensch
R. F. D. 1

1939. J. D. says has 1 Jap chestnut
growing between 2 black
walnut trees; supposed
to have a number of other
40yr-old Jap chestnut trees, about
1939 - J. D. ordered 100 seeds.
11/5/40 - Burs empty this year

Boysertown, Pa. Berks Co
H. W. Rickard
R. F. D. 2

4/23/41 - 1 lb seed FP-979 C. mol. v
1 1/2" " FP-1003 hybrid

Brockway, Pa.
A. V. Bassetti
Brockway ^{Borough} Municipal Authority

For reforestation on watershed:
4/27/51 - 100 FP-1514 C. mol. [Map in file]

BRYN MAWR, PENNA.

W-1951

MRS. WYKOFF SMITH

10/18/37 - Received seedlings in 1937 from Bartlett trees

Seed mimeo. sent '44

Butler, Pa

W-1951

Ray Monnier
R # 10 # 2

4/9/38 - 15 H-497 *C. erenata*
15 5-8 Ball hybrid

4/18/30 - ack receipt of trees; map in file.

4/11/39 - map in file. 5-8 Ball ^{not} so good
but all of the large size grew;
rabbits killed several before
netting put up. Balance in
good condition. Trees to be
cultivated