

St. Leonards, Md.

H. B. Trueman.

W-1951
Seed mimeo. sent '44

4/9/37 - 20 MAX, *C. mollissima*
10 FP-496, mixed varieties

Tom Parran 25 trees max

Dagnall - 15

Lusby, or St. Leonard,
Calvert County, Md.

W-1951

11/46 Thomas Parran sent 1 pint of nuts from MAX
trees, pure planting; of large size and attractive.
Too dry to plant or to rate. Sample filed.

6/55 - address letter to Mrs. Parran. Mr.
Parran deceased.

~~Lusby, or St. Leonard~~ Md. Seed mimeo. sent '44
Tom Parran, West Shore Transit Co.
(G.F.G. delivered trees)

4/9/37 - 25 MAX - *C. mollissima*
9/18/44 all chestnut trees are living
and doing very well

St. Marys County, Maryland

J. K. Erly (VA-4000)

Metropolitan Police Boys Club

300 Indiana Ave

Trees planted
at Campin
St. M. Co, Md.

4/4/51 - 50 FP-1360 C. mollissima

Seed mimeo. sent '44

41358 *Talbot Co.* *pumila x crenata*

12

1 pl. 12-16-18 Benson, O. Harper Grace St.,
St. Michael, Md.

3 pl 3/9/17 - # 36666 - e. mal.

Talbot Co,

41358

Chestnut

Chinquapin

Castanea pumila x crenata

S.P.I.No.

Scientific Name

Common Name

A prompt reply to the following questions regarding the above-named tree will be thankfully received:

Number of trees sent.....1.....Date sent.....12-16-18.....

Number of trees alive...1.....Height of trees...about 8 ft.....

Have trees fruited?..No..Size and quality of nuts.....

Approximate location of trees on your place. *Now in leaves. This tree has been noted 3 times because of wonderful circumventer-ness, its growth. At least. It is now doing fine, healthy.*

Kindly use inclosed envelope.

Knowles Ryerson,
Horticulturist in Charge

Date.....6-4-28.....Sign Here.....*O. Harper Benson*.....

O. Harper Benson, Grace St., St. Michael, Md.

ST. MICHAELS, MD.

Castanea pumila x crenata

41462

O. H. Benson
Box 64.

1 pl. 3/15/16

Falbot Co.

41462	Castanea pumila x crenata	Chestnut
S.P.I. No.	Scientific Name	Common Name

A prompt reply to the following questions regarding the above-named tree will be thankfully received:

Number of trees sent. 1 Date sent. 3-15-16

Number of trees alive. 1 Height of trees. 8 ft

Have trees fruited? No Size and quality of nuts. ✓

Approximate location of trees on your place. Unfortunately on account of circumstances beyond control - this tree has been moved twice. It now is located in open lawn. Tree is healthy and will do well.

Kindly use inclosed envelope.

Knowles Ryerson,
Horticulturist in Charge.

Date 5-21-28

Sign Here

O. H. Benson

St. Michaels, Md.

O. H. Benson
.....
Experimenter

Address

Salisbury, Md.
Mrs. Sallie Alsharoon
705 Bay Street

1951 - Received some trees from Mr. Herbert C. Fooks.

Seed memo. sent '44

Weevil Memo Sent 1948 - 1951

Town: Salisbury, Md

CASTANEA mollissima

Owner: ~~J. Edgar Purnell~~

FPI No. 70314 Vor Origin:

Address: 10-1/2 acres

Number of trees: 3 (spring 1930)

Caretaker: Spring Hill Road.

If several trees, make separate cards for each, using this outline.

Address:

(Land purchased by Mr. & Elizabeth Redden and
Joy R. Heaster)

Age: Ht.: DBH: Buds: Quan.: Size: Qual.:

C. B. present: Location: Age of cankers:

Description:

Other pathological symptoms:

Average twig growth preceding year: this year:
Site and growing conditions poor fair good

REMARKS

over

Noted by:

Date

(On reverse side sketch location of trees and number each 1,2,3 etc.)

10/4/39 - one tree died first season. See this letter for details. Nuts received.

Rec'd '39: #1, 35 p.p. medium attractive, cleans very well, medium sweet to good. B.T. #2, 37 p.p. very plump medium attractive, peltate thick, tight, cleans very well, quite sweet. B.

11-4-44. He has 4 doz. trees, 2-6 or 7 years old, and most of them bearing from a few burrs to a full crop, which indicates unusual productiveness of this introduction. In spite of the trees having been damaged by two hurricanes, the original two trees sent him in 1930 had about 1 bushel of nuts this year.

1946 - Trees hit by 2 wind storms this year, which cleaned trees of nuts before all developed. Land on which chestnut trees were planted now owned by Misses Hester & Redden.

Salisbury, Md.

Seed memo. sent '44

Mr. Ernest A. Vaughn
Farm Security Adm.

for same div., State of Md.

3/22/39 - 25 S-8 Jap-ching. hybrid
125 RG-6 Jap. hybrid
150 FP-799 mixed ching. hybrid

4/1/39 - 150 FP-717 C. mollissima
150 FP-718 C. mal. hybrid
150 FP-725 mixed var + hybrid
125 FP-773 C. mal. hybrid
125 S-8 Jap-ching. hybrid
25 FP-710 C. mollissima

over

6/23/39 - Map in 1939 file.

10/16/43 sent a few buds but all were sterile.

10/9/43 - 90% survival first summer, but since then blight has killed all but 3 trees; 93 trees still making sprout growth but probably will succumb to blight. --- "Trees respond quickly to cultivation + fertilization & soon become susceptible to blight when practice discontinued."

9/14/44 - negative results. Trees winter kill each year; planted on soils with varying fertility but results the same.

Sandy Point, Maryland

Koehler,
Head of Conservation in Maryland

Ten trees of the Chinese Chestnut which are growing on the new park at Sandy Point, Maryland. They are about 25 years old producing edible nuts and Koehler is saving them for planting.

Seneca, MD
Washington, D.C.

Dr. F. C. Craighead (Trees planted at
5301-41st Street NW. Seneca, Md.)

4/2/41 - 3 FP-869 C. mal. [Bell]
4 FP-903 " " [Tientsin]
3 FP-870 " " hybrids, O.P.

¹⁹⁵⁰
1950 = 6 or 7 moved, one has blight, ~~has~~ practically girdled no branch,
Jan 1950, per Mr. Craighead to BFB.

Letter 10/19/50 to C. Hartley: "2 of the chestnut trees he gave me
bore well this fall, One of the trees had very sweet nuts quite
like the native but somewhat larger. "

Washington, D.C.

F. C. Craighead
Forest Insects.

Bu. Entom + Pl. Quar.

4/5/49 - Delivered:-

40 FP-12687 *Castanea mollissima*
10 FP-378 *Quercus acutissima*

Seed mimeo. sent '44 Weevil Memo Sent 1948 mal

Severn Park Md. 1937 Shipment

O. L. Molter

Castanea mollissima
Quan. 15 MI No. _____

Remarks:

Written 3-16-36. No reply.

Anne Arundell Co

~~Boone, Md.~~
Severn Park, Mr.
O. L. Molter

Castanea mollissima
1 plt. 1-16-24 - 56392

Severn Park, Md

10/15/30 I was bringing nuts this year - but now left to seed.
Nuts last year finer - no better than native nuts. I was
grow nicely.

41358 Anne Arundell Co pumila x crenata

12

(Molten?)

1 pl. 2-18-19 Molter, O. L. Boone, Md.

36666 - 2 pls. 2-28-17 Mollissima ✓

SILVER SPRINGS, MD.

Seed mimeo. sent '44

Messrs. C. Root & E. Hallauer

Maryland-National Capitol Park & Planting Commission

(telephone Shp. 1480)

5/20/36

✓ 100 FP 303 Castanea crenata
✓ 100 MI " mollissima
✓ 100 MM " "
✓ 100 MN " "
100 GJ " crenata

Silver Spring, Md.

Seed mimeo. sent '44

R. G. Hill deceased (1946)

~~408 B Street.~~

804 Sligo Ave., Silver Spring, Church, Va. See his card

He received a like amount for M E Smith

306 Great Falls St., Falls

4/8/38 - '17P-497 C. crenata

2 MAV C. mollissima

2 S-8 Ball hybrid

} map in file

Letter sent to occupant 9/23/44, returned undelivered

(See new address above - 1945).

July 1946 - mimeo returned by son with advice father dead, property sold in 1940 & he has no knowledge of present condition of trees. A letter to "occupant" returned "undelivered"

Check further with aid of maps.

Seed mimeo. sent '44

Weevil Memo Sent 1948

C. mollema

S.P.L. 66037, rec'd. 2/21/28 from Chico, 10 plants.

Distribution: 5 to Dr. A. L. Quaintance, Bus. Ento.
(5 to greenhouse for inoculations)

Dr. A. L. Quaintance,
Quaint Acres,
Silver Spring, Md.

Near Colesville, Md.

5/10/47 - 2 trees of the 1928 lot living {one tree produces
a very good, medium
size nut.

4/28/47 -- Growing a considerable number of seedling trees for
sale. -- G.F.G.

8/10/50 - 2 trees still alive - orchard type - no sign of chestnut
blight - some weevil injury - a heavy crop this year -
Mr. Quaintance says they have been bearing quite re- (over)

gularly for the past several years. They have planted a few nuts from these trees, and have some chestnut seedlings for sale, but don't find much sale for them, and don't push them. The property on which these trees are growing has been sold to a housing development company, and in time these 2 remaining trees will probably be cut down. F.H.B.

Silver Spring, Md.

C. mollis.

R. M. Woodward, Rte. 2.

7/16/46 Has one tree he obtained from the lot of trees planted at Soldiers Home, D.C., that was surplus? and apparently dumped. Reed + Clopper inspected this date and Reed photographed the tree. A remarkable lawn tree, spread greater than height, about 25-30 ft. x about 40 ft. Bears a few dozen fertile nuts each season but with efficient cross-pollination would yield more than 1/2 bu. nuts. A light crop of burrs this year. Tree is many branched at 2 feet. It is about 1 1/2 to 2 miles north of Quantico.

Silver Springs, Md.

Seed mimeo. sent '44

Harry Thompson
230 Cole Street

5/9/40 - 2 FP-845 *C. mollissima*

Silver Spring, Md.

~~WASHINGTON, D. C.~~

John E. Wiseman, Silver Spring, Md.

Richard L. Lamb

725 - 13th St. NW

824

3/30/15 - 2 #39721 *C. moll.*

2701-36th St. N.W. res.

10/1/30 Trees planted at Silver Spring, Md., Rte. 1. One tree was living in 1917 when house was sold to John E. Wiseman.

- M. E. F.

Wiseman not in directories 1944.

SHIP: Pick-up

FROM: Glenn Dale

DIVISION OF
PLANT EXPLORATION AND INTRODUCTION
BUREAU OF PLANT INDUSTRY,
SOILS AND AGRICULTURAL ENGINEERING
BELTSVILLE, MARYLAND

ORDER DATE: April 30, 1956

FOR: Mr. A. E. McClure
2109 Arcola Avenue
Silver Spring, Maryland

EXPRESS ADDRESS:

2 pounds Chinese x American hybrid seed from 1935 F₁ trees.

WT. OF SHIPMENT _____ LBS.

NOTE: REPORT TO BELTSVILLE IF MATERIAL DOES NOT ARRIVE IN GOOD CONDITION.

Silver Spring, Md.

Dr. C. E. Waller

1707 W. Highland Drive

Woodside

Silver Spring, Md.

8/10/50 - The 5 trees planted along the fence line are doing well - no sign of chestnut blight. Trees are planted 35-40 ft. apart. Soil is sandy. Light crop this year. Trees are a good example of the way in which chestnuts can be used for shade trees along city streets. See folder for map of planting. F.H.B.

seed mimet. sent '41

Montgomery Co. Md.

Weevil Memo Sent 1948

Silver Springs

Md.

Mall

Dr. C. E. Waller

1707 W. Highland Drive,

3/5/26 Woodside,

Silver Springs, Md.

25 SPI 61834

Castanea mollissima

3-16-36. No reply to our letter.

7/3/44 5 of the trees growing on parkway across from his house and doing well; 2 are growing in his back yard; and he has raised a few seedlings from some of they seed, and they have been planted. Like the American chestnut, one tree is reported as unusually straight and upright grower. - GFG

7/10/46 5 trees along fence line across road from his houses. Light crops on all 5 trees. not yet dropping. several nuts collected from tree #5. Practically no blight. Stout & Clapper. Two best trees about 30' tall, rest about 25'. None seen in back yard. Nuts start drop about 9/15/46

#1	2	3	4	5	Powell's pole
X	X	X	X	X	0

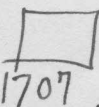
 1707
 Kightland Drive.

Montgomery Co.

61834	Castanea mollissima	Chestnut
S.P.I.No.	Scientific Name	Common Name

A prompt reply to the following questions regarding the ²⁵ trees above named will be thankfully received:

Number of trees alive... 24* ... Height of trees... 2 1/2 - 3 feet

Have trees fruited? No. Size and quality of nuts... —

Approximate location of trees on your place... 8 on parking in front of my home. Others scattered in vacant spaces in place of chestnut trees that failed.

* One accidentally cut down by laborer.

Knowles Ryerson,
Horticulturist in Charge.

Date... 5-16-28.

Sign here *C. E. Waller*

..... C. E. Waller
 Experimenter

Silver Springs, Md.

Address

-OVER-

The trees were planted
a year ago this spring.
Most of them made
a very good growth
last summer and are
in good condition at
the present time.

Mr. C. E. Waller,
Silver Springs, Md.

SHIP: Express collect

FROM: Beltsville, Maryland

ORDER DATE: April 24, 1956

FOR: Mr. John Warren
Wildlife Field Superintendent
Snow Hill, Maryland

DIVISION OF
PLANT EXPLORATION AND INTRODUCTION
BUREAU OF PLANT INDUSTRY,
SOILS AND AGRICULTURAL ENGINEERING
BELTSVILLE, MARYLAND

EXPRESS ADDRESS:

20 pounds of Asiatic oak seed (*Quercus acutissima*)
F.P. 1686.

WT. OF SHIPMENT _____ LBS.

NOTE: REPORT TO BELTSVILLE IF MATERIAL DOES NOT ARRIVE IN GOOD CONDITION.

Salomons, Md.
W. P. Lare

W-1951

3/19/49 - He has spent \$200 or so a year on nut trees. He has one "Zimmerman" & some small ones, altogether about 150 chestnut trees on his farm. - G. F. Brant.

6/13/49 - He is using scions from his Zimmerman for grafting onto other chestnut trees.

Diaberson, Blohin, Md.
Gordon Strong,
"Stronghold"

W-1951

~~4/21/48~~

5/4/48 20 F.P. 56 mollis.

7/3/48 - Chestnuts received; 6 planted in woods near road, 6 adjoining; 8 at edge of woods.

Sudley, Md.

J. Harris Franklin
1729 - 19th St. NW
Washington D.C.

See "D. C." file

Washington, D.C.

Seed mimeo. sent '44

Salt to

~~J. Harris Franklin~~ Mr. Franklin P. Asher, Jr.
1729 - 19th Street NW. [?] Sudley, Md.

for planting on farm at Sudley, Md.

3/21/35 - 15 MAV } Castanea mollissima
10 MAT }

chart for location of farm attached to correspondence
May, 1935 - Trees all doing well. (Oral _{to 3/24/35} report)

12/14/35 - All chestnuts living & doing fine.
July 1946 mimeo returned.

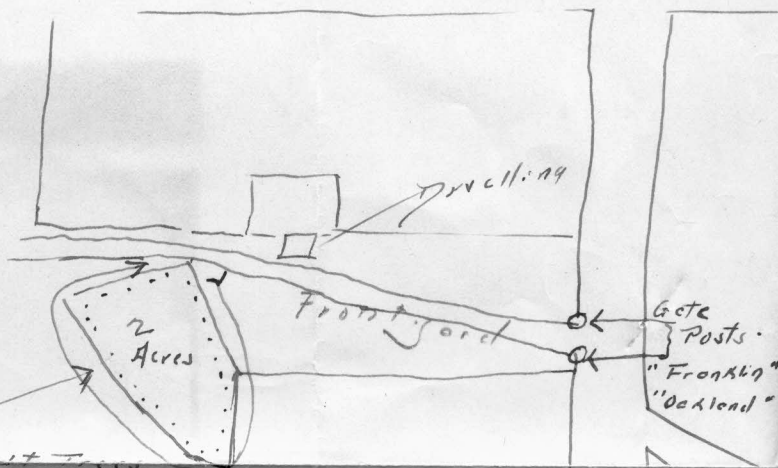
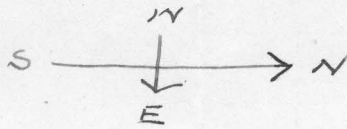

chestnut trees
Begin "MAN"
Northwest corner
"MAT" follow
Southwest then
Northwest -
Planted 40 feet
Apert -

25 Trees

FARM of J. Harris Franklin
"Oakland" - Sudley, Anne Arundel
County, Maryland -