

Riderwood, Md.

Seed memo. sent '44

Richard H. Tillman
Walnut Road

(Mail - Lexington Bldg at
Baltimore, Md.)

4/5/38 - 8 FP-530 c. mollesima
10 S-8 Ball hybrid

Ridgville, Md

W-1951

Ridgville Nurseries, Inc.

Jack P. King, Pres. & Mgr.

P.O. address - Mt. Airy, Md.

10/3/46 - Have ordered 300 2-yr.-old chest seedlings
and 2500 1-yr. old seedlings from Gold
Nursery, Covington, N. Va.

Reisterstown, Md (Trees here)
Baltimore, Md.

Hermann W. Roschen
214 N. Fulton Ave.

2/8/39 - Has about "a dozen" trees raised
from seed planted about 15 yrs.
ago, from 2 to 10 ft high. Only
1 bud developed so far; no blight.

Seed mimeo. sent '44

4/16

msl

Weevil Memo Sent 1948

Rockville, Md

1932 Shipment

Brooks John

Castanea mollissima

Quan.

No.

✓ 5 MF

✓ 5 MB

✓ 10 MT

✓ 5 MF

Try -
Remarks: Brooke Johns
Oakdale, Md.

9/29/35 - G. S. thinks trees planted
elsewhere, + requested name
and address.

no reply to inquiry made 3/18/36.

Rockville, Md.

W-1951

Tel = Rockville 2518

C. Kent Beattie

Liney Branch Farm

North Glen Road

Route #1

4/18/47 - 5 PI-61881 Quercus dentata.

5 PI-78658 " acutissima

4/25/47 - 50 7P-1200 Castanea mollissima (66037)

50 PI-78658 Quercus acutissima

Rockville
Washington, D.C.

Tel. EM 3-6123
Rockville, MD

Harold B. Stabler
6123 Broad Branch Road NW.

5/16/42 - See attached sketch of planting
of trees from Von Ammon.

Information to Gravatt
1/23/56

20 Thomas Bl. Walnut, 4 to 5" diameter
some sprouted from west.

About 12 chestnuts living, being
overtopped by pines.
Some cypress 4" in diameter

ACREE	DILLER	HICKERSON
BALINGER	DOAK	LINTHICUM
BARNES	ELLIS	MANGANARO
BEATTIE	FOWLER	MORGAN
CLAPPER	GOTT	PAGE
DAVIDSON	GRAVATT, A. R.	PFISTER
DAVIS, CATH.	GRAVATT, G. F.	TAYLOR, JOHN
DAVIS, W. C.	HARTLEY	HUTCHINS
DELAIVE	HEDGCOCK	

~~RONEY~~

Copy: Original and carbons.

Attach copy of letter—

Make copies agree

Amend	Instructions
Attention	Mail out
Comment	Order
Comply	Recording
Criticism	Refer to
File	Release if O. K.
Information ✓	Return to gms.
Initialing	Signature

16-15830 GPO

It came out in the
conversation that he
transplanted the trees
that are now so severely
bleighted, in dead of winter
when the ground was frozen.
He also cut off a lot of
roots in the transplants.

J.R.L.

would like a
photostat copy of map.

HAROLD B. STABLER
6123 BROAD BRANCH ROAD, N. W.
WASHINGTON, D. C.

File

DC

May 16, 1942.

Mr. G. F. Gravatt, Senior Pathologist,
Bureau of Plant Industry,
U. S. Department of Agriculture
Washington, D. C.

Dear Mr. Gravatt:

Very belatedly I am complying with a request you made in a letter you wrote me on November 8, 1938, to furnish you a sketch showing the location of the Chinese chestnut trees I obtained from Mrs. Anne von Ammon, widow of the late Sigfried von Ammon. Please find the sketch enclosed.

During your absence ^{from} the city this week I had two telephone conversations with Mr. Diller about these chestnut trees. I had thought they were doomed with the chestnut blight, but after examining samples he assures me it is twig blight, a different malady and one they may be expected to overcome if given proper care.

With renewed interest I have accordingly fed and cultivated them in the manner discussed with him, and am looking forward to seeing them yet make bearing trees. He would like to visit them with me say at the end of the 1943 growing season, and I am looking ^{forward} to that pleasure, conditions permitting.

Very truly yours

Harold B. Stabler

Enclosure;

Sketch

*Hugh V. Stabler
Sweets Manor
Rockville
Md.*

*Son who is interested in
place & who will probably inherit it
E*



PLAT OF STABLER FORESTRY AND NURSERY HOBBY PROJECT

5.08 Acres - Owned by Harold B. and Sarah F. Stabler,
6123 Broad Branch Road N. W., Washington, D. C.

LOCATION SKETCH

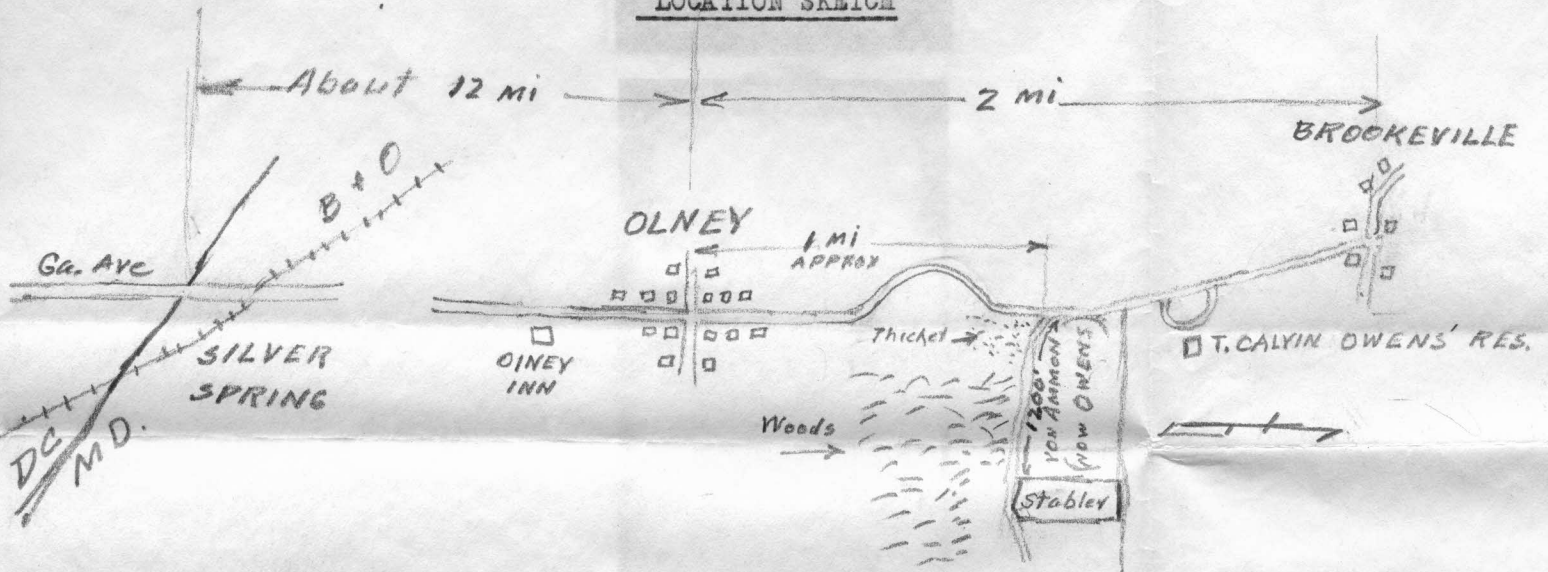

DETAIL PLAT

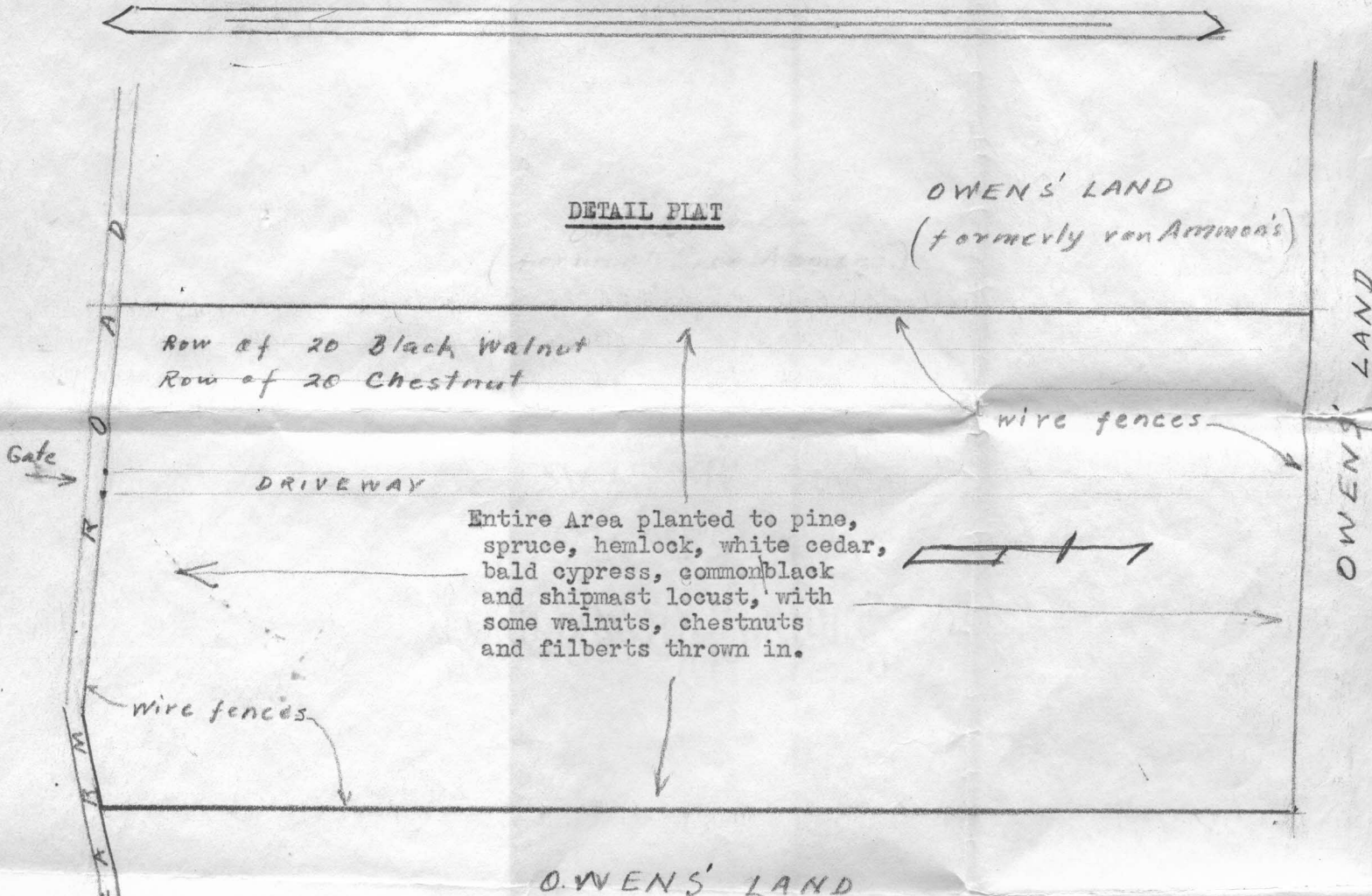

May 12, 1942
H.B.S.

Seed mimeo. sent '44

45947 *Montgomery Co.* mollissima

1

2 pls. 3-18-20 Bullard, Dr.E.L. Rockville, Md.

Montgomery Co.

45947

Castanea mollissima

Chestnut

X

S.P.I.No. Scientific Name Common Name

A prompt reply to the following questions regarding the tree above named will be thankfully received:

Number of trees alive... ² 2 Height of trees... ³⁻¹⁸⁻²⁰ 12 and 15-ft.

Have trees fruited? ^{Yes} Size and quality of nuts.....

Approximate location of trees on your place... *In front lawn*

near street

Kindly use inclosed envelope.

Knowles Ryerson,
Horticulturist in Charge.

Date... 5/12/28

Sign here... *E. L. Bullard*

..... Dr. E. L. Bullard.....
Experimenter

..... Rockville, Md.
Address

ROCKVILLE, MD.

DR. C. M. Grubb
Box 202

Seed mimeo. sent '44

5/29/16 - 1 #36666 C. moll.

Rockville 4, Md.

Manor Club Estates

James C. Dulin, Jr.

172 Carrollton Road

April, 1949 - Mr. Bisset sent him 50 trees of the Chinese chestnut, but no record of what he sent.

4/25/50 - Bisset sent up the map Mr. Dulin had sent him, showing where trees were planted.

45947 Montgomery Co. mollissima

Seed nimeo. sent '44

1 pl. 1-27-20 ~~Maynard, George~~, Rockville, Md.

Letter sent to P. M. 9/25/44

9/29/44 - Postmaster at Rockville, Md. says property now owned by Mr. Raymond Nichols.

ROCKVILLE, MD.

WILLIAM T. NICHOLSON

1940 -- 1 S-8 hybrid given him by J. Russell Smith

Ruxton, Md.

James H. Harrison

Nov. 1951 - Cooper Walker sent in a specimen from this tree for identification. Berry + \$\$\$ not sure; probably a hybrid with Jap blood.